

LOOP	PHASE (Φ)	FT. X FT.	CALCULATED	CALCULATED	REQUIRED
			INDUCTANCE MICROHENRIES (μH)	RESISTANCE OHMS (Ω)	# OF TURNS
1. EB CCO	2	6 X 6	342.9	2.4	6
2. EB LT CD	5	6 X 50 0	811.1	2.2	3-6-3
3. EB THRU CD	2	6 X 50 0	807.6	2.1	3-6-3
4. NB CD	N/A	N/A	N/A	N/A	N/A
5. WB CCO	6	6 X 6	82.0	0.8	3
6. WB LT CD	1	6 X 50 0	818.1	2.3	3-6-3
7. WB THRU CD	6	6 X 50 0	813.9	2.2	3-6-3
8. SB CCO	N/A	N/A	N/A	N/A	N/A
9. SB LT CD	N/A	N/A	N/A	N/A	N/A
10. SB THRU CD	N/A	N/A	N/A	N/A	N/A
11. SB RT CD	N/A	N/A	N/A	N/A	N/A

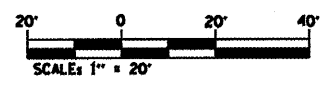
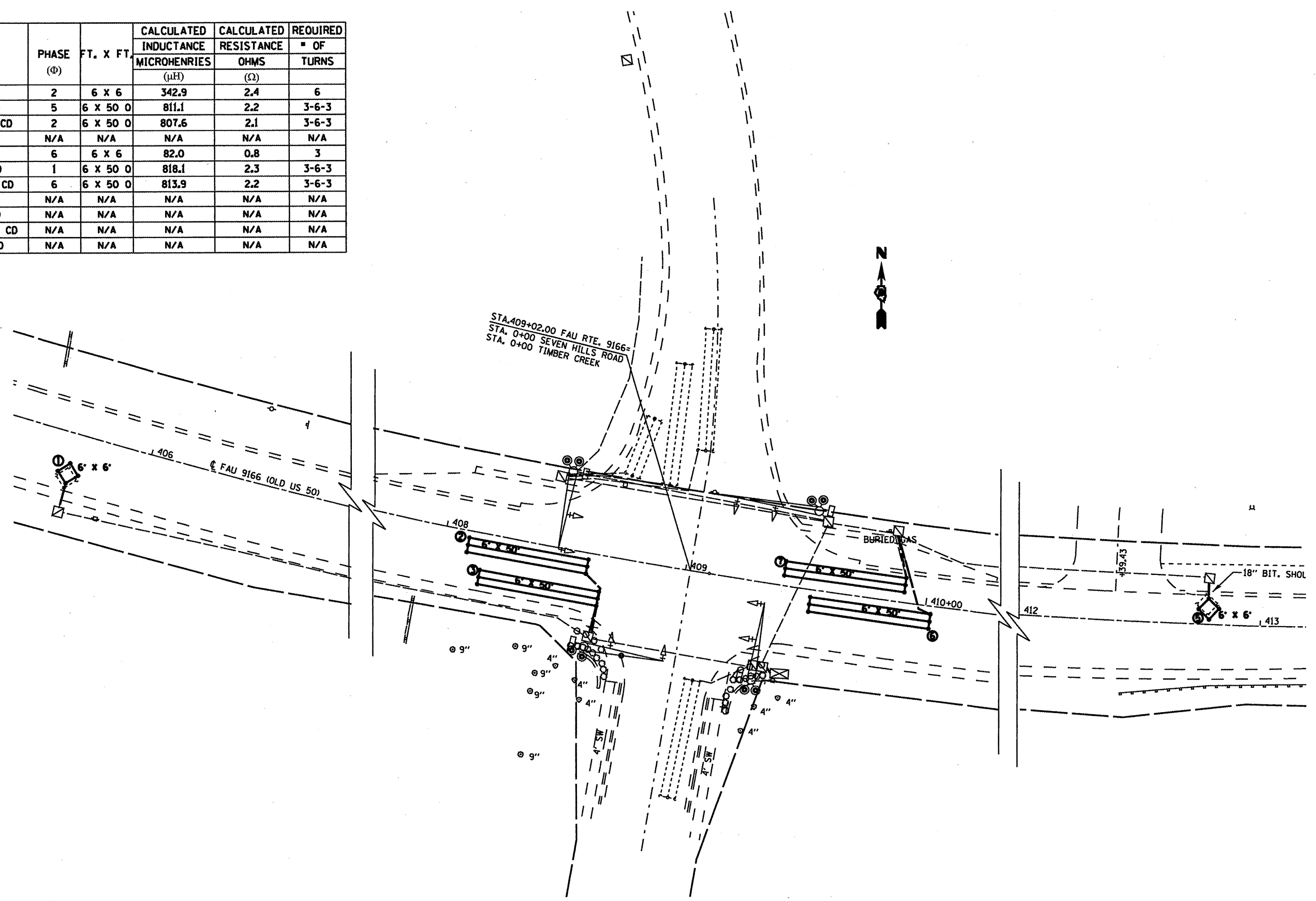

FILE NAME :	USER NAME : alfordb	DESIGNED -	REVISED -
ca\p...work\p...alfordb\08174224\d87659-shr-TSI.dgn		DRAWN -	REVISED -
		CHECKED -	REVISED -
		DATE -	REVISED -

**STATE OF ILLINOIS  
DEPARTMENT OF TRANSPORTATION**

**DETECTOR LOOP REPLACEMENT PLAN  
US 50 AT TIMBER CREEK / SEVEN HILLS RD**

SCALE: 1" = 20'    SHEET NO. OF SHEETS

F.A.U. RTE.	SECTION	COUNTY	TOTAL SHEETS	SHEET NO.
9166	32RS-3, 31RS-3, 1RS-1	ST. CLAIR	56	49
FED. ROAD DIST. NO. ILLINOIS FED. AID PROJECT			CONTRACT NO. 76069	