

Existing Curve Data
 PI Sta. 459+50.80
 $\Delta = 24^\circ 41' 27''$
 $D = 2^\circ 30'$
 $R = 2292.00'$
 $T = 501.64'$
 $L = 987.63'$
 $E = 54.25'$
 $SE = 0.024'/Ft.$

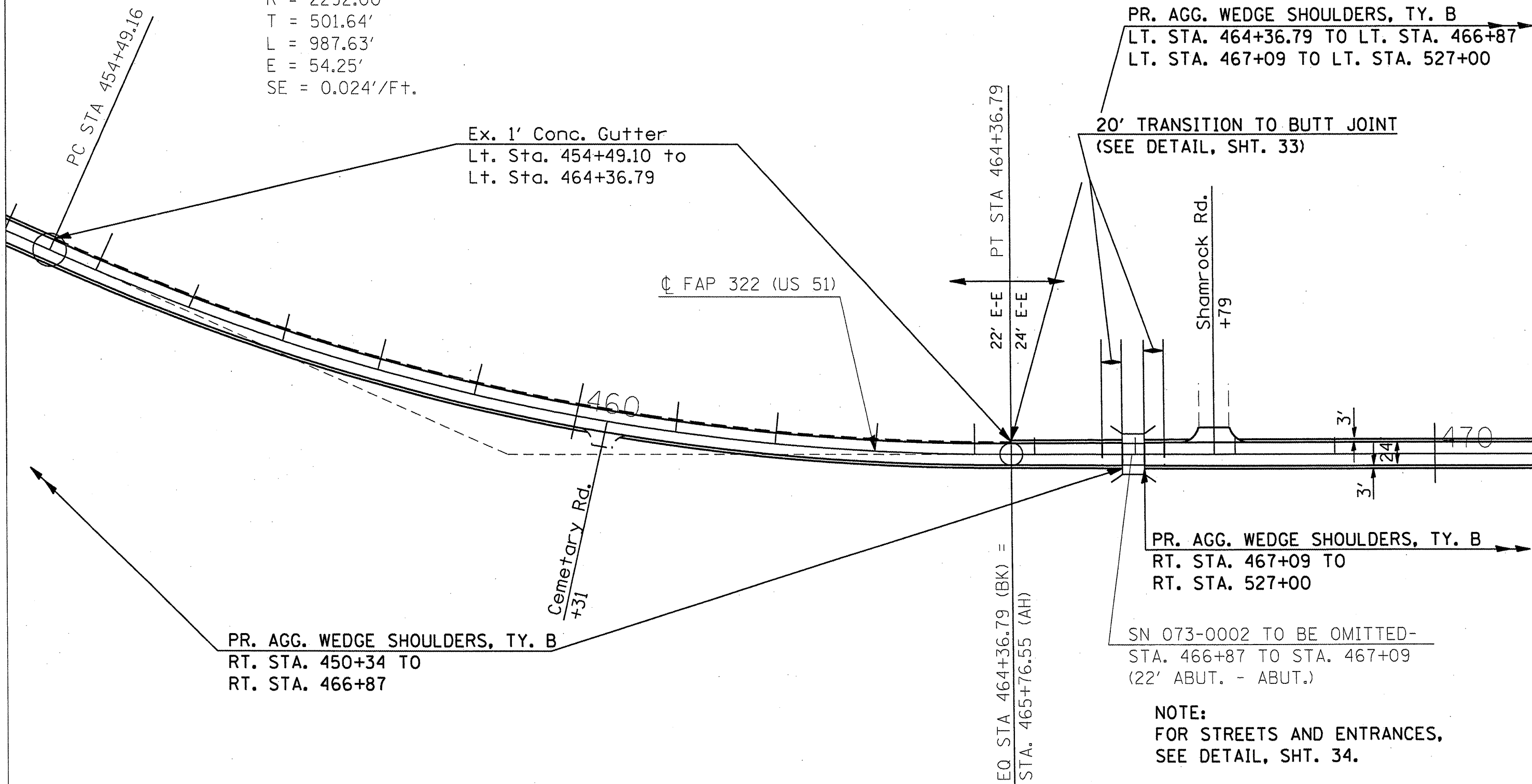
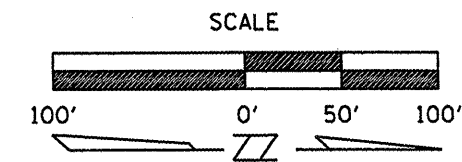

PR. AGG. WEDGE SHOULDERS, TY. B
 LT. STA. 464+36.79 TO LT. STA. 466+87
 LT. STA. 467+09 TO LT. STA. 527+00

20' TRANSITION TO BUTT JOINT
 (SEE DETAIL, SHT. 33)

PR. AGG. WEDGE SHOULDERS, TY. B
 RT. STA. 467+09 TO
 RT. STA. 527+00

SN 073-0002 TO BE OMITTED-
 STA. 466+87 TO STA. 467+09
 (22' ABUT. - ABUT.)

NOTE:
 FOR STREETS AND ENTRANCES,
 SEE DETAIL, SHT. 34.

FILE NAME =	USER NAME = mccordkr	DESIGNED -	REVISED -	STATE OF ILLINOIS DEPARTMENT OF TRANSPORTATION	PLAN LAYOUT		F.A.P. RTE. =	SECTION	COUNTY	TOTAL SHEETS	SHEET NO.
et\pwwork\pwwid\mccordkr\d0169663\78187-sht-plan.dgn		DRAWN -	REVISED -		--- STA. 454 ± 00 TO STA. 471 ± 00 ---		322	16-2185-3	PEBBY	37	24
PLOT SCALE = 1/8" = 100' / IN.		CHECKED -	REVISED -		SCALE: _____	SHEET NO. _____ OF _____ SHEETS	STA. _____ TO STA. _____	CONTRACT NO. 78167			
PLOT DATE = 1/8/2010		DATE -	REVISED -		ILLINOIS FED. AID PROJECT						