

LEGACY PARK

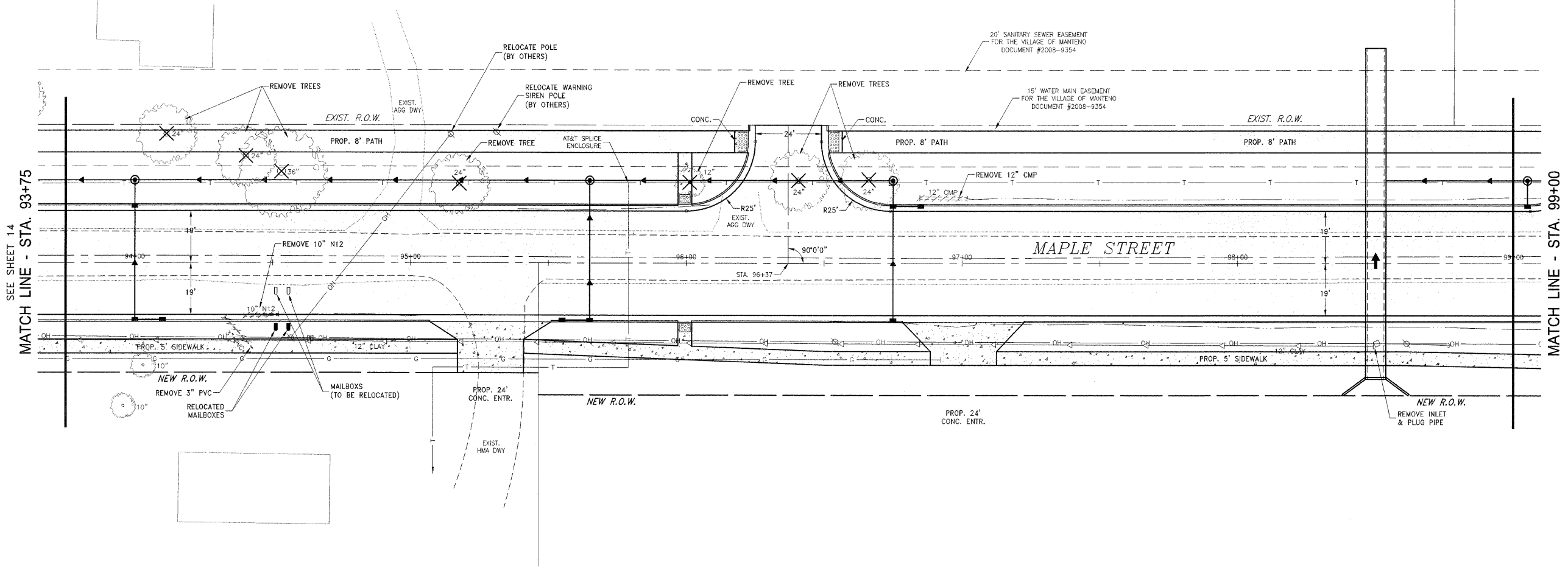

SEE SHEET 14  
MATCH LINE - STA. 93+75

MATCH LINE - STA. 99+00

LEGACY PARK

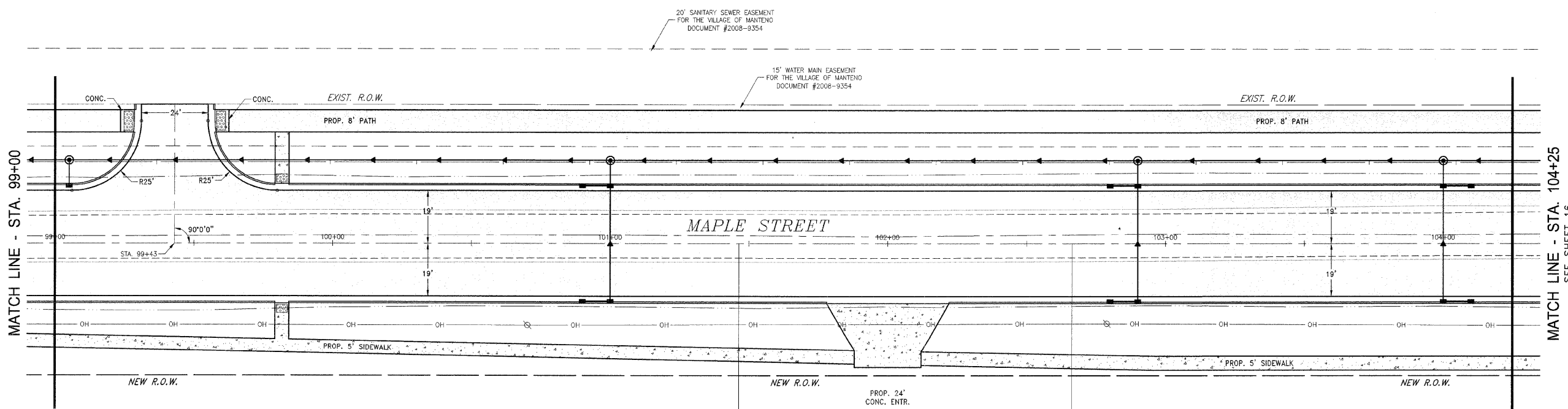

MATCH LINE - STA. 99+00

MATCH LINE - STA. 104+25  
SEE SHEET 16

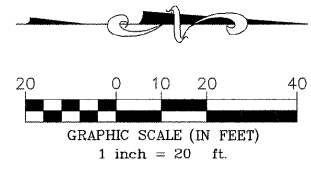

F.A.U. RTE.	SECTION	COUNTY	TOTAL SHEETS	SHEET NO.
**	**	KANKAKEE	59	15

CONTRACT NO. 87252

FED. ROAD DIST. NO. ILLINOIS FED. AD. PROJECT

- \* RONNIE GRAY DRIVE (6502)
- \* MAPLE STREET (6512)
- \*\* 00-00054-00-FP

**TYSON ENGINEERING, INC.**  
 CONSULTING CIVIL ENGINEERS  
 LAND SURVEYORS  
 DESIGN FIRM LICENSE # 184-001136  
 367 SOUTH SCHUYLER AVENUE  
 KANKAKEE, ILLINOIS 60901  
 PHONE (815) 932-7406

This document and the ideas and designs incorporated herein, as an instrument of professional service, is the property of Tyson Engineering Inc. and is not to be used in whole or in part, for any other project without written authorization of Tyson Engineering Inc.

Do not scale drawings. Use dimensions only.

Contractor shall be responsible for verifying all dimensions.

Information hereon and herein is confidential.

REVISIONS

NO.	DATE	BY	DESCRIPTION
1	10/30/09	MRG	PER IDOT REVIEW

MAPLE STREET  
REMOVAL PLAN

VILLAGE OF MANTENO  
**MAPLE STREET AND RONNIE GRAY DRIVE IMPROVEMENTS**  
 MANTENO, ILLINOIS

SECTION  
00-00054-00-FP

DATE: 9/25/09 JOB NO. E06030

SCALE: HORZ.: 1"=20' FILE NO.  
VERT.: N/A

DRAWN BY: MRG SHEET

CHECKED BY: SRM **15**