

ROUTE NO.	SECTION	COUNTY	TOTAL SHEETS	SHEET NO.
-	08-00024-00-SW	TAZEWELL	19	4
FEDERAL ROAD DIST. NO.	ILLINOIS	CONTRACT NO.	69506	

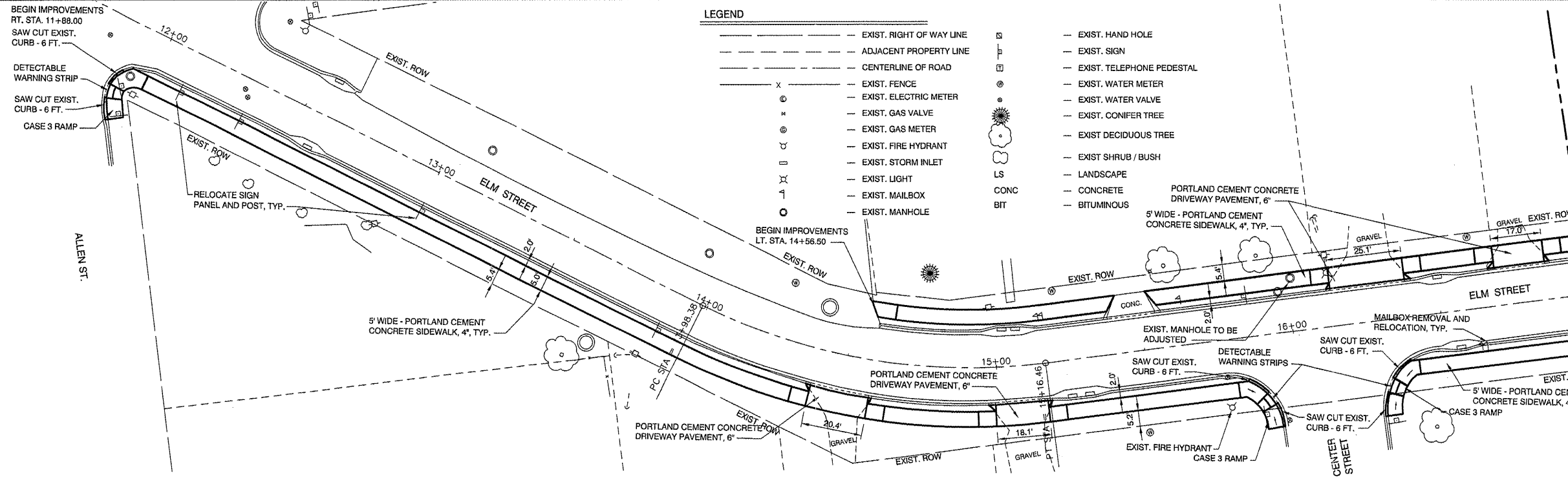

- LEGEND**
- EXIST. RIGHT OF WAY LINE
  - ADJACENT PROPERTY LINE
  - CENTERLINE OF ROAD
  - EXIST. FENCE
  - EXIST. ELECTRIC METER
  - EXIST. GAS VALVE
  - EXIST. GAS METER
  - EXIST. FIRE HYDRANT
  - EXIST. STORM INLET
  - EXIST. LIGHT
  - EXIST. MAILBOX
  - EXIST. MANHOLE
  - EXIST. HAND HOLE
  - EXIST. SIGN
  - EXIST. TELEPHONE PEDESTAL
  - EXIST. WATER METER
  - EXIST. WATER VALVE
  - EXIST. CONIFER TREE
  - EXIST. DECIDUOUS TREE
  - EXIST. SHRUB / BUSH
  - LANDSCAPE
  - CONCRETE
  - BITUMINOUS

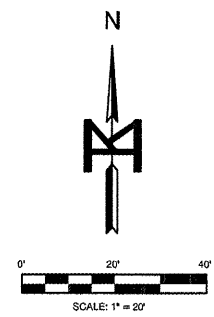

**ELM STREET SIDEWALK PLAN**  
SCALE: 1" = 20'

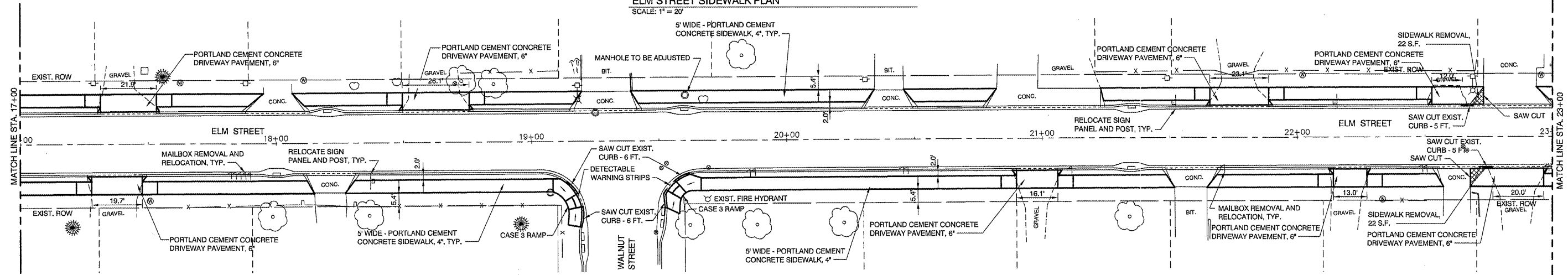

**ELM STREET SIDEWALK PLAN**  
SCALE: 1" = 20'

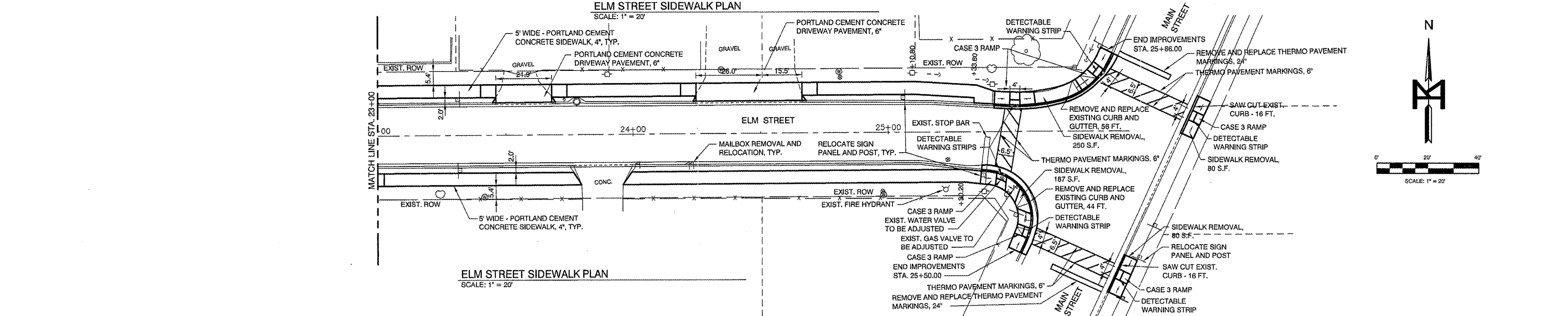

**ELM STREET SIDEWALK PLAN**  
SCALE: 1" = 20'

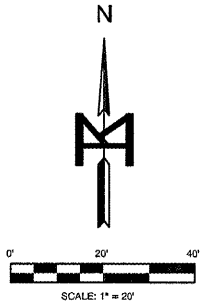

**M MOHR & KERR ENGINEERING & LAND SURVEYING, P.C.**  
7335 N. University Ave. Office: (309) 692-8500  
Peoria, Illinois 61614 Fax: (309) 692-8501  
www.mohr-kerr.com Professional Design Firm #184.005091

REV.	DATE	NATURE OF REVISION	CHECKED

SURVEYED	MOP	CLIENT:
DRAWN	DEH	VILLAGE OF NORTH PEKIN
CHECKED	SDK	TAZEWELL COUNTY, ILLINOIS
SCALE	1" = 20'	
DATE	02-15-10	

TITLE: **NORTH PEKIN SIDEWALK IMPROVEMENTS  
ELM STREET SIDEWALK PLAN VIEWS**

PROJECT NO.	09-087
SHEET	4 OF 19
DRAWING NO.	4