

ROUTE NO.	SECTION	COUNTY	TOTAL SHEETS	SHEET NO.
08-00024-00-SW	TAZEWELL	ILLINOIS	19	10
FEDERAL ROAD DIST. NO.		CONTRACT NO.	8996	

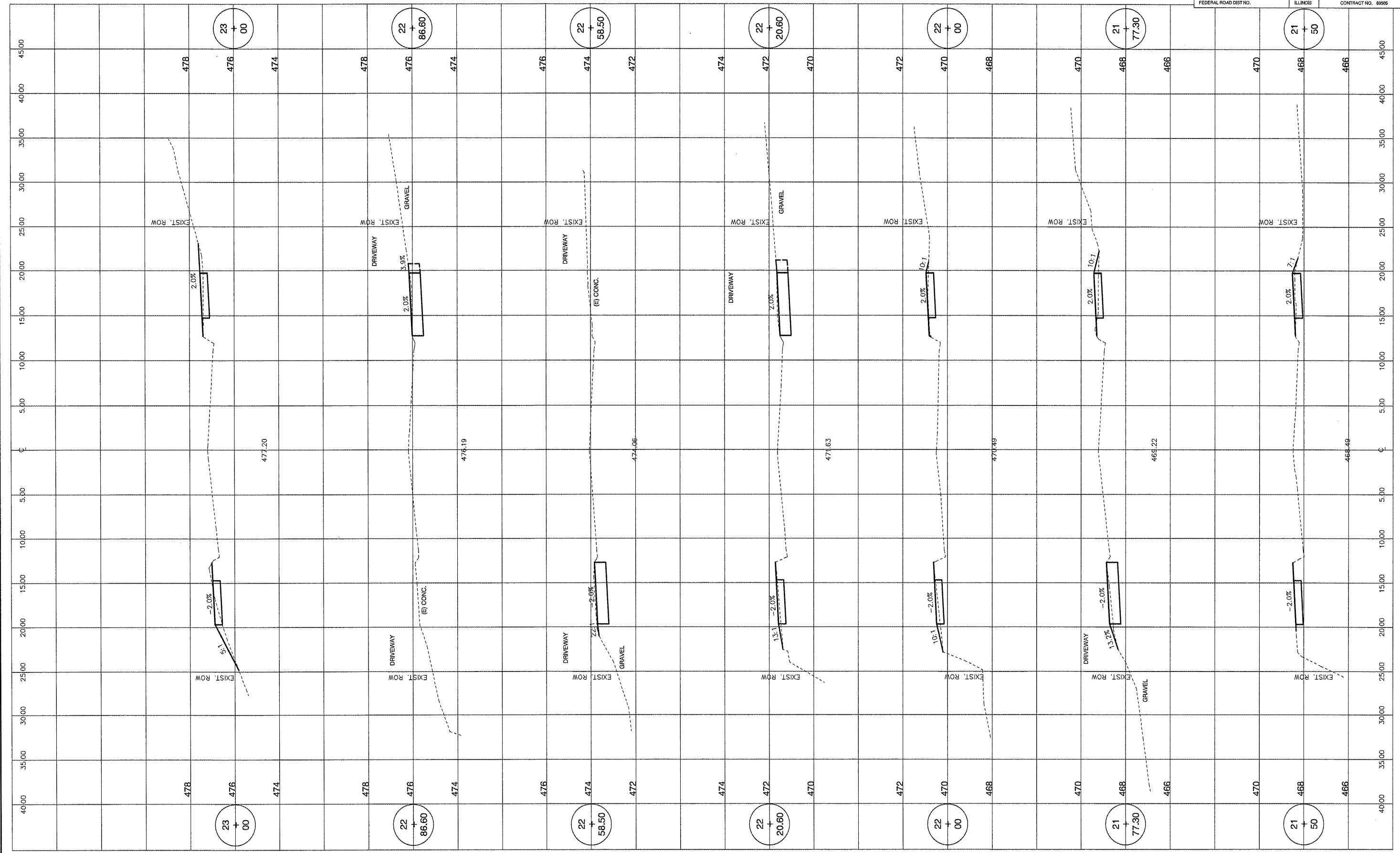

**M** MOHR & KERR ENGINEERING & LAND SURVEYING, P.C.  
 7336 N. University Ave. Office: (309) 692-8500  
 Peoria, Illinois 61614 Fax: (309) 692-8501  
 www.mohrandkerr.com Professional Design Firm #184.005091

REV.	DATE	NATURE OF REVISION	CHECKED

FILE NAME: 2109-097 \*02V0\_BHT10-ELMHW3012DW

SURVEYED MDP  
 DRAWN DEH  
 CHECKED SDK  
 SCALE 1" = 8' H 1" = 2' V  
 DATE 02-15-10

CLIENT:  
**VILLAGE OF NORTH PEKIN  
 TAZEWELL COUNTY, ILLINOIS**

TITLE:  
**NORTH PEKIN SIDEWALK IMPROVEMENTS  
 ELM STREET CROSS SECTIONS  
 STA. 21+50 TO STA. 23+00**

PROJECT NO. 09-087  
 SHEET 10 OF 19  
 DRAWING NO. 10