

ROUTE NO.	SECTION	COUNTY	TOTAL SHEETS	SHEET NO.
08-00024-00-SW	TAZEWELL	ILLINOIS	19	14
FEDERAL ROAD DIST. NO.		CONTRACT NO.	89968	

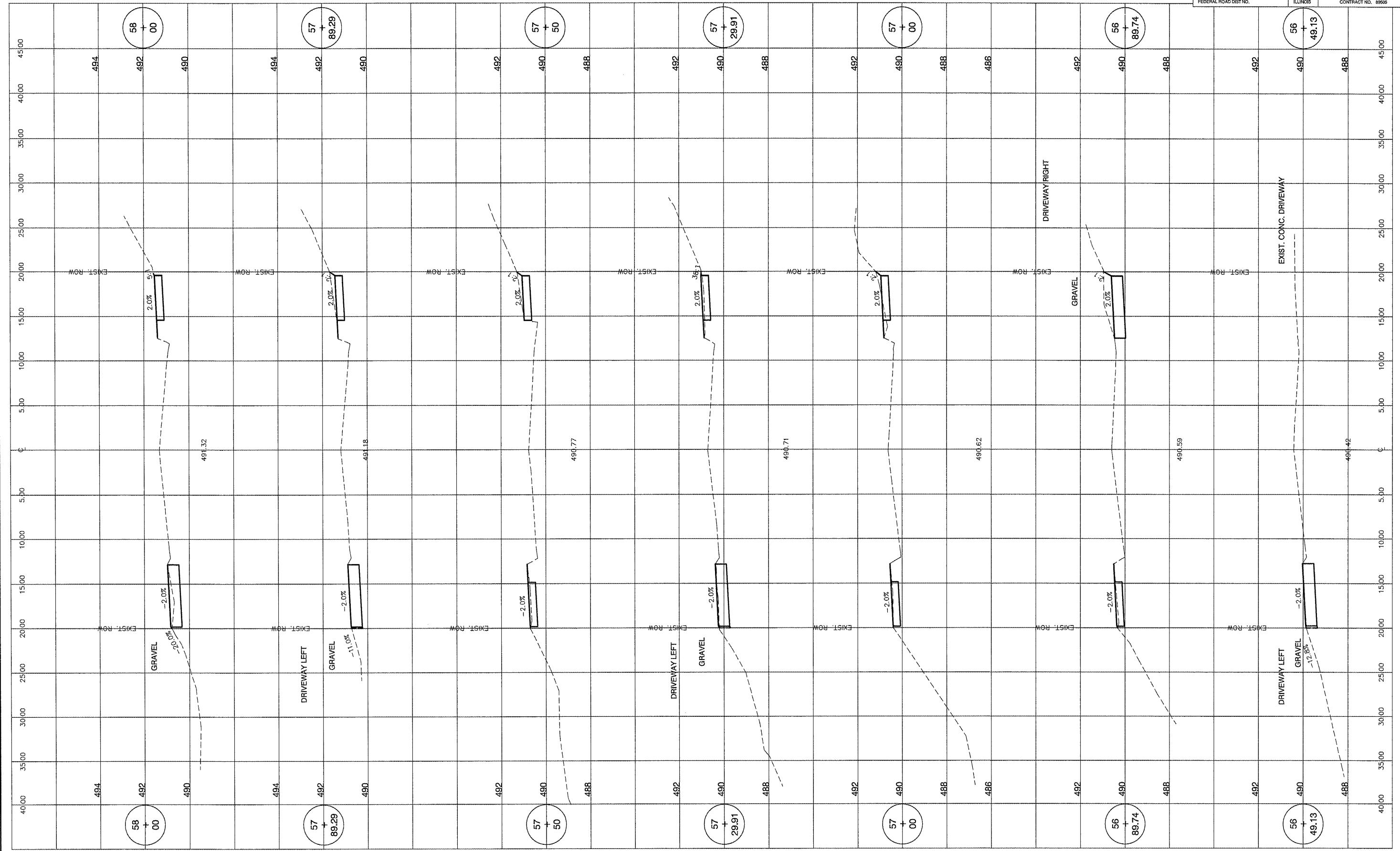

M MOHR & KERR ENGINEERING & LAND SURVEYING, P.C.
 7336 N. University Ave. Office: (309) 692-8500
 Peoria, Illinois 61614 Fax: (309) 692-8501
 www.mohrandkerr.com Professional Design Firm #184.005091

REV.	DATE	NATURE OF REVISION	CHECKED

FILE NAME: 2102-007 *DWG. 01714-LEE-00002.DWG

SURVEYED MDP
 DRAWN DEH
 CHECKED SDK
 SCALE 1" = 5' H 1" = 2' V
 DATE 02-15-10

CLIENT:
 VILLAGE OF NORTH PEKIN
 TAZEWELL COUNTY, ILLINOIS

TITLE:
 NORTH PEKIN SIDEWALK IMPROVEMENTS
 LEE STREET CROSS SECTIONS
 STA. 56+49.13 TO STA. 58+00

PROJECT NO. 09-087
 SHEET 14 OF 19
 DRAWING NO. 14