

STATE OF ILLINOIS
DEPARTMENT OF TRANSPORTATION

* Order a(E) and a₁(E) bars full length.
Cut to fit skew and use remainder
of bars in opposite end.

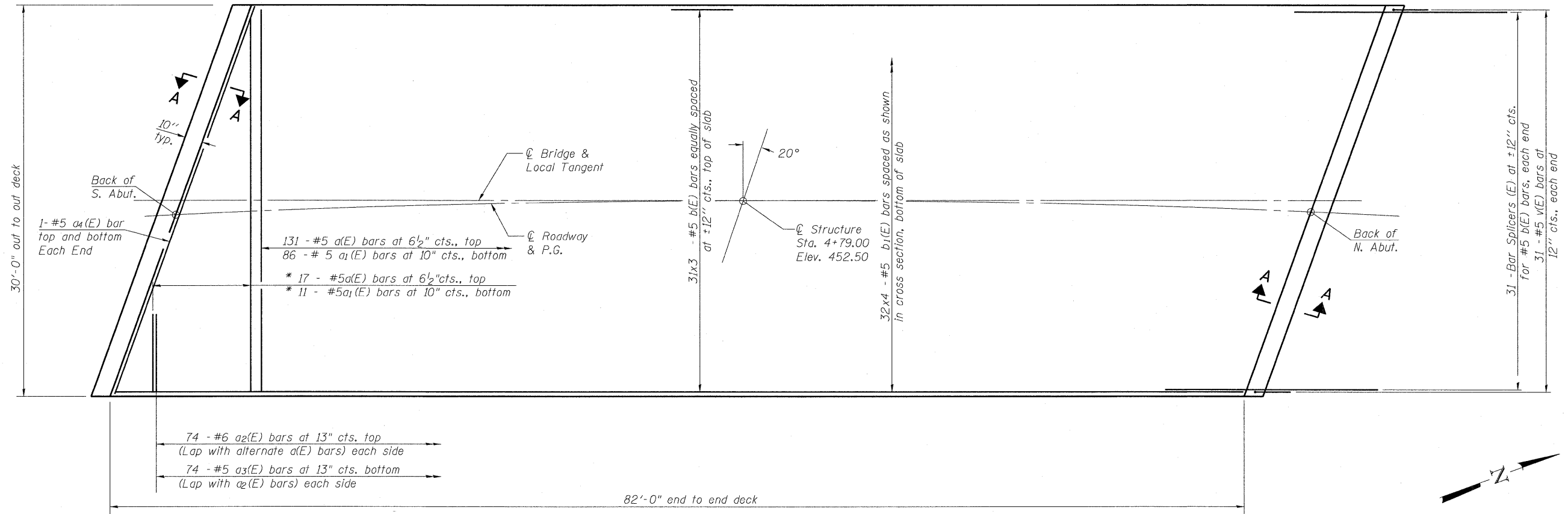

PLAN

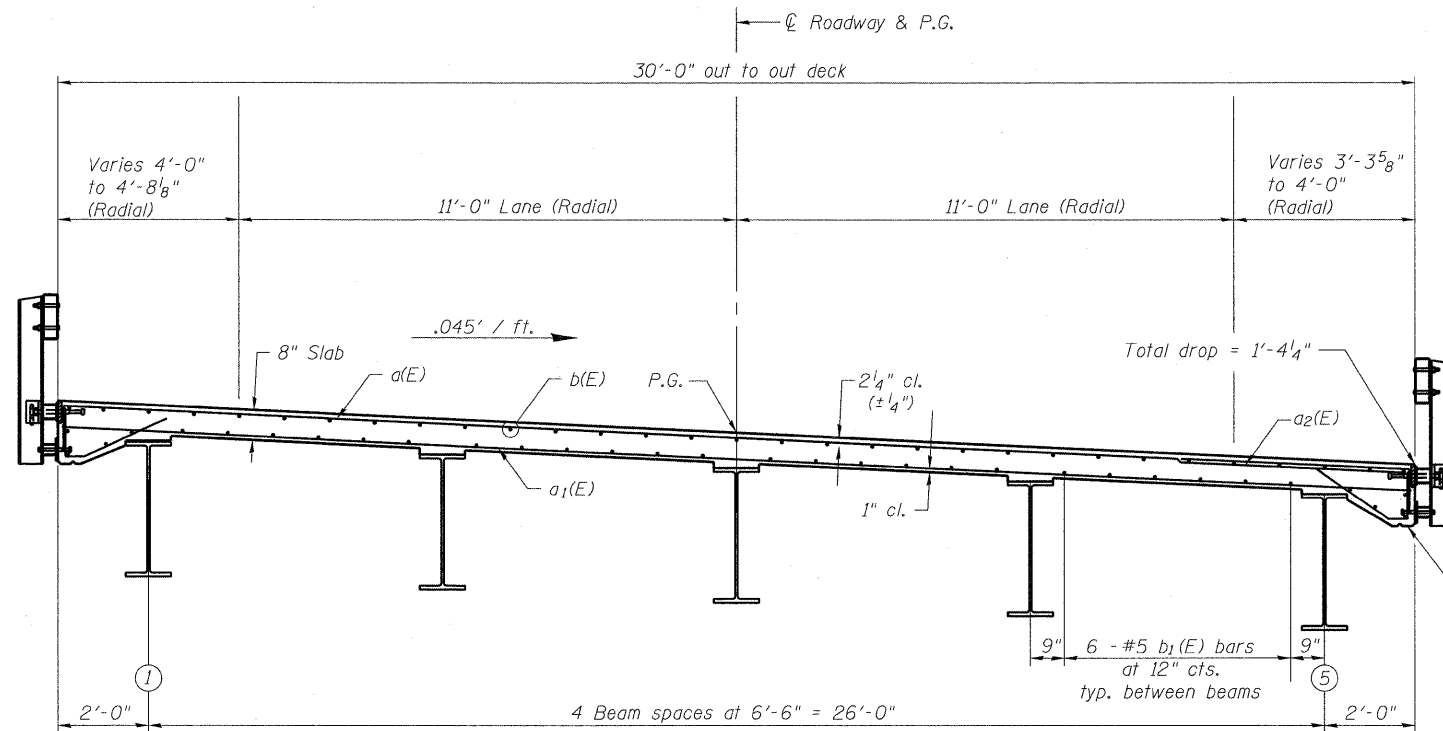

CROSS SECTION
(Looking North)

Notes:
See Sheet 6 of 17 for superstructure details
and Bill of Material.
Bars indicated thus 20 x 3-#5 etc. indicates
20 lines of bars with 3 lengths per line.
See Sheet 6 of 17 for Section A-A.
See Sheet 15 of 17 for Bar Splicer Details.

MIN. BAR LAP
#5 bar = 2'-2"



DESIGNED NIEWINSKI
CHECKED TRELLO
DRAWN VERENSKI
CHECKED TRELLO

G&B PROJECT: - PLOT DRIVER = V61.TDS700.PS.LOCAL_ID01.pltcf g
FILE NAME = J:\07258\CADD\CAD\Sheets\SN 085-3055\0853055-87258-Sht-SS.dgn
PLOT DATE = 9/18/2009 PLOT SCALE = 24' 1" / 1" USER NAME = frankv

SUPERSTRUCTURE
F.A.S. ROUTE 454
SECTION 04-00070-00-BR
SCHUYLER COUNTY
STATION 4+79.00
S.N. 085-3055

SHEET NO. 5 17 SHEETS	F.A.S. RTE.	SECTION	COUNTY	TOTAL SHEETS	SHEET NO.
	454	04-00070-00-BR	SCHUYLER	30	13
FED. ROAD DIST. NO. - ILLINOIS			FED. AID PROJECT		
			CONTRACT NO. 93499		

SI-1-L

10-1-08