



LEGEND	
	PERIMETER EROSION BARRIER
	SEEDING LIMITS

DISTURBED AREAS SHALL BE TEMPORARILY SEEDED AS SPECIFIED IN SECTION 280 OF THE STANDARD SPECIFICATIONS

THE FOLLOWING AREAS WILL BE SEEDED WITH TURF SEEDING:

1. A 2 FOOT WIDE STRIP ADJACENT TO EACH EDGE OF THE MAIN TRAIL STA 917+26.90 TO STA 1207+75
2. AT REST AREAS, CENTENNIAL PARK TRAIL HEAD AND PLANTING AREAS AS SHOWN IN THE PLANS
3. A 2 FOOT WIDE STRIP ADJACENT TO EACH EDGE OF THE CONNECTOR PAVEMENT LT STA 1027+81 AND 1089+10.5
4. ALL DISTURBED AREAS WITHIN 30 FEET OF THE EDGE OF PAVEMENT OF INTERSECTING STREETS
5. ALL DISTURBED AREAS ALONG THE STUART PARK CONNECTOR, PARK CONNECTOR, AND PARK PATHWAY

ALL OTHER AREAS WILL BE SEEDED WITH PRAIRIE SEEDING.

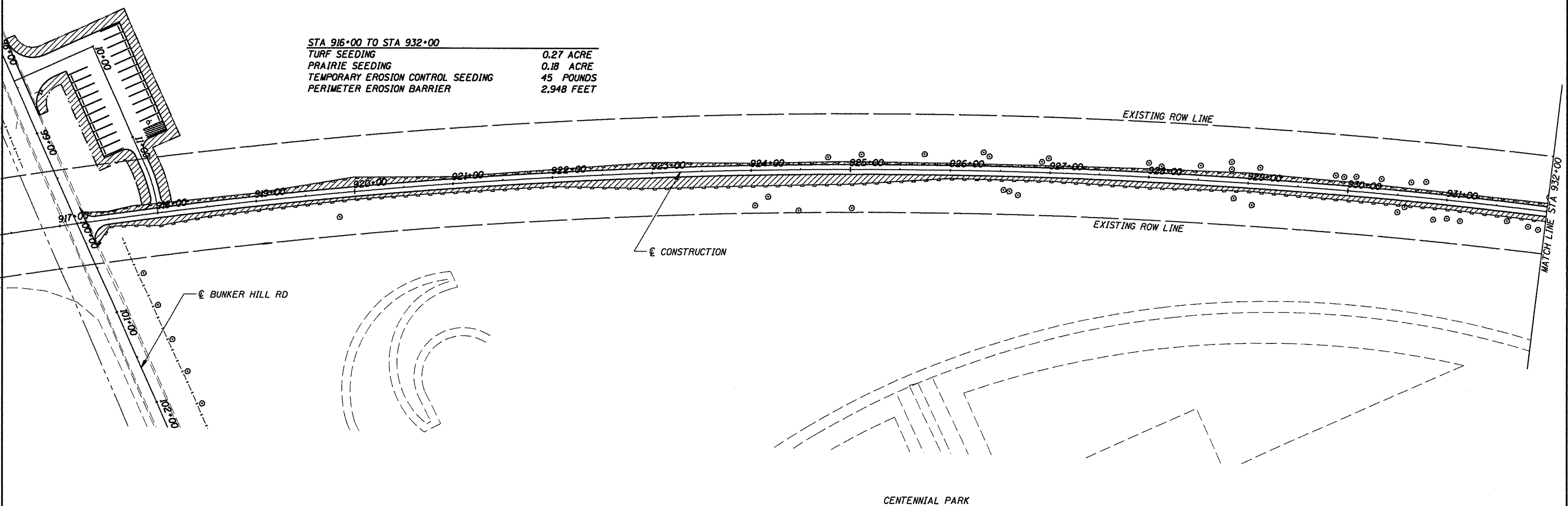

STA 916+00 TO STA 932+00	
TURF SEEDING	0.27 ACRE
PRAIRIE SEEDING	0.18 ACRE
TEMPORARY EROSION CONTROL SEEDING	45 POUNDS
PERIMETER EROSION BARRIER	2,948 FEET

CUMMINS
ENGINEERING
CORPORATION

JOB = 2192	DESIGNED - NAK	REVISED -
FILE NAME = 2192erosion.dgn	DRAWN - AJH	REVISED -
PLOT SCALE = 1/8" = 1' / IN.	CHECKED - NAK	REVISED -
PLOT DATE = 6/5/2009	DATE - 1/22/2009	REVISED -

SANGAMON VALLEY TRAIL

EROSION CONTROL PLAN

F.A.S. RTE.	SECTION	COUNTY	TOTAL SHEETS	SHEET NO.
	05-00173-00-BT	SANGAMON	173	44
CONTRACT NO.				
FED. ROAD DIST. NO.	ILLINOIS FED. AID PROJECT			

93522