

GENERAL NOTES

- Fasteners shall be AASHTO M164 Type 3. Bolts 3/4" φ, holes 15/16" φ, unless otherwise noted.
- All Reinforcement bars shall conform to the requirements of ASTM A 706 Gr 60. See Special Provisions.
- Reinforcement bars shall be epoxy coated.
- Plan dimensions and details relative to existing plans are subject to nominal construction variations. The Contractor shall field verify existing dimensions and details affecting new construction and make necessary approved adjustments prior to construction or ordering of materials. Such variations shall not be cause for additional compensation for a change in scope or work, however, the Contractor will be paid for the quantity actually furnished at the unit bid price for work.
- Concrete Sealer shall be applied to the exposed surfaces of the new concrete bearing pedestals and the top and front face of the new concrete back wall.
- The existing structural steel coating contains lead. The Contractor shall take appropriate precautions to deal with the presence of lead on this project.
- Unless noted otherwise, exposed concrete edges shall have a 3/4" chamfer.
- The Contractor shall provide and install all necessary timber shims to construct a level deck surface.
- Timber deck planks shall be placed with the grain such that cupping will not cause water to sit on a plank.
- The Contractor shall field verify all conditions at the site prior to the start of construction.
- All structural timber shall be treated to conform to Section 507 of the Standard Specifications.
- All hardware required for timber construction, including nuts, washers, lag screws, threaded rods and miscellaneous fasteners shall be stainless steel or hot-dipped galvanized and shall conform to Section 507 of the Standard Specifications unless noted otherwise.
- The Contractor shall remove the existing debris from both abutments. The cost of this work shall be included in the cost for "Removal of Existing Timber Materials".
- It shall be the responsibility of the Contractor to verify all dimensions and elevations of the existing structure in the field prior to construction and ordering materials. Do not scale dimensions from the drawings for construction purposes.
- If, during the performance of the work, the Contractor finds a conflict or discrepancy related to existing details and dimensions of the existing structure, the Contractor shall report such discrepancies to the Engineer in writing at once and before proceeding with the work affected thereby. The Contractor shall obtain written interpretation or clarification of such discrepancies.
- "Removal of Existing Timber Materials" includes:
Existing Railroad Ties, quantity = 44 each
Existing Spacer Ties, quantity = 4 each
Existing Backwall Timbers, approximate quantity = 10 each
Existing Bearing Cribbing, quantity = 12 each
- All lumber dimensions given are nominal dimensions. The minimum surfaced areas of timbers shall be as follows:

NOMINAL SIZE	DRESSED
2 x 6	1 1/2" x 5 1/2"
2 x 8	1 1/2" x 7 1/4"
3 x 12	2 1/2" x 11 1/4"
6 x 6	5 1/2" x 5 1/2"
8 x 8	7 1/2" x 7 1/2"

INDEX OF SHEETS

- General Plan & Elevation
- General Notes, Total Bill of Material, Typical Cross Sections
- Timber Deck & Railing Details
- Timber Framing Details
- Timber Details
- Abutment Details

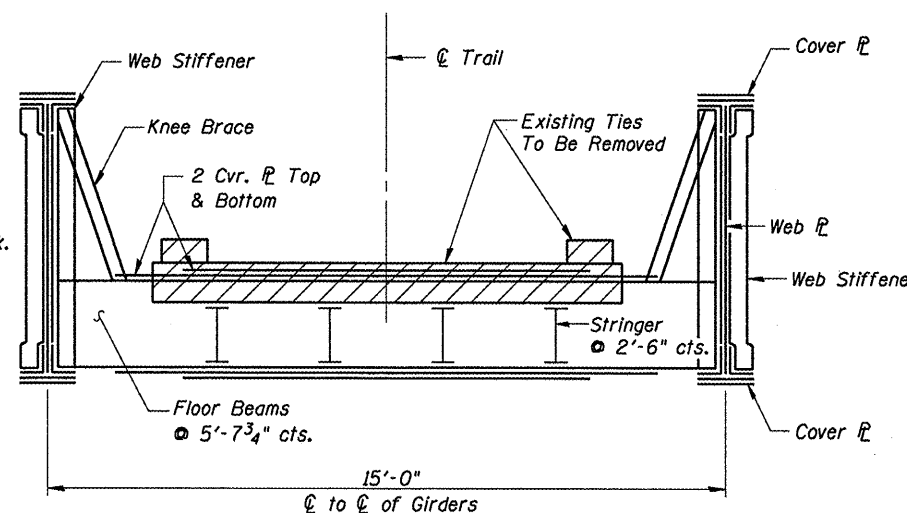

**EXISTING CROSS SECTION
42' RIVETED THRU PLATE GIRDER**

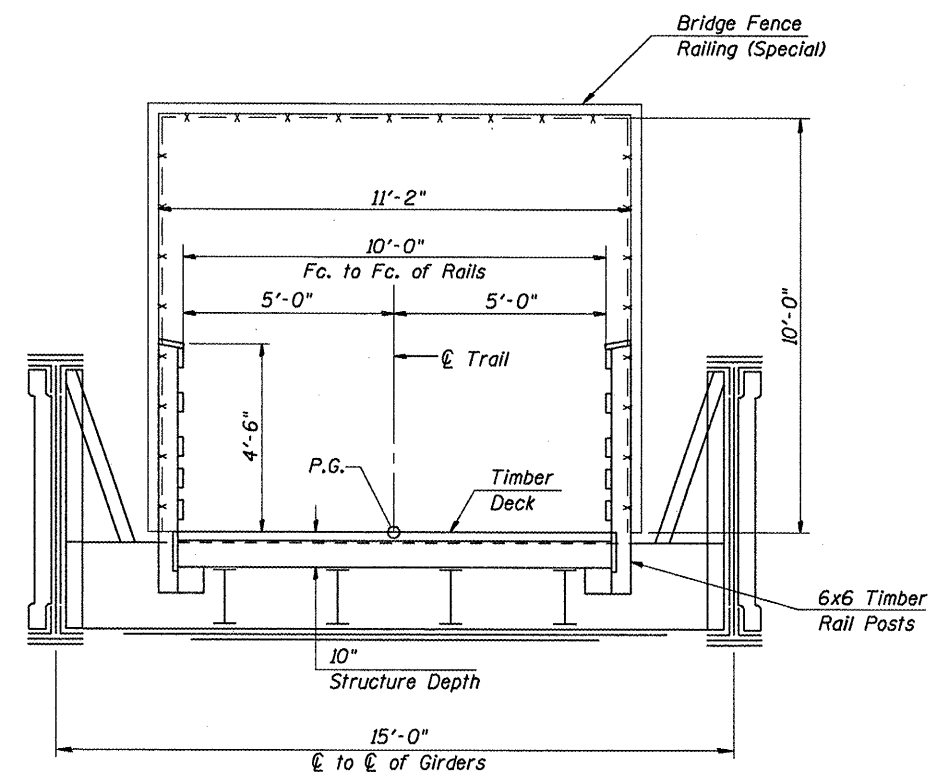

**PROPOSED CROSS SECTION
REHABILITATION OF EXISTING RIVETED THRU PLATE GIRDERS**

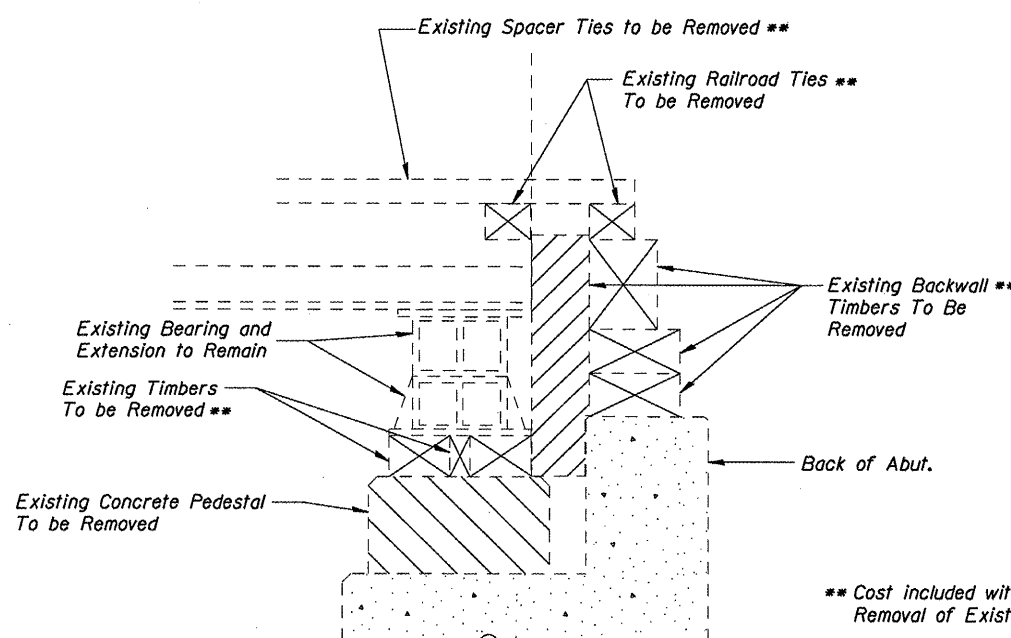

SECTION THRU EXISTING ABUTMENT

TOTAL BILL OF MATERIAL

ITEM	UNIT	SUPER	SUB	TOTAL
Treated Timber	F.B.M.	4,785		4,785
Hardware	Pound	900		900
Concrete Structures	Cu. Yd.		10.8	10.8
Concrete Removal	Cu. Yd.		1.2	1.2
Jacking Existing Superstructure	L. Sum	1		1
Reinforcement Bars, Epoxy Coated	Pound		1,060	1,060
Removal of Existing Timber Materials, Location 2	L. Sum	1		1
Bridge Fence Railing (Special)	Sq. Ft.	1,150		1,150
Structure Excavation	Cu. Yd.		7	7
Concrete Sealer	Sq. Ft.		330	330
Protective Shield	Sq. Yd.	70		70
Anchor Bolts 1/4"	Each		8	8

* See Special Provisions

**GENERAL NOTES, TOTAL BILL OF MATERIAL
& TYPICAL CROSS SECTIONS
SANGAMON VALLEY TRAIL
OVER JEFFERSON STREET (IL ROUTE 97)
SVT BRIDGE NO. 15
STRUCTURE NO. 084-9936**

CEC Cummins
Engineering
Corporation
Civil and Structural Engineering

JOB = 2192	DESIGNED	M.D.C.
FILE = 2192jeff_gennotes	CHECKED	A.A.N.
DATE = 10/30/2009	DRAWN	T.S.H.
	CHECKED	M.D.C.

Sheet 2 of 6	RTE.	SECTION	COUNTY	TOTAL SHEETS	SHEET NO.
	SVT	05-00173-00-BT	SANGAMON	173	108
SANGAMON VALLEY TRAIL			CONTRACT NO.		
FED. ROAD DIST. NO. 6			ILLINOIS FED. AID PROJECT		

93522