

DATE	
BY	
FINAL SURVEY	
NOTE BOOK	
NO.	
SURVEYED	
PLOTTED	
DATE	
AREAS CHECKED	

DATE	
BY	
ORIGINAL SURVEY	
NOTE BOOK	
NO.	
SURVEYED	
PLOTTED	
DATE	
AREAS CHECKED	

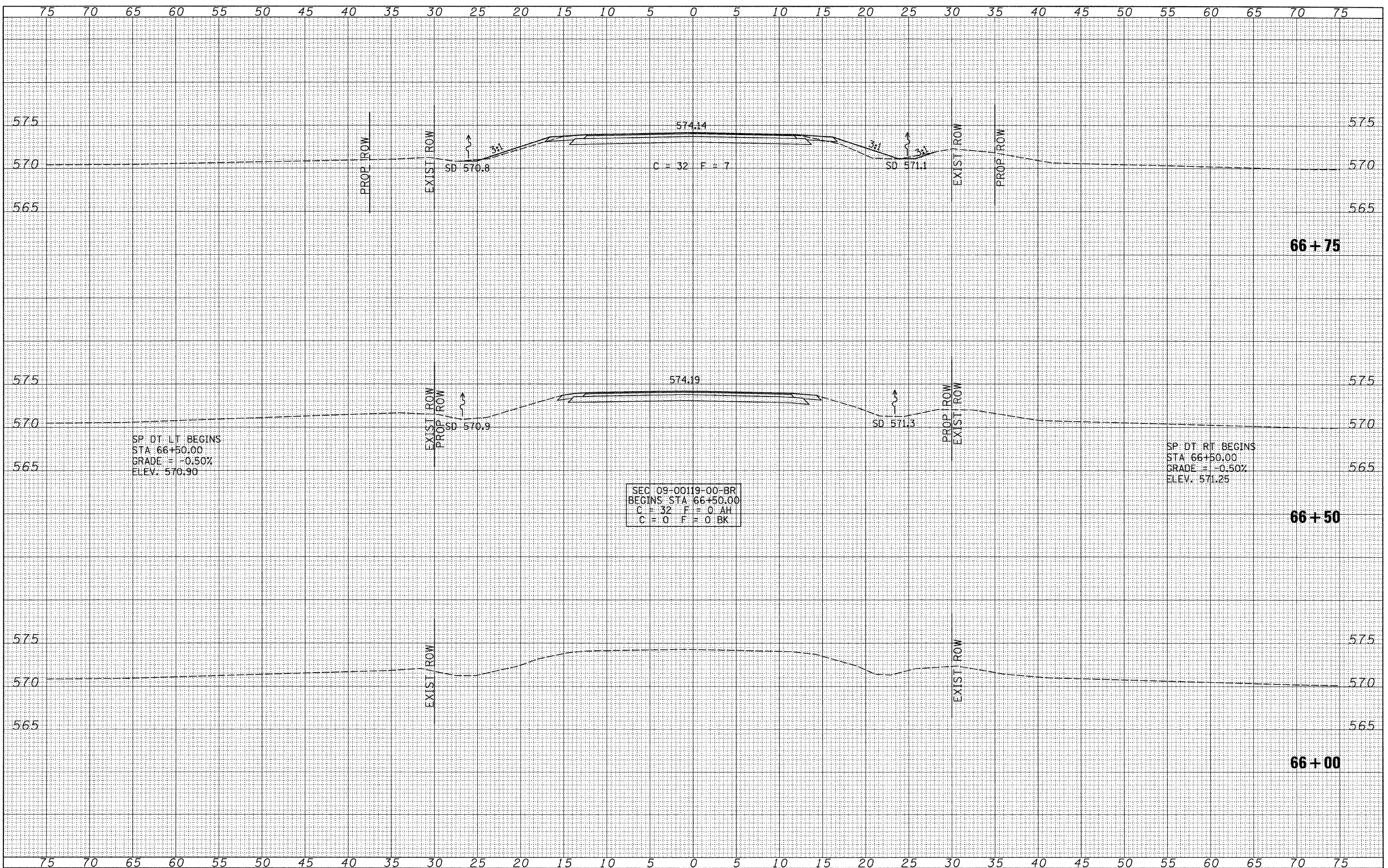

FILE NAME = V:\Bridg\2755-Logan\2755xsheeta.dgn	USER NAME = othomas	DESIGNED -	REVISED -	LOGAN COUNTY COUNTY HIGHWAY 10 OVER LAKE FORK CREEK TRIBUTARY	CROSS SECTIONS		F.A.S. RTE. = 566	SECTION = 09-00119-00-BR	COUNTY = LOGAN	TOTAL SHEETS = 17	SHEET NO. = 11
		DRAWN -	REVISED -		SCALE: 1" = 5'-0"	SHEET NO. 1 OF 7 SHEETS	STA. 66+00.00	TO STA. 66+75.00	FED. ROAD DIST. NO. 7	ILLINOIS	FED. AID PROJECT BRS-0566(07)
		CHECKED -	REVISED -		CONTRACT NO. 93525						
		DATE -	REVISED -								