

DATE	
BY	
FINAL SURVEY	SURVEYED
NOTE BOOK	PLOTTED
NO.	DATE
	AREAS CHECKED

DATE	
BY	
ORIGINAL SURVEY	SURVEYED
NOTE BOOK	PLOTTED
NO.	DATE
	AREAS CHECKED

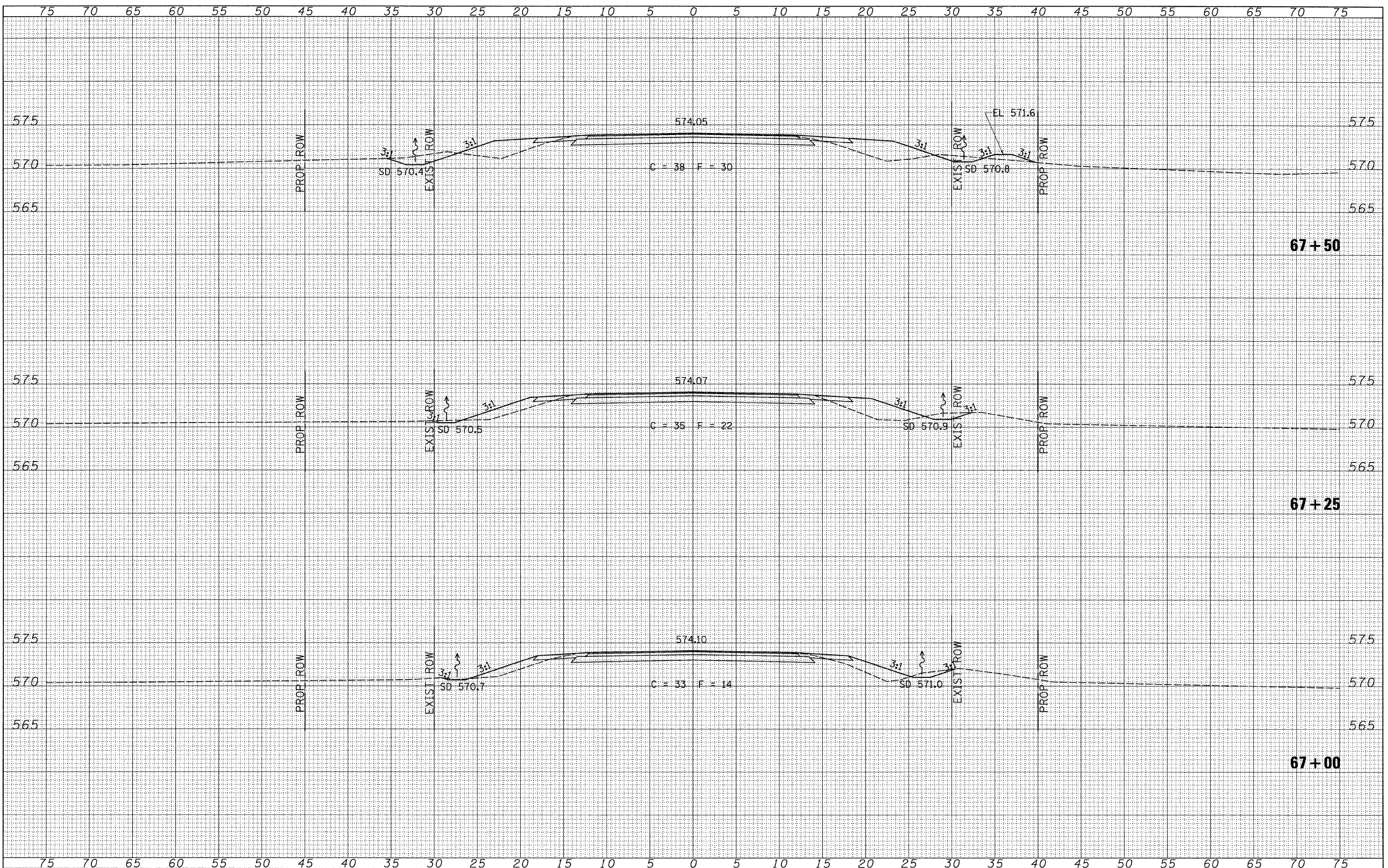

FILE NAME = V:\Bridg\2755-Logan\2755xsheet.dgn	USER NAME = cthomas	DESIGNED -	REVISED -	LOGAN COUNTY COUNTY HIGHWAY 10 OVER LAKE FORK CREEK TRIBUTARY	CROSS SECTIONS		F.A.S. TOTAL SHEETS	SECTION	COUNTY	TOTAL SHEETS	SHEET NO.	
		DRAWN -	REVISED -		566	09-00119-00-BR	LOGAN	17	12			
		CHECKED -	REVISED -		SCALE: 1" = 5'-0"		SHEET NO. 2 OF 7 SHEETS		STA. 67+00.00 TO STA. 67+50.00		CONTRACT NO. 9525	
		DATE -	REVISED -		FED. ROAD DIST. NO. 7 ILLINOIS		FED. AID PROJECT BRS-0666(107)					