

E:\1135 - Other - Old Collinsville Roadway\LA\_CROSS SECTIONS.dwg, 4/7/2009 10:35:48 AM, Raster by MLL

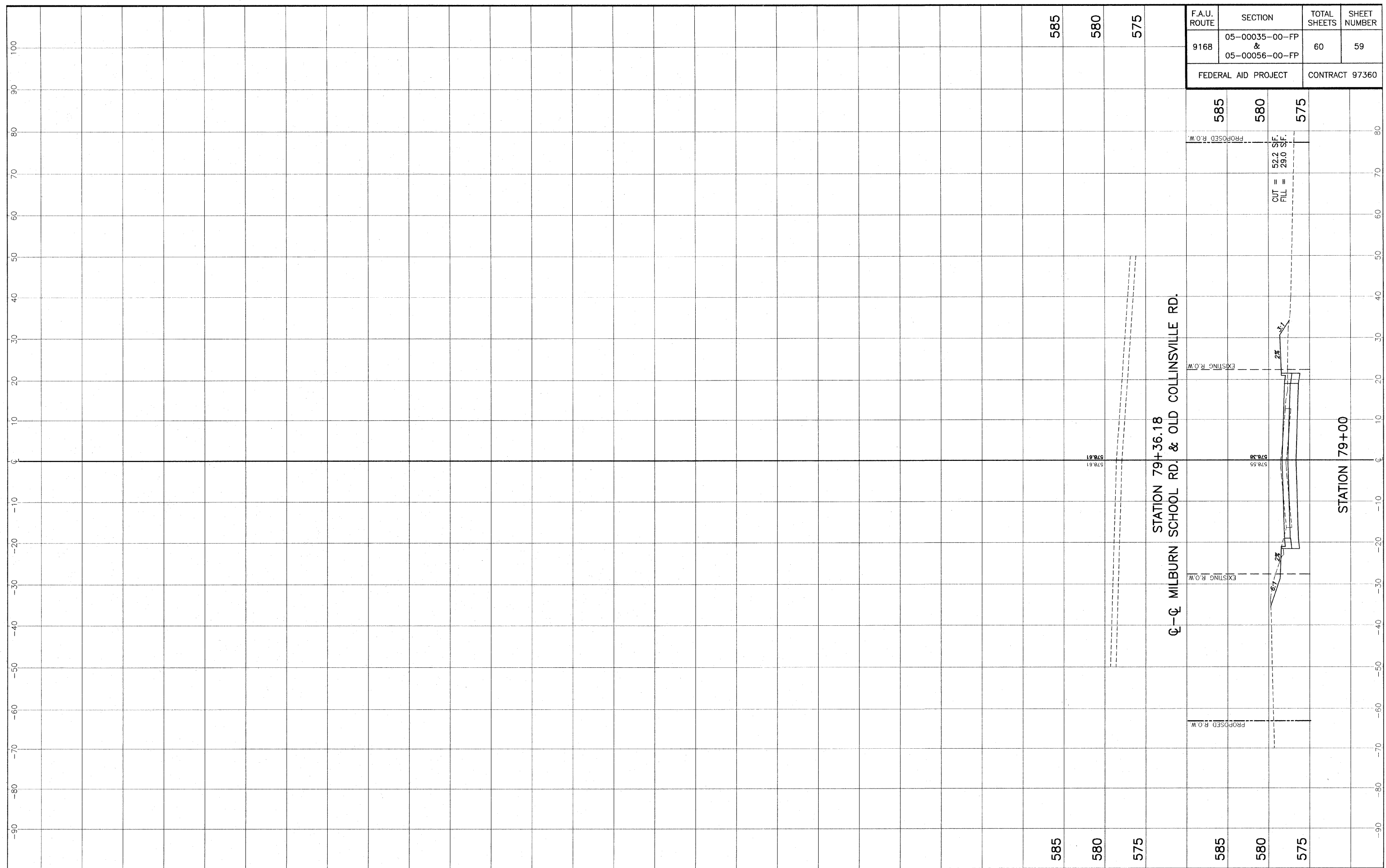

STA. 79+00 - STA. 79+36.18 CROSS SECTIONS - OLD COLLINSVILLE ROAD IMPROVEMENTS  
SECTION 05-00035-00-FP & 05-00056-00-FP ST. CLAIR COUNTY, ILLINOIS