

**GENERAL NOTES**

- WHERE SECTION OR SUBSECTION MONUMENTS ARE ENCOUNTERED, THE ENGINEER SHALL BE NOTIFIED BEFORE SUCH MONUMENTS ARE REMOVED. THE CONTRACTOR SHALL PROTECT AND CAREFULLY PRESERVE ALL PROPERTY MARKERS AND MONUMENTS UNTIL THE OWNER, AN AUTHORIZED SURVEYOR, OR AGENT HAS WITNESSED, OR OTHERWISE REFERENCED THEIR LOCATION.
- EXISTING UNDERGROUND AND ABOVE-GRADE FACILITIES, STRUCTURES, AND UTILITIES HAVE BEEN PLOTTED ON THESE CONTRACT DOCUMENTS BASED UPON THE INFORMATION AND SURVEYS AVAILABLE AT THE TIME OF DRAWING PREPARATION. THE LOCATION OF THESE FEATURES MUST, THEREFORE, BE CONSIDERED APPROXIMATE ONLY. IN ADDITION, THERE MAY BE OTHER FACILITIES, STRUCTURES, AND UTILITIES WHICH DID NOT EXIST (OR THE EXISTENCE OF WHICH WAS NOT KNOWN) AT THE TIME OF DRAWING PREPARATION. IT IS THE SOLE RESPONSIBILITY OF THE CONTRACTOR(S) TO HAVE ALL EXISTING FACILITIES, STRUCTURES, AND UTILITIES LOCATED IN THE FIELD PRIOR TO ANY EXCAVATION OR CONSTRUCTION ACTIVITY; AND TO PROTECT ALL SUCH EXISTING FEATURES (EXCEPT THOSE SPECIFICALLY NOTED FOR REMOVAL OR DEMOLITION) DURING CONSTRUCTION.
- THE THICKNESS OF BITUMINOUS MIXTURE SHOWN ON THE PLANS IS THE NOMINAL THICKNESS. DEVIATIONS FROM THE NOMINAL THICKNESS WILL BE PERMITTED WHEN SUCH DEVIATIONS OCCUR DUE TO IRREGULARITIES IN THE EXISTING SURFACE OR BASE ON WHICH THE BITUMINOUS MIXTURE IS PLACED.
- FACTORS USED FOR ESTIMATING PLAN QUANTITIES ARE AS FOLLOWS AND SHALL NOT BE USED FOR THE BASIS OF FINAL QUANTITIES:
 

HOT MIX ASPHALT SURFACE COURSE	0.056	TON/SQ YD/IN	
LIME (LIME MODIFIED SOILS)	0.02	TON/SQ YD / FT THICK	
AGGREGATE (SURFACE, BASE, & BACKFILL)	2.05	TON/CU YD	
BITUMINOUS MATERIALS:			
PRIME COAT FOR HOT MIX ASPHALT:			
- ON PAVEMENT	0.05	GAL/SQ YD	
AGGREGATE (PRIME COAT)			
- ON EXISTING PAVEMENT	0.002	TON/SQ YD	
RIP RAP	1.5	TON/CU YD	
TEMPORARY EROSION CONTROL SEEDING	100	LB/ACRE	
NITROGEN FERTILIZER NUTRIENT	90	LB/ACRE	
PHOSPHORUS FERTILIZER NUTRIENT	90	LB/ACRE	
POTASSIUM FERTILIZER NUTRIENT	90	LB/ACRE	
MULCH	2	TON/ACRE	
- TREES SHALL BE PRESERVED THROUGHOUT THIS SECTION AS SHOWN ON THE PLANS AND AS DIRECTED BY THE ENGINEER. TREES OUTSIDE THE CLEAR ZONE, AND WHICH DO NOT INTERFERE WITH CONSTRUCTION, SHALL NOT BE DISTURBED.
- ALL CULVERT EXTENSIONS SHALL BE CONSTRUCTED IN ACCORDANCE WITH METHOD II AS SPECIFIED IN ARTICLE 542.05 OF THE STANDARD SPECIFICATIONS. PRIOR TO EXTENDING ANY CULVERT, THE ENTIRE LENGTH OF THE EXISTING CULVERT SHALL BE CLEANED OF ALL EARTH AND DEBRIS BY THE CONTRACTOR TO THE SATISFACTION OF THE ENGINEER. THE COST OF THIS WORK SHALL BE INCLUDED IN THE COST OF THE EXTENSION.
- THE ENGINEER SHALL BE THE SOLE JUDGE CONCERNING CURING TIME FOR THE VARIOUS BITUMINOUS LIFTS.
- FOR STABILIZATION, ALL TYPE III BARRICADES SHALL REQUIRE A MINIMUM OF FOUR SANDBAGS PER BARRICADE.
- BEFORE ORDERING STORM SEWERS, CATCH BASINS, PIPE CULVERTS, PIPE DRAINS, MANHOLES, INLETS, AND BOX CULVERTS, THE CONTRACTOR SHALL CONTACT THE ENGINEER AS TO THE EXACT LENGTH AND QUANTITY REQUIRED.
- THE STATE PLANE COORDINATE SYSTEM HAS BEEN USED FOR THE HORIZONTAL CONTROL.
- ALL ELEVATIONS SHOWN ON THE PLANS ARE BASED ON U. S. G. S. MEAN SEA LEVEL DATUM.
- SEEDING SHALL BE DONE ON ALL AREAS THAT ARE DISTURBED BY CONSTRUCTION OPERATIONS AS DIRECTED BY THE ENGINEER. SEEDING SHALL BE PAID FOR ONLY WITHIN THE PROPOSED RIGHT-OF-WAY OR EASEMENT LIMITS. ALL AREAS DISTURBED BY THE CONTRACTOR OUTSIDE THE PROPOSED CONSTRUCTION LIMITS SHALL BE SEED AS DIRECTED BY THE ENGINEER, AT THE CONTRACTOR'S EXPENSE.
- ALL DRAINAGE STRUCTURES SHALL BE DELIVERED TO THE PROJECT SITE WITHOUT SILT, DEBRIS, OR OTHER SUCH OBSTRUCTIONS AT THE TIME OF FINAL INSPECTION. THE CLEANING OF THESE DRAINAGE STRUCTURES SHALL BE INCLUDED IN THE VARIOUS PAY ITEMS INVOLVED.
- THE ENGINEER SHALL BE CONTACTED AND PRIOR APPROVAL OBTAINED FOR ANY TREE REMOVAL BEYOND THE LIMITS/LOCATIONS INCLUDED IN THE PLANS.
- ALL CONSTRUCTION WARNING SIGNS SHALL BE 48" FLUORESCENT ORANGE.
- STRAW BALES, HAY BALES, PERIMETER EROSION BARRIER, AND SILT FENCES WILL NOT BE PERMITTED FOR TEMPORARY OR PERMANENT DITCH CHECKS. DITCH CHECKS SHALL BE COMPOSED OF AGGREGATE, SILT PANELS, ROLLED EXCELSIOR, SILT WEDGES, OR ANY OTHER MATERIAL APPROVED BY THE ENGINEER.
- ANY FACILITIES OR APPURTENANCES WHICH ARE THE PROPERTY OF ANY PUBLIC UTILITY LOCATED WITHIN THE LIMITS OF CONSTRUCTION SHALL BE RELOCATED OR ADJUSTED BY THEIR RESPECTIVE OWNERS. THE CONTRACTOR SHALL NOTIFY AND COOPERATE WITH THE OWNERS OF ANY SUCH FACILITY IN THEIR REMOVAL AND REARRANGEMENT OPERATIONS IN ORDER THAT THESE OPERATIONS AND THE CONSTRUCTION OF THIS PROJECT MAY PROGRESS IN A REASONABLE MANNER.
- THE REMOVAL OF AGGREGATE AND OIL & CHIP SURFACES IS INCLUDED IN THE COST OF EARTH EXCAVATION.
- THE FOLLOWING UTILITY COMPANIES MAY HAVE FACILITIES LOCATED WITHIN THE LIMITS OF CONSTRUCTION WHICH MAY REQUIRE ADJUSTMENTS, RELOCATION OR REMOVAL.

FRONTIER COMMUNICATIONS 801 WEST JACKSON STREET ALTAMONT, IL 62411 (618) 483-6205	AMEREN IP 2610 BROADWAY P. O. BOX 868 MT. VERNON, IL 62864 (618) 244-8271
ATTN: ROD ELLER	ATTN: MIKE TATLOCK

**COMMITMENTS**

NONE

**ALIGNMENT TIES**

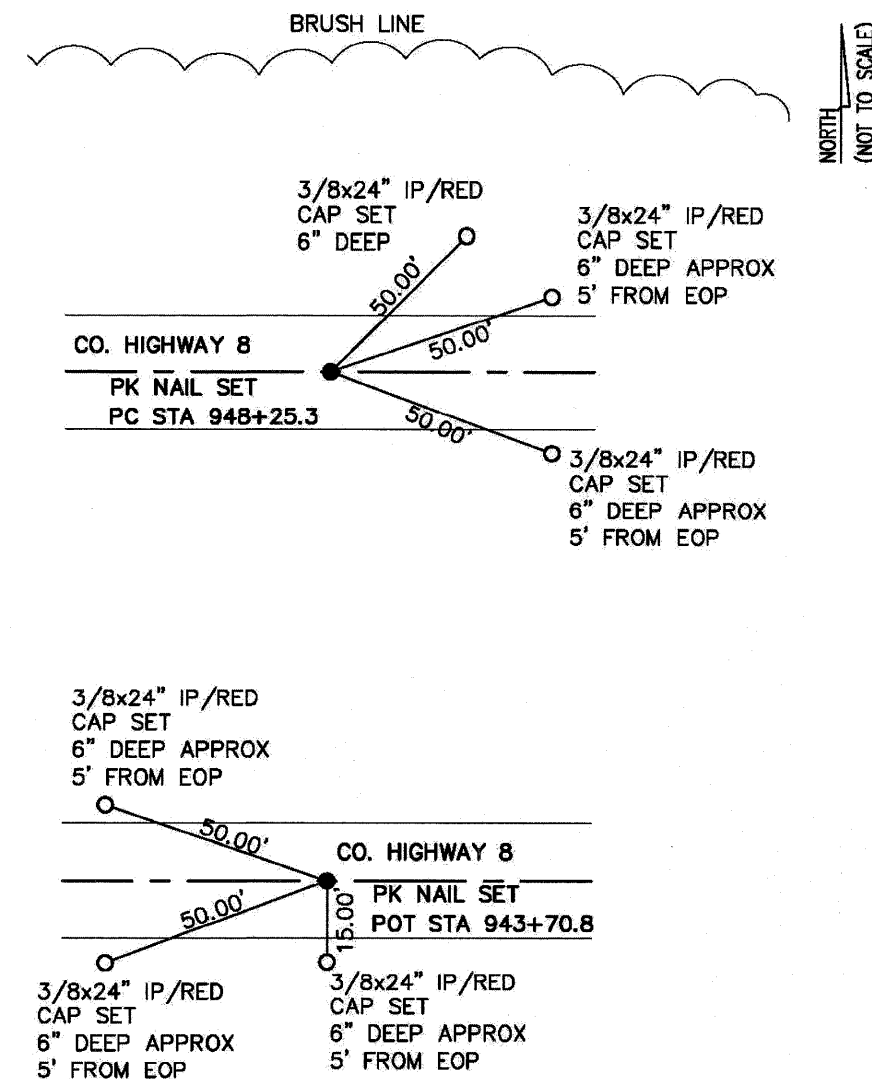

**MIXTURE DESIGNS**

HOT-MIX ASPHALT MIXTURES REQUIREMENT TABLE			
MIXTURE USE(S):	HOT-MIX ASPHALT SURFACE COURSE	HOT-MIX ASPHALT BINDER COURSE	HOT-MIX ASPHALT SHOULDERS
AC/PG:	PG 64-22	PG 64-22	PG 58-22
RAPZ (MAX): **	0%	10%	20%
DESIGN AIR VOIDS:	4.0% @ Ndes=70	4.0% @ Ndes=70	2.0% @ Ndes=30
MIXTURE COMPOSITION (GRADATION MIXTURE):	IL 12.5	IL 19.0	
FRICITION AGGREGATE	MIXTURE "C"		BAM

\*\* FOR RAPZ GREATER THAN 15%, BOTH THE HIGH AND LOW TEMPERATURES OF THE BINDER SHOULD BE DECREASED

LAST SAVED = 1/20/2010 10:27:00 AM  
PLOT DRIVER = TR:\pco6284\Tc\F11c.plt

FILE NAME =	USER NAME = bschmidt	DESIGNED -	REVISED -
\\10986300\oad\construction\plans\002\GeneralNotes.dgn		DRAWN -	REVISED -
	PLOT SCALE = 50.0023 ' / IN.	CHECKED -	REVISED -
	PLOT DATE = 1/26/2010 10:27:00 AM	DATE -	REVISED -



**WASHINGTON COUNTY HIGHWAY DEPARTMENT**

**GENERAL NOTES, COMMITMENTS, AND MIXTURE DESIGNS**

SCALE: SHEET NO. OF SHEETS STA. TO STA.

F.A.S. 836  
COUNTY HIGHWAY 8  
CONTRACT NO. 97402  
SECTIONS 07-00077-01-BR

TOTAL SHEETS	SHEET NO.
27	2