

F.A.U. RTE.	SECTION	COUNTY	TOTAL SHEETS	SHEET NO.
9173	04-00080-06-PV	ST. CLAIR	144	9
STA.		TO STA.		
FED. ROAD DIST. NO.	ILLINOIS	FED. AID PROJECT		
PROPOSED TYPICAL SECTIONS				

CONTRACT NO: 97418

### LEGEND

- ① EXISTING AGGREGATE BASE
- ② EXISTING BITUMINOUS SURFACE
- ③ EXISTING COMBINATION CONCRETE CURB & GUTTER TYPE B-6.24
- ④ EXISTING ASPHALT PAVEMENT, 11"
- ⑤ PROPOSED PROCESSING MODIFIED SOIL, 12"
- ⑥ PROPOSED SUB-BASE GRANULAR MATERIAL, TYPE A, 4"
- ⑦ PROPOSED PCC PAVEMENT, 9", TYPE A FINAL FINISH (SEE HIGHWAY STANDARD 420601)
- ⑧ PROPOSED PAVEMENT FABRIC
- ⑨ PROPOSED SAWED LONGITUDINAL JOINT OR LONGITUDINAL CONSTRUCTION JOINT (SEE HIGHWAY STANDARD 420001)
- ⑩ PROPOSED CONCRETE GUTTER, TYPE A (SEE HIGHWAY STANDARD 606101)
- ⑪ PROPOSED HOT-MIX ASPHALT SHOULDER, 8"
- ⑫ PROPOSED AGGREGATE SHOULDER, TYPE B
- ⑬ PROPOSED COMBINATION CONCRETE CURB & GUTTER TYPE B-6.24 (SEE HIGHWAY STANDARD 606001)
- ⑭ PROPOSED HOT-MIX ASPHALT PAVEMENT (FULL DEPTH), 6" (1 1/2" SURFACE COURSE, 4 1/2" BINDER COURSE) (INITIAL BINDER LIFT THICKNESS 2 1/4")
- ⑮ PROPOSED BITUMINOUS MATERIALS PRIME COAT & AGGREGATE PRIME COAT
- ⑯ PROPOSED SUB-BASE GRANULAR MATERIAL, TYPE A, 8"
- ⑰ PROPOSED HOT-MIX ASPHALT BASE COURSE, 7"
- ⑱ PROPOSED HOT-MIX ASPHALT REMOVAL, 1 1/2"
- ⑲ PROPOSED HOT-MIX ASPHALT SURFACE COURSE, MIX "C", N70, 1 1/2"
- ⑳ PROPOSED AGGREGATE SHOULDERS, TYPE A, 6"

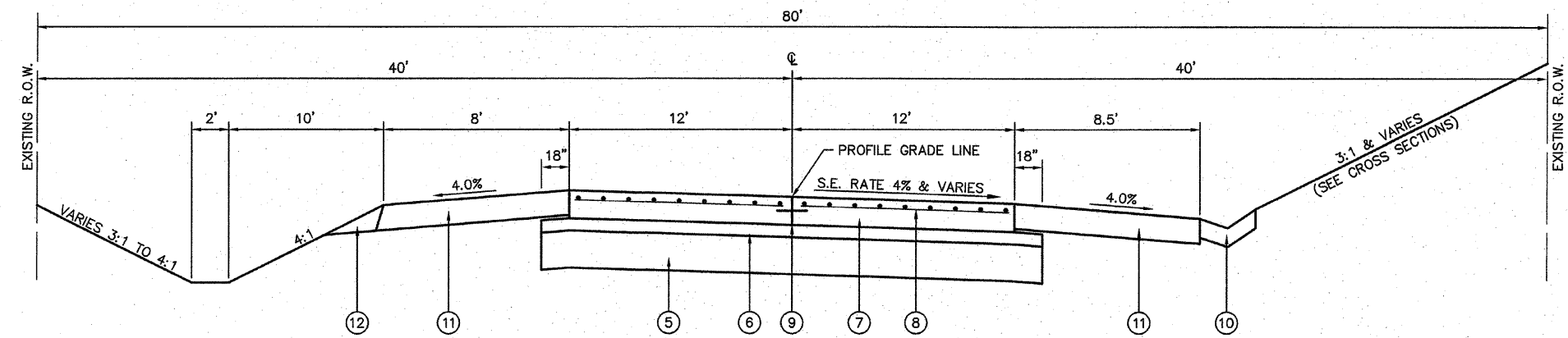

### PROPOSED O'FALLON-TROY ROAD SUPERELEVATED SECTION

STA. 138+17.66 TO STA. 139+45.07  
(NOT TO SCALE)

S/E TRANSITION OCCURS BETWEEN  
STA. 139+41.81 TO STA. 140+55.81

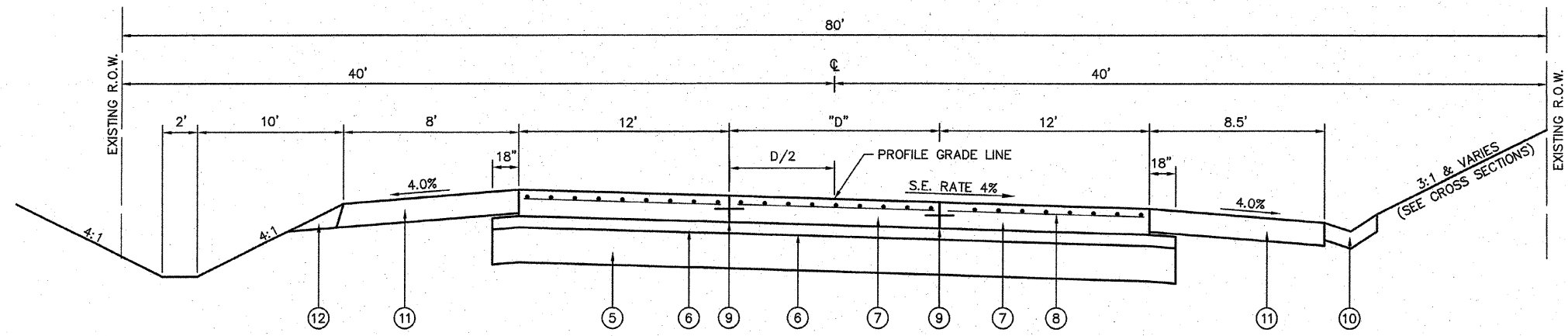

### PROPOSED O'FALLON-TROY ROAD SUPERELEVATED SECTION

STA. 131+80.55 TO STA. 135+77.66 D = 12'  
STA. 135+77.66 TO STA. 138+17.66 D = VARIES 12' TO 0'  
(NOT TO SCALE)

FINAL SURVEY	DATE
SURVEYED	
PLOTTED	
NOTE BOOK	
TEMPLATE	
AREAS	
CHECKED	
NO.	

ORIGINAL SURVEY	DATE
SURVEYED	
PLOTTED	
NOTE BOOK	
TEMPLATE	
AREAS	
CHECKED	
NO.	