

F.A. RTE.	SECTION	COUNTY	TOTAL SHEETS	SHEET NO.
9173	04-00080-06-PV	ST. CLAIR	144	37
STA.		TO STA.		
FED. ROAD DIST. NO.	ILLINOIS	FED. AID PROJECT		

TRAFFIC CONTROL PLANS
CONTRACT NO: 97418

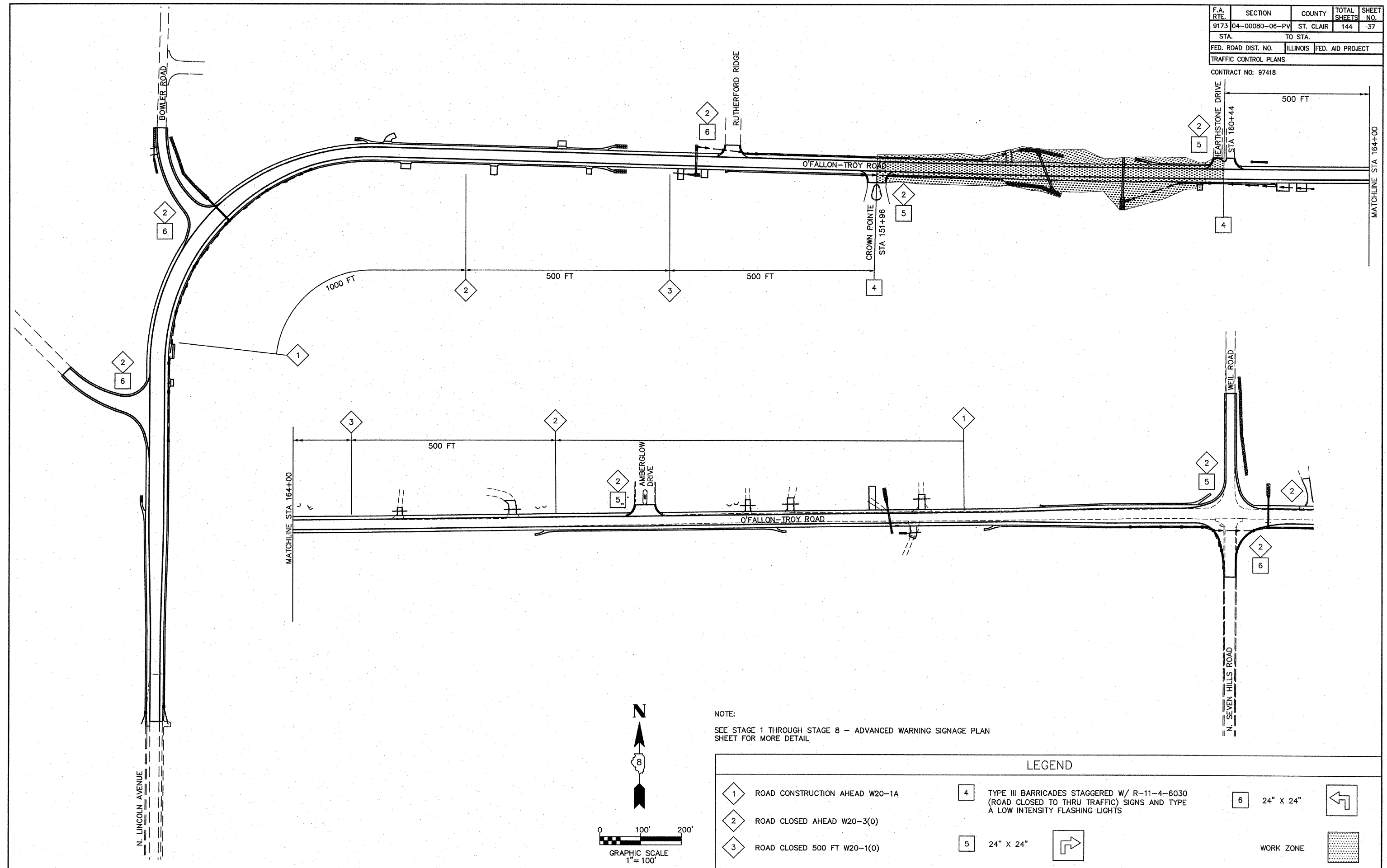

NOTE:
SEE STAGE 1 THROUGH STAGE 8 - ADVANCED WARNING SIGNAGE PLAN SHEET FOR MORE DETAIL

LEGEND

- | | | | | | |
|---|--------------------------------|---|---|-----------|-----------|
| 1 | ROAD CONSTRUCTION AHEAD W20-1A | 4 | TYPE III BARRICADES STAGGERED W/ R-11-4-6030 (ROAD CLOSED TO THRU TRAFFIC) SIGNS AND TYPE A LOW INTENSITY FLASHING LIGHTS | 6 | 24" X 24" |
| 2 | ROAD CLOSED AHEAD W20-3(0) | 5 | 24" X 24" | WORK ZONE | |
| 3 | ROAD CLOSED 500 FT W20-1(0) | | | | |