

PLAN

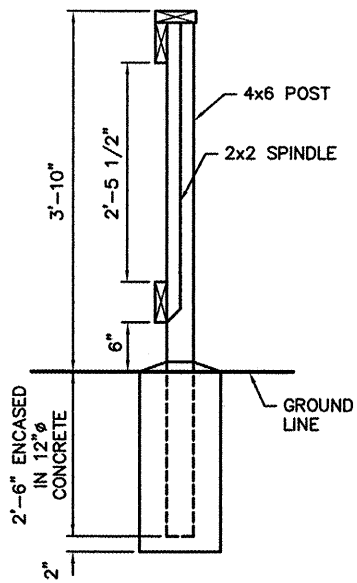

SECTION A-A

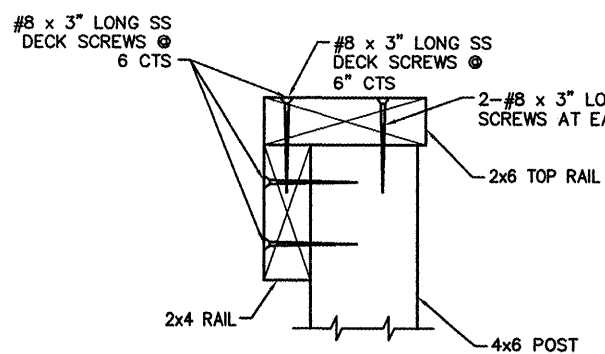

SECTION C-C

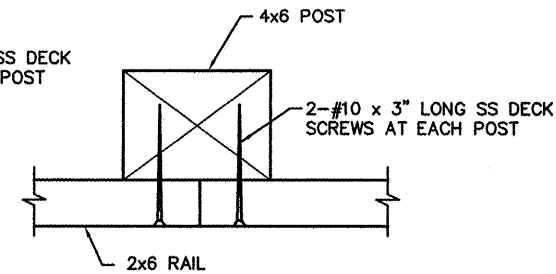

SECTION D-D

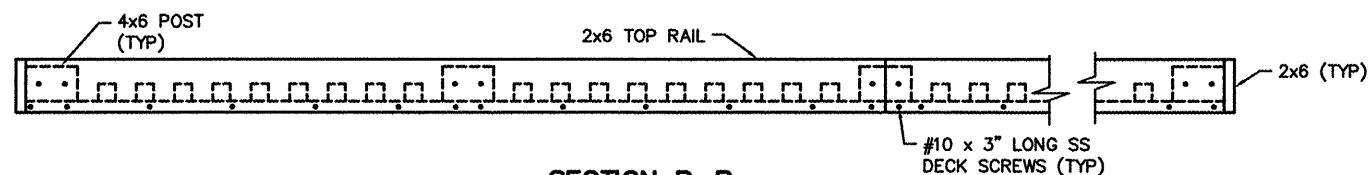

SECTION B-B

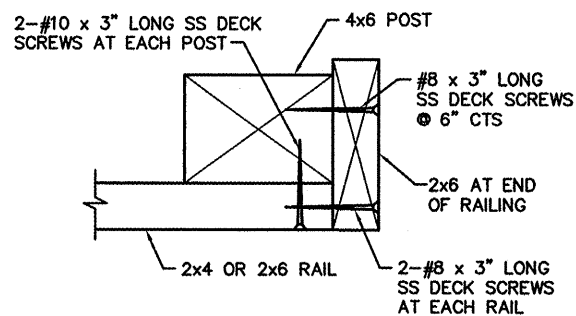

SECTION E-E

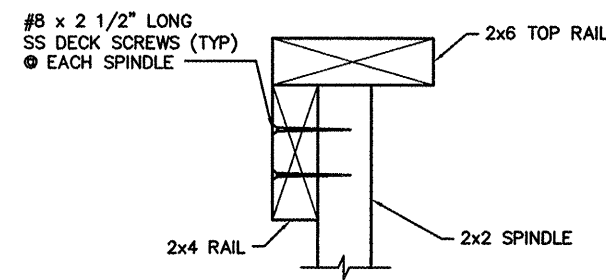

SECTION F-F

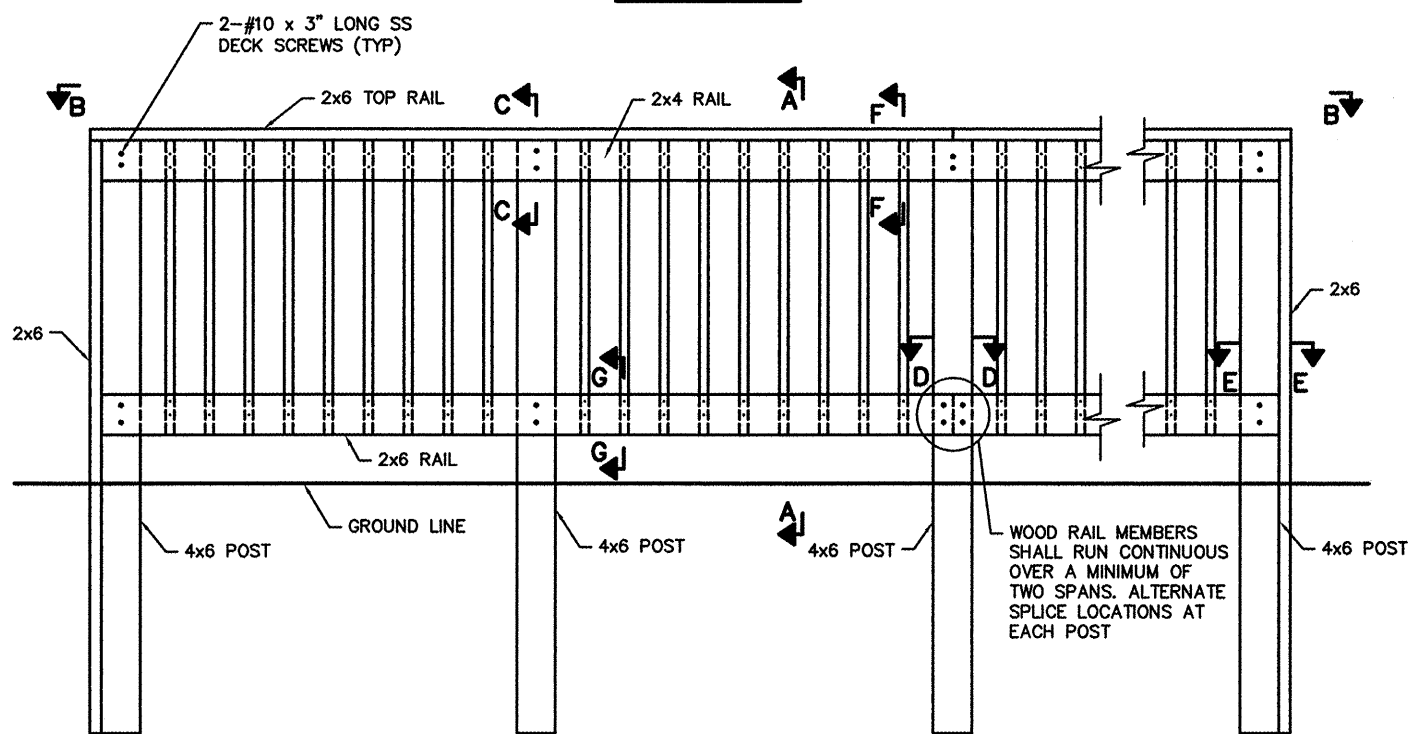

INSIDE RAIL ELEVATION

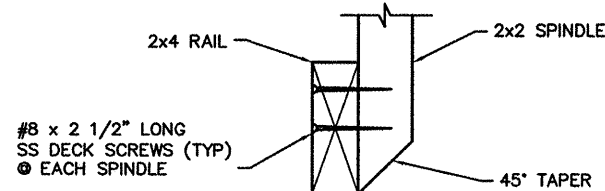

SECTION G-G

RAIL NOTES

1. DECK SCREWS SHALL BE STAINLESS STEEL (SS) AND SHALL HAVE FLAT HEADS WITH AFOR APPROVAL PRIOR TO ORDERING MATERIALS. SQUARE DRIVE. PREDRILL HOLES TO RECEIVE DECK SCREWS.
2. ALL LUMBER SIZES SHOWN ARE NOMINAL DIMENSIONS.
3. ALL LUMBER SHALL BE SURFACED ON FOUR SIDES.
4. ALL TREATED TIMBER MEMBERS SHALL COMPLY WITH THE REQUIREMENTS FOR NO. 1 DENSE SR 1550 F FOR SOUTHERN PINE OR NO. 1 DENSE 1400 F FOR DOUGLAS FIR AND HAVE A PRESERVATIVE TREATMENT IN ACCORDANCE WITH SECTION 1007.12 OF THE STANDARD SPECIFICATIONS. RAILS SHALL HAVE A MINIMUM RETENTION OF 0.25 POUNDS PER CUBIC FOOT AND POSTS SHALL HAVE A MINIMUM RETENTION OF 0.40 POUNDS PER CUBIC FOOT. EACH MEMBER SHALL CARRY A GRADE STAMP AND QUALITY ASSURANCE STAMP INDICATING CLASS OF TIMBER AND CHEMICAL RETENTION
5. WOOD POSTS SHALL BE PLACED IN THE CONCRETE FOUNDATION TO A DEPTH OF 2.5 FT. AFTER PLACEMENT IN THE FOUNDATION, THE POST SHALL BE SHIMMED AS NECESSARY WITH WOODEN WEDGES INSERTED BETWEEN THE POSTS AND THE SIDES OF THE FOUNDATION SO AS TO SECURELY HOLD THE POST IN A VERTICAL POSITION TO THE SATISFACTION OF THE ENGINEER. PLACEMENT OF THE CONCRETE SHALL BE INCLUDED IN THE COST OF THE FENCE RAIL.

WOOD FENCE DETAIL
NOT TO SCALE

FILE NAME = 841DT01.DWG

USER NAME = ASHLEIGH ENGELMANN	DESIGNED - TLC	REVISED -
PLOT SCALE = 6" = 1'	DRAWN - AME	REVISED -
PLOT DATE = 2010-02-26	CHECKED - TGV	REVISED -
	DATE - 2009-02-26	REVISED -

STATE OF ILLINOIS
DEPARTMENT OF TRANSPORTATION

WOOD FENCE DETAILS

SCALE: SHEET NO. 1 OF 1 SHEETS STA. TO STA.

F.A. RTE.	SECTION	COUNTY	TOTAL SHEETS	SHEET NO.
	08-00006-00-BT	MADISON	26	16
MORRIS BIKE TRAIL		CONTRACT NO. 97436		
FED. ROAD DIST. NO.	ILLINOIS	FED. AID PROJECT		