

4+50

C = 0.0
F = 72.0

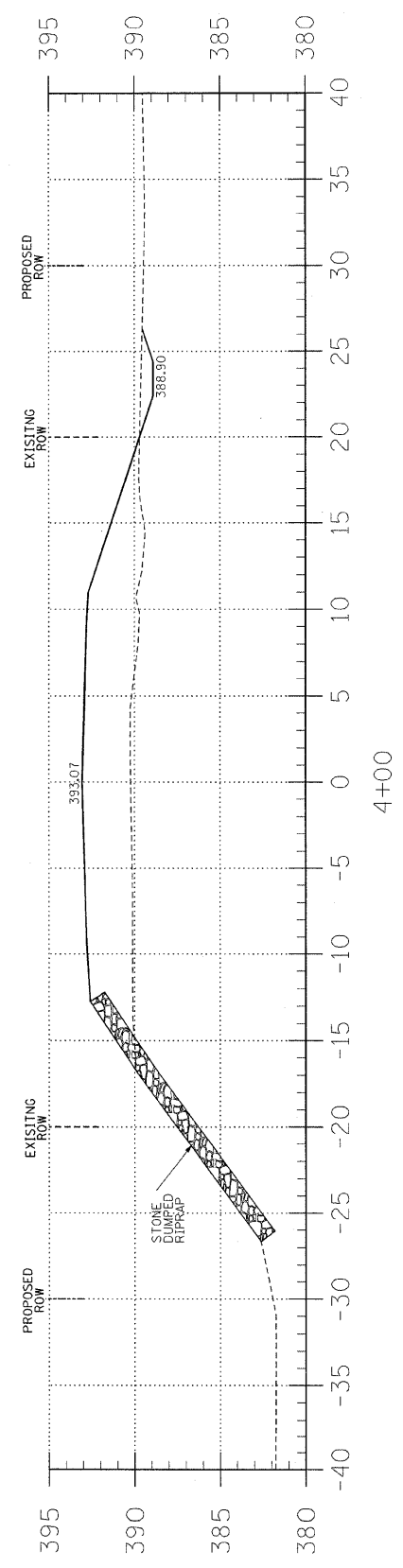

4+00

C = 2.9
F = 83.3

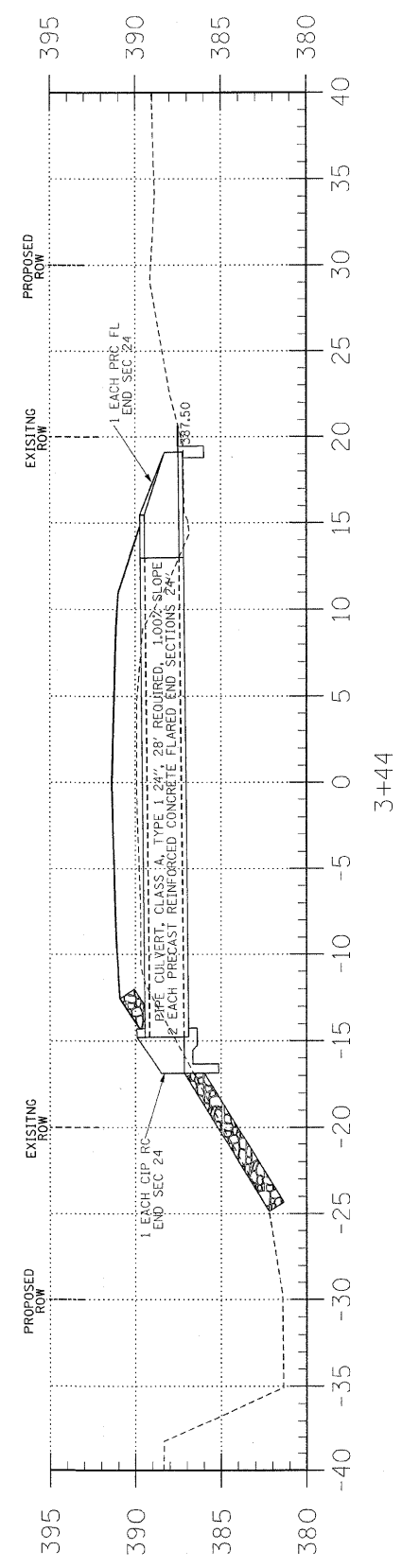

3+44

C = 5.6
F = 42.4

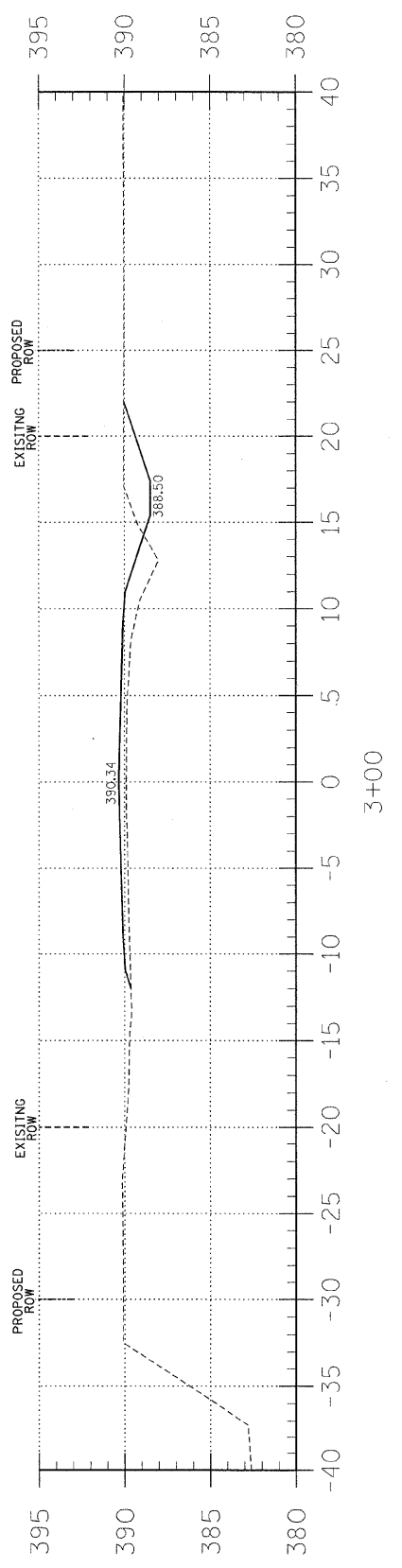

3+00

C = 6.7
F = 13.1

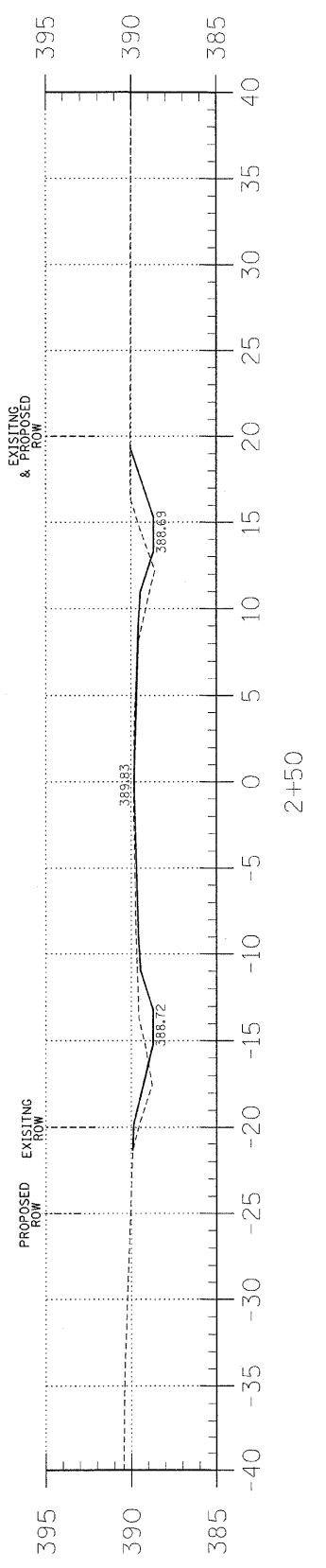

2+50

C = 7.9
F = 3.3

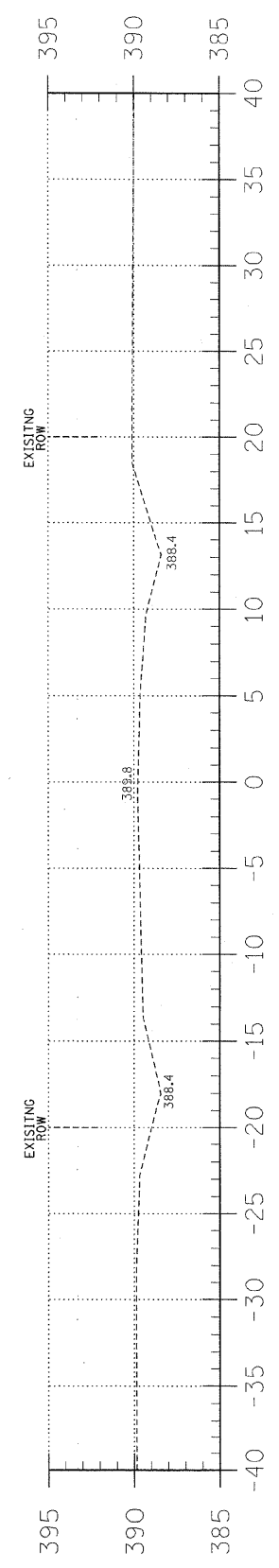

2+00

EARTHWORK SCHEDULE

LOCATION	EARTH EXCAVATION CUBIC YARD	CHANNEL EXCAVATION CUBIC YARD	ESTIMATED UNSUITABLE MATERIAL CUBIC YARD	SUITABLE MATERIAL ADJUSTED FOR SHRINKAGE CUBIC YARD	EMBANKMENT CUBIC YARD	EARTHWORK BALANCE WASTE (+) OR SHORTAGE (-) CUBIC YARD
STA 0+00 TO 4+74.3	42.8	0.0	0.0	32.1	375.5	-343.4
STA 4+74.3 TO 5+25.7	0.0	245.0	122.5	92.0	0.0	+92.0
STA 5+25.7 TO 10+00	89.2	0.0	0.0	66.9	453.3	-386.4
2 PRIVATE ENTRANCE & 1 FIELD ENTRANCE	0.0	0.0	0.0	0.0	89.2	-89.2
TOTAL	132.0	245.0	122.5	191.0	918.0	-727.0

TR	SECTION	COUNTY	TOTAL SHEETS	SHEET NO.
128	06-08134-00-BR	WHITE	12	3
FED. ROAD DIST. NO. 9 ILLINOIS		CREEK		
PROJECT * BR05-193(30)		CONTRACT * 99373		
LEC JOB # HB81014WH				

323 W. 3RD ST.
P.O. BOX 160
MT. CARMEL, IL
62863
PHONE:
(618)-262-8651
FAX:
(618)-263-3327

405 W. STATE ST.
SUITE 1
PRINCETON, IN
47670
PHONE:
(812)-386-7611
FAX:
(812)-386-2812



PROFESSIONAL DESIGN FIRM
LAND SURVEY & PROFESSIONAL ENGINEERING CORPORATION
184-000887
(62-032435)(35-002769)



AARON M. MEFFORD
NAME
SIGNATURE
DATE
1-13-10
11-30-11 EXPIRES

TOWNSHIP ROUTE 128
OVER CREEK
WHITE COUNTY, ILLINOIS

SHEET TITLE:

CROSS-SECTIONS

SCALE: 1" = 5'

BY: AMM

DATE: 10/00

REV:

3 OF 12 SHEETS

SHEET NO. 3