

STATE OF ILLINOIS
DEPARTMENT OF TRANSPORTATION
DIVISION OF HIGHWAYS

PLANS FOR PROPOSED
FEDERAL AID HIGHWAY
F.A. ROUTE 51 (S.B.I. ROUTE 146)
SECTION 107RS-2; 110RS-1
JOHNSON COUNTY

C-99-412-74

INDEX OF SHEETS - SHEET NO. 2
SUMMARY OF QUANTITIES - SHEET NO. 2

ROUTE	SECTION	COUNTY	TOTAL SHEETS	SHEET NO.
F.A. 51	*	JOHNSON	6	1
ILLINOIS PROJECT				
* 107RS-2; 110RS-1				
P-99-014-74				

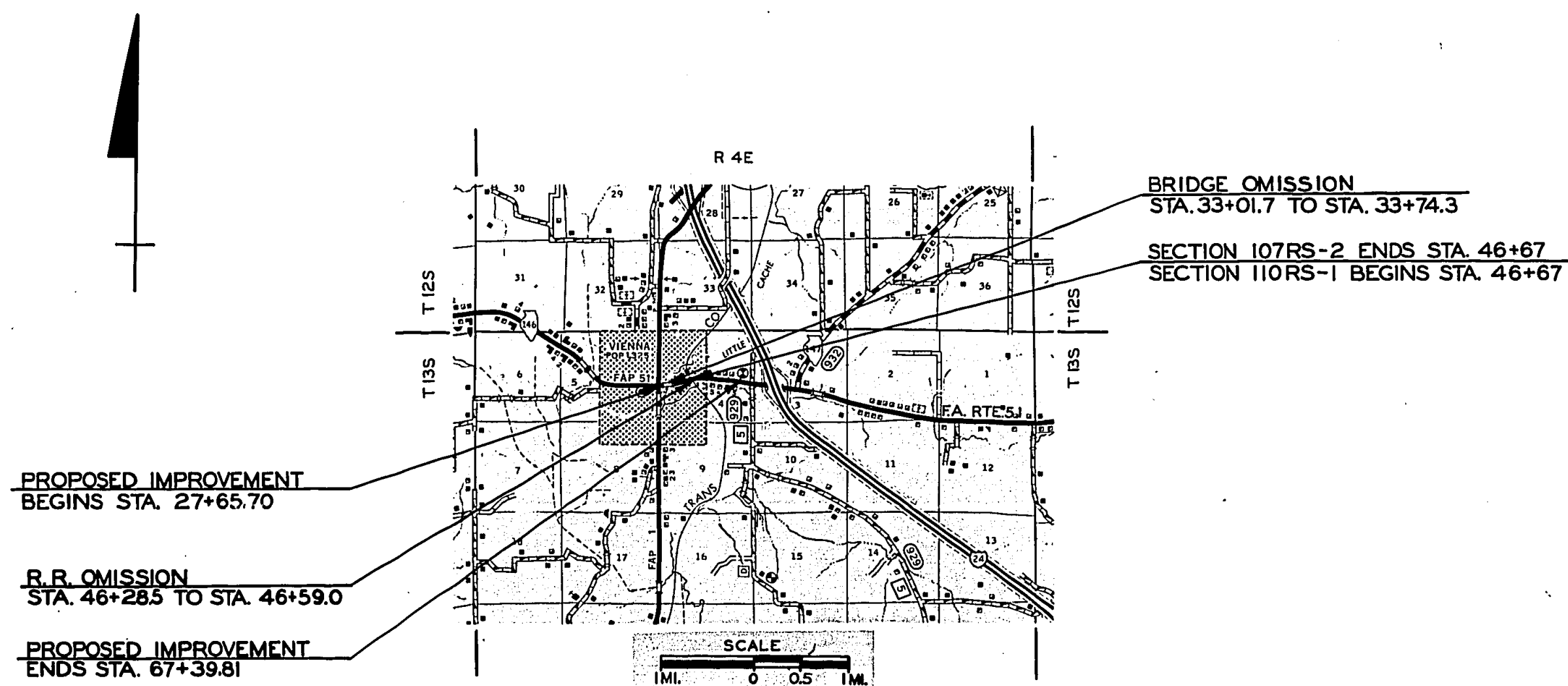
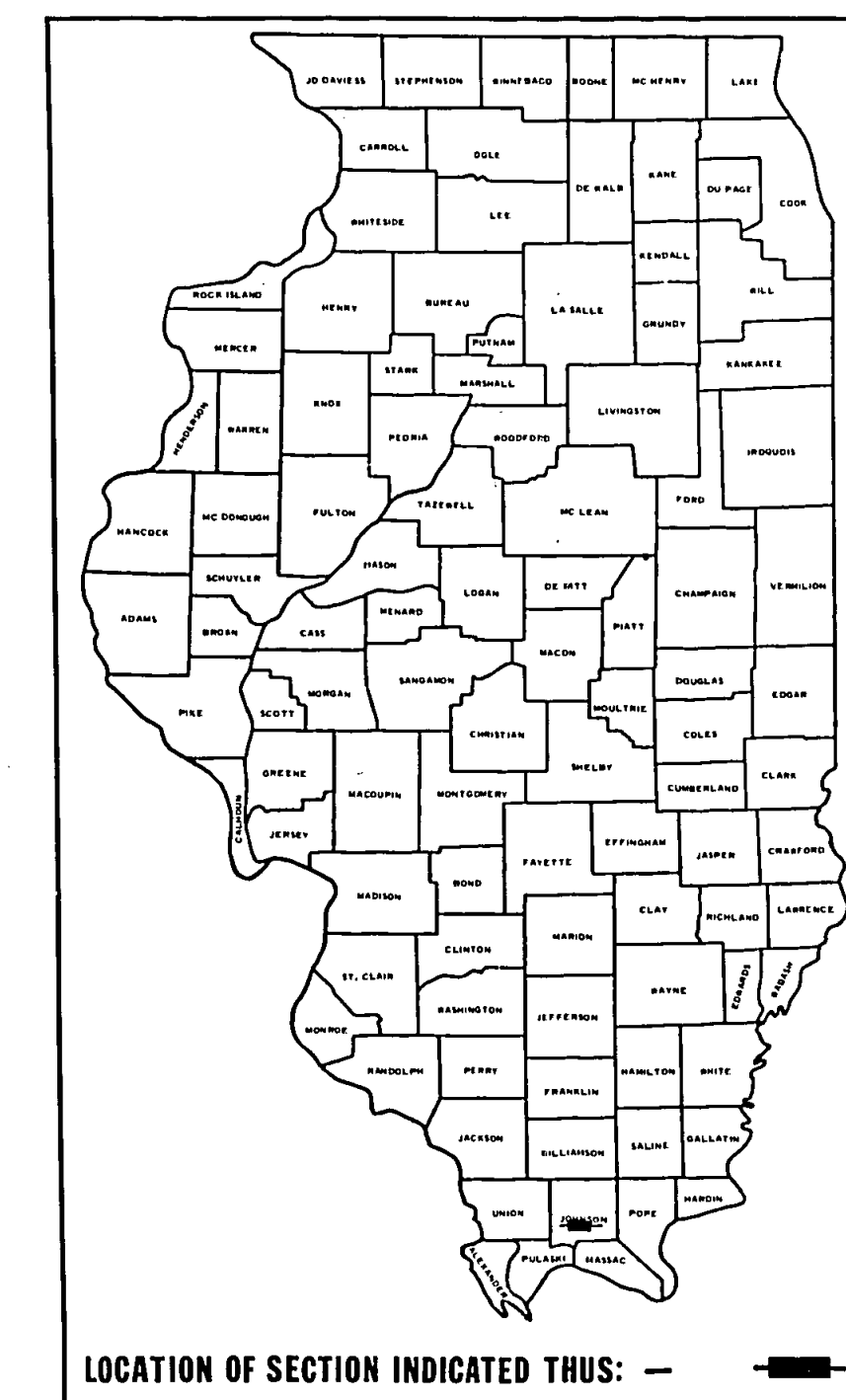

NET LENGTH SECTION 107RS-2 = 1798.20 FT = .340 MI.
NET LENGTH SECTION 110RS-1 = 2072.81 FT = .393 MI.
NET LENGTH IMPROVEMENT = 3871.01 FT = .733 MI.

STATE OF ILLINOIS
DEPARTMENT OF TRANSPORTATION
DIVISION OF HIGHWAYS

SUBMITTED June 3 1974

EXAMINED July 10 1974

PASSED July 10 1974

APPROVED July 10 1974

DISTRICT ENGINEER
ENGINEER OF PLANS AND CONTRACTS
ENGINEER OF DESIGN
DIRECTOR OF HIGHWAYS

CONTRACT NO. 80205

JOHNSON COUNTY SECTION 107RS-2; 110RS-1 F. A. ROUTE 51

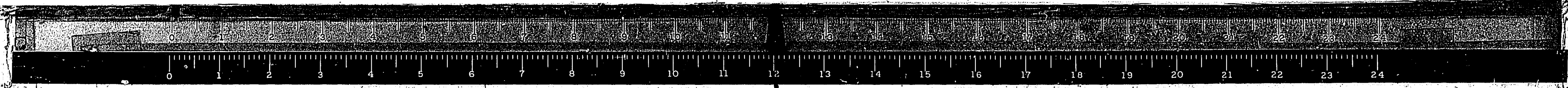

TYPICAL SECTION

ROUTE NO.	SEC.	COUNTY	TOTAL SHEETS	SHEET NO.
F.A. 51	*	JOHNSON	6	2
FED. ROAD DIST. NO.	ILLINOIS	PROJECT		
*Section 107RS-2; 110RS-1				

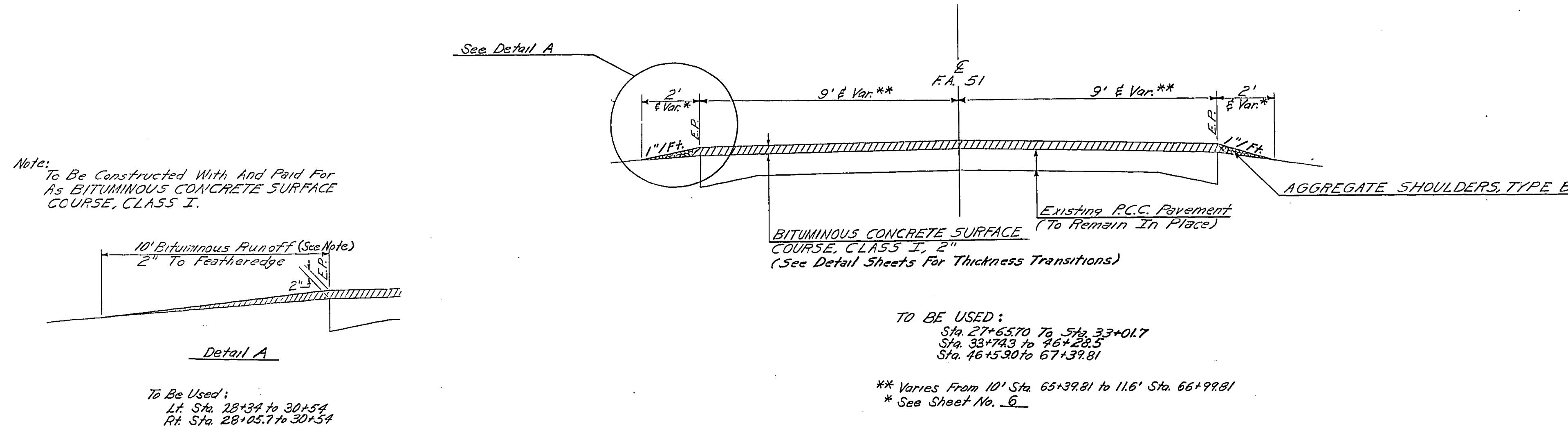

THE THICKNESS OF BITUMINOUS MIXTURE SHOWN ON THE PLANS IS THE NOMINAL THICKNESS. DEVIATIONS FROM THE NOMINAL THICKNESS WILL BE PERMITTED WHEN SUCH DEVIATIONS OCCUR DUE TO IRREGULARITIES IN THE EXISTING SURFACE OR BASE ON WHICH THE BITUMINOUS MIXTURE IS PLACED.

SUMMARY OF QUANTITIES

LOCATION OF WORK				Sec. 107RS-2	Sec. 110RS-1
				Sta. 27+65.70 to Sta. 46+67	Sta. 46+67 to Sta. 67+39.81
Construction Type Code				6706	6706
Code No.	Item	Unit	Total Quantity	Quantity	Quantity
215004	Aggregate Shoulders, Type B	Ton	173	75	98
406001	Bituminous Materials (Prime Coat)	Gal.	957	395	564
406003	Aggregate (Prime Coat)	Ton	14	7	7
406004	Mixture For Cracks, Joints, and Flangeways	Ton	5	2	3
406008	Bituminous Concrete Surface Course, Class I	Ton	1,014	454	560
620004	Pavement Removal & Replacement, Type I, 9 inch	Sq. Yd.	183	85	98
620005	Pavement Removal & Replacement, Type II, 7 inch	Sq. Yd.	206	96	110
620006	Pavement Removal & Replacement, Type III, 5 inch	Sq. Yd.	72	34	38
X64701	Pavement Marking Tape	Lin. Ft.	312	144	168
Z10588	Removal Of Existing Excess Bitumen	Unit	38	18	20
XZ1087	Traffic Control & Protection, Standard 2312	L. Sum	1	0.5	0.5

GENERAL NOTES

STANDARDS IN THE PLANS: THE STANDARDS WITH THE REVISION NUMBER LISTED IN THE INDEX OF SHEETS INCLUDED IN THE PLANS SHALL HOLD PRECEDENCE OVER STANDARD NUMBERS LISTED IN SPECIAL PROVISIONS OR PLANS OF THIS CONTRACT.

QUANTITIES USED FOR ESTIMATING:
 0.112 TON/SQ. YD. BITUMINOUS CONCRETE SURFACE COURSE, CLASS I, 2" THICK
 0.09 GAL./SQ. YD. BITUMINOUS MATERIALS (PRIME COAT) ON EXISTING PAVEMENT
 0.32 GAL./SQ. YD. BITUMINOUS MATERIALS (PRIME COAT) ON SIDE APPROACHES
 0.0015 TON/SQ. YD. AGGREGATE (PRIME COAT)

THE ACTUAL AMOUNT OF PRIME AND AGGREGATE APPLIED SHALL BE AS DIRECTED BY THE ENGINEER.

IT IS NOT THE INTENT THAT ANY LEVELING BINDER BE REQUIRED; HOWEVER, IF PAVEMENT LEVELING IS DEEMED NECESSARY BY THE ENGINEER IT SHALL BE ACCOMPLISHED WITH BITUMINOUS CONCRETE SURFACE COURSE AND PAID FOR AT THE CONTRACT UNIT RATE PER TON FOR BITUMINOUS CONCRETE SURFACE COURSE, CLASS I.

INDEX OF SHEETS

Sheet No.	Description
1	Cover Sheet
2	Typical Section, General Notes, Summary Of Quantities, Index Of Sheets
3-4	Plan Sheets
5	Details Of Construction Sta. 32+80 to Sta. 34+00 Sta. 45+40 to Sta. 47+50
6	Detail Of Construction Sta. 65+39.81 to Sta. 67+39.81; Typical Side Approaches
Standards	
1686-3	2303-4
2116-1	2304-3
2117-1	2305-3
2298-4	2306-4
2299-5	2312-5
2300-1	

PREPARED BY: Harry D. By
 District Design Engineer

EXAMINED BY: Arnold Lenzini
 District Construction Engineer

EXAMINED BY: Carl S. DeWitt
 District Maintenance Engineer

EXAMINED BY: A. E. Zebolis
 District Traffic Engineer

EXAMINED BY: T. M. Amick
 District Materials Engineer

EXAMINED BY: J. E. Mayhall
 District Land Acc. Engineer

APPROVED: June 3 1974
 Date
J. F. Newton
 District Engineer

ROUTE NO.	SEC.	COUNTY	TOTAL SHEETS	SHEET NO.
F.A. 51	*	JOHNSON	6	3
FED. ROAD DIST. NO. 7	ILLINOIS	PROJECT		

*Section 107-RS-2; 110RS-1

EQUATION
 STA. 1751+88.0 F.A. 1 (U.S. 45)=
 STA. 27+56.70 F.A. 51 (I.H. 146)

Existing Curve Data
 $\Delta = 19^{\circ}-06'$ $T = 481.97'$
 $D = 2^{\circ}-00'$ $L = 955.00'$
 $R = 2864.79'$ $E = 40.26'$

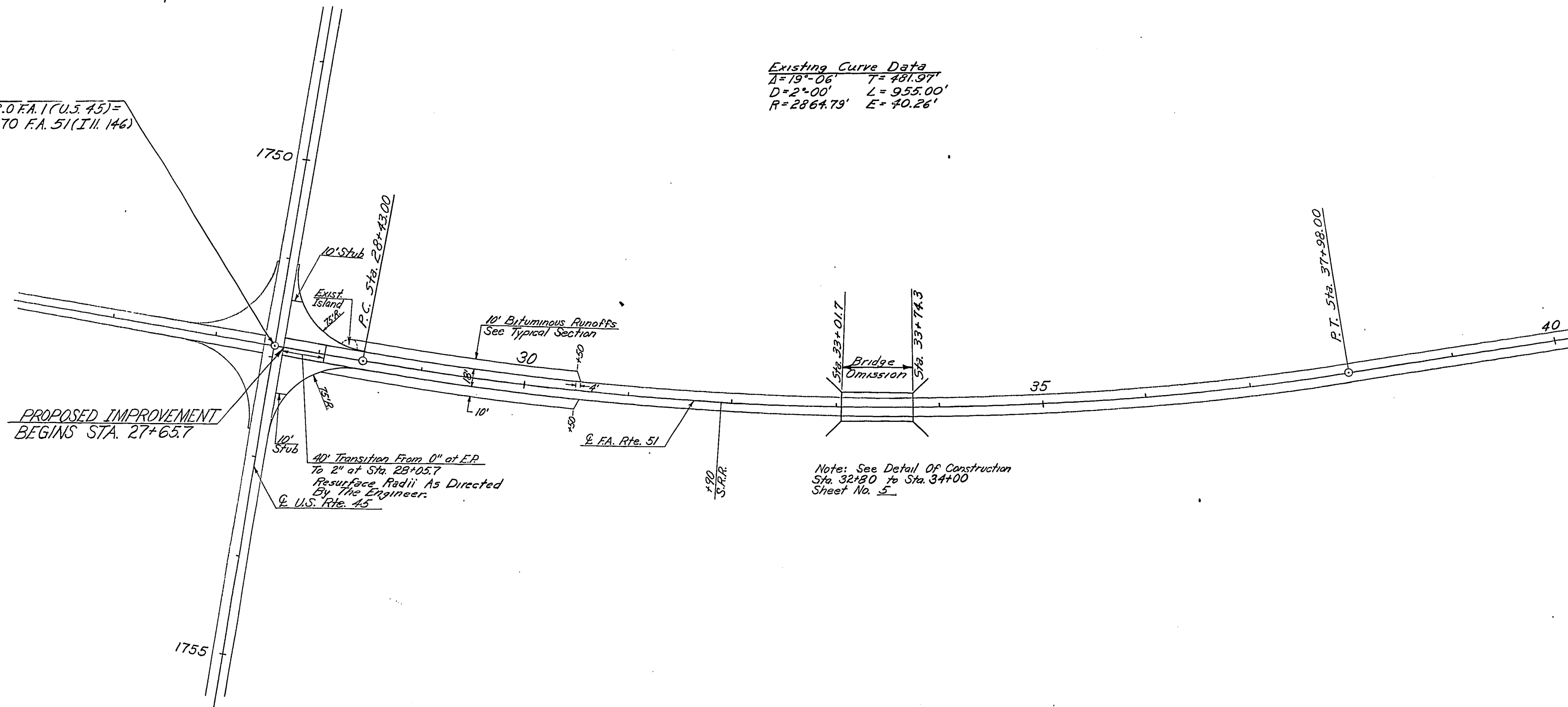

PROPOSED IMPROVEMENT
 BEGINS STA. 27+65.7

40' Transition From 0" at E.P.
 To 2" at Sta. 28+05.7
 Resurface Radii As Directed
 By The Engineer.
 @ U.S. Rte. 45

Note: See Detail Of Construction
 Sta. 32+80 to Sta. 34+00
 Sheet No. 5

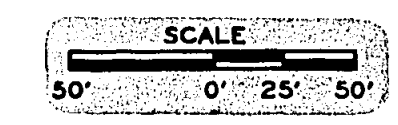

Sta. 27+65.7 to Sta. 40+00

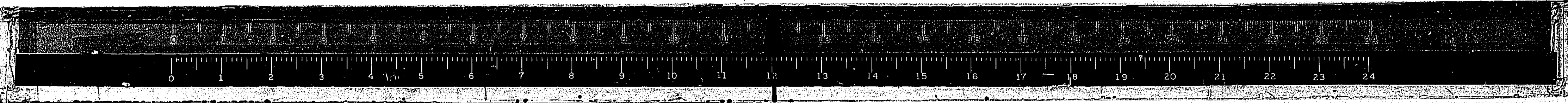

ROUTE NO.	SEC.	COUNTY	TOTAL SHEETS	SHEET NO.
FA. 51	*	JOHNSON	6	4
FED. ROAD DIST. NO. 7	ILLINOIS	PROJECT		
* Section 107RS-2; 110RS-1				

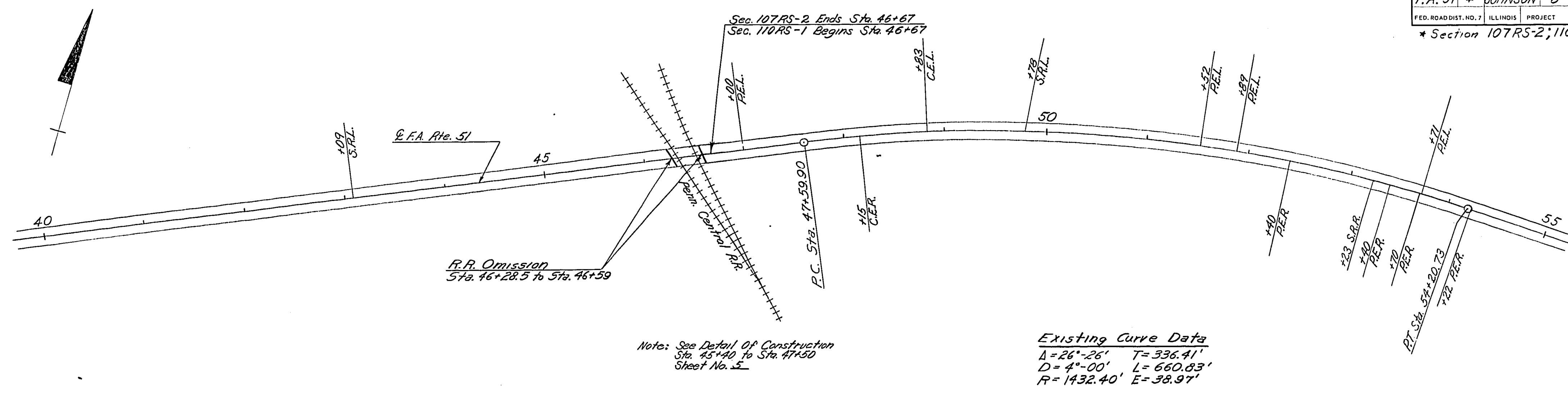

Note: See Detail Of Construction
Sta. 45+40 to Sta. 47+50
Sheet No. 5

Existing Curve Data
 $\Delta = 26^{\circ} - 26'$ $T = 336.41'$
 $D = 4^{\circ} - 00'$ $L = 660.83'$
 $R = 1432.40'$ $E = 38.97'$

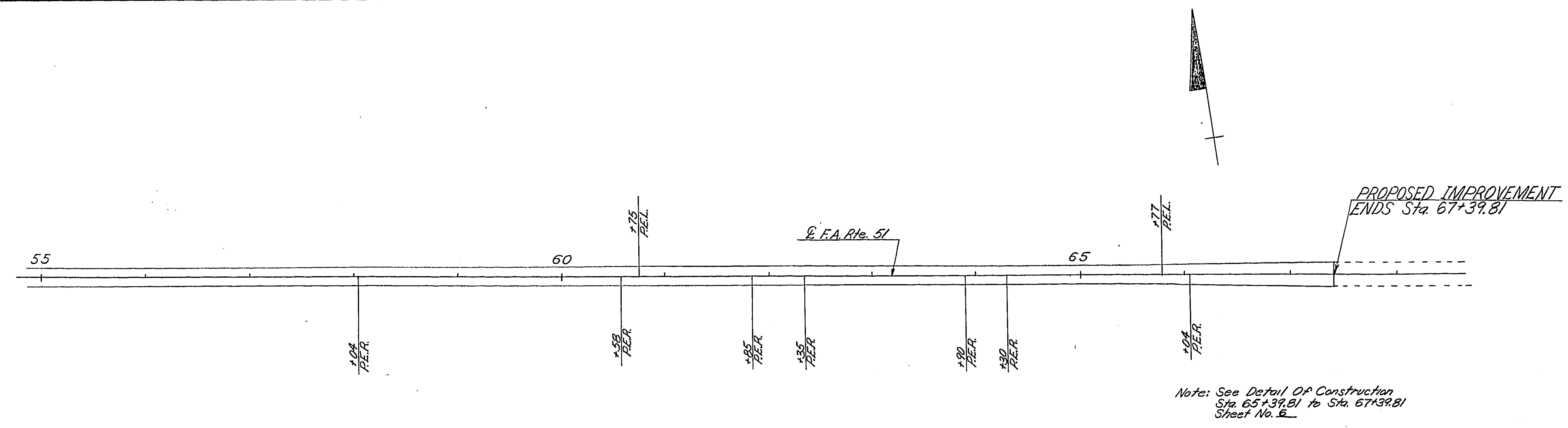

Note: See Detail Of Construction
Sta. 65+39.81 to Sta. 67+39.81
Sheet No. 6

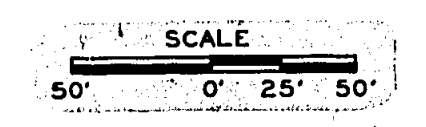

Sta. 40+00 to Sta. 68+00

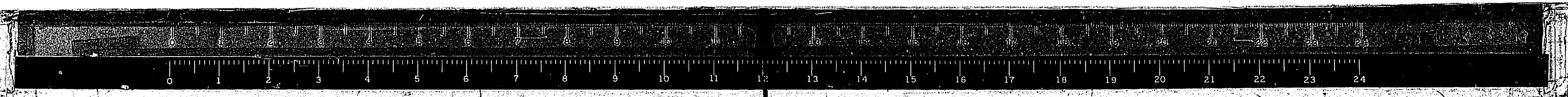

ROUTE NO.	SEC.	COUNTY	TOTAL SHEETS	SHEET NO.
F.A. 51	*	JOHNSON	6	6
FED. ROAD DIST. NO. 7	ILLINOIS	PROJECT		

*Section 107RS-2;
110RS-1

DETAIL OF CONSTRUCTION STA. 65+39.81 TO 67+39.81

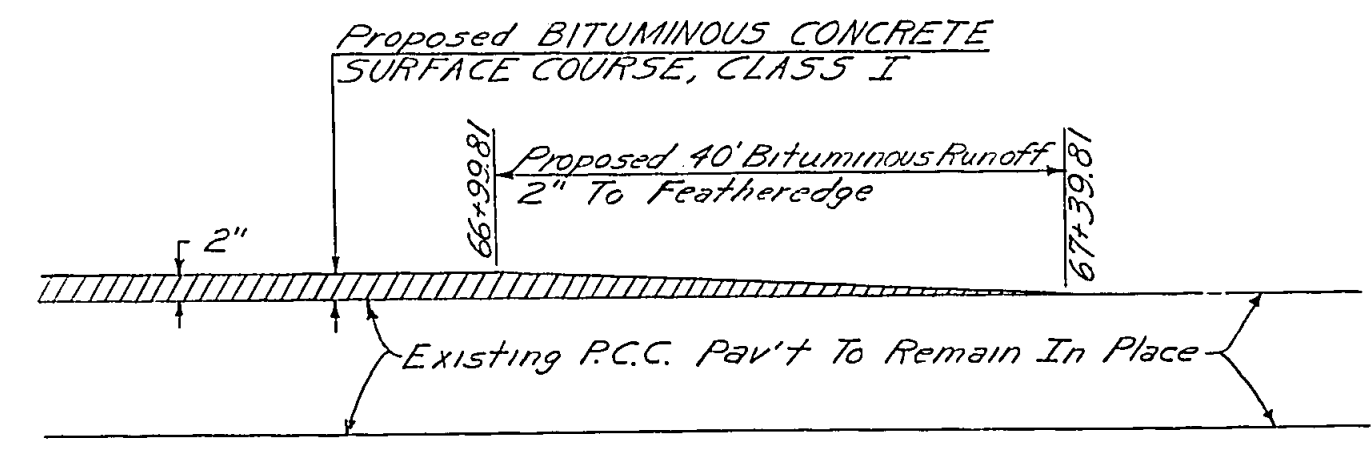
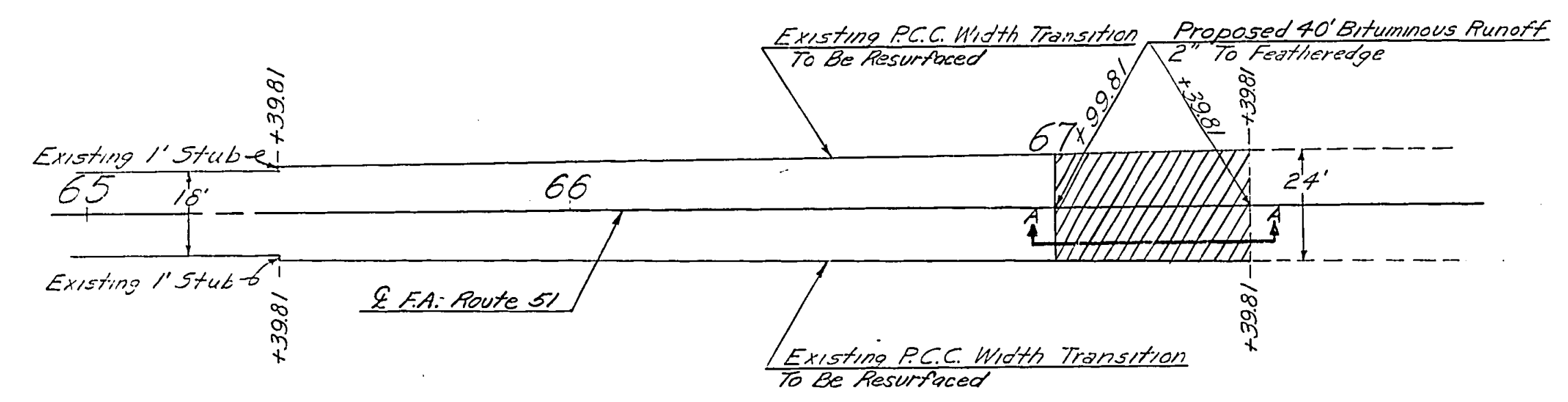

Sec. A-A

TYPICAL LAYOUT OF SIDE APPROACHES

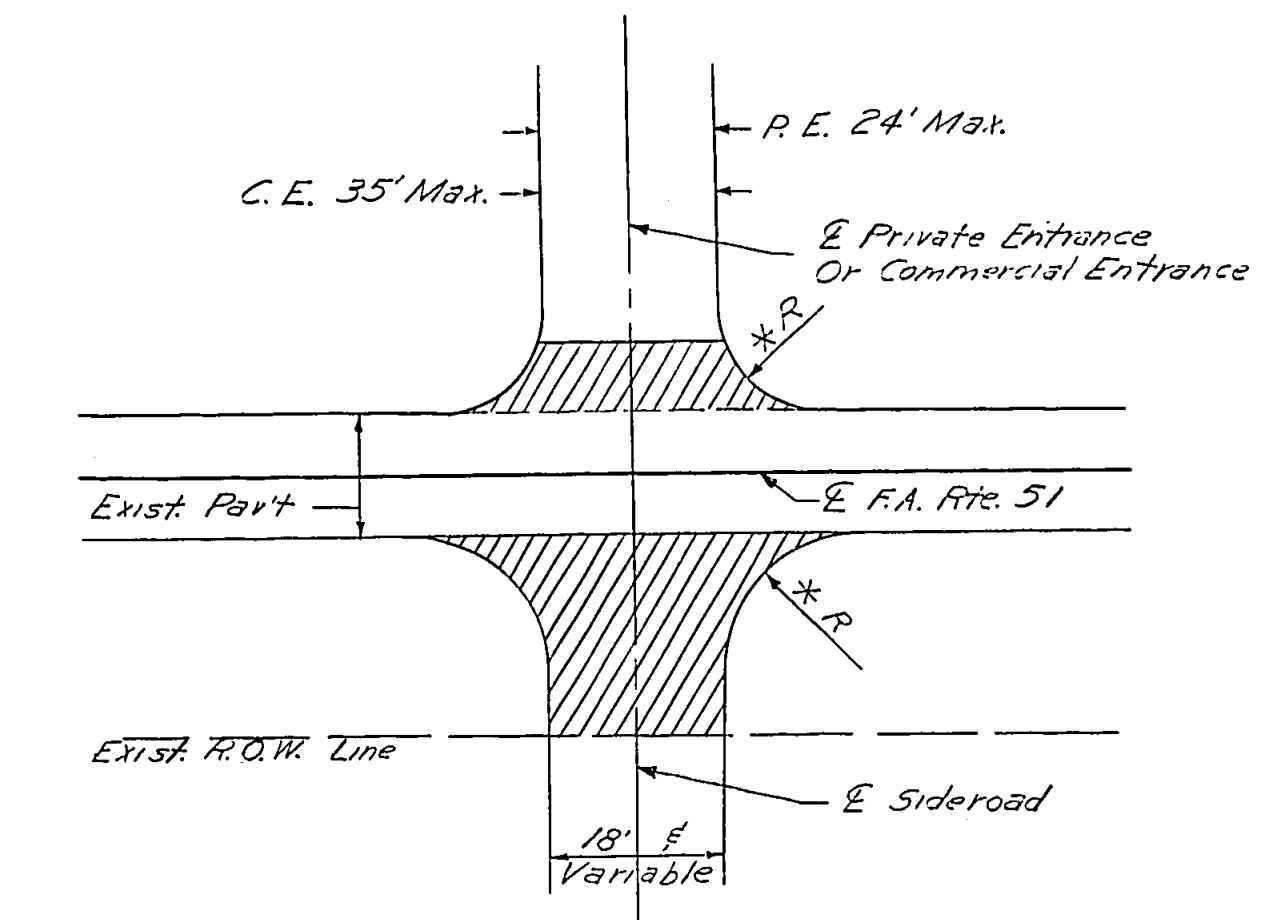

Denotes BITUMINOUS CONCRETE SURFACE COURSE, CLASS I

* As Directed By The Engineer

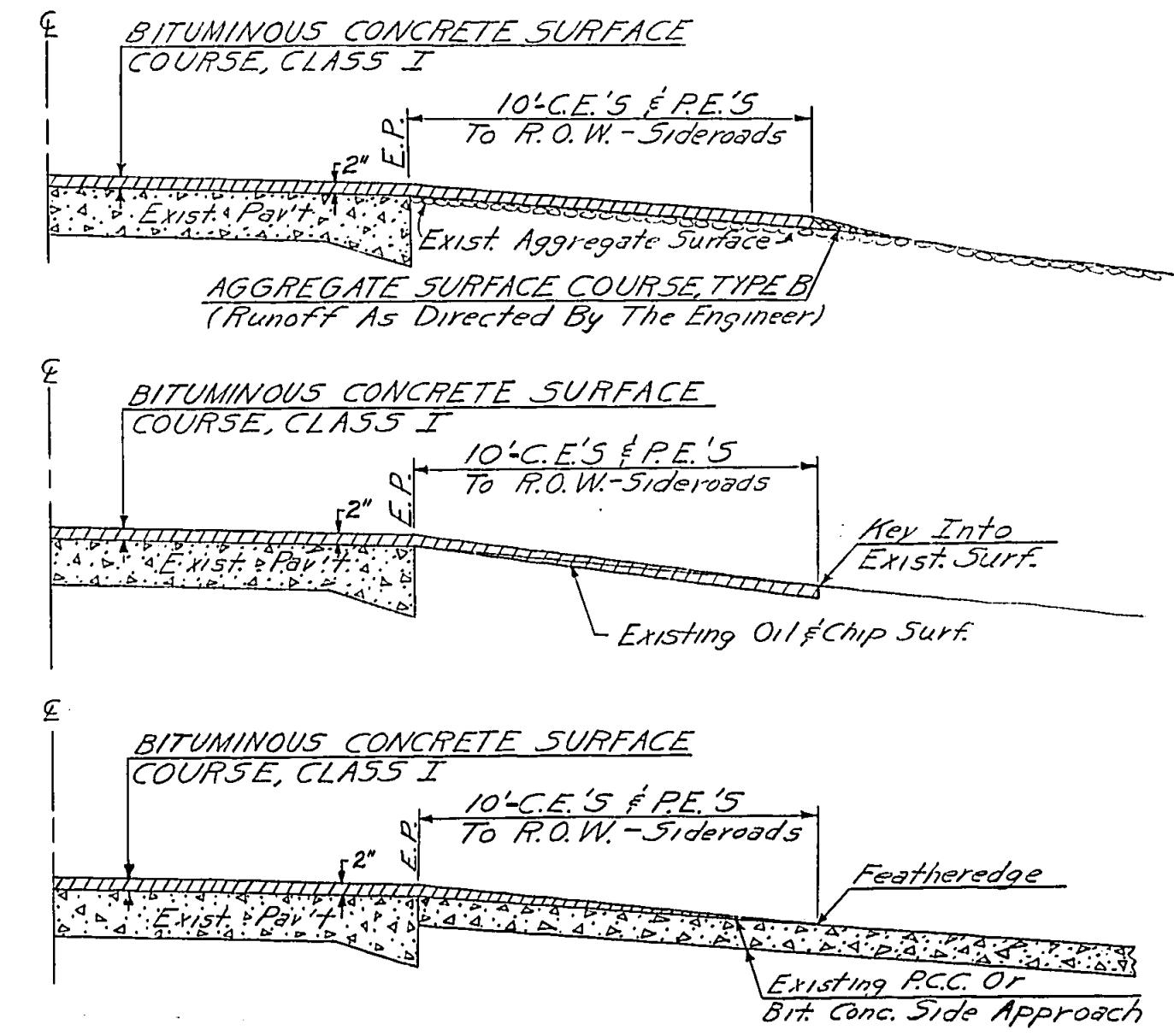

Detail Of Construction Sta. 65+39.81 to 67+39.81; TYPICAL SIDE APPROACHES

