

STATE OF ILLINOIS
DEPARTMENT OF TRANSPORTATION

F.A.P. RTE.	SECTION	COUNTY	TOTAL SHEETS	SHEET NO.
741	D7 HMA RESURF 2021-3	MACON	18	1
		ILLINOIS	CONTRACT NO. 74A37	

FOR INDEX OF SHEETS, SEE SHEET NO. 2

ADT = 8200 (2019)
9.3% TRUCKS

PROPOSED HIGHWAY PLANS

FAP ROUTE 741 (IL 105)
SECTION D7 HMA RESURF 2021-3

SMART RESURFACING
MACON COUNTY

C-97-121-21

D-97-068-21

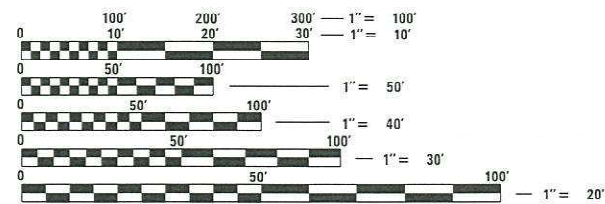
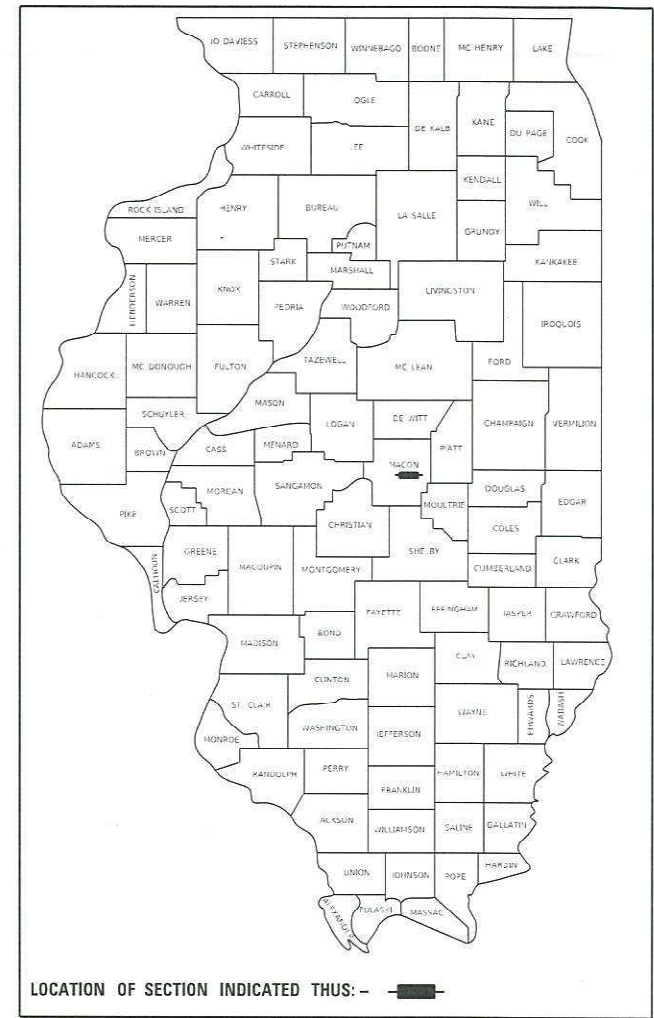

FULL SIZE PLANS HAVE BEEN PREPARED USING STANDARD ENGINEERING SCALES. REDUCED SIZED PLANS WILL NOT CONFORM TO STANDARD SCALES. IN MAKING MEASUREMENTS ON REDUCED PLANS, THE ABOVE SCALES MAY BE USED.

J.U.L.I.E.
JOINT UTILITY LOCATION INFORMATION FOR EXCAVATORS
1-800-892-0123
OR 811

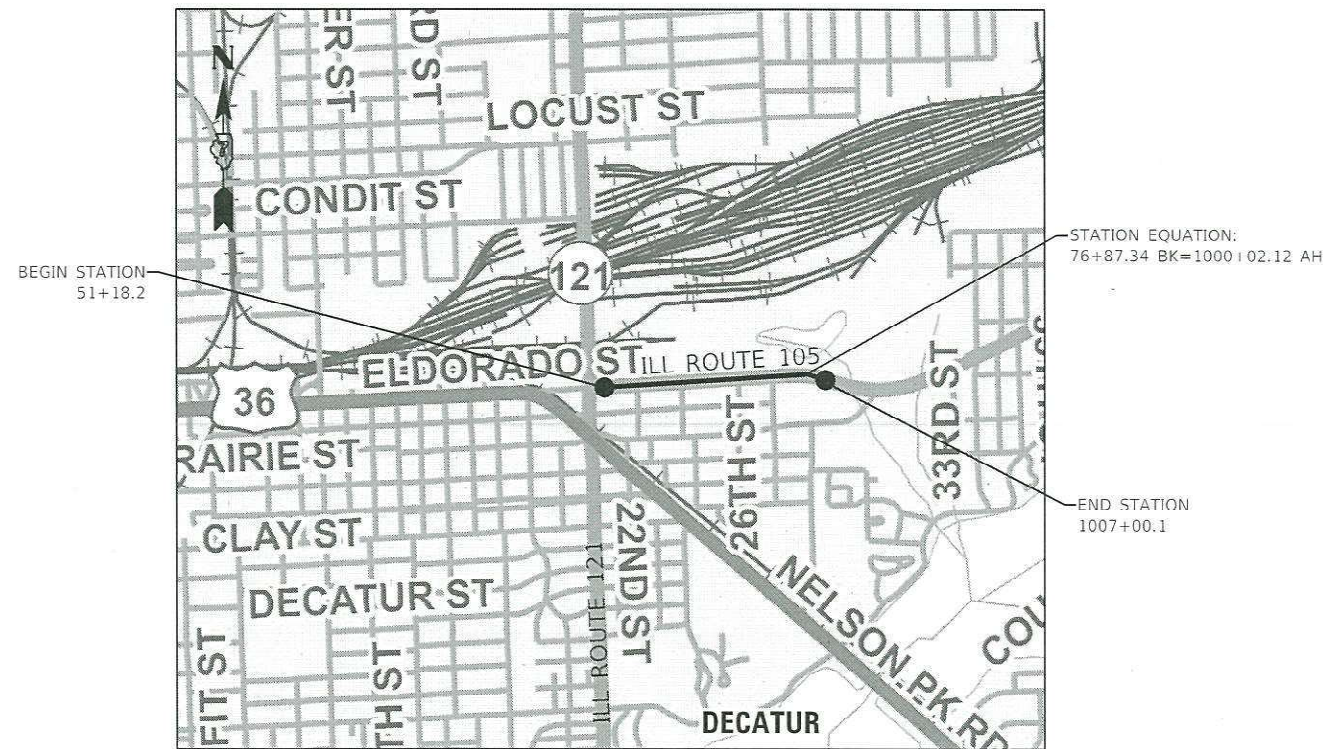

PROJECT ENGINEER DEBRA BARRETT
PROJECT MANAGER LEAH HILLE

GROSS LENGTH = 3259.1 FT. = 0.62 MILE
NET LENGTH = 3259.1 FT. = 0.62 MILE

CONTRACT NO. 74A37

STATE OF ILLINOIS
DEPARTMENT OF TRANSPORTATION

SUBMITTED February 11 20 21
Jeffrey P. Myerles
REGIONAL ENGINEER

March 19, 2021
[Signature]
ENGINEER OF DESIGN AND ENVIRONMENT

March 19, 2021
[Signature]
DIRECTOR OF HIGHWAYS PROJECT IMPLEMENTATION

PRINTED BY THE AUTHORITY
OF THE STATE OF ILLINOIS

GENERAL NOTES

THIS PROJECT IS LOCATED ON FAP ROUTE 741 (ILL 105) IN MACON COUNTY EAST OF ILL 121 TO 0.1 MILES EAST OF 26TH STREET. THE WORK INCLUDED IN SECTION D7 HMA RESURF 2021-3 CONSISTS OF MILLING, HOT-MIX ASPHALT RESURFACING, PAVEMENT MARKING, AND ANY OTHER WORK NECESSARY TO COMPLETE THIS SECTION.

MILLED PAVEMENT SHALL BE RESURFACED WITHIN 5 CALENDAR DAYS.

WHEN APPLYING SHORT TERM PAVEMENT MARKINGS, TEMPORARY TAPE SHALL BE USED ON THE SURFACE AND PAINT SHALL BE USED ON THE MILLED SURFACE.

APPLICATION RATES

THE FOLLOWING APPLICATION RATES WERE USED IN CALCULATING PLAN QUANTITIES AND HAVE BEEN INCLUDED FOR REFERENCE:

BITUMINOUS MATERIALS (TACK COAT)	0.5 LB/SQ FT (ON MILLED SURFACES)
	0.025 LB/SQ FT (ON HMA LIFTS)
HOT-MIX ASPHALT BINDERS AND SURFACES	112 LB/SQ YD/INCH

MIXTURE REQUIREMENTS

THE FOLLOWING MIXTURE REQUIREMENTS ARE APPLICABLE TO THIS PROJECT:

APPLICATION	AC/PG	DESIGN AIR Voids	MIXTURE COMPOSITION	FRICTION AGGREGATE	QUALITY MANAGEMENT
POLYMERIZED HMA SURFACE COURSE, IL-9.5, MIX "D", N90 (2")	SBS 70-22	4.0% @ N=90	IL - 9.5	MIXTURE D	QC/QA
INCIDENTAL HMA SURFACING	PG 64-22	4.0% @ N=70	IL - 9.5	MIXTURE C	QC/QA

INDEX OF SHEETS

SHEET NO.	ITEM
1	COVER SHEET
2	INDEX OF SHEETS, LIST OF STANDARDS, AND GENERAL NOTES
3-4	SUMMARY OF QUANTITIES
5	TYPICAL SECTIONS
6	SCHEDULE OF QUANTITIES
7-9	PLAN SHEETS
10-13	PAVEMENT MARKING DETAILS
14-18	DISTRICT 7 DETAILS

THE FOLLOWING STANDARDS ARE A PART OF THESE PLANS AND ARE INCLUDED AFTER SHEET NO. 18:

STANDARD NO.	DESCRIPTION
000001-08	STANDARD SYMBOLS, ABBREVIATIONS AND PATTERNS
001001-02	AREAS OF REINFORCEMENT BARS
001006	DECIMAL OF AN INCH AND OF A FOOT
667101-02	PERMANENT SURVEY MARKERS
701101-05	OFF-ROAD OPERATIONS, MULTILANE, 15' (4.5 M) TO 24' (600 MM) FROM PAVEMENT EDGE
701106-02	OFF-ROAD OPERATIONS, MULTILANE, MORE THAN 15' (4.5 M) AWAY
701427-05	LANE CLOSURE, MULTILANE, INTERMITTENT OR MOVING OPERATION, FOR SPEEDS ≤ 40 MPH
701606-10	URBAN SINGLE LANE CLOSURE, MULTILANE, 2W WITH MOUNTABLE MEDIAN
701701-10	URBAN LANE CLOSURE, MULTILANE INTERSECTION
701901-08	TRAFFIC CONTROL DEVICES
780001-05	TYPICAL PAVEMENT MARKINGS
781001-04	TYPICAL APPLICATIONS RAISED REFLECTIVE PAVEMENT MARKERS
886001-01	DETECTOR LOOP INSTALLATIONS
886006-01	TYPICAL LAYOUT FOR DETECTION LOOPS

MODEL: Default
 FILE NAME: p:\pub\harronm.dwt\illinois.gov\PWIDOT\Documents\DOT_Offices\District 7\Projects\74A37\CADD\DATA\CAD\Sheets\ID7\74A37-d7r-senote.dgn

USER NAME = steffenmk	DESIGNED - LMH	REVISED -
	DRAWN - LMH	REVISED -
PLOT SCALE = 100,0000 ' / in.	CHECKED -	REVISED -
PLOT DATE = 2/11/2021	DATE - 2/11/2021	REVISED -

**STATE OF ILLINOIS
DEPARTMENT OF TRANSPORTATION**

**INDEX OF SHEETS
AND GENERAL NOTES**

SCALE: NO SCALE SHEET OF SHEETS STA. TO STA.

F.A.P. RTE.	SECTION	COUNTY	TOTAL SHEETS	SHEET NO.
741	D7 HMA RESURF 2021-3	MACON	18	2
			CONTRACT NO. 74A37	
		ILLINOIS	FED. AID PROJECT	

URBAN

URBAN

SUMMARY OF QUANTITIES			TOTAL QUANTITIES	CONSTRUCTION TYPE CODE		
CODE NO	ITEM	UNIT		0005 100% STATE		
40600290	BITUMINOUS MATERIALS (TACK COAT)	POUND	7135	7135		
40600990	TEMPORARY RAMP	SO YD	91	91		
40604164	POLYMERIZED HOT-MIX ASPHALT SURFACE COURSE, IL-9.5, MIX "D", N90	TON	1776	1776		
40800050	INCIDENTAL HOT-MIX ASPHALT SURFACING	TON	82	82		
44000157	HOT-MIX ASPHALT SURFACE REMOVAL, 2"	SO YD	15854	15854		
66700205	PERMANENT SURVEY MARKERS, TYPE I	EACH	2	2		
67100100	MOBILIZATION	L SUM	1	1		
70102625	TRAFFIC CONTROL AND PROTECTION, STANDARD 701606	L SUM	1	1		
70102635	TRAFFIC CONTROL AND PROTECTION, STANDARD 701701	L SUM	1	1		
70107025	CHANGEABLE MESSAGE SIGN	CAL DA	28	28		
70300100	SHORT TERM PAVEMENT MARKING	FOOT	3210	3210		
70300150	SHORT TERM PAVEMENT MARKING REMOVAL	SO FT	535	535		

SUMMARY OF QUANTITIES			TOTAL QUANTITIES	CONSTRUCTION TYPE CODE		
CODE NO	ITEM	UNIT		0005 100% STATE		
* 78000100	THERMOPLASTIC PAVEMENT MARKING - LETTERS AND SYMBOLS	SO FT	94	94		
* 78000200	THERMOPLASTIC PAVEMENT MARKING - LINE 4"	FOOT	6815	6815		
* 78000400	THERMOPLASTIC PAVEMENT MARKING - LINE 6"	FOOT	1874	1874		
* 78000600	THERMOPLASTIC PAVEMENT MARKING - LINE 12"	FOOT	150	150		
* 78000650	THERMOPLASTIC PAVEMENT MARKING - LINE 24"	FOOT	40	40		
* 78100100	RAISED REFLECTIVE PAVEMENT MARKER	EACH	168	168		
78300200	RAISED REFLECTIVE PAVEMENT MARKER REMOVAL	EACH	168	168		
* 88600100	DETECTOR LOOP, TYPE I	FOOT	536	536		
X0326440	SURFACE REMOVAL, VARIABLE DEPTH (SPECIAL)	SO YD	730	730		
X4060995	TEMPORARY RAMP, SPECIAL	SO YD	157	157		
* X7830060	GROOVING FOR RECESSED PAVEMENT MARKING, LETTERS AND SYMBOLS	SO FT	94	94		
* X7830070	GROOVING FOR RECESSED PAVEMENT MARKING 5"	FOOT	6815	6815		
* X7830074	GROOVING FOR RECESSED PAVEMENT MARKING 7"	FOOT	1874	1874		

* SPECIALTY ITEM

MODEL: Default
 FILE NAME: p:\pub\harronm.dwt
 PROJECT: 74A37\CAAD\Drawings\DOT Office\Drawings\74A37\Drawings\DOT Office\Drawings\74A37.dwg
 PLOT DATE: 2/11/2021

USER NAME = steffenmk	DESIGNED - LMH	REVISED -
DRAWN - LMH	CHECKED -	REVISED -
PLOT SCALE = 100,0000' / in.	DATE - 2/11/2021	REVISED -

STATE OF ILLINOIS
DEPARTMENT OF TRANSPORTATION

SUMMARY OF QUANTITIES

SCALE: NO SCALE SHEET OF SHEETS STA. TO STA.

F.A.P. RTE.	SECTION	COUNTY	TOTAL SHEETS	SHEET NO.
741	D7 HMA RESURF 2021-3	MACON	18	3
CONTRACT NO. 74A37				
ILLINOIS FED. AID PROJECT				

PROPOSED TYPICAL SECTION

STA. 51+18.2 TO STA. 56+93.9

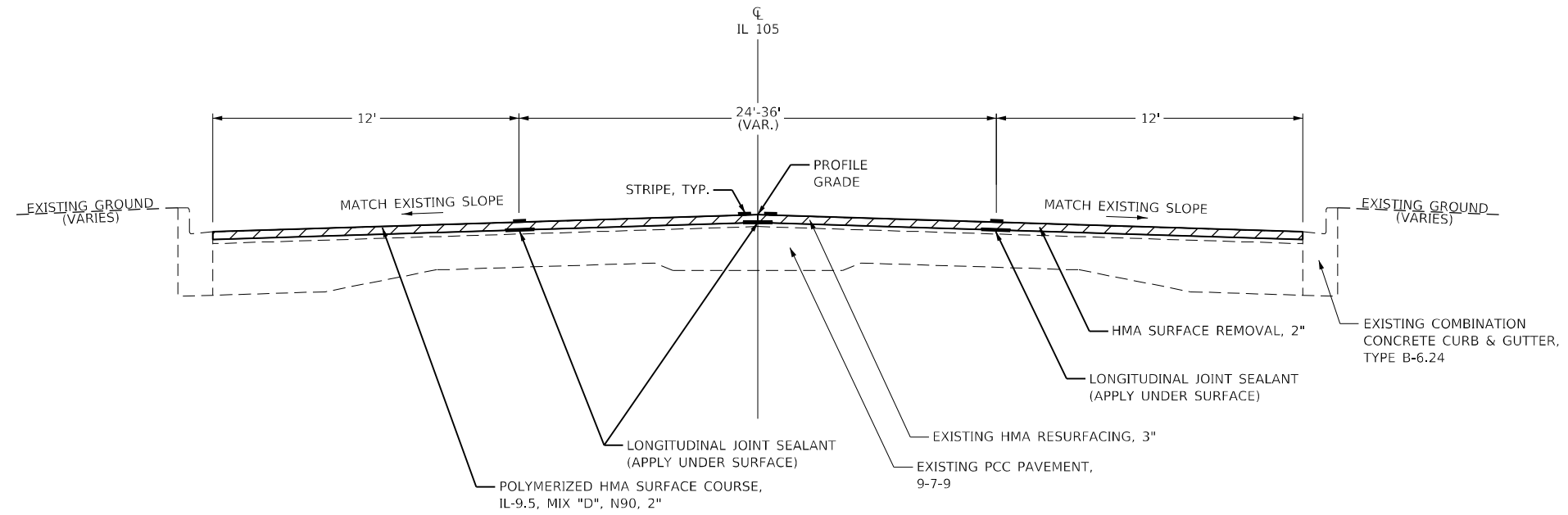

PROPOSED TYPICAL SECTION

STA. 56+93.9 TO STA. 76+87.3
 STATION EQUATION: 76+87.34 BK=1000+02.12 AH
 STA. 1000+02.12 TO STA. 1007+00.1

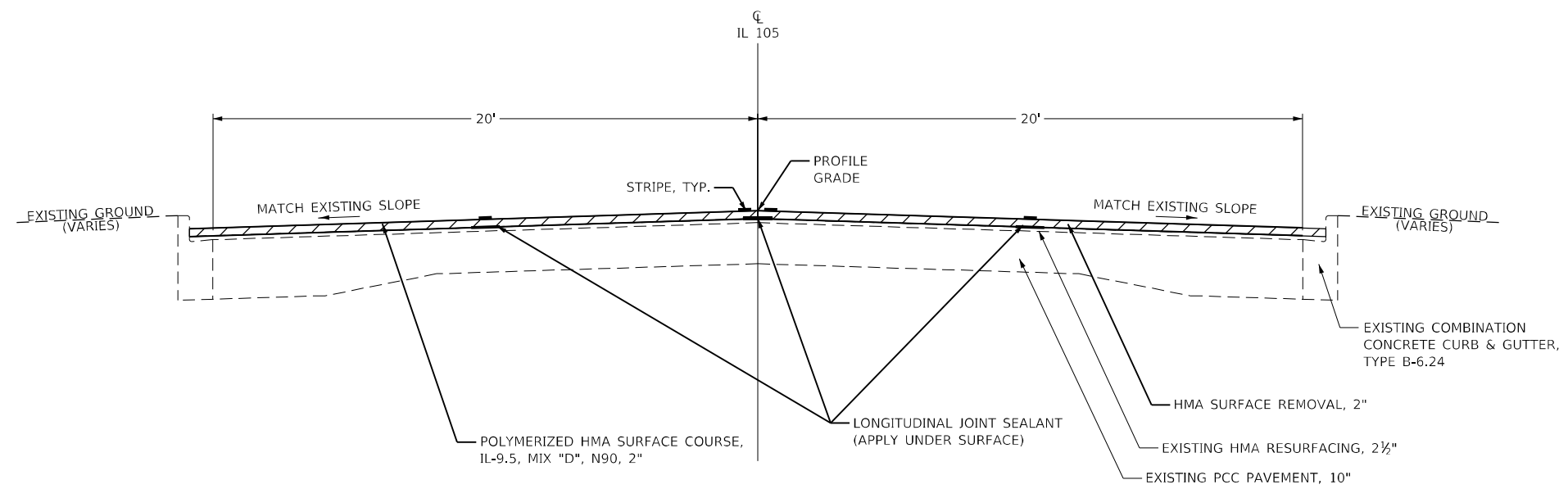

MODEL: Default
 FILE NAME: p:\pub\harronm.dwt\illinois.dot\illinois\dot\Office\Drawings\7\Projects\74A37\CADD\Drawings\CAD\Drawings\74A37-5118-5693.dgn

USER NAME = steffenmk	DESIGNED - LMH	REVISED -
	DRAWN - LMH	REVISED -
PLOT SCALE = 100,0000' / in.	CHECKED -	REVISED -
PLOT DATE = 2/11/2021	DATE - 2/11/2021	REVISED -

**STATE OF ILLINOIS
 DEPARTMENT OF TRANSPORTATION**

TYPICAL SECTIONS

SCALE: NO SCALE SHEET OF SHEETS STA. TO STA.

F.A.P. RTE.	SECTION	COUNTY	TOTAL SHEETS	SHEET NO.
741	D7 HMA RESURF 2021-3	MACON	18	5
CONTRACT NO. 74A37				
		ILLINOIS	FED. AID PROJECT	

MODEL: Default
 FILE NAME: p:\pub\harronm.dwt\illinois.gov\PWIDOT\Documents\IDOT_Offices\Distric_7\Projects\74A37\CADD\DATA\CAD\Sheet\ID74A37-shc-schedule.dgn

STATION TO STATION			70300100 SHORT TERM PAVEMENT MARKING (YELLOW)		70300100 SHORT TERM PAVEMENT MARKING (WHITE)		70300150 SHORT TERM PAVEMENT MARKING REMOVAL		78000200 THERMOPLASTIC PAVEMENT MARKING - LINE 4" (YELLOW)		X7830068 GROOVING FOR RECESSED PAVEMENT MARKING 5"		78000400 THERMOPLASTIC PAVEMENT MARKING - 6" (WHITE)		X7830074 GROOVING FOR RECESSED PAVEMENT MARKING 7"		78000600 THERMOPLASTIC PAVEMENT MARKING - 12" (YELLOW)		X7830078 GROOVING FOR RECESSED PAVEMENT MARKING 13"		78000650 THERMOPLASTIC PAVEMENT MARKING - 24" (WHITE)		X7830090 GROOVING FOR RECESSED PAVEMENT MARKING 25"		78000100 THERMOPLASTIC PAVEMENT MARKING - LETTERS AND		X7830060 GROOVING FOR RECESSED PAVEMENT MARKING, LETTERS			
FOOT	FOOT	SQ FT	FOOT	FOOT	FOOT	FOOT	FOOT	FOOT	FOOT	FOOT	FOOT	FOOT	FOOT	FOOT	FOOT	FOOT	FOOT	FOOT	FOOT	FOOT	FOOT	FOOT	FOOT	FOOT	FOOT	FOOT	FOOT	FOOT	FOOT	
50+50.0	TO	51+90.0	-	280.0	46.7	-	-	140.0	140.0	-	-	-	-	-	-	-	-	-	-	-	-	-	-	-	-	-	-	-	-	
50+90.0	TO	51+90.0	-	200.0	33.3	-	-	100.0	100.0	-	-	-	-	-	-	-	-	-	-	-	-	-	-	-	-	-	-	-	-	
51+18.2	TO	55+90.0	62.4	124.7	31.2	943.6	943.6	155.9	155.9	-	-	-	-	-	-	-	-	-	-	-	-	-	-	-	-	-	-	-	-	
51+90.0	TO	55+90.0	48.0	96.0	24.0	800.0	800.0	-	-	150.0	150.0	-	-	-	-	-	-	-	-	-	-	-	-	-	-	-	-	-	-	
55+90.0	TO	56+63.0	94.5	189.2	47.3	146.0	146.0	116.5	116.5	-	-	-	-	-	-	-	-	-	-	-	-	-	-	-	-	-	-	-	-	
56+63.0	TO	57+25.0	12.4	24.8	6.2	-	-	31.0	31.0	-	-	-	-	-	-	-	-	-	-	-	-	-	-	-	-	-	-	-	-	
57+25.0	TO	63+05.5	116.1	232.2	58.1	1161.0	1161.0	290.3	290.3	-	-	-	-	-	-	-	-	-	-	-	-	-	-	-	-	-	-	-	-	
63+05.5	TO	63+89.5	16.3	513.6	88.4	-	-	42.0	42.0	-	-	40.0	40.0	-	-	-	-	-	-	-	-	-	-	-	-	-	-	-	-	
63+89.5	TO	71+49.2	151.9	303.9	76.0	1519.4	1519.4	379.9	379.9	-	-	-	-	-	-	-	-	-	-	-	-	-	-	-	-	-	-	-	-	
71+49.2	TO	72+11.2	12.4	24.8	6.2	-	-	31.0	31.0	-	-	-	-	-	-	-	-	-	-	-	-	-	-	-	-	-	-	-	-	
72+11.2	TO	76+53.1	88.4	176.8	44.2	883.8	883.8	221.0	221.0	-	-	-	-	-	-	-	-	-	-	-	-	-	-	-	-	-	-	-	-	
76+53.1	TO	76+87.3	6.8	13.7	3.4	-	-	17.1	17.1	-	-	-	-	-	-	-	-	-	-	-	-	-	-	-	-	-	-	-	-	
STATION EQUATION: 76+87.34 BK = 1000+02.12 AH																														
1000+02.1	TO	1000+29.9	5.6	11.1	2.8	-	-	13.9	13.9	-	-	-	-	-	-	-	-	-	-	-	-	-	-	-	-	-	-	-	-	-
1000+29.9	TO	1006+80.3	130.1	260.2	65.0	1300.8	1300.8	325.2	325.2	-	-	-	-	-	-	-	-	-	-	-	-	-	-	-	-	-	-	-	-	-
1006+80.3	TO	1007+00.1	4.0	7.9	2.0	59.4	59.4	9.9	9.9	-	-	-	-	-	-	-	-	-	-	-	-	-	-	-	-	-	-	-	-	-
TOTALS:			3210	535	6815	6815	1874	1874	150	150	40	40	94	94																

ENTRANCE SCHEDULE			40800050 INCIDENTAL HOT- MIX ASPHALT SURFACING		X0326440 SURFACE REMOVAL, VARIABLE DEPTH (SPECIAL)		X4060995 TEMPORARY RAMP, SPECIAL	
SIDE	STATION	TYPE	TON	SQ YD	SQ YD	SQ YD	SQ YD	
R	56+91.2	PRA-23RD ST	7.5	66.7	13.9			
L	56+93.9	CE	10.6	94.44	16.7			
R	59+39.0	PE	1.1	10.22	4.4			
R	59+55.7	PE	1.1	10.22	4.4			
R	61+03.2	PE	0.6	5.56	4.4			
L	63+38.1	PRA-24TH ST	28.8	256.94	30.6			
R	63+38.6	PRA-24TH ST	7.7	68.33	16.7			
R	65+35.9	PF	1.1	10.22	4.4			
R	67+99.1	PE	1.1	10.2	4.4			
R	68+93.0	PE	1.1	10.22	4.4			
R	69+98.5	PE	1.1	10.22	4.4			
R	71+80.2	PRA-25TH ST	7.7	69.17	15.6			
R	72+77.2	PE	1.1	10.22	4.4			
R	74+40.3	PE	1.1	10.22	4.4			
R	74+80.5	PE	1.1	10.22	4.4			
R	75+36.7	PE	1.1	10.22	4.4			
R	76+84.1	PRA-26TH ST	7.5	66.67	13.9			
TOTALS:			82	730	157			

PAVING SCHEDULE			40600290 BITUMINOUS MATERIALS (TACK COAT)		40600990 TEMPORARY RAMP		40602970 POLYMERIZED HMA SURFACE COURSE, IL-9.5, MIX "D", N90		44000157 HMA SURFACE REMOVAL, 2"	
STATION TO STATION	FOOT	POUND	SQ YD	TON	SQ YD	TON	SQ YD			
51+18.2 TO 54+30.0	311.8	1091.3	60.7	271.6	2425.1					
54+30.0 TO 56+93.9	263.9	659.7	-	164.2	1466.1					
56+93.9 TO 76+87.3	1993.4	3986.9	-	992.3	8859.7					
STATION EQUATION: 76+87.34 BK = 1000+02.12 AH										
1000+02.1 TO 1007+00.1	698.0	1396.0	29.6	347.4	3102.2					
TOTALS:			7134	91	1776	15854				

PERMANENT SURVEY MARKERS						
POINT #	NORTHING	EASTING	STATION	OFFSET	66700205 PERMANENT SURVEY MARKERS, TYPE I	Z0049799 PROTECTING OR RESETTING SURVEY MARKERS
1002	1158636.926	818867.300	61+17.51	0'	1	1
1113	1158699.859	820435.867	STA EQN 76+87.34 BK = 1000+02.12 AH	0'	1	1
TOTALS:					2	2

USER NAME = stefenmk	DESIGNED - LMH	REVISED -
	DRAWN - LMH	REVISED -
PLOT SCALE = 100,0000' / in.	CHECKED -	REVISED -
PLOT DATE = 2/11/2021	DATE - 2/11/2021	REVISED -

**STATE OF ILLINOIS
DEPARTMENT OF TRANSPORTATION**

SCHEDULE OF QUANTITIES

SCALE: NO SCALE SHEET OF SHEETS STA. TO STA.

F.A.P. RTE.	SECTION	COUNTY	TOTAL SHEETS	SHEET NO.
741	D7 HMA RESURF 2021-3	MACON	18	6
CONTRACT NO. 74A37				
ILLINOIS FED. AID PROJECT				

MODEL: Default
 FILE NAME: p:\pub\harronm.dwt\illinois.gov\PWIDOT\Documents\DOT_Offices\District 7\Projects\74A37\CADD\DATA\CADD\sheet\074A37-5b.dwg.dgn

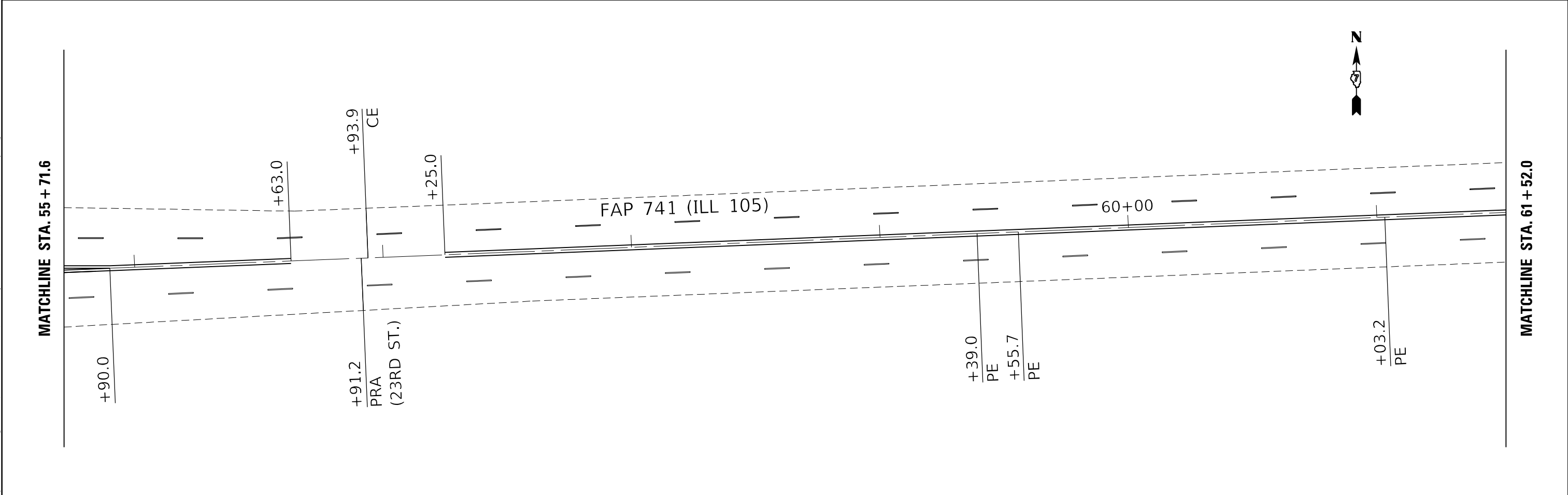
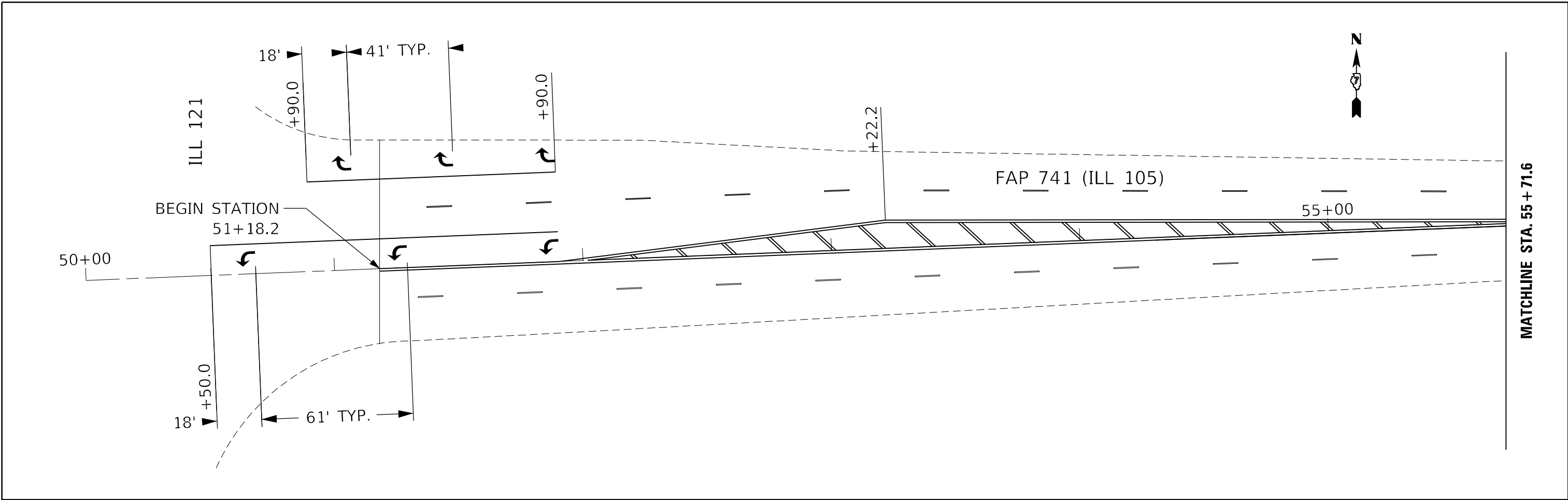

USER NAME = steffenmk	DESIGNED - LMH	REVISED -
	DRAWN - LMH	REVISED -
PLOT SCALE = 40.0000 ' / in.	CHECKED -	REVISED -
PLOT DATE = 2/11/2021	DATE - 2/11/2021	REVISED -

**STATE OF ILLINOIS
 DEPARTMENT OF TRANSPORTATION**

PLAN SHEET

SCALE: 40.0000 ' / in. SHEET OF SHEETS STA. TO STA.

F.A.P. RTE.	SECTION	COUNTY	TOTAL SHEETS	SHEET NO.
741	D7 HMA RESURF 2021-3	MACON	18	7
ILLINOIS FED. AID PROJECT			CONTRACT NO. 74A37	

MODEL: Default
 FILE NAME: p:\pub\barroom.dwg
 PROJECT: 74A37 CAD\Drawings\CAD\Drawings\74A37-21c-dwg.dgn

MATCHLINE STA. 61 + 52.0

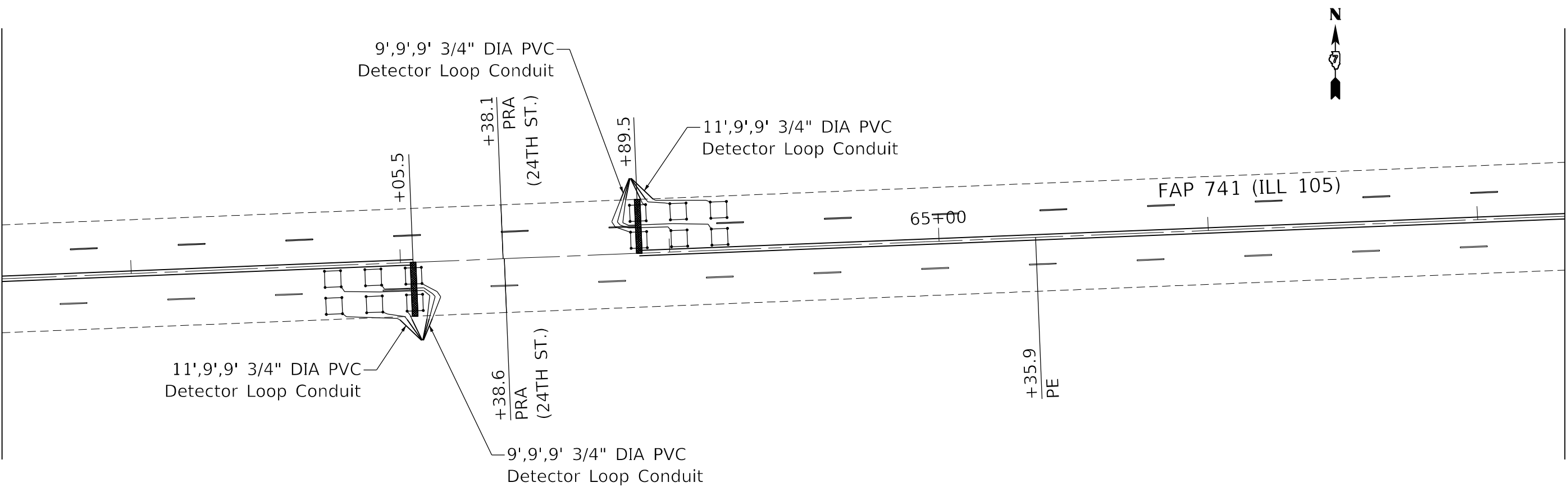

MATCHLINE STA. 67 + 32.5



MATCHLINE STA. 67 + 32.5

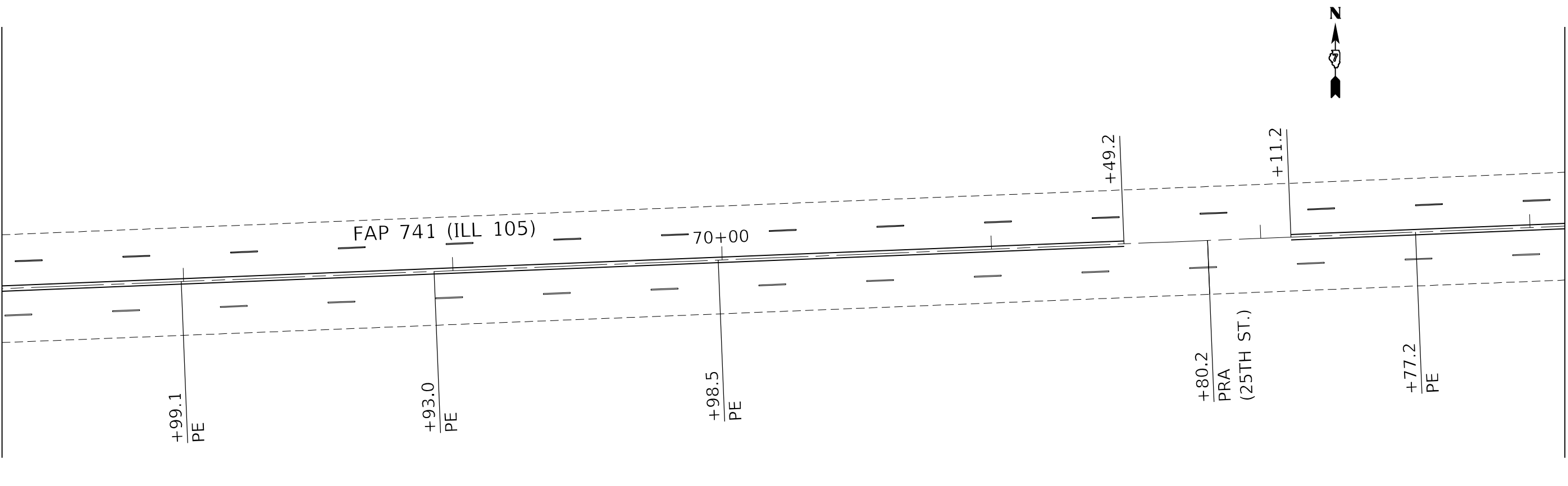

MATCHLINE STA. 73 + 13.0



USER NAME = steffnmk	DESIGNED - LMH	REVISED -
	DRAWN - LMH	REVISED -
PLOT SCALE = 40,0000 * / in.	CHECKED -	REVISED -
PLOT DATE = 2/11/2021	DATE - 2/11/2021	REVISED -

**STATE OF ILLINOIS
 DEPARTMENT OF TRANSPORTATION**

PLAN SHEET
 SCALE: 40,0000 ' / in. SHEET OF SHEETS STA. TO STA.

F.A.P. RTE.	SECTION	COUNTY	TOTAL SHEETS	SHEET NO.
741	D7 HMA RESURF 2021-3	MACON	18	8
CONTRACT NO. 74A37				
ILLINOIS FED. AID PROJECT				

MODEL: Default
 FILE NAME: p:\pub\harronm.dwg
 PROJECT: 74A37-CA000000-0000-0000-0000-000000000000
 PROJECT: 74A37-CA000000-0000-0000-0000-000000000000
 PROJECT: 74A37-CA000000-0000-0000-0000-000000000000

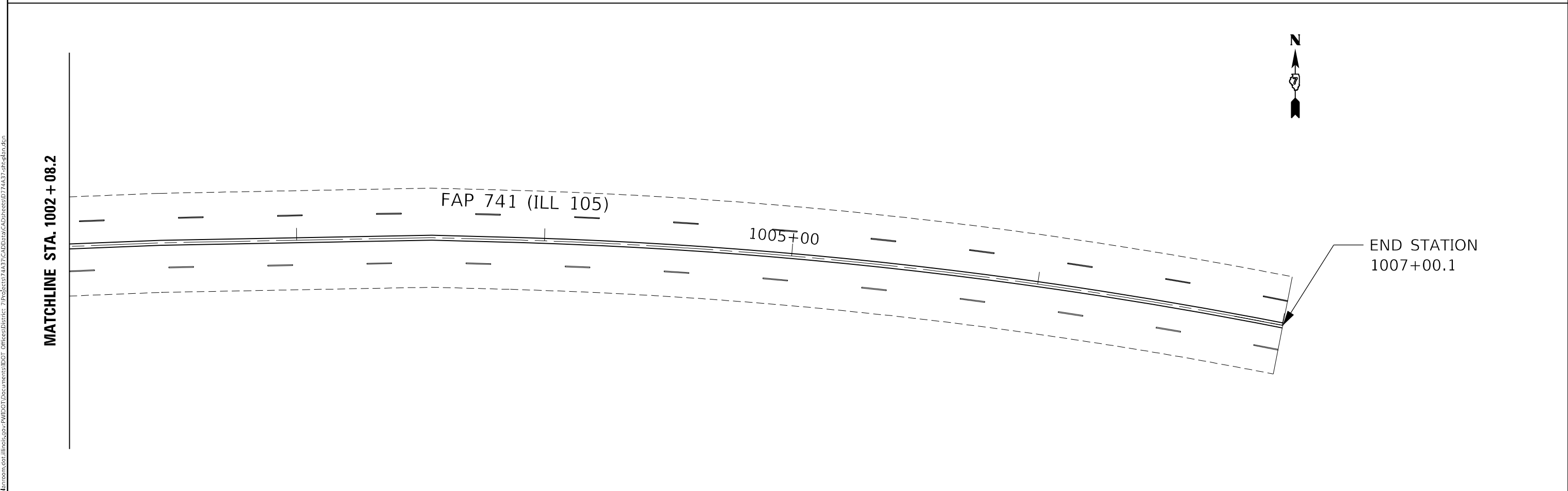
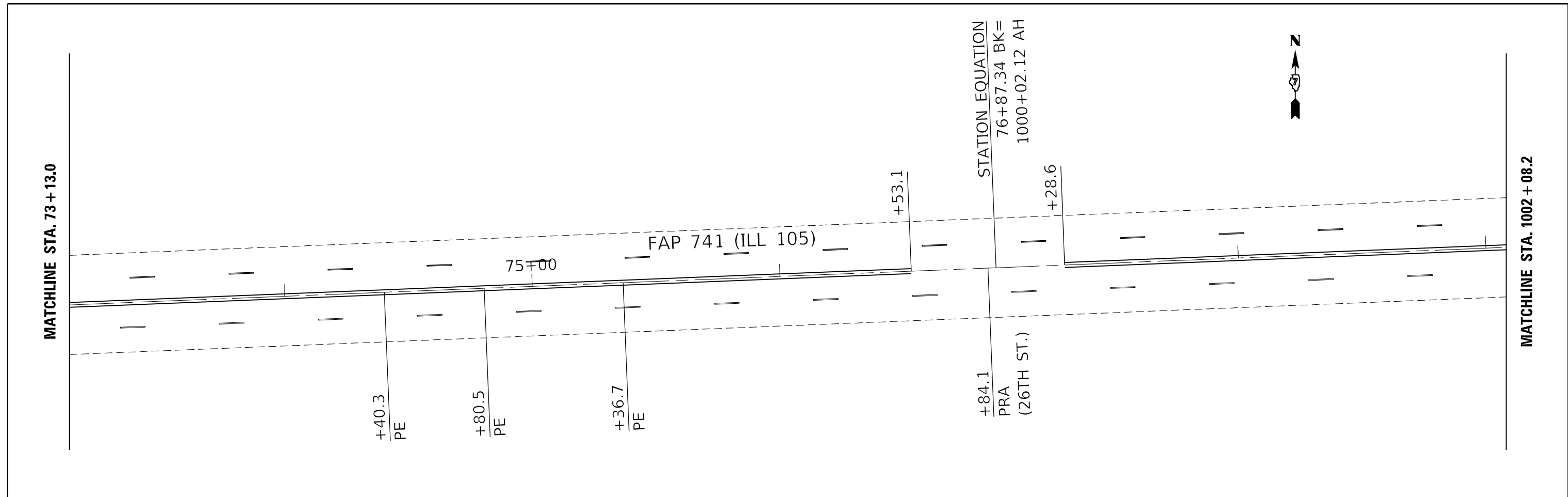

USER NAME = steffenmk	DESIGNED - LMH	REVISED -
	DRAWN - LMH	REVISED -
PLOT SCALE = 40,0000 ' / in.	CHECKED -	REVISED -
PLOT DATE = 2/11/2021	DATE - 2/11/2021	REVISED -

**STATE OF ILLINOIS
 DEPARTMENT OF TRANSPORTATION**

PLAN SHEET

SCALE: 40,0000 ' / in. SHEET OF SHEETS STA. TO STA.

F.A.P. RTE.	SECTION	COUNTY	TOTAL SHEETS	SHEET NO.
741	D7 HMA RESURF 2021-3	MACON	18	9
CONTRACT NO. 74A37				
ILLINOIS FED. AID PROJECT				

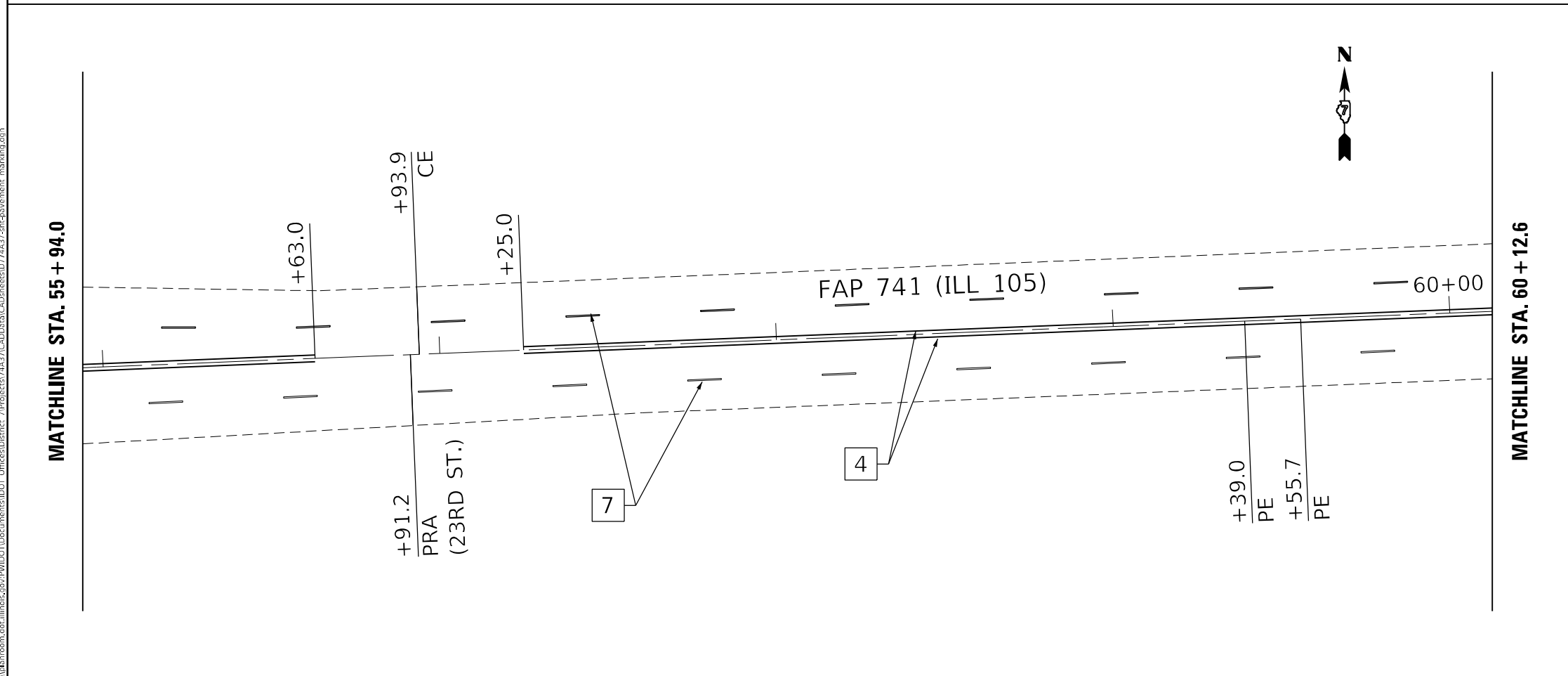
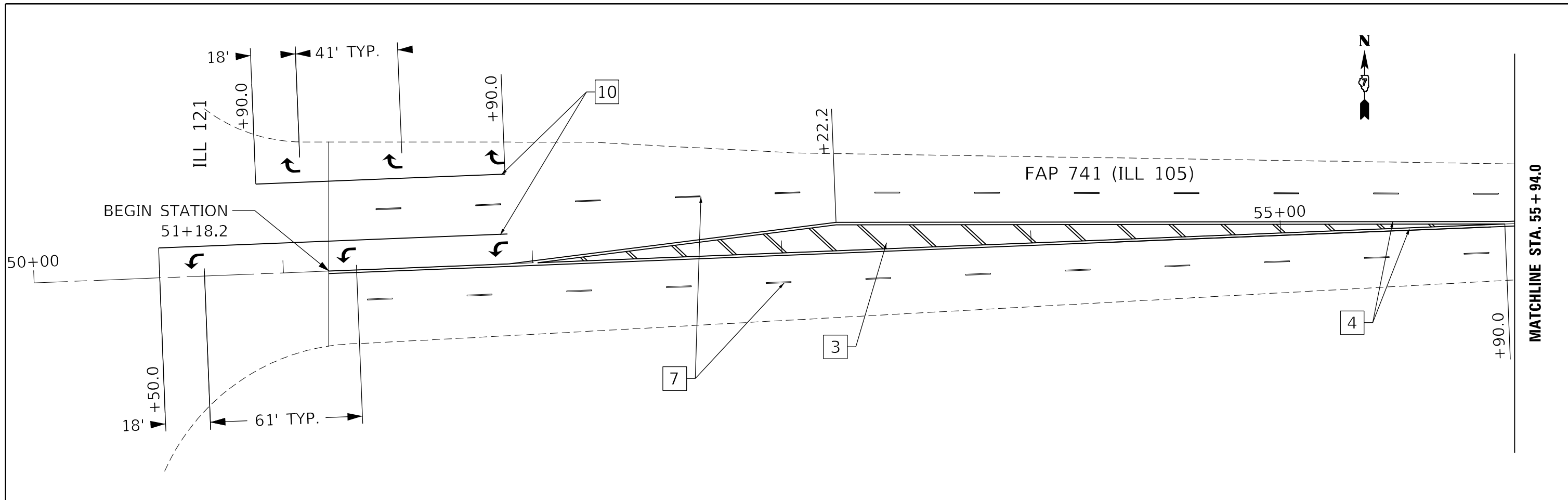

THERMOPLASTIC PAVEMENT MARKING LEGEND

1	4" (100) SKIP-DASH (YELLOW)	
2	4" (100) SOLID (YELLOW)	
3	12" (300) DIAGONAL (YELLOW)	
4	4" (100) DOUBLE YELLOW (NARROW)	
5	12" (300) SOLID WHITE	
6	8" (100) SOLID YELLOW	
7	6" (150) SKIP-DASH (WHITE)	
8	4" (100) SOLID (WHITE)	
9	12" (300) DIAGONAL (WHITE)	
10	6" (150) SOLID (WHITE)	
11	24" (600) STOP BAR (WHITE)	
12	8" (200) SOLID (WHITE)	
13	4" (100) PARKING WHITE	

NOT TO SCALE

MODEL: Default
 FILE NAME: p:\pub\harronm.dwg
 PROJECT: 74A37-3
 OFFICE: DISTRICT 7
 DATE: 2/16/2021

USER NAME	= steffenmk	DESIGNED	- LMH	REVISED	-
DRAWN	- LMH	CHECKED	-	REVISI	-
PLOT SCALE	= 40,0000 * / in.	DATE	- 2/16/2021	REVISI	-

**STATE OF ILLINOIS
DEPARTMENT OF TRANSPORTATION**

PAVEMENT MARKING DETAIL

SCALE: 40,0000 ' / in. SHEET OF SHEETS STA. TO STA.

F.A.P. RTE.	SECTION	COUNTY	TOTAL SHEETS	SHEET NO.
741	D7 HMA RESURF 2021-3	MACON	18	10
CONTRACT NO. 74A37				
ILLINOIS FED. AID PROJECT				

MODEL: Default
 FILE NAME: pavimarkroom.dwg
 PROJECT: 74A37-CADDData-CAD-Details-0774A37-24th-governent-marking.dgn

MATCHLINE STA. 60 + 12.6

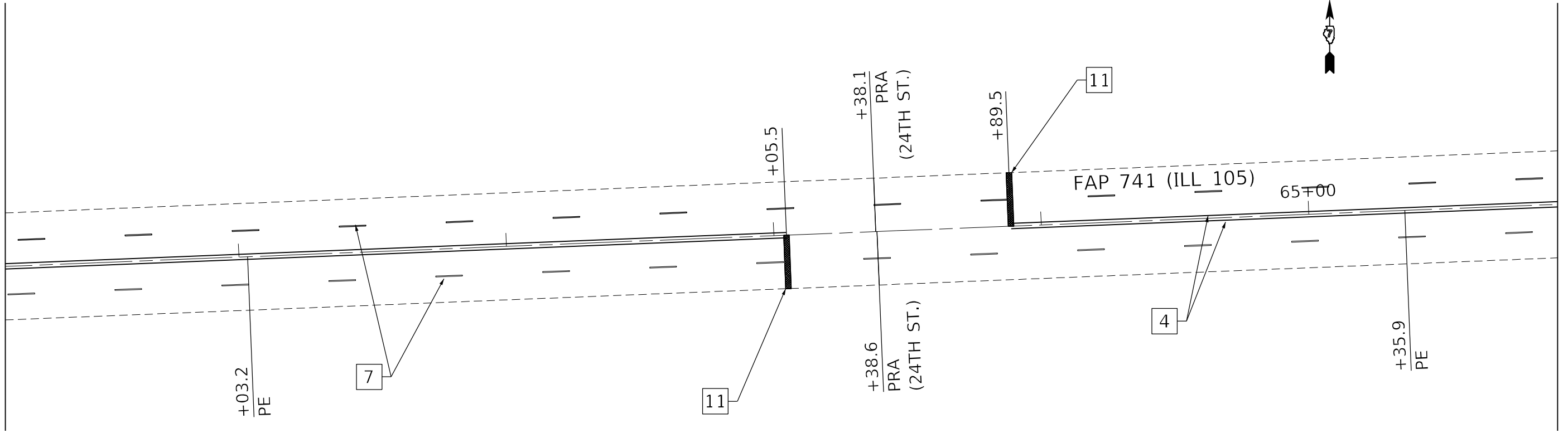

MATCHLINE STA. 65 + 93.1

MATCHLINE STA. 65 + 93.1

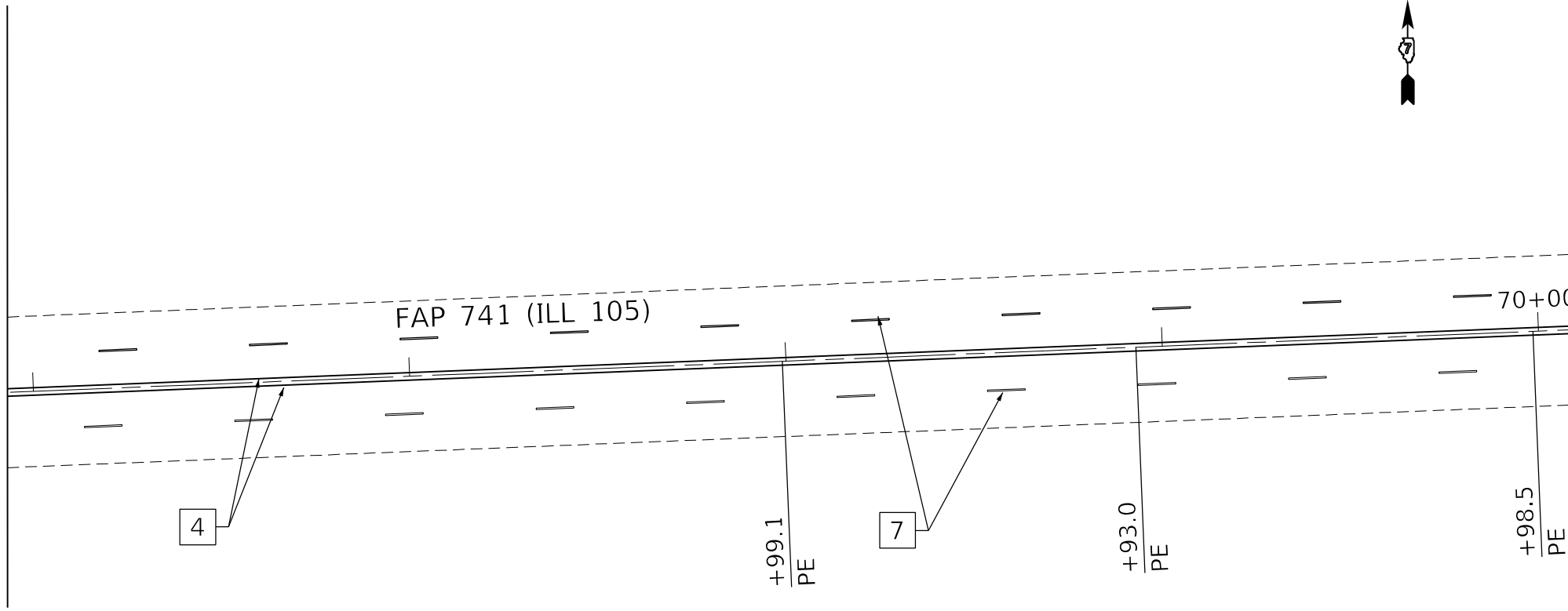

MATCHLINE STA. 70 + 09.1

THERMOPLASTIC PAVEMENT MARKING LEGEND

- 1 4" (100) SKIP-DASH (YELLOW)
- 2 4" (100) SOLID (YELLOW)
- 3 12" (300) DIAGONAL (YELLOW)
- 4 4" (100) DOUBLE YELLOW (NARROW)
- 5 12" (300) SOLID WHITE
- 6 8" (100) SOLID YELLOW
- 7 6" (150) SKIP-DASH (WHITE)
- 8 4" (100) SOLID (WHITE)
- 9 12" (300) DIAGONAL (WHITE)
- 10 6" (150) SOLID (WHITE)
- 11 24" (600) STOP BAR (WHITE)
- 12 8" (200) SOLID (WHITE)
- 13 4" (100) PARKING WHITE

NOT TO SCALE

USER NAME = steffenmk	DESIGNED - LMH	REVISED -
DRAWN - LMH	REVISOR -	
PLOT SCALE = 40,0000 * / in.	CHECKED -	REVISOR -
PLOT DATE = 2/16/2021	DATE - 2/16/2021	REVISOR -

**STATE OF ILLINOIS
 DEPARTMENT OF TRANSPORTATION**

PAVEMENT MARKING DETAIL

SCALE: 40,0000 ' / in. SHEET OF SHEETS STA. TO STA.

F.A.P. RTE.	SECTION	COUNTY	TOTAL SHEETS	SHEET NO.
741	D7 HMA RESURF 2021-3	MACON	18	11
CONTRACT NO. 74A37				
ILLINOIS FED. AID PROJECT				

MODEL: Default
 FILE NAME: pavement.mxd
 PROJECT: 74A37-CADD/DBA/CADD/DBA/74A37-2/2021/PAVEMENT MARKING.dgn

MATCHLINE STA. 70 + 09.1

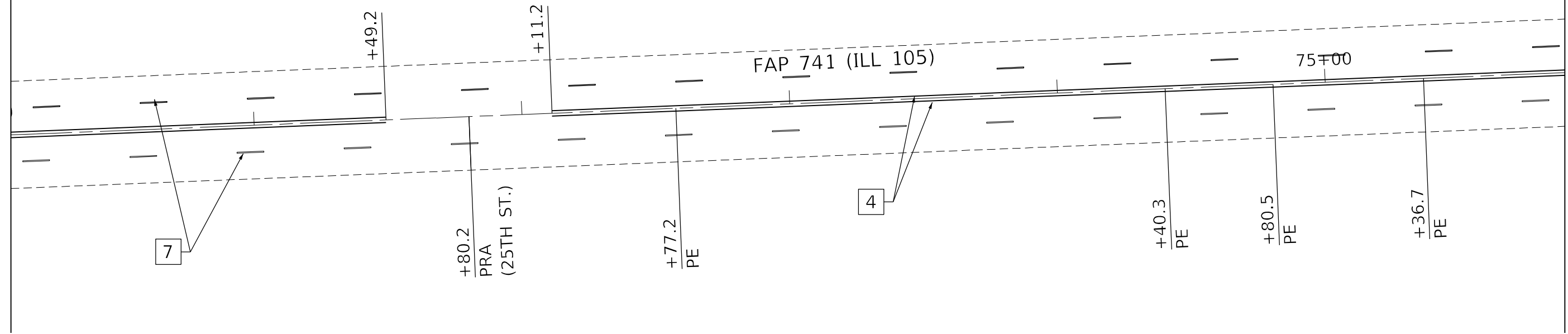

MATCHLINE STA. 75 + 89.6

MATCHLINE STA. 75 + 89.6

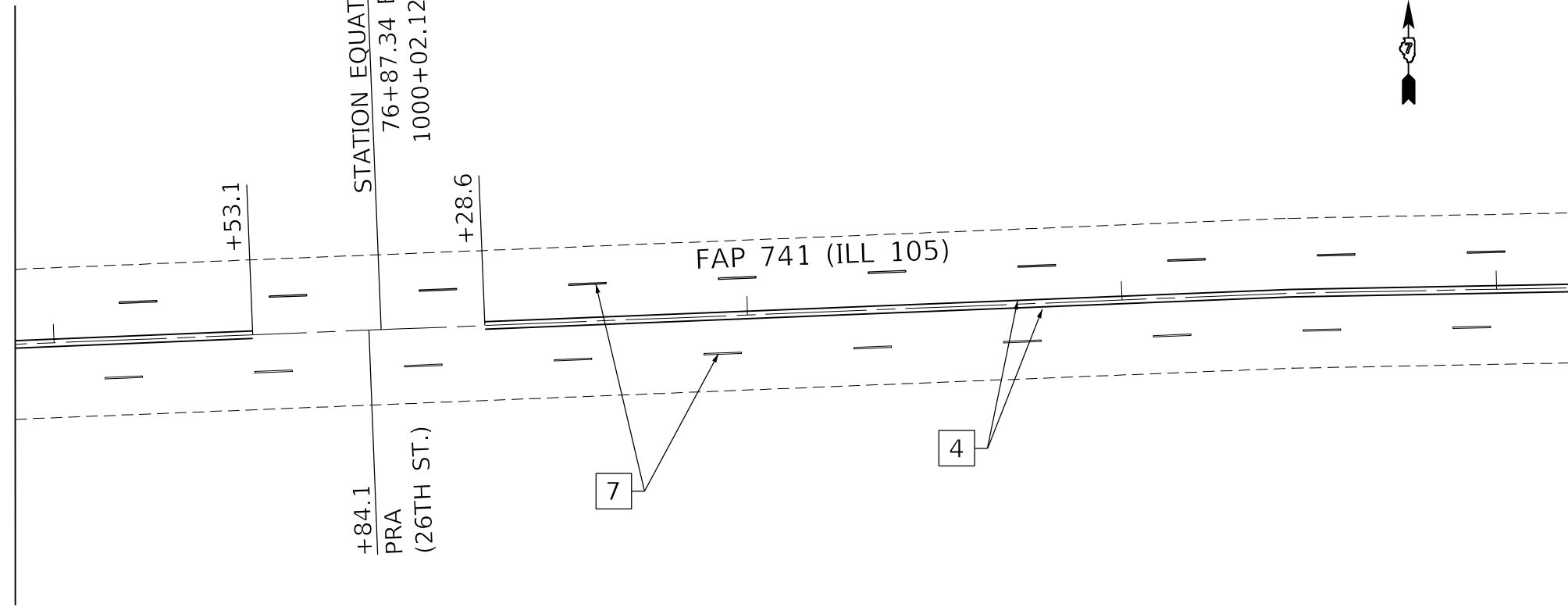

MATCHLINE STA. 1003 + 20.3

THERMOPLASTIC PAVEMENT MARKING LEGEND

- 1 4" (100) SKIP-DASH (YELLOW)
- 2 4" (100) SOLID (YELLOW)
- 3 12" (300) DIAGONAL (YELLOW)
- 4 4" (100) DOUBLE YELLOW (NARROW)
- 5 12" (300) SOLID WHITE
- 6 8" (100) SOLID YELLOW
- 7 6" (150) SKIP-DASH (WHITE)
- 8 4" (100) SOLID (WHITE)
- 9 12" (300) DIAGONAL (WHITE)
- 10 6" (150) SOLID (WHITE)
- 11 24" (600) STOP BAR (WHITE)
- 12 8" (200) SOLID (WHITE)
- 13 4" (100) PARKING WHITE

NOT TO SCALE

USER NAME = steffenmk	DESIGNED - LMH	REVISED -
DRAWN - LMH	REVISOR -	REVISIONS -
PLOT SCALE = 40,0000 * / in.	CHECKED -	REVISOR -
PLOT DATE = 2/11/2021	DATE - 2/11/2021	REVISOR -

**STATE OF ILLINOIS
 DEPARTMENT OF TRANSPORTATION**

PAVEMENT MARKING DETAIL

SCALE: 40,0000 ' / in. SHEET OF SHEETS STA. TO STA.







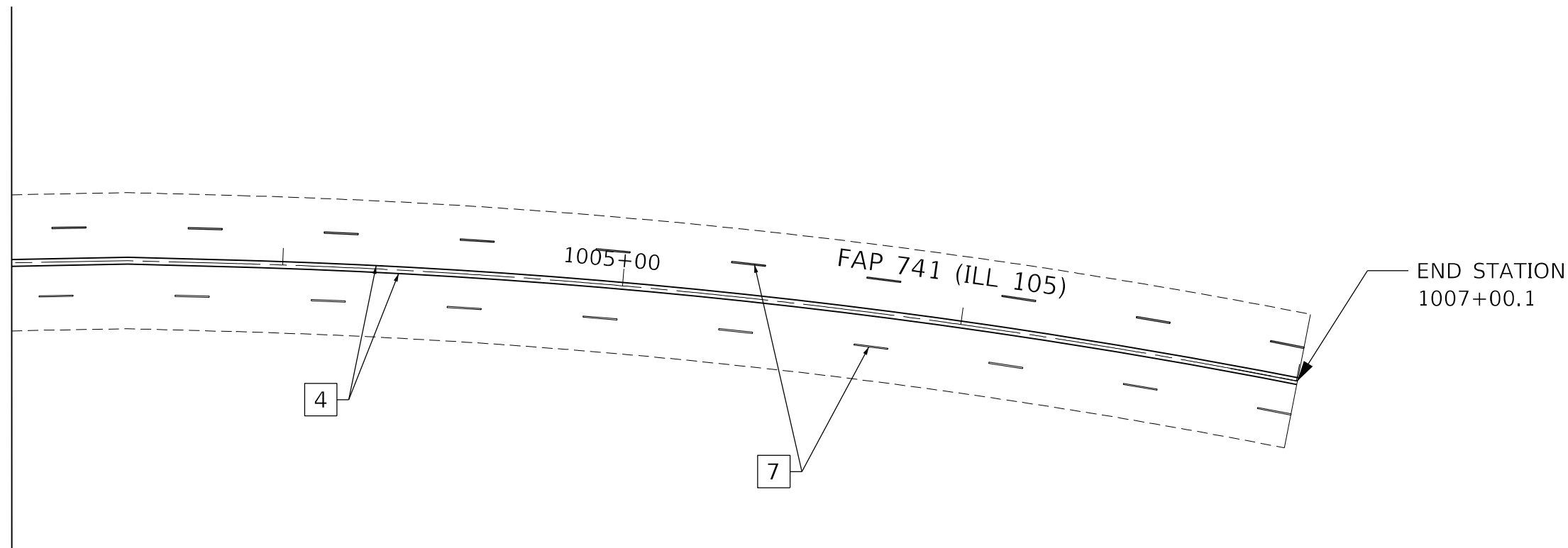

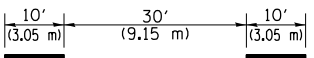
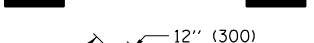

F.A.P. RTE.	SECTION	COUNTY	TOTAL SHEETS	SHEET NO.
741	D7 HMA RESURF 2021-3	MACON	18	12
CONTRACT NO. 74A37				
ILLINOIS		FED. AID PROJECT		

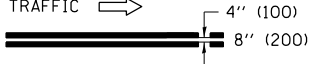
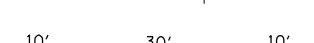
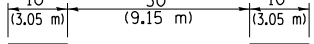

MATCHLINE STA. 1003 + 20.3

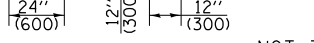

THERMOPLASTIC PAVEMENT MARKING LEGEND

- 1 4" (100) SKIP-DASH (YELLOW) 
- 2 4" (100) SOLID (YELLOW) 
- 3 12" (300) DIAGONAL (YELLOW) 
- 4 4" (100) DOUBLE YELLOW (NARROW) 
- 5 12" (300) SOLID WHITE 
- 6 8" (100) SOLID YELLOW 
- 7 6" (150) SKIP-DASH (WHITE) 
- 8 4" (100) SOLID (WHITE) 
- 9 12" (300) DIAGONAL (WHITE) 
- 10 6" (150) SOLID (WHITE) 
- 11 24" (600) STOP BAR (WHITE) 
- 12 8" (200) SOLID (WHITE) 
- 13 4" (100) PARKING WHITE 

NOT TO SCALE

MODEL: Default
FILE NAME: p:\pub\harronm.dwg
PROJECT: 741A37-CADD\Drawings\DOT_Offices\Drawings\741A37-4th-Pavement_Markings.dgn

USER NAME = steffenmk	DESIGNED - LMH	REVISED -
	DRAWN - LMH	REVISED -
PLOT SCALE = 40,0000 * / in.	CHECKED -	REVISED -
PLOT DATE = 2/11/2021	DATE - 2/11/2021	REVISED -

**STATE OF ILLINOIS
DEPARTMENT OF TRANSPORTATION**

PAVEMENT MARKING DETAIL

SCALE: 40,0000 ' / in. SHEET OF SHEETS STA. TO STA.

F.A.P. RTE.	SECTION	COUNTY	TOTAL SHEETS	SHEET NO.
741	D7 HMA RESURF 2021-3	MACON	18	13
CONTRACT NO. 74A37				
ILLINOIS		FED. AID PROJECT		

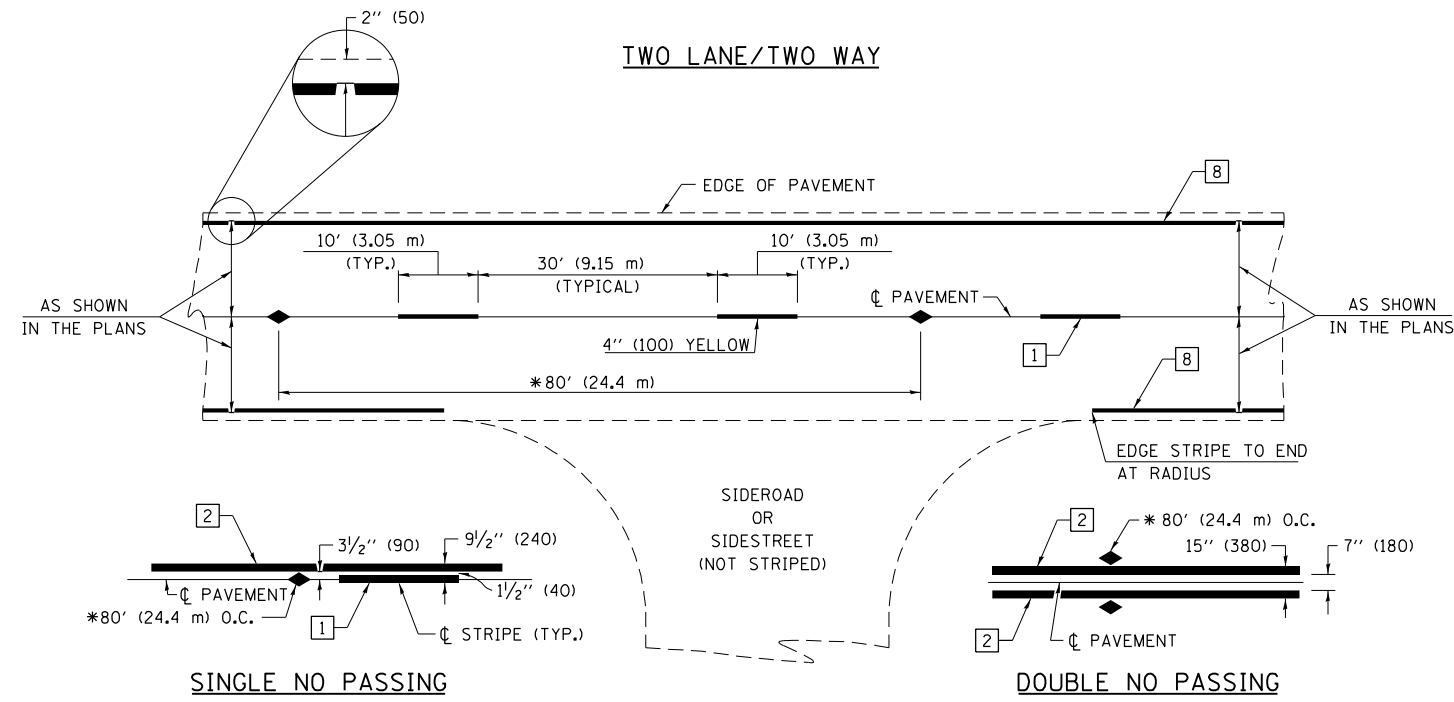

* REDUCE TO 40' (12.2 m) O.C. ON CURVES WITH POSTED OR ADVISORY SPEEDS OF 45 mph (70 km/h) OR LESS.

PAVEMENT MARKING LEGEND

- 1 4" (100) SKIP-DASH (YELLOW)
 - 2 4" (100) SOLID (YELLOW)
 - 3 12" (300) DIAGONAL (YELLOW)
 - 4 4" (100) DOUBLE YELLOW (NARROW)
 - 5 12" (300) SOLID WHITE
 - 6 RESERVED
 - 7 6" (150) SKIP-DASH (WHITE)
 - 8 4" (100) SOLID (WHITE)
 - 9 12" (300) DIAGONAL (WHITE)
 - 10 6" (150) SOLID (WHITE)
 - 11 24" (600) STOP BAR (WHITE)
 - 12 8" (200) SOLID (WHITE)
 - 13 4" (100) PARKING WHITE
-

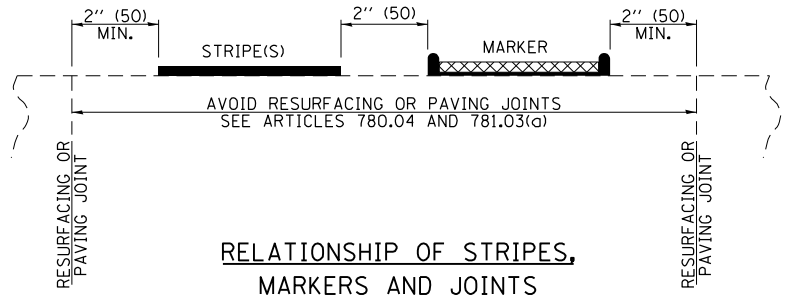

TYPICAL PAVEMENT MARKERS LEGEND

- ◆ TWO-WAY AMBER MARKER
- ▶ ONE-WAY AMBER MARKER
- ▷ ONE-WAY CRYSTAL MARKER

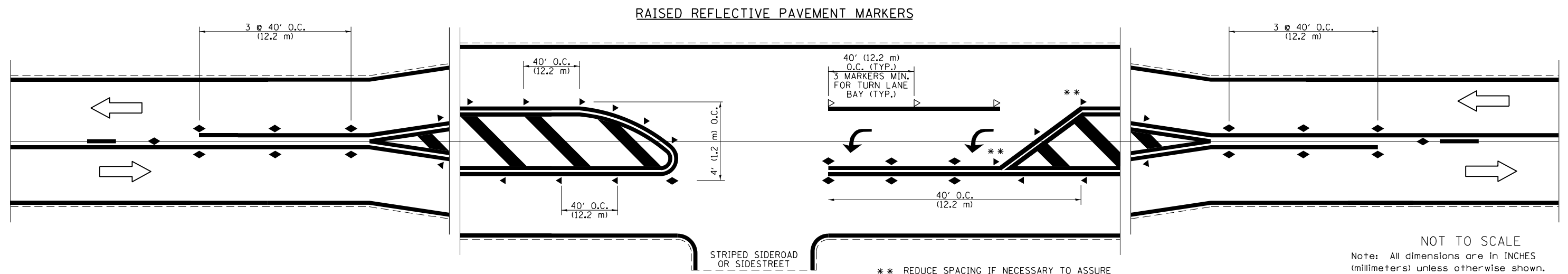

NOT TO SCALE
 Note: All dimensions are in INCHES (millimeters) unless otherwise shown.

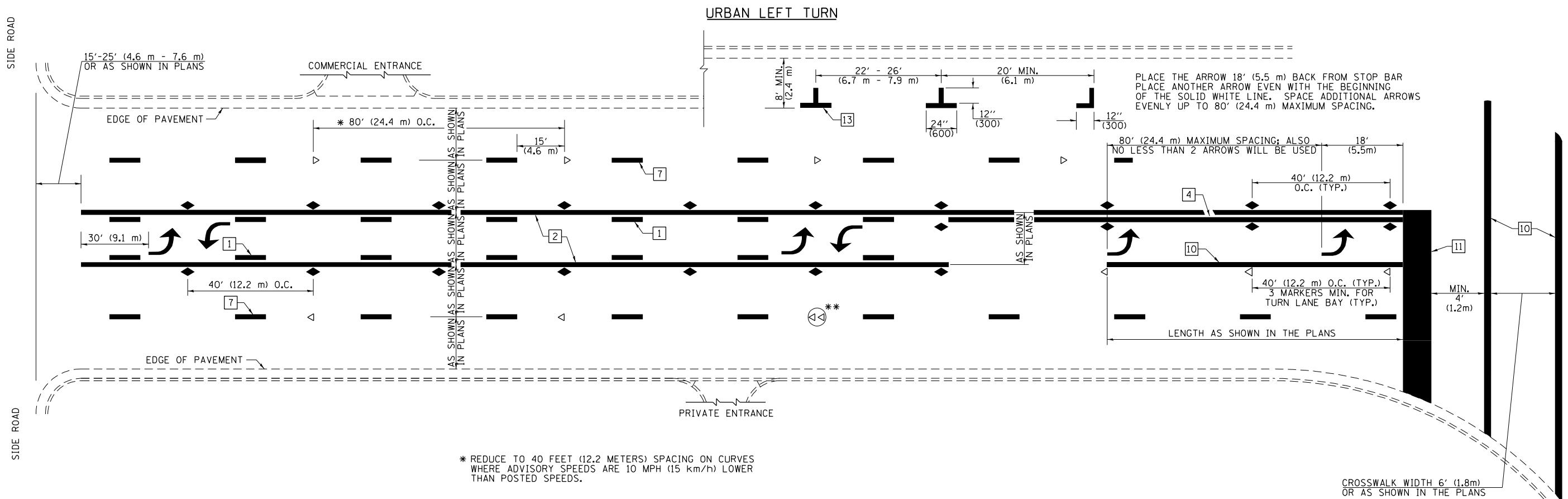

- * REDUCE TO 40 FEET (12.2 METERS) SPACING ON CURVES WHERE ADVISORY SPEEDS ARE 10 MPH (15 km/h) LOWER THAN POSTED SPEEDS.
- ** DOUBLE LANE LINE MARKERS SHALL BE SPECIFIED AND SPACED AS SHOWN IN HIGHWAY STANDARD 781001 FOR MULTI-LANE DIVIDED AND UNDIVIDED HIGHWAYS.

PAVEMENT MARKING LEGEND

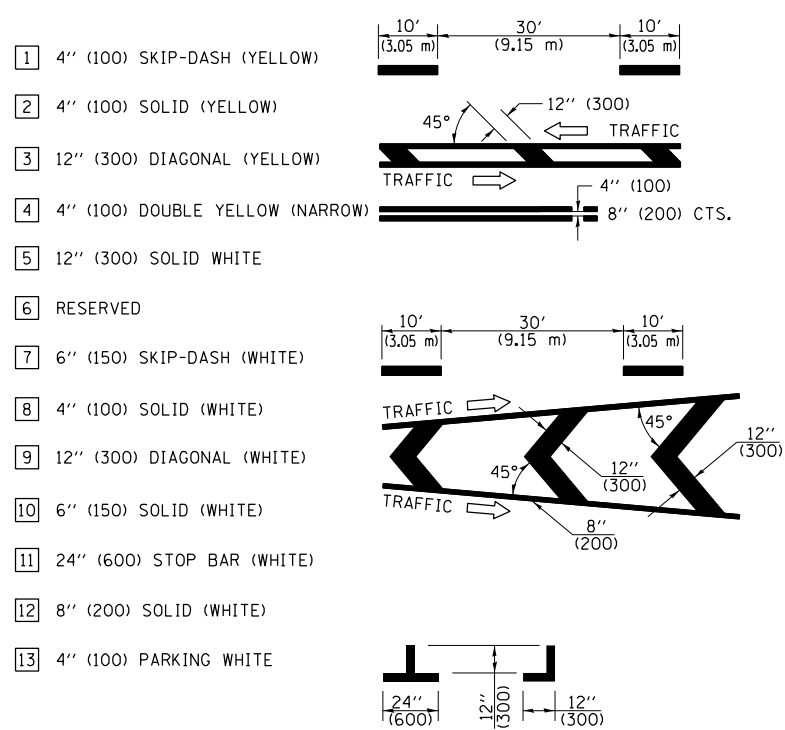

GENERAL NOTES

1. TURN ARROW PAIRS SHALL BE PLACED AT 250' (75 m) INTERVALS AND SHALL BE EVENLY SPACED BETWEEN BOTH ENDS OF THE BIDIRECTIONAL LEFT TURN LANE. USE A MINIMUM OF TWO PAIRS PER BLOCK.
2. THE SOLID YELLOW PAVEMENT MARKINGS [2] SHOULD GENERALLY START OR END NEAR THE RADIUS POINT OF EACH STREET RETURN EXCEPT WHERE ONE OR BOTH ENDS WOULD INCLUDE STOP BARS.
3. THE SKIP-DASH PAVEMENT MARKINGS [1] OR [7] SHOULD BE CENTERED BETWEEN BOTH ENDS OF EACH CITY BLOCK AND SHALL BE PLACED SO THEY LINE UP ACROSS FROM EACH OTHER.
4. USE LARGE ARROW SIZE FOR BOTH RURAL AND URBAN LOCATIONS. (SEE LAST PAGE OF SECTION 780x FOR SYMBOLS TABLE)
5. LANE LINE EXTENSIONS SHALL BE THE SAME COLOR AND WIDTH AS THE LANE LINE BEING EXTENDED.

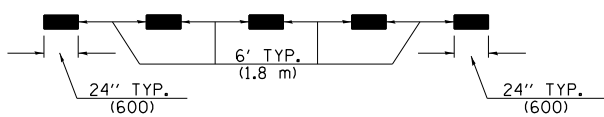

LANE LINE EXTENSIONS

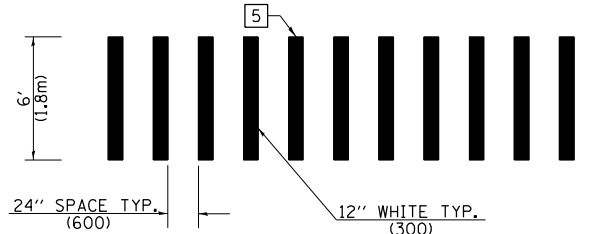

CROSSWALK DETAIL (DECATUR CITY LIMITS ONLY)

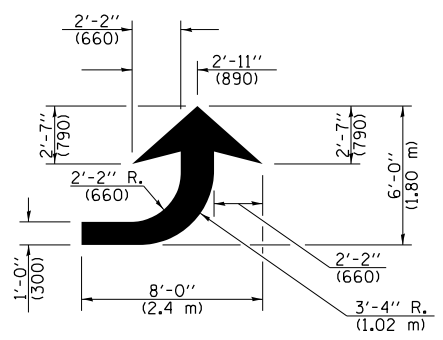

LEFT ARROW

REVERSE FOR RIGHT ARROW
AREA = 15.6 SQ. FT. (1.47 m²)
(WHITE)

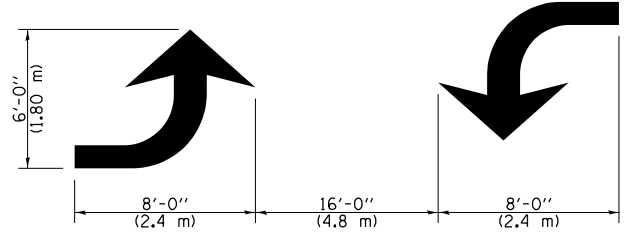

TYPICAL DOUBLE TURN ARROWS (WHITE)

NOT TO SCALE

Note: All dimensions are in INCHES (millimeters) unless otherwise shown.

FILE NAME =	USER NAME = steffenk	DESIGNED -	REVISED -	STATE OF ILLINOIS DEPARTMENT OF TRANSPORTATION	PAVEMENT MARKING AND RAISED REFLECTIVE PAVEMENT MARKERS (RURAL & URBAN APPLICATIONS)			F.A.P. RTE.	SECTION	COUNTY	TOTAL SHEETS	SHEET NO.
pw:\planning\dot.illinois.gov\PWIDOT\Documents\IDOT Offices\District 7\Projects\74A37\DRAWING\CADsheets\0774A37-sht-details.dgn	DESIGNED -	REVISED -	741					D7 HMA RESURF 2021-3	MACON	18	15	
PLOT SCALE = 2.0000' / in.	CHECKED -	REVISED -	CONTRACT NO. 74A37									
PLOT DATE = 2/11/2021	DATE -	REVISED -	ILLINOIS FED. AID PROJECT									
					SCALE: NO SCALE	SHEET NO. 2 OF 4 SHEETS	STA. TO STA.					

ISLAND

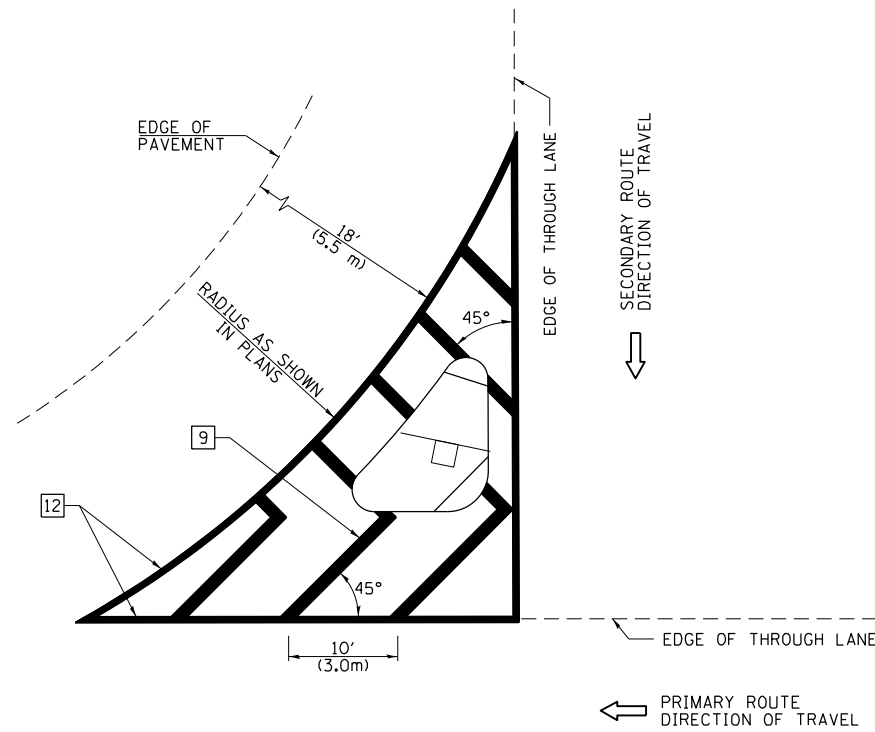

GENERAL NOTES

1. RAISED AND CORRUGATED MEDIANS SHALL BE OUTLINED WITH [2] IF PRESENT.
2. SOME OF THE INFORMATION INCLUDED WITH THIS DETAIL MAY NOT BE APPLICABLE TO THIS IMPROVEMENT.
3. PAVEMENT MARKINGS ARE TO BE EXTENDED THROUGH OMISSIONS WHEN APPLICABLE.
4. FINAL PAVEMENT MARKINGS SHALL BE IN PLACE PRIOR TO PLACING ANY RAISED REFLECTIVE PAVEMENT MARKERS.
5. THE FOLLOWING CRITERIA SHALL BE USED FOR SELECTING THE DIAGONAL PAVEMENT MARKING SPACING:

< 30 MPH (< 50 km/h)	15' (4.5 m)
30-45 MPH (50-75 km/h)	20' (6.0 m)
> 45 MPH (> 75 km/h)	30' (9.0 m)

PAVEMENT MARKING LEGEND

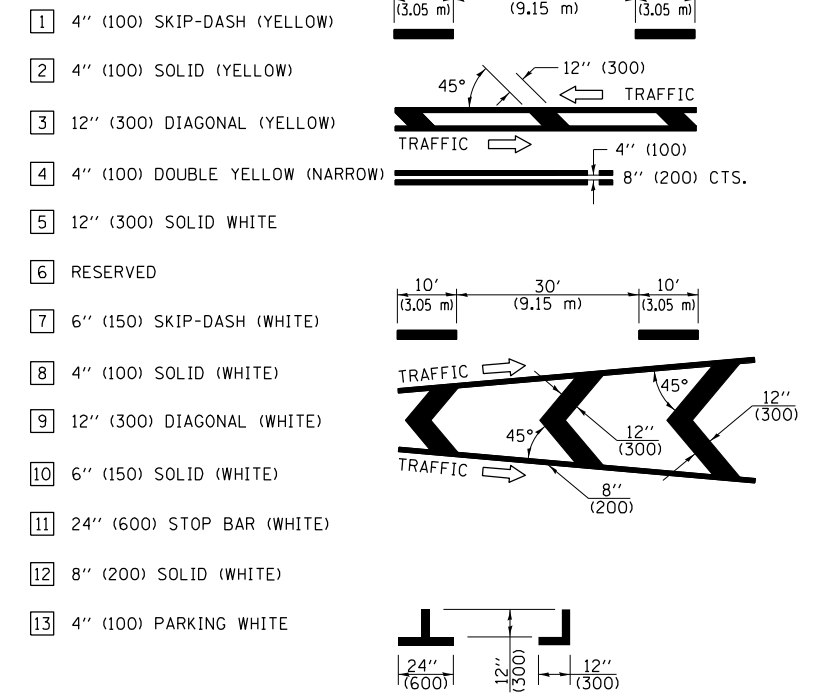

RURAL LEFT TURN STRIPING

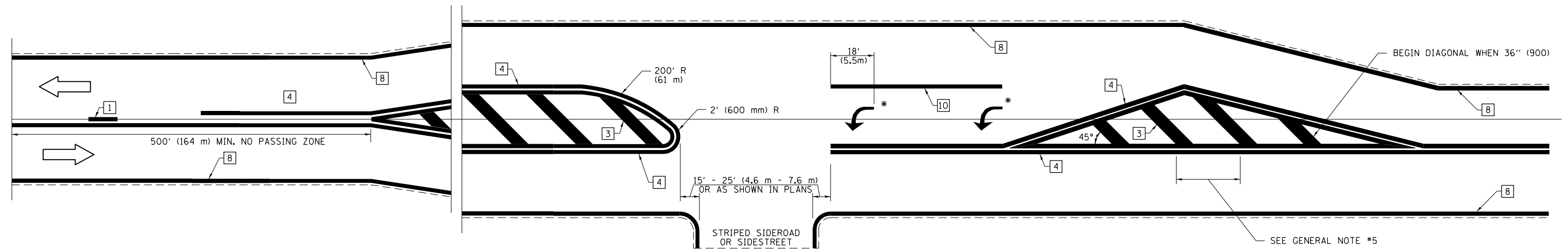

* PLACE AN ARROW 18' (5.5 m) BACK FROM STOP BAR. PLACE ANOTHER ARROW EVEN WITH THE BEGINNING OF THE SOLID WHITE LINE. SPACE ADDITIONAL ARROWS EVENLY UP TO 80' (24.4 m) MAXIMUM SPACING. USE MINIMUM OF 2 ARROWS.

NOT TO SCALE
Note: All dimensions are in INCHES (millimeters) unless otherwise shown.

DISTRICT 7 DETAIL NO. 7800001

FILE NAME =	USER NAME = steffenmk	DESIGNED -	REVISED -	STATE OF ILLINOIS DEPARTMENT OF TRANSPORTATION	PAVEMENT MARKING AND RAISED REFLECTIVE PAVEMENT MARKERS (RURAL & URBAN APPLICATIONS)	F.A.P. RTE.	SECTION	COUNTY	TOTAL SHEETS	SHEET NO.
pw:\planning\dot.illinois.gov\PIDOT\Documents\IDOT Offices\District 7\Projects\74A37\DRAWING\CADsheets\0774A37-sht-details.dgn	PLLOT SCALE = 2.0000' / in.	CHECKED -	REVISED -			741	D7 HMA RESURF 2021-3	MACON	18	16
PLLOT DATE = 2/11/2021	DATE -	REVISED -	REVISED -			CONTRACT NO. 74A37				
ILLINOIS FED. AID PROJECT										

PAVEMENT MARKINGS AT RAILROAD-HIGHWAY GRADE CROSSING

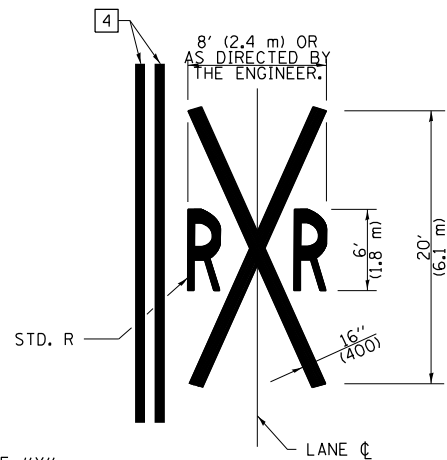
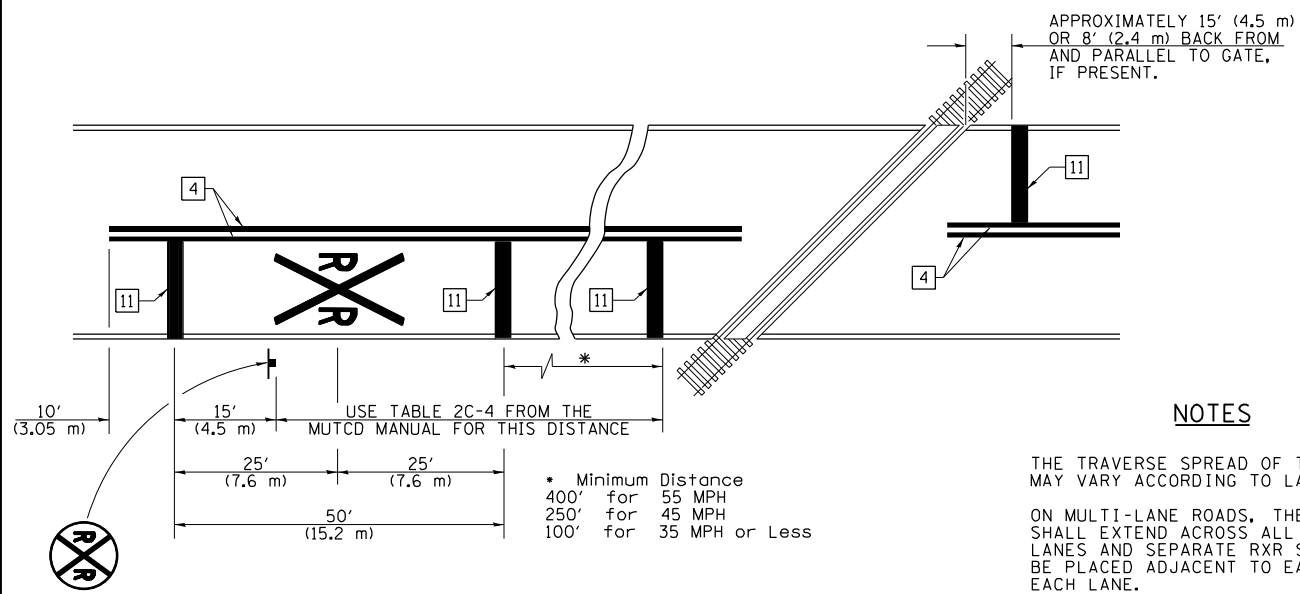

NOTES

THE TRAVERSE SPREAD OF THE "X" MAY VARY ACCORDING TO LANE WIDTH.

ON MULTI-LANE ROADS, THE STOP LINES SHALL EXTEND ACROSS ALL APPROACH LANES AND SEPARATE R X R SYMBOLS SHALL BE PLACED ADJACENT TO EACH OTHER IN EACH LANE.

WHEN THE PAVEMENT MARKING SYMBOL IS USED, A PORTION OF THE SYMBOL SHOULD BE LOCATED DIRECTLY ADJACENT TO THE ADVANCE WARNING SIGN (W10-1) AS PLACED BY TABLE II-1, CONDITION B OF THE MUTCD.

PAVEMENT MARKING LEGEND

- 1 4" (100) SKIP-DASH (YELLOW)
- 2 4" (100) SOLID (YELLOW)
- 3 12" (300) DIAGONAL (YELLOW)
- 4 4" (100) DOUBLE YELLOW (NARROW)
- 5 12" (300) SOLID WHITE
- 6 RESERVED
- 7 6" (150) SKIP-DASH (WHITE)
- 8 4" (100) SOLID (WHITE)
- 9 12" (300) DIAGONAL (WHITE)
- 10 6" (150) SOLID (WHITE)
- 11 24" (600) STOP BAR (WHITE)
- 12 8" (200) SOLID (WHITE)
- 13 4" (100) PARKING WHITE

RAILROAD CROSSING WITH INTERCONNECT ONLY

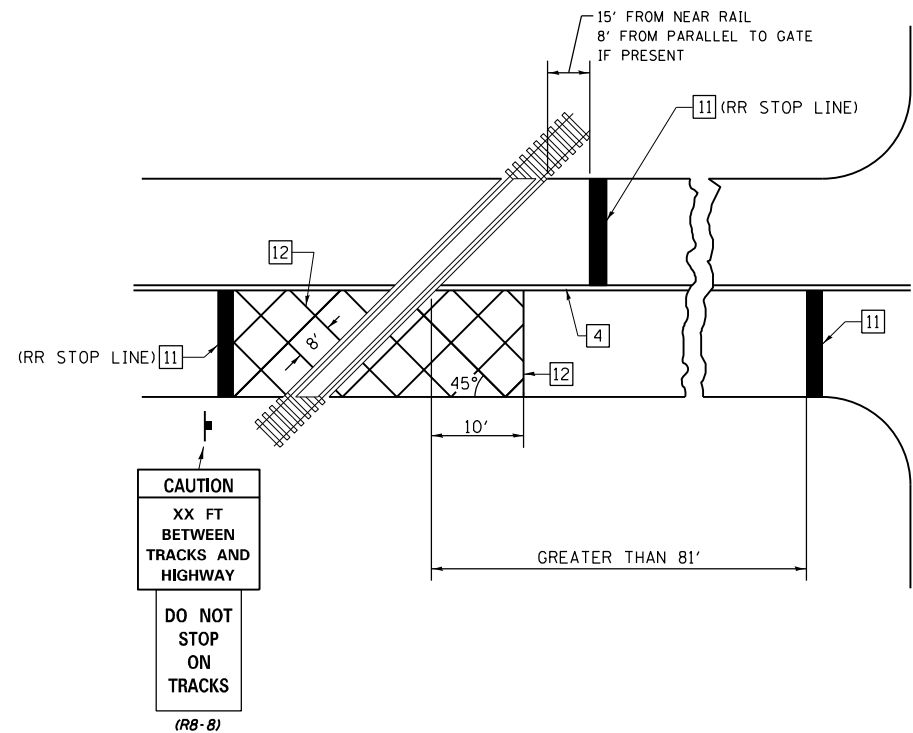

RAILROAD CROSSING WITH INTERCONNECT AND PRE-SIGNALS

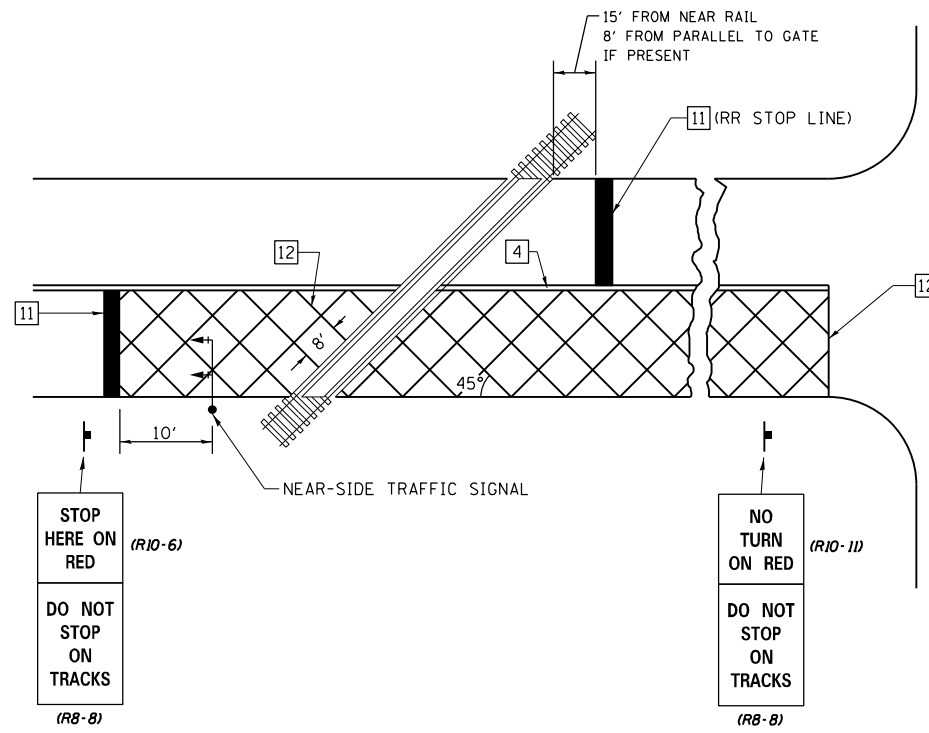

GENERAL NOTES

- SUPPLEMENTAL PAVEMENT MARKINGS TO BE INSTALLED ONLY ON APPROACHES TO INTERSECTIONS CONTROLLED BY TRAFFIC SIGNALS WHICH ARE INTERCONNECTED WITH THE RAILROAD WARNING SIGNALS.
- EXTEND PAVEMENT MARKINGS TO THE INTERSECTION ONLY WHERE NEAR-SIDE TRAFFIC SIGNALS ARE USED.

SUPPLEMENTAL PAVEMENT MARKING TREATMENT FOR RAILROAD-HIGHWAY GRADE CROSSING

NOT TO SCALE

Note: All dimensions are in INCHES (millimeters) unless otherwise shown.

DISTRICT 7 DETAIL NO. 7800001

FILE NAME =	USER NAME = steffenk	DESIGNED -	REVISED -
pw:\planroom.dot.illinois.gov\PIWIDOT\Documents\IDOT Offices\District 7\Projects\74A37\DRAWING\CADsheets\0774A37-sht-details.dgn		REVISIONS	REVISED -
	PLOT SCALE = 2.0000' / in.	CHECKED -	REVISED -
	PLOT DATE = 2/11/2021	DATE -	REVISED -

STATE OF ILLINOIS
DEPARTMENT OF TRANSPORTATION

PAVEMENT MARKING AND RAISED REFLECTIVE PAVEMENT MARKERS
(RURAL & URBAN APPLICATIONS)

SCALE: NO SCALE SHEET NO. 4 OF 4 SHEETS STA. TO STA.

F.A.P. RTE.	SECTION	COUNTY	TOTAL SHEETS	SHEET NO.
741	D7 HMA RESURF 2021-3	MACON	18	17
CONTRACT NO. 74A37				
ILLINOIS FED. AID PROJECT				

TYPICAL APPLICATION OF DETECTOR LOOPS

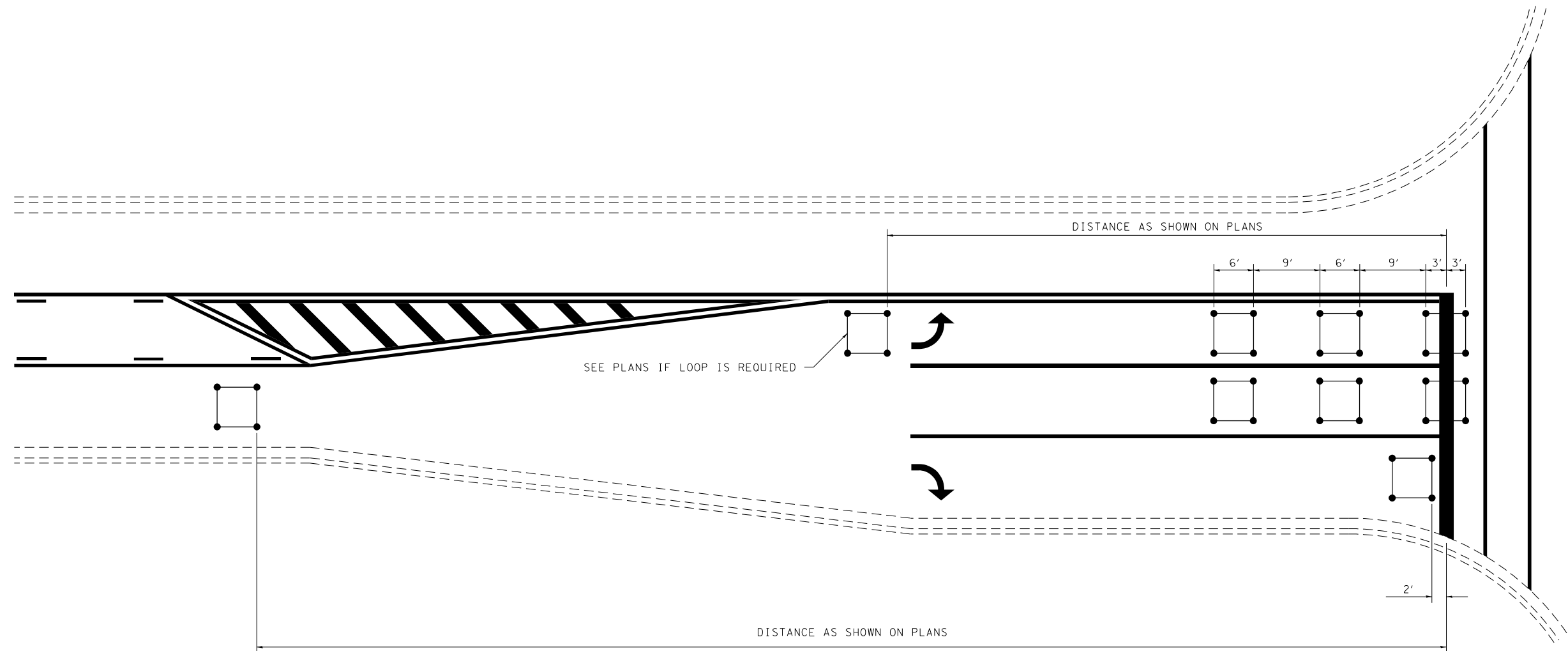

NOTE:

1. EACH LOOP SHALL HAVE ITS OWN HOMERUN TO THE GULFBOX/HANDHOLE.
2. LOOPS SHOULD BE CENTERED IN EACH LANE.
3. USE 6' BY 6' LOOPS FOR LANE WIDTHS OF 11' OR GREATER.
4. USE 5' BY 5' LOOPS IF LANE WIDTH IS LESS THAN 11'.

NOT TO SCALE

DISTRICT 7 DETAIL NO. 88600100

FILE NAME =	USER NAME = steffenmk	DESIGNED -	REVISED - MKS 4-08
pw:\planroom.dot.illinois.gov\PIDOT\Documents\IDOT Offices\District 7\Projects\74A37\DRAWING\CADsheets\D774A37-sht-details.dgn		DRAWN -	REVISED -
	PLOT SCALE = 2.0000' / in.	CHECKED -	REVISED -
	PLOT DATE = 2/11/2021	DATE -	REVISED -

**STATE OF ILLINOIS
DEPARTMENT OF TRANSPORTATION**

TYPICAL APPLICATIONS OF DETECTOR LOOPS

SCALE: NO SCALE SHEET NO. OF SHEETS STA. TO STA.

F.A.P. RTE.	SECTION	COUNTY	TOTAL SHEETS	SHEET NO.
741	D7 HMA RESURF 2021-3	MACON	18	18
FED. ROAD DIST. NO. ILLINOIS FED. AID PROJECT			CONTRACT NO. 74A37	