

INDEX OF SHEETS

1. COVER SHEET
2. GENERAL NOTES
3. SUMMARY OF QUANTITIES
4. TYPICAL
5. SCHEDULES
6. DETAILS
7. TEMPORARY INFORMATION SIGNING

STANDARDS

000001-08	STANDARD SYMBOLS, ABBREVIATIONS AND PATTERNS
001006	DECIMAL OF AN INCH AND OF A FOOT
701001-02	OFF-ROAD OPERATIONS 2L, 2W, MORE THAN 15' (4.5 m) AWAY
701006-05	OFF-ROAD OPERATIONS 2L, 2W, 15' (4.5 m) TO 24" (600 mm) FROM PAVEMENT EDGE
701301-04	LANE CLOSURE, 2L, 2W, SHORT TIME OPERATIONS
701306-04	LANE CLOSURE, 2L, 2W, SLOW MOVING OPERATIONS DAY ONLY, FOR SPEEDS ≥ 45 MPH
701901-08	TRAFFIC CONTROL DEVICES

STATE OF ILLINOIS
DEPARTMENT OF TRANSPORTATION

PROPOSED HIGHWAY PLANS

F.A.P. ROUTE 786 (IL 170)
SECTION (110,111)G
AGGREGATE SHOULDERS
LASALLE & LIVINGSTON COUNTY

F.A.P. RTE.	SECTION	COUNTY	TOTAL SHEETS	SHEET NO.
786	(110,111)G	LASALLE/LIVINGSTON	7	1
ILLINOIS				

D-93-014-21

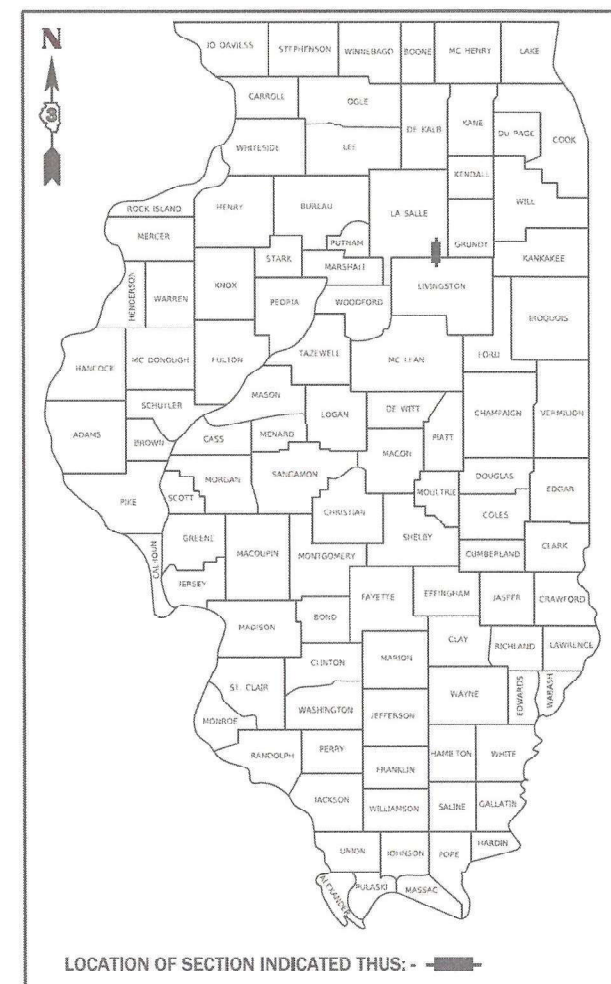

BEGIN IMPROVEMENT

N 21st RD.
LASALLE COUNTY
LOG MILE 0.00

C-93-045-21

END IMPROVEMENT

IL 17
LIVINGSTON COUNTY
LOG MILE 12.00

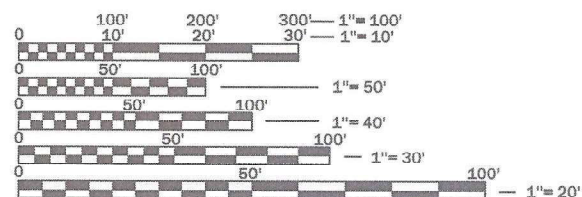
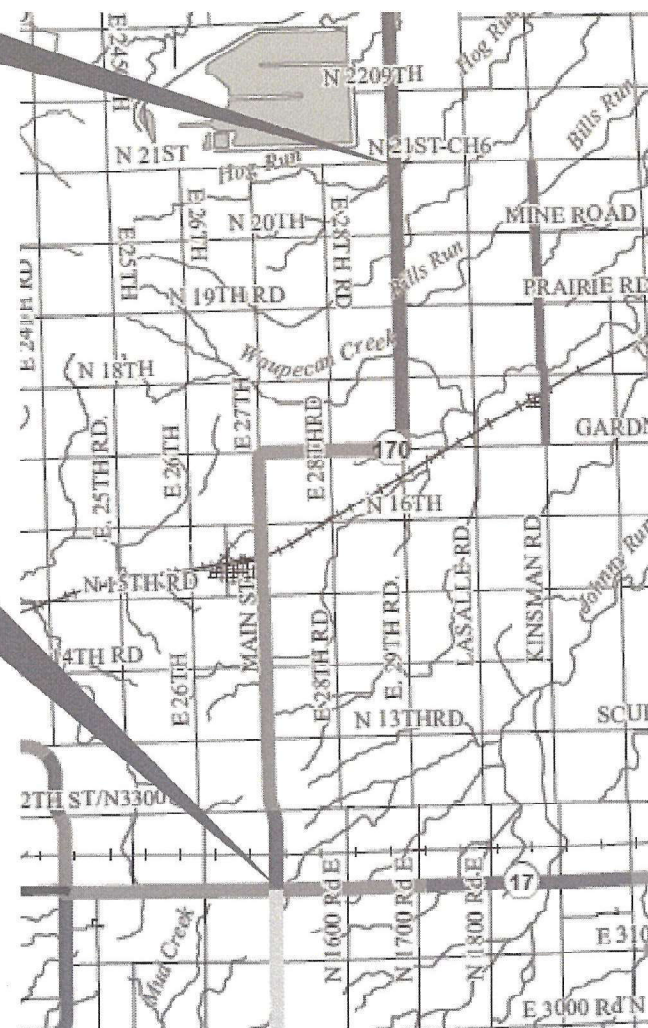

FULL SIZE PLANS HAVE BEEN PREPARED USING STANDARD ENGINEERING SCALES. REDUCED SIZED PLANS WILL NOT CONFORM TO STANDARD SCALES. IN MAKING MEASUREMENTS ON REDUCED PLANS, THE ABOVE SCALES MAY BE USED.

J.U.L.I.E.
JOINT UTILITY LOCATION INFORMATION FOR EXCAVATION
1-800-892-0123
OR 811

PROJECT ENGINEER: JOE KANNEL P.E.
UNIT CHIEF: RON WOODSHANK
DISTRICT 3 NO. (815) 434-6131
CONTRACT NO. 66L56

GROSS LENGTH = 63,360 FT. = 12.00 MILES
NET LENGTH = 63,360 FT. = 12.00 MILES

LASALLE/LIVINGSTON
COUNTY LINE
LOG MILE 11.00

FUNCTIONAL CLASSIFICATION

RURAL
STATE
F.A.P. ROUTE 786 (IL 170)
2019 ADT = 1263
P.V. 79.14% S.U. 7.54% M.U. 13.32%

STATE OF ILLINOIS
DEPARTMENT OF TRANSPORTATION

SUBMITTED February 02, 20 21
[Signature]
REGIONAL ENGINEER

March 19, 2021
[Signature]
ENGINEER OF DESIGN AND ENVIRONMENT

March 19, 2021
[Signature]
DIRECTOR OF HIGHWAYS PROJECT IMPLEMENTATION

**PRINTED BY THE AUTHORITY
OF THE STATE OF ILLINOIS**

GENERAL NOTES

THE AGGREGATE SHOULDERS SHALL BE CARRIED THROUGH ALL ENTRANCES AND SIDE ROADS WITH AGGREGATE SURFACE.

ALL EXCAVATED MATERIAL, WHICH INCLUDES DIGGING OR GRADING OF ANY SOIL OR FILL MATERIAL, WITH THE EXCEPTION OF AGGREGATE FILLS, MUST BE INCORPORATED WITHIN THE IDOT RIGHT OF WAY DUE TO ENVIRONMENTAL DOCUMENTATION REQUIREMENTS.

THE FOLLOWING RATES OF APPLICATION HAVE BEEN USED IN CALCULATING PLAN QUANTITIES:

GRANULAR MATERIALS	2.05	TONS / CU YD
--------------------	------	--------------

COMMITMENTS

STATE OF ILLINOIS
DEPARTMENT OF TRANSPORTATION
DISTRICT THREE
AS BUILT INFORMATION

SUPERVISING CONSTRUCTION FIELD ENGINEER

RESIDENT ENGINEER / TECHNICIAN

START & END DATES
OF CONSTRUCTION:

INSPECTORS:

STATE OF ILLINOIS
DEPARTMENT OF TRANSPORTATION
DISTRICT THREE

PREPARED BY: _____
DISTRICT STUDIES & PLANS ENGINEER

DATE: _____

EXAMINED BY: _____
DISTRICT CONSTRUCTION ENGINEER

DISTRICT MATERIALS ENGINEER

DISTRICT OPERATIONS ENGINEER

FILE NAME =	USER NAME = MARINEJ	DESIGNED - EM	REVISED - ____
pw:\planroom\dot\illinois.gov\PWIDOT\Documents\IDOT	offices\District 3\Projects\I366L56\CADData\I3xxxxx-shl-cover.d	DRAWN - EM	REVISED - ____
Default	PLOT SCALE = 1:8685' / mm	CHECKED - RW	REVISED - ____
	PLOT DATE = 12/14/2020	DATE - 12/14/2020	REVISED - ____

**STATE OF ILLINOIS
DEPARTMENT OF TRANSPORTATION**

GENERAL NOTES

SCALE: ____ SHEET 1 OF 1 SHEETS STA. ____ TO STA. ____

F.A.P. RTE.	SECTION	COUNTY	TOTAL SHEETS	SHEET NO.
786	(110,111)G	LASALLE/INGSTON	7	2
CONTRACT NO. 66L56				
ILLINOIS			FED. AID PROJECT	

CODE NO.	ITEM	UNIT	TOTAL QUANTITY	CONSTRUCTION CODE	
				CONTRACT MAINTENANCE	
				100% STATE	
				LIVINGSTON CO.	LASALLE CO.
				ROADWAY	ROADWAY
				0021	0021
				RURAL	RURAL
48102100	AGGREGATE WEDGE SHOULDER, TYPE B	TON	5014	4652	362
67100100	MOBILIZATION	L SUM	1	0.9	0.1
70100460	TRAFFIC CONTROL AND PROTECTION, STANDARD 701306	L SUM	1	0.9	0.1
Z0030850	TEMPORARY INFORMATION SIGNING	SQ FT	42	21	21

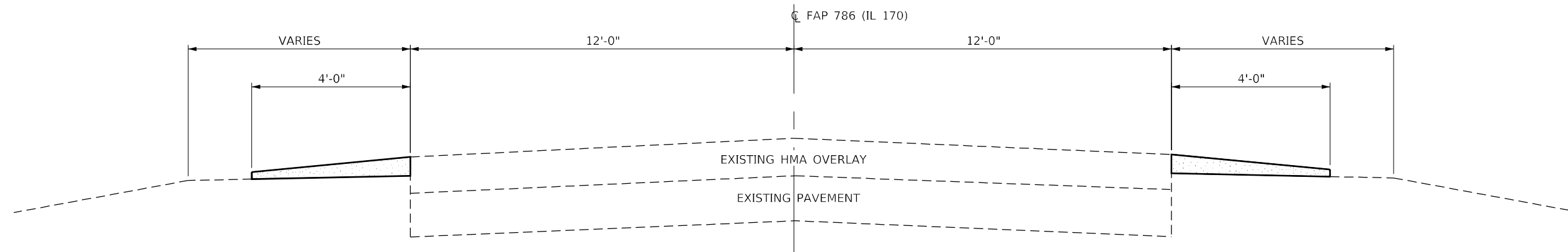

TYPICAL SECTION
LOG MILE 0.00 TO LOG MILE 12.00

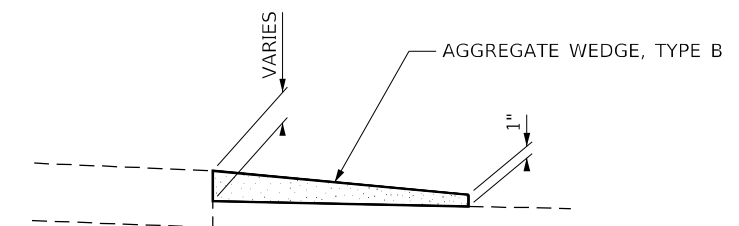

SHOULDER DETAIL (TYPICAL)

FILE NAME =	USER NAME = MARINEJ	DESIGNED - EM	REVISED - ____	STATE OF ILLINOIS DEPARTMENT OF TRANSPORTATION	TYPICALS			F.A.P. RTE. 786	SECTION (110,111)G	COUNTY LABALLEE/INGSTON	TOTAL SHEETS 7	SHEET NO. 4
pw:\planroom.dot\illinois.gov\PWIDOT\Documents\IDOT	offices\District 3\Projects\I366L56\CADData\I3xxxxx-shl-cover.d	DRAWN - EM	REVISED - ____		SCALE: ____	SHEET 1	OF 1	SHEETS	STA. ____	TO STA. ____	CONTRACT NO. 66L56	
Default	PLOT SCALE = 1:665' / mm	CHECKED - RW	REVISED - ____									
	PLOT DATE = 12/14/2020	DATE - 12/14/2020	REVISED - ____		ILLINOIS FED. AID PROJECT							

**SCHEDULE - AGGREGATE SHOULDERS
LASALLE COUNTY - SOUTHBOUND LANES L.M. 0.00 TO L.M. 12.00 (RURAL)**

LOCATION			SHOULDER DIMENSIONS		AGGREGATE SHOULDERS TYPE B TON
			SHOULDER WIDTH (FT)	AVERAGE DEPTH (IN)	
LOG MILE	- LOG MILE	SIDE ROAD	WIDTH (FT)	DEPTH (IN)	TON
0.00	-	N 21st RD.			
0.00	- 0.10		4	2	20
0.10	- 0.20	GUARDRAIL SECTION			
0.20	- 0.90		4	4	208
0.90	-	N 20th RD.			
0.90	- 1.10		4	3	45
1.10	- 1.20	GUARDRAIL SECTION			
1.20	- 1.90		4	2	137
1.90	-	N 19th RD.			
1.90	- 2.60		4	2	136
2.60	- 2.60	GUARDRAIL SECTION			
2.60	- 2.90		4	2	60
2.90	-	N 18th RD.			
2.90	- 3.70		4	3	192
3.70	- 3.70	GUARDRAIL SECTION			
3.70	- 4.00		4	2	53
4.00	- 4.00	GUARDRAIL SECTION			
4.00	- 4.90		4	4	291
4.90	-	E 28th RD.			
4.90	- 5.90		4	4	281
5.90	-	E 21st RD./N 17th RD.			
5.90	- 6.90		4	2	182
6.90	-	N 16th RD.			
6.90	- 7.20		4	2	48
7.20	- 7.50	GUARDRAIL SECTION			
7.50	-	E PLUMB ST.			
7.50	- 7.60		4	1	13
7.60	-	E HARRISON ST.			
7.60	- 7.70		4	2	14
7.70	-	ROOSEVELT RD.			
7.70	- 7.90		4	3	50
7.90	-	N 15th RD.			
7.90	- 8.70		4	3	193
8.70	- 8.70	GUARDRAIL SECTION			
8.70	- 8.90		4	2	50
8.90	-	N 14th RD.			
8.90	- 9.90		4	2	196
9.90	-	N 13th RD.			
9.90	- 10.90		4	2	199
10.90	-	N 12th RD./1500 E RD.			
10.90	- 11.00		4	3	20
11.00	-	LIVINGSTON COUNTY LINE			
SUBTOTAL					2388

**SCHEDULE - AGGREGATE SHOULDERS
LIVINGSTON COUNTY - SOUTHBOUND LANES L.M. 11.00 TO L.M. 12.00 (RURAL)**

LOCATION			SHOULDER DIMENSIONS		AGGREGATE SHOULDERS TYPE B TON
			SHOULDER WIDTH (FT)	AVERAGE DEPTH (IN)	
LOG MILE	- LOG MILE	SIDE ROAD	WIDTH (FT)	DEPTH (IN)	TON
11.00	- 11.50				
11.50	- 11.50	RAILROAD			
11.50	- 12.00		4	3	113
12.00	-	IL 17			
LANE TOTAL					113

**SCHEDULE - AGGREGATE SHOULDERS
LIVINGSTON COUNTY - NORTHBOUND LANES L.M. 12.00 TO L.M. 11.00 (RURAL)**

LOCATION			SHOULDER DIMENSIONS		AGGREGATE SHOULDERS TYPE B TON
			SHOULDER WIDTH (FT)	AVERAGE DEPTH (IN)	
LOG MILE	- LOG MILE	SIDE ROAD	WIDTH (FT)	DEPTH (IN)	TON
12.00	-	IL 17			
12.00	- 11.60		4	3	78
11.60	- 11.60	RAILROAD			
11.60	- 11.00		4	3	171
11.00	-	LASALLE COUNTY			
TOTAL					249

**SCHEDULE - AGGREGATE SHOULDERS
LASALLE COUNTY - NORTHBOUND LANES L.M. 11.00 TO L.M. 0.00 (RURAL)**

LOCATION			SHOULDER DIMENSIONS		AGGREGATE SHOULDERS TYPE B TON
			SHOULDER WIDTH (FT)	AVERAGE DEPTH (IN)	
LOG MILE	- LOG MILE	SIDE ROAD	WIDTH (FT)	DEPTH (IN)	TON
11.00	- 10.90				
10.90	-	1500 E RD.			
10.90	- 10.00		4	2	194
10.00	-	N 13th RD.			
10.00	- 9.00		4	2	194
9.00	-	N 14th RD.			
9.00	- 8.80		4	2	33
8.80	- 8.70	GUARDRAIL SECTION			
8.70	- 7.90		4	2	148
7.90	-	N 15th RD.			
7.90	- 7.60		4	2	68
7.60	- 7.30	GUARDRAIL SECTION			
7.30	- 7.00		4	2	1
7.00	-	N 16th RD.			
7.00	- 5.00		4	2	640
5.00	-	E 28th ST.			
5.00	- 4.10		4	2	256
4.10	- 4.10	GUARDRAIL SECTION			
4.10	- 4.00		4	2	12
4.00	-	N 17th RD.			
4.00	- 3.80		4	2	33
3.80	- 3.80	GUARDRAIL SECTION			
3.80	- 3.00		4	3	96
3.00	-	N 18th RD.			
3.00	- 2.70		4	2	37
2.70	- 2.60	GUARDRAIL SECTION			
2.60	- 2.10		4	1	130
2.10	-	N 19th RD.			
2.10	- 1.20		4	2	217
1.20	- 1.20	GUARDRAIL SECTION			
1.20	- 1.00		4	1	37
1.00	-	N 20th RD.			
1.00	- 0.20		4	3	147
0.20	- 0.10	GUARDRAIL SECTION			
0.10	- 0.00		4	3	21
0.00	-	N 21st RD.			
LANE TOTAL					2264

FILE NAME =	USER NAME = woodshank1	DESIGNED - EM	REVISED -
pw:\planroom\dotillinois.gov\PWDOT\Documents\IDOT\Office\District 3\Projects\D366L56\CADData\D366L56-PLANS.dgn		DRAWN - EM	REVISED -
Default	PLOT SCALE = 50,0000' / in.	CHECKED - RW	REVISED -
	PLOT DATE = 2/11/2021	DATE - 2/11/2021	REVISED -

**STATE OF ILLINOIS
DEPARTMENT OF TRANSPORTATION**

SCHEDULES

SCALE: _____ SHEET 1 OF 1 SHEETS STA. _____ TO STA. _____

F.A.P. RTE.	SECTION	COUNTY	TOTAL SHEETS	SHEET NO.
786	(110,111)G	LASALLE/LIVINGSTON	7	5
CONTRACT NO. 66L56				
ILLINOIS FED. AID PROJECT				

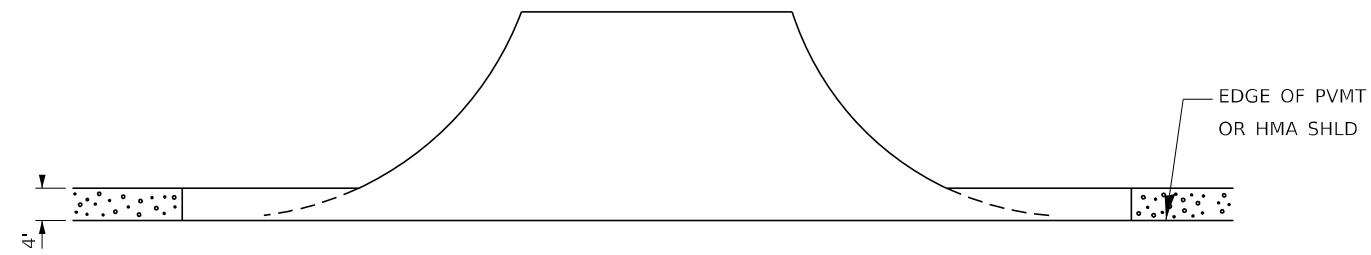

AGG SHOULDER IS NOT TO BE
PLACED AROUND SIDE ROAD RADII

PLAN AT SIDE ROADS

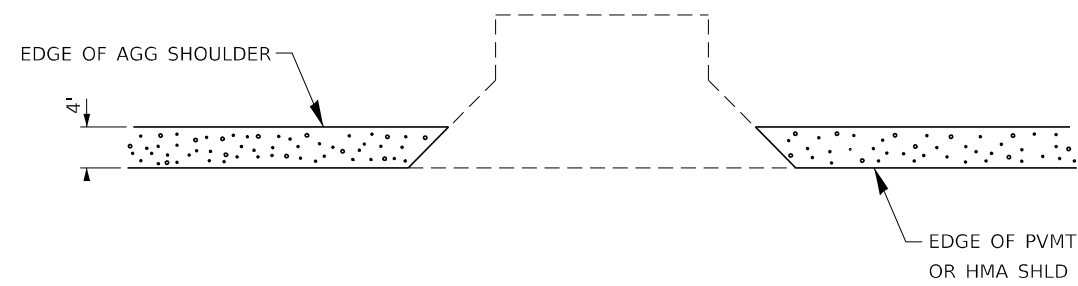

**PLAN AT PRIVATE & COMMERCIAL ENTRANCES
WITH PAVED SURFACE**

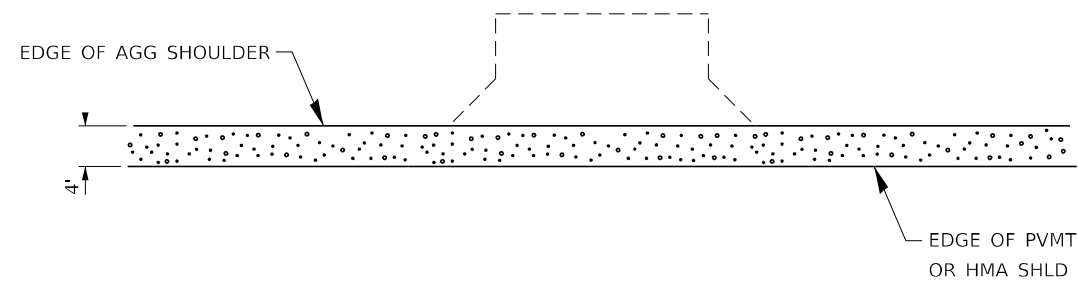

**PLAN AT PRIVATE & COMMERCIAL ENTRANCES
WITH AGGREGATE SURFACE**

FILE NAME =	USER NAME = MARINEJ	DESIGNED - EM	REVISED - ____
pw:\planroom.dot\illinois.gov\PWIDOT\Documents\IDOT	offices\District 3\Projects\I366L56\CADData\I3xxxxx-shl-cover.d	DRAWN - EM	REVISED - ____
Default	PLOT SCALE = 1:8685' / mm	CHECKED - RW	REVISED - ____
	PLOT DATE = 12/14/2020	DATE - 12/14/2020	REVISED - ____

STATE OF ILLINOIS
DEPARTMENT OF TRANSPORTATION

DETAILS			
SCALE: ____	SHEET 1	OF 1	SHEETS
STA. ____	TO STA. ____		

F.A.P. RTE.	SECTION	COUNTY	TOTAL SHEETS	SHEET NO.
786	(110,111)G	LASALLE/JUNINGSTON	7	6
CONTRACT NO. 66L56				
ILLINOIS FED. AID PROJECT				

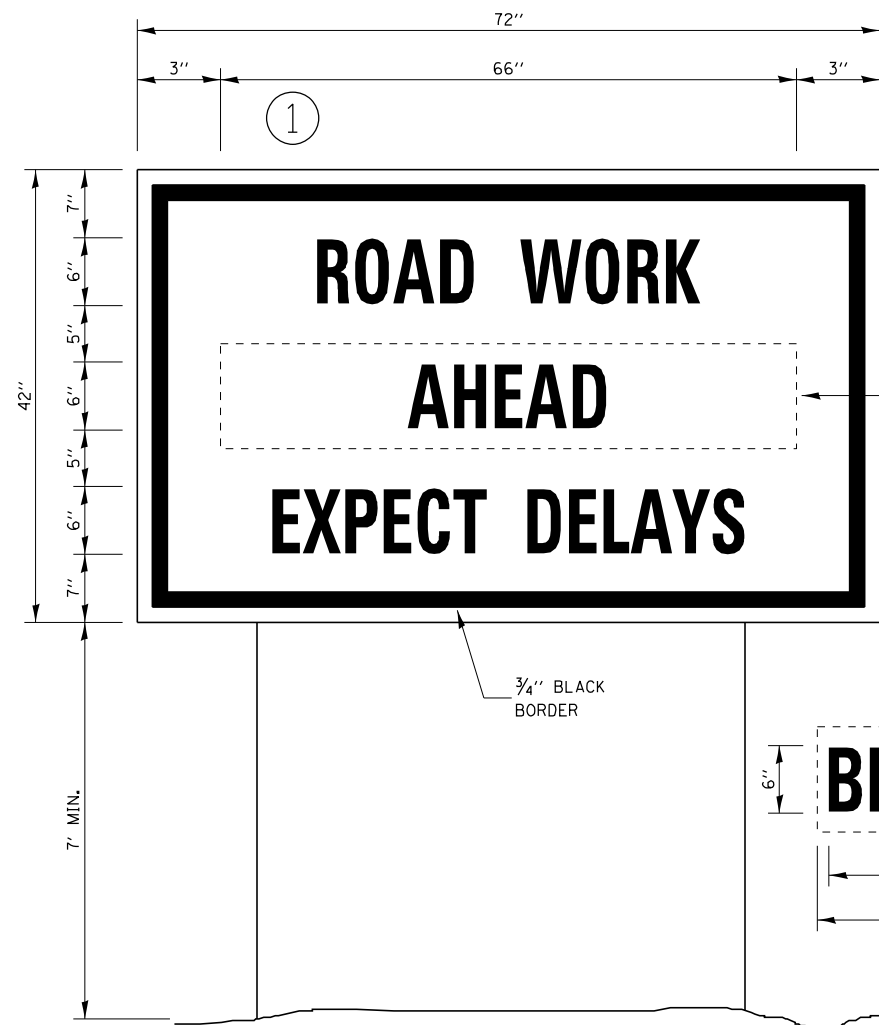

TEMPORARY INFORMATION SIGNING

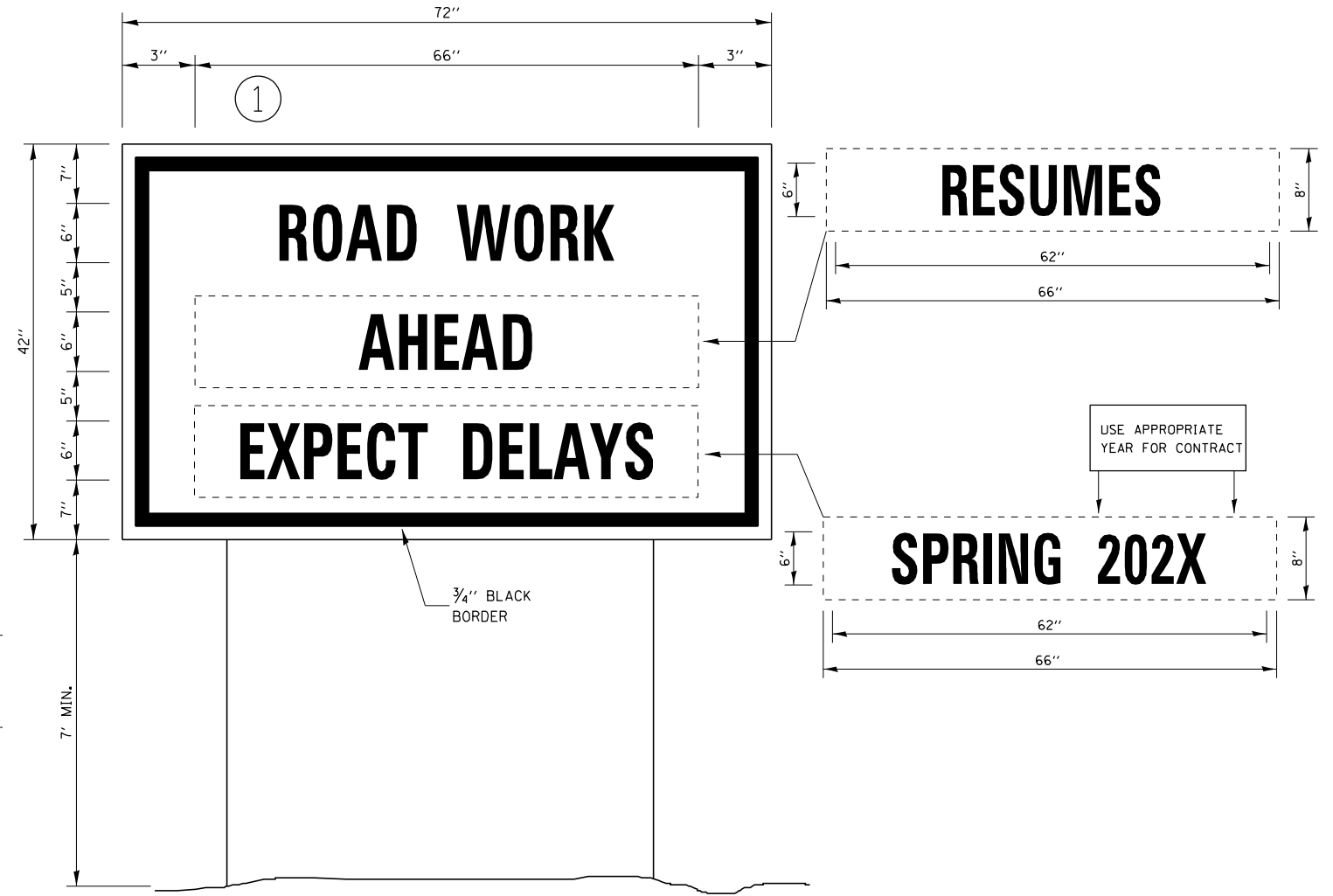

WINTER SHUT DOWN SIGNING

NOTES:

1. USE 6" D BLACK LETTERING ON FLOURESENT ORANGE BACKGROUND.
2. ERECT SIGNS AT LOCATIONS IN ADVANCE OF THE "ROAD CONSTRUCTION AHEAD" SIGNS AS DIRECTED BY THE ENGINEER.
3. ERECT SIGN ① WITH INSTALLED PANEL ② A MINIMUM OF ONE WEEK PRIOR TO THE START OF THE LANE CLOSURE.
4. REMOVE PANEL ② ON THAT DATE.
5. SEE SPECIAL PROVISION "TEMPORARY INFORMATION SIGNING" FOR ADDITIONAL INFORMATION.
6. WILL BE PAID FOR PER SO FT AS "TEMPORARY INFORMATION SIGNING". EACH SIGN = 21 SO FT AND THE DATE PANEL ② WILL NOT BE MEASURED SEPARATELY FOR PAYMENT.

FILE NAME =	USER NAME = MARINEJ	DESIGNED - EM	REVISED -	STATE OF ILLINOIS DEPARTMENT OF TRANSPORTATION	TEMPORARY INFORMAYION SIGNING			F.A.P. RTE.	SECTION	COUNTY	TOTAL SHEETS	SHEET NO.
pw:\planroom\dot\illinois.gov\PWIDOT\Documents\IDOT\Offices\District 3\Projects\1366L56\CADData\13xxxxx-shl-cover.dgn	DRAWN - EM	CHECKED - RW	REVISED -					786	(110.111)G	LASALLE/JVINGSTON	7	7
Default	PLOT SCALE = 2.1654" / mm	DATE - 12/14/2020	REVISED -		CONTRACT NO. 66L56			ILLINOIS FED. AID PROJECT				
	PLOT DATE = 12/14/2020	DATE - 12/14/2020	REVISED -		SCALE: _____	SHEET 1	OF 1	SHEETS	STA. _____	TO STA. _____		