

F.A.U. RTE.	SECTION	COUNTY	TOTAL SHEETS	SHEET NO.
2714	(1213&3198B)RS-4	COOK	23	1
ILLINOIS CONTRACT NO. 60356				

STATE OF ILLINOIS
DEPARTMENT OF TRANSPORTATION
DIVISION OF HIGHWAYS

PROPOSED HIGHWAY PLANS

FOR INDEX OF SHEETS, SEE SHEET NO. 2

THE PROJECT IS LOCATED IN THE VILLAGE OF FRANKLIN PARK

FAU ROUTE 2714: 25TH AVE. (ROSE ST.)
ADDISON ST. TO BELMONT AVE.
SECTION (1213&3198B)RS-4
PROJECT : ESP-2714(OIO)
RESURFACING (MAINTENANCE)
COOK COUNTY
C-91-243-97

D-91-243-97

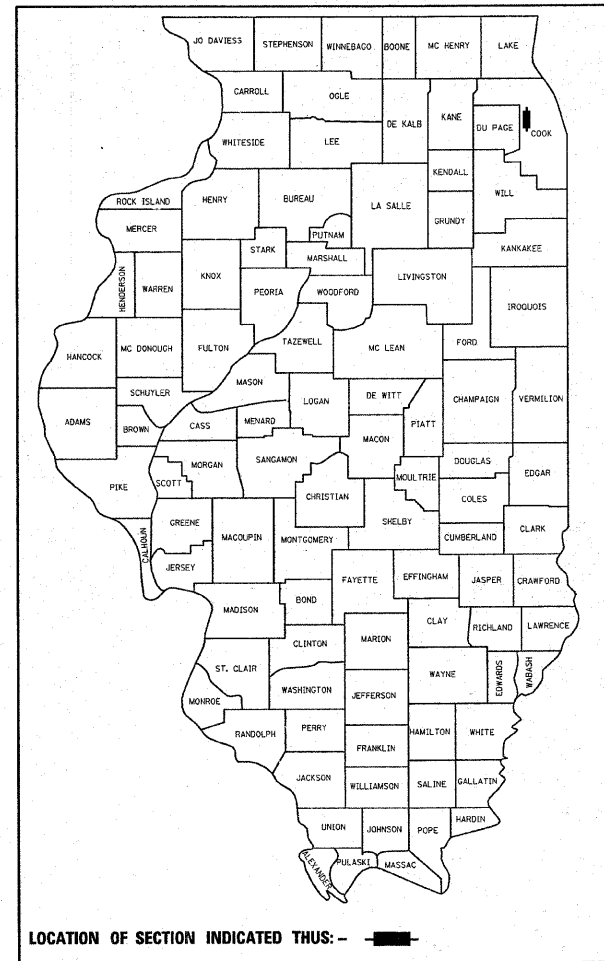

LOCATION OF SECTION INDICATED THUS: —

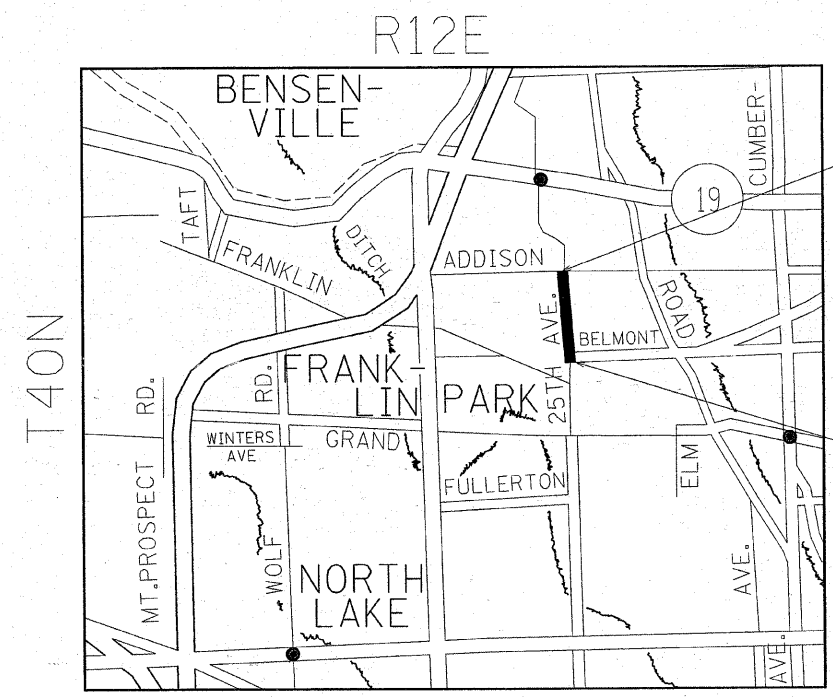

PROJECT ENDS
STA 29+75

TRAFFIC DATA
ADT (2009) = 11,600
POSTED SPEED LIMIT = 30 MPH

PROJECT BEGINS
STA 00+75

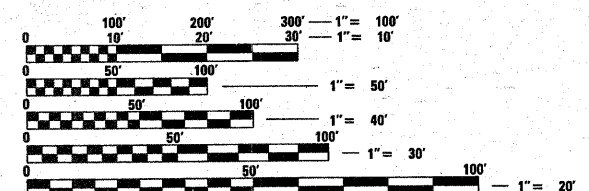

FULL SIZE PLANS HAVE BEEN PREPARED USING STANDARD ENGINEERING SCALES. REDUCED SIZED PLANS WILL NOT CONFORM TO STANDARD SCALES. IN MAKING MEASUREMENTS ON REDUCED PLANS, THE ABOVE SCALES MAY BE USED.

J.U.L.I.E.
JOINT UTILITY LOCATION INFORMATION FOR EXCAVATION
1-800-892-0123
OR 811

PROJECT ENGINEER JENPAI CHANG 847-705-4432
PROJECT MANAGER KEN ENG

GROSS LENGTH OF THE PROJECT = 2900 FT. = .55 MILES
NET LENGTH OF THE PROJECT = 2900 FT. = .55 MILES

STATE OF ILLINOIS
DEPARTMENT OF TRANSPORTATION
DIVISION OF HIGHWAYS

SUBMITTED FEBRUARY 9, 20 09
Diana M. O'Keefe *or*
 DEPUTY DIRECTOR OF HIGHWAYS, REGION ENGINEER
March 27, 20 09
Charles J. Ingwall
 ENGINEER OF DESIGN AND ENVIRONMENT
March 27, 20 09
Christine M. Reed
 DIRECTOR OF HIGHWAYS, CHIEF ENGINEER

PRINTED BY THE AUTHORITY OF THE STATE OF ILLINOIS

CONTRACT NO. 60356