

F.A.P. RTE.	SECTION	COUNTY	TOTAL SHEETS	SHEET NO.
351	3277R	COOK	541	50
STA. 0+400		TO STA. 1+000		
FED. ROAD DIST. NO.		ILLINOIS FED. AID PROJECT		CONTRACT NO. 60774

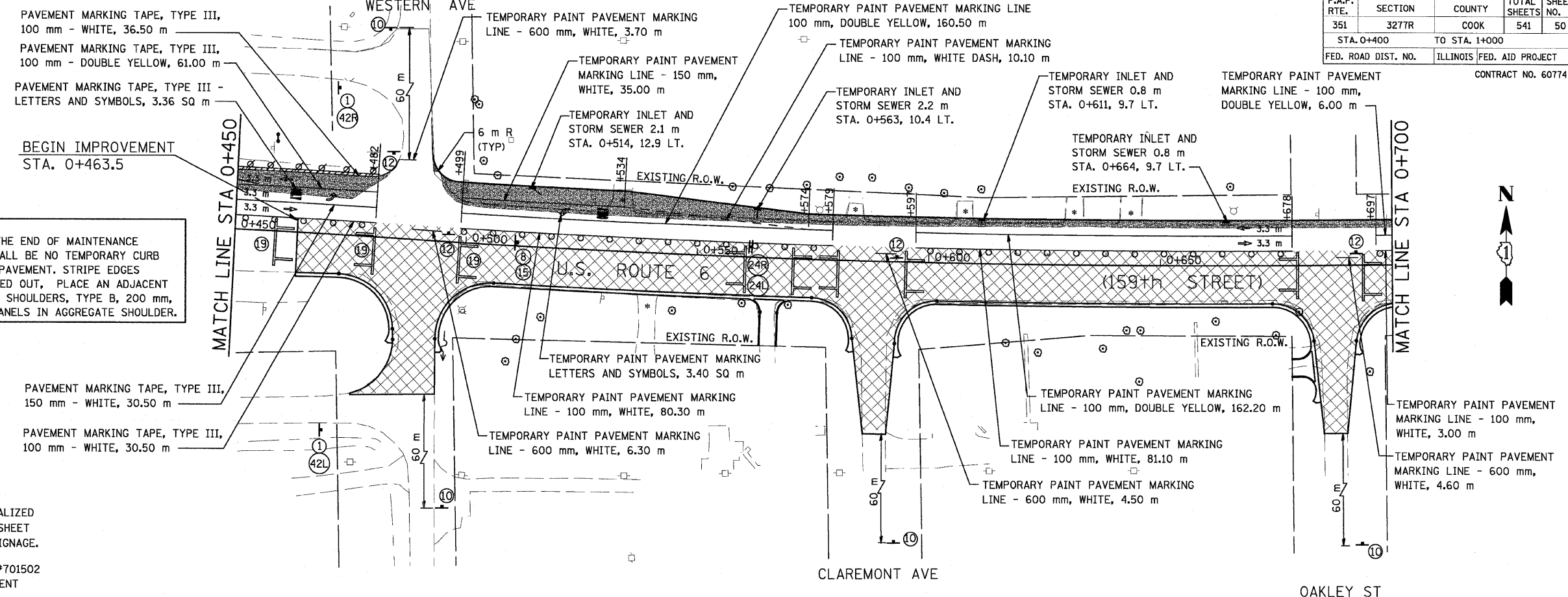

NOTE:
 FROM WESTERN AVENUE WEST TO THE END OF MAINTENANCE OF TRAFFIC WORK ZONE, THERE SHALL BE NO TEMPORARY CURB PLACED ADJACENT TO TEMPORARY PAVEMENT. STRIPE EDGES OF TEMPORARY PAVEMENT AS CALLED OUT, PLACE AN ADJACENT 600 mm WIDE AREA OF AGGREGATE SHOULDERS, TYPE B, 200 mm, AND INSTALL LIGHTED VERTICAL PANELS IN AGGREGATE SHOULDER.

NOTE: SEE SHEET MT-02 FOR LOCALIZED STREET CLOSING DETAILING. SEE SHEET MT-03 FOR ADDITIONAL DETOUR SIGNAGE.

NOTE: REFER TO IDOT STANDARD #701502 FOR BARREL SPACING AND PLACEMENT

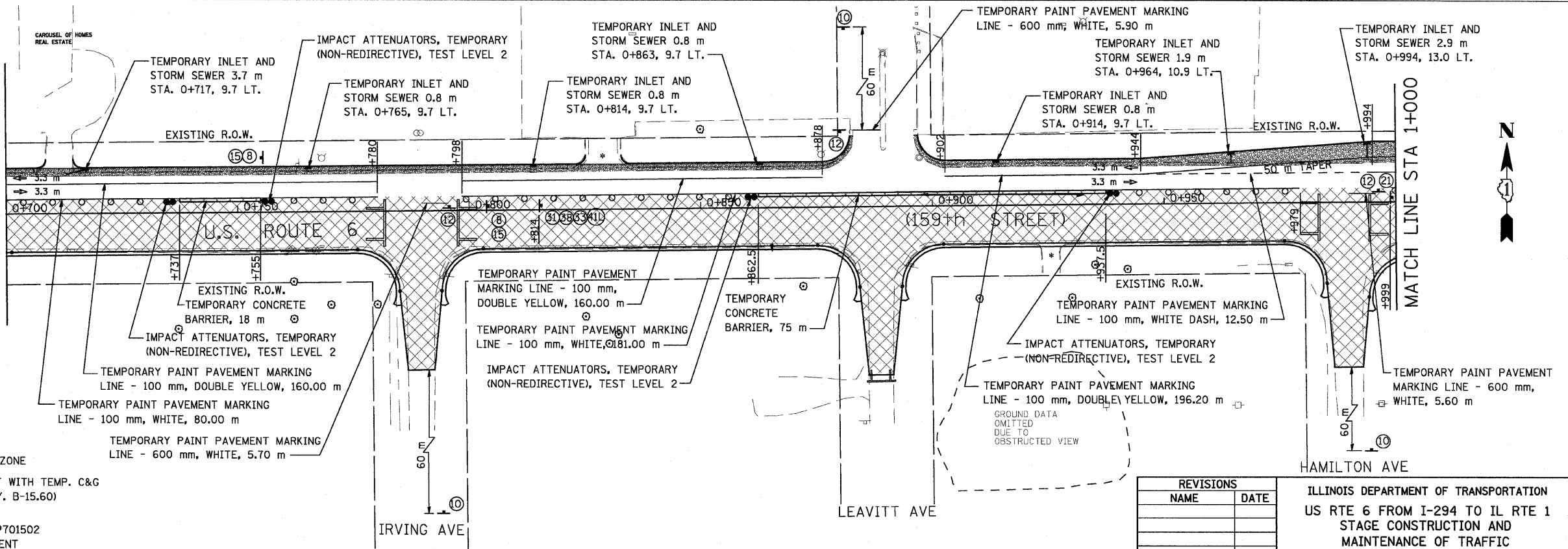

LEGEND

CONSTRUCTION WORK ZONE

TEMPORARY PAVEMENT WITH TEMP. C&G (PAID FOR AS C&G TY. B-15.60)

NOTE: REFER TO IDOT STANDARD #701502 FOR BARREL SPACING AND PLACEMENT

URS 100 S. WACKER DR., SUITE 500
 CHICAGO, ILLINOIS 60606
 TEL. (312) 939-1000
 FAX (312) 939-4198

NOTE: SEE SHEET MT-02 FOR LOCALIZED STREET CLOSING DETAILING. SEE SHEET MT-03 FOR ADDITIONAL DETOUR SIGNAGE.

* DRIVEWAY TO BE CLOSED

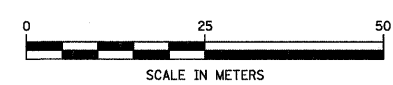

REVISIONS	
NAME	DATE

ILLINOIS DEPARTMENT OF TRANSPORTATION
 US RTE 6 FROM I-294 TO IL RTE 1
 STAGE CONSTRUCTION AND MAINTENANCE OF TRAFFIC
 U.S. ROUTE 6 (159th ST.)
 STAGE I

MT-14 DRAWN BY TJJ
 DATE 01/28/09 CHECKED BY JWK