

F.A.P. RTE.	SECTION	COUNTY	TOTAL SHEETS	SHEET NO.
351	3277R	COOK	541	62
STA. 2+700		TO STA. 3+250		
FED. ROAD DIST. NO.		ILLINOIS FED. AID PROJECT		

CONTRACT NO. 60774

TEMPORARY CONST. EASEMENT

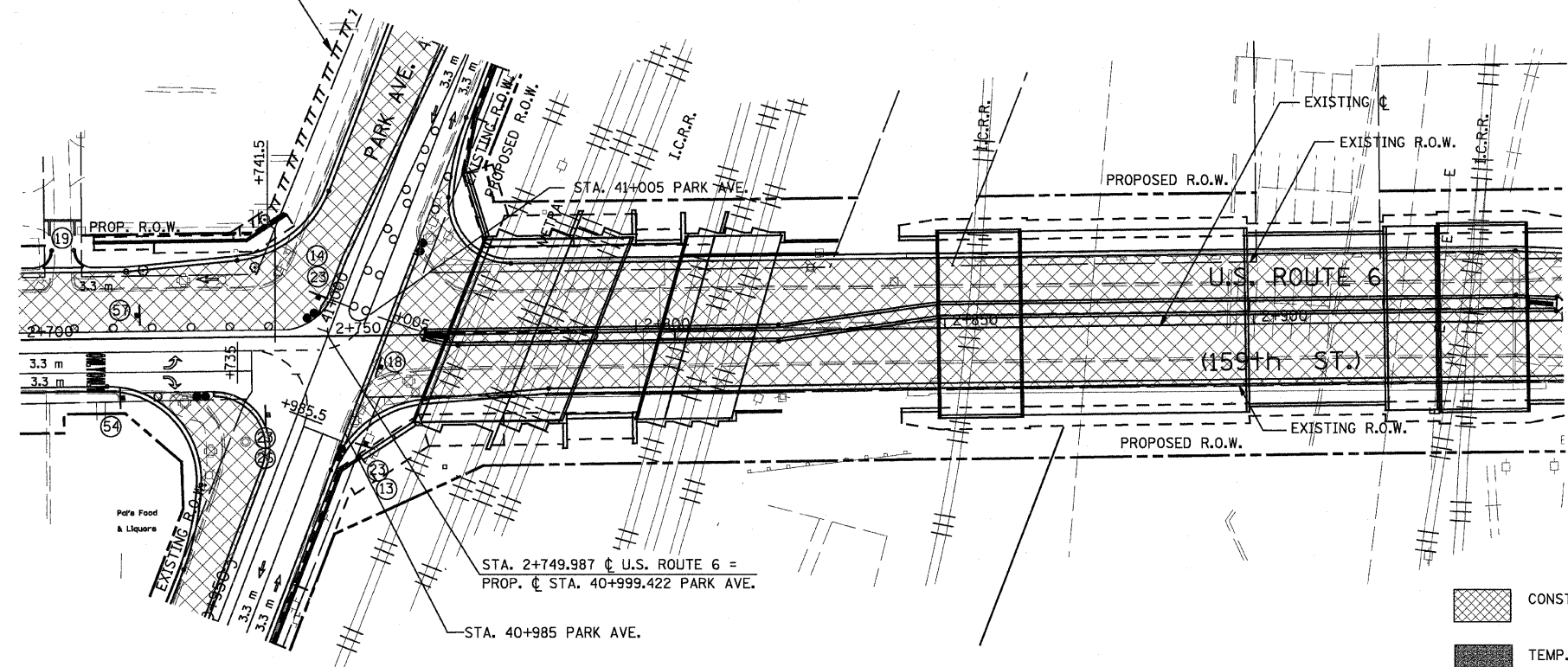

NOTE: SEE SHEET MT-02 FOR LOCALIZED STREET CLOSING DETAILING. SEE SHEET MT-03 FOR ADDITIONAL DETOUR SIGNAGE.
NOTE: REFER TO IDOT STANDARD *701502 FOR BARREL SPACING AND PLACEMENT

LEGEND

- CONSTRUCTION WORK ZONE
- TEMP. PAVEMENT WITH TEMP. C&G (PAID FOR AS C&G TY. B-15.60)

COORDINATE M.O.T. LAYOUT WITH CONTRACT 60E10 M.O.T. LAYOUT
CONSTRUCTION ZONE CONTRACT 60774

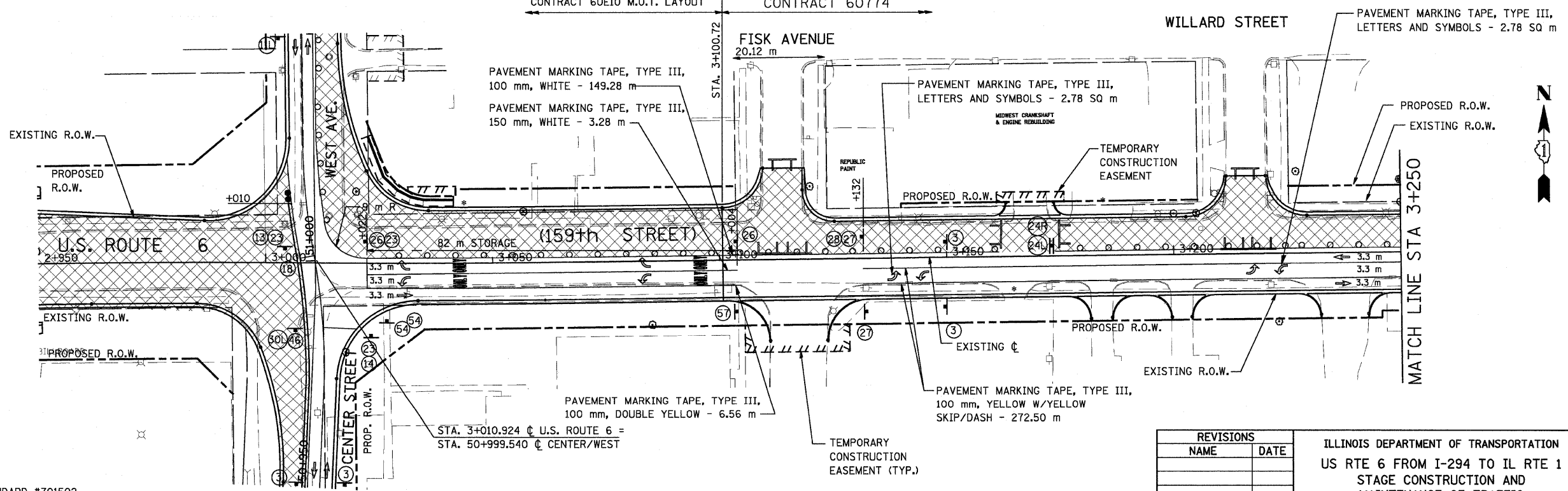

NOTE: REFER TO IDOT STANDARD *701502 FOR BARREL SPACING AND PLACEMENT

NOTE: SEE SHEET MT-02 FOR LOCALIZED STREET CLOSING DETAILING. SEE SHEET MT-03 FOR ADDITIONAL DETOUR SIGNAGE.

* DRIVEWAY TO BE CLOSED

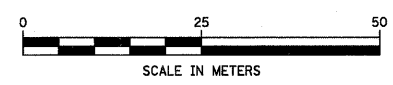

REVISIONS	
NAME	DATE

ILLINOIS DEPARTMENT OF TRANSPORTATION
US RTE 6 FROM I-294 TO IL RTE 1
STAGE CONSTRUCTION AND MAINTENANCE OF TRAFFIC
U.S. ROUTE 6 (159th ST.)
STAGE II
MT-26 DRAWN BY TJJ
DATE 01/28/09 CHECKED BY JWK

URS 100 S. WACKER DR., SUITE 500
CHICAGO, ILLINOIS 60606
TEL. (312) 939-1000
FAX (312) 939-4198