

F.A.P. RTE.	SECTION	COUNTY	TOTAL SHEETS	SHEET NO.
351	3277R	COOK	541	63
STA. 3+250		TO STA. 3+850		
FED. ROAD DIST. NO.		ILLINOIS	FED. AID PROJECT	
CONTRACT NO. 60774				

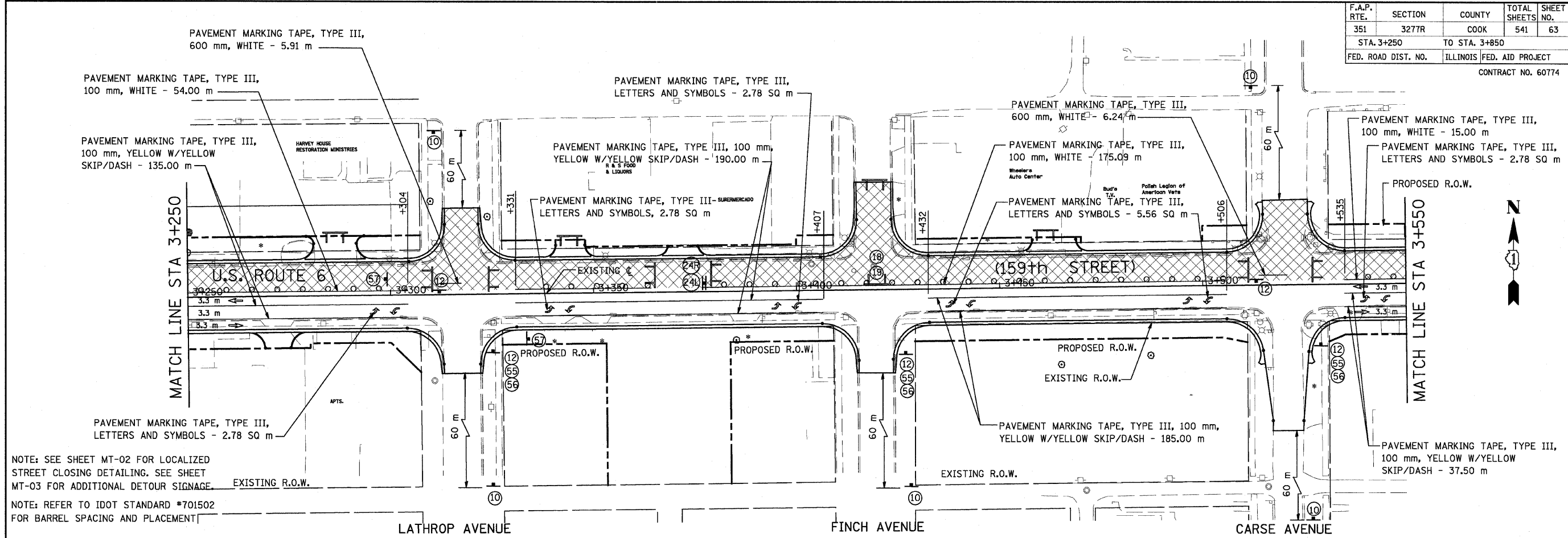

NOTE: SEE SHEET MT-02 FOR LOCALIZED STREET CLOSING DETAILING. SEE SHEET MT-03 FOR ADDITIONAL DETOUR SIGNAGE.

NOTE: REFER TO IDOT STANDARD #701502 FOR BARREL SPACING AND PLACEMENT

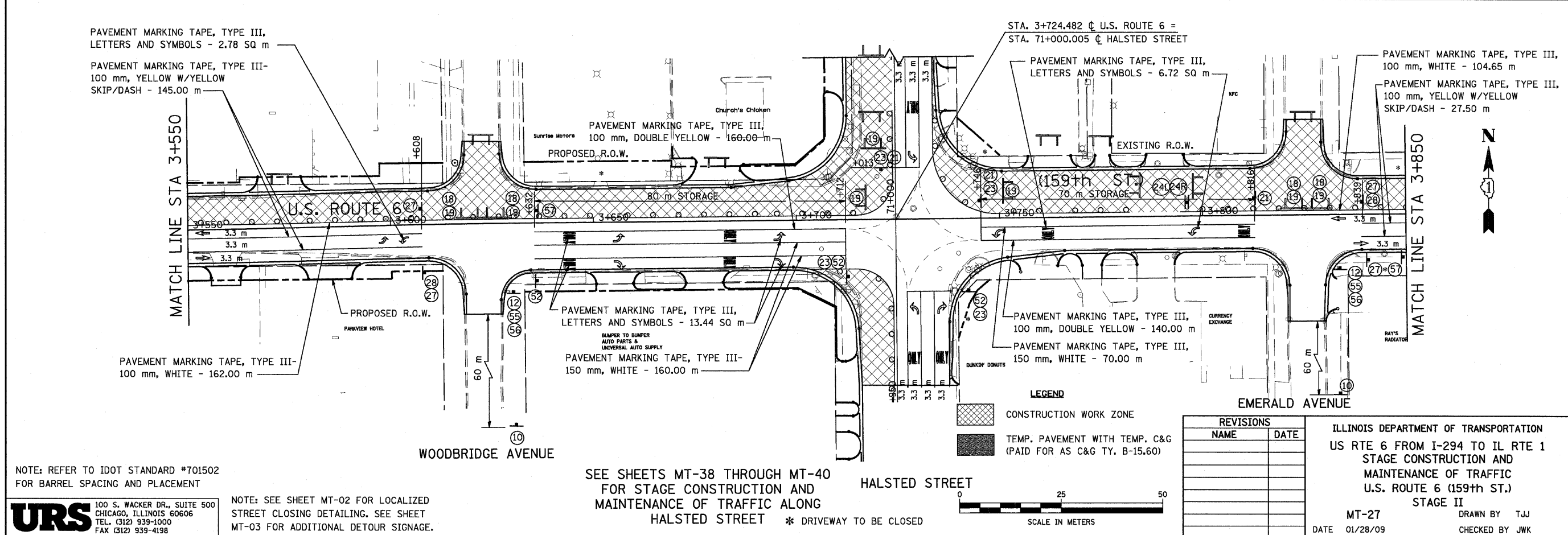

NOTE: REFER TO IDOT STANDARD #701502 FOR BARREL SPACING AND PLACEMENT

**URS** 100 S. WACKER DR., SUITE 500  
CHICAGO, ILLINOIS 60606  
TEL. (312) 939-1000  
FAX (312) 939-4198

NOTE: SEE SHEET MT-02 FOR LOCALIZED STREET CLOSING DETAILING. SEE SHEET MT-03 FOR ADDITIONAL DETOUR SIGNAGE.

SEE SHEETS MT-38 THROUGH MT-40 FOR STAGE CONSTRUCTION AND MAINTENANCE OF TRAFFIC ALONG HALSTED STREET \* DRIVEWAY TO BE CLOSED

**LEGEND**

- CONSTRUCTION WORK ZONE
- TEMP. PAVEMENT WITH TEMP. C&G (PAID FOR AS C&G TY. B-15.60)

**REVISIONS**

NAME	DATE

SCALE IN METERS

ILLINOIS DEPARTMENT OF TRANSPORTATION  
US RTE 6 FROM I-294 TO IL RTE 1  
STAGE CONSTRUCTION AND  
MAINTENANCE OF TRAFFIC  
U.S. ROUTE 6 (159th ST.)  
STAGE II

MT-27 DRAWN BY TJJ  
DATE 01/28/09 CHECKED BY JWK