

F.A.P. RTE.	SECTION	COUNTY	TOTAL SHEETS	SHEET NO.
351	3277R	COOK	541	120
STA. 2+150		TO STA. 2+295		
FED. ROAD DIST. NO.		ILLINOIS FED. AID PROJECT		
CONTRACT NO. 60774				

**DRAINAGE TABLE LEGEND**

A3 = TYPE C, 0.6m DIAMETER  
A4 = TYPE A, 1.2m DIAMETER  
A5 = TYPE A, 1.5m DIAMETER  
A6 = TYPE A, 1.8m DIAMETER  
A7 = TYPE A, 2.1m DIAMETER

\*WMR = WATER MAIN REQUIREMENTS

**NOTE:**  
STRUCTURE OFFSET LOCATIONS GIVEN ON THE PLANS ARE TO THE FOLLOWING POINTS  
A) FOR STRUCTURES FALLING IN THE CURB LINE - TO THE EDGE OF PAVEMENT  
B) FOR ALL OTHER STRUCTURE LOCATIONS - TO THE CENTER OF THE STRUCTURE

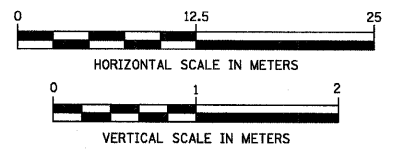

FINAL SURVEYED SURVEY PLOTTED NOTE BOOK TEMPLATE AREAS CHECKED NO.

ORIGINAL SURVEYED SURVEY PLOTTED NOTE BOOK TEMPLATE AREAS CHECKED NO.

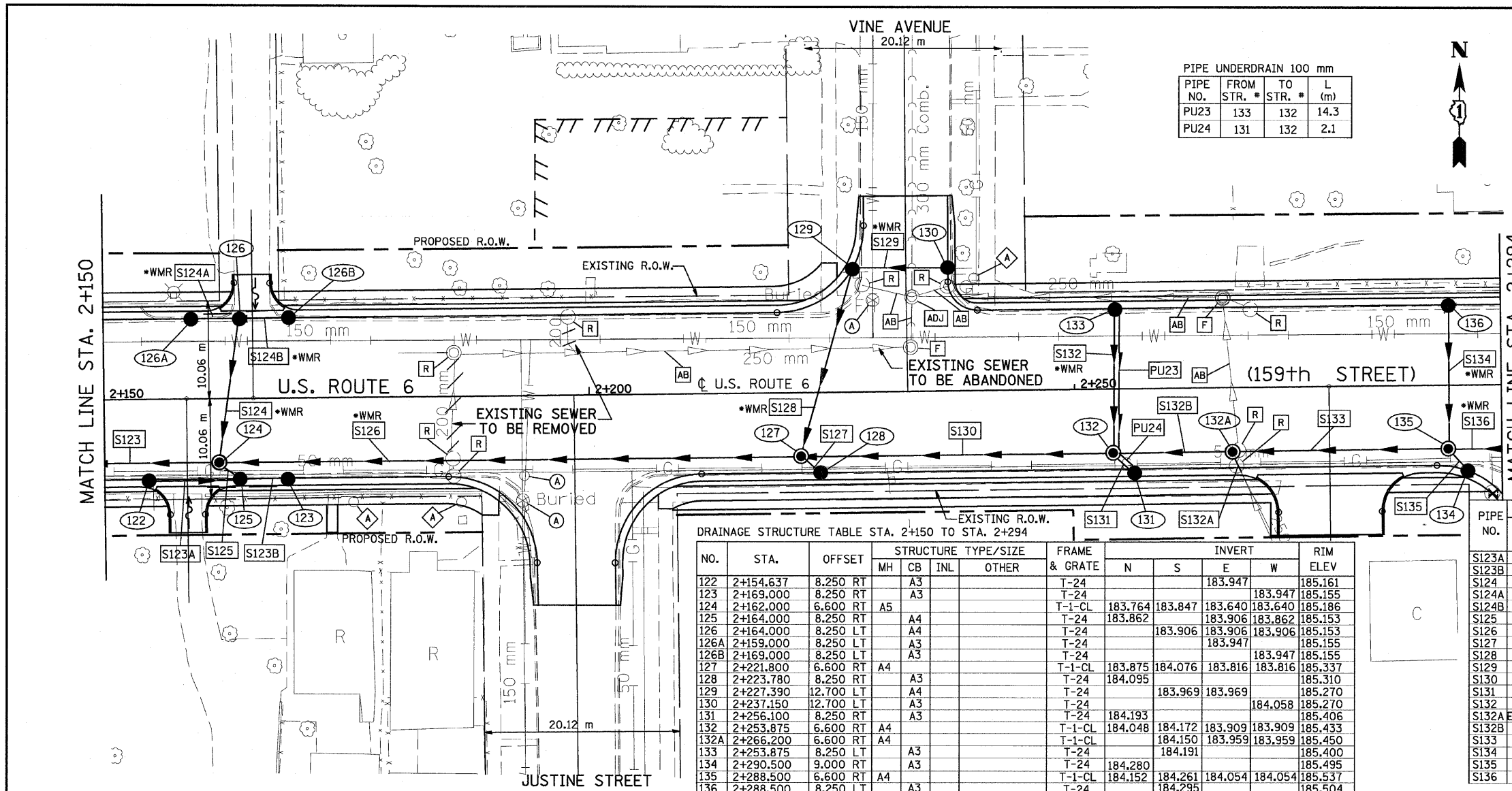

**DRAINAGE STRUCTURE TABLE STA. 2+150 TO STA. 2+294**

NO.	STA.	OFFSET	STRUCTURE TYPE/SIZE			FRAME & GRATE	INVERT				RIM ELEV.		
			MH	CB	INL		OTHER	N	S	E		W	
122	2+154.637	8.250 RT			A3							183.947	185.161
123	2+169.000	8.250 RT			A3							183.947	185.155
124	2+162.000	6.600 RT			A5							183.764	183.847
125	2+164.000	8.250 RT			A4							183.862	183.640
126	2+164.000	8.250 LT			A4							183.906	183.862
126A	2+159.000	8.250 LT			A3							183.906	183.906
126B	2+169.000	8.250 LT			A3							183.906	185.153
127	2+221.800	6.600 RT			A4							183.947	185.155
128	2+223.780	8.250 RT			A3							183.947	185.155
129	2+227.390	12.700 LT			A4							184.076	183.816
130	2+237.150	12.700 LT			A3							183.816	183.816
131	2+256.100	8.250 RT			A3							184.095	185.310
132	2+253.875	6.600 RT			A4							183.969	183.969
132A	2+266.200	6.600 RT			A4							184.058	185.270
133	2+253.875	8.250 LT			A3							184.193	185.406
134	2+290.500	9.000 RT			A3							184.048	184.172
135	2+288.500	6.600 RT			A4							184.048	184.172
136	2+288.500	8.250 LT			A3							184.150	183.959
												184.191	185.450
												184.280	185.400
												184.152	185.495
												184.295	185.537
												184.054	184.054
												184.295	185.504

**PIPE TABLE STA. 2+150 STA. 2+294**

PIPE NO.	FROM STR.#	TO STR.#	DESCRIPTION	DIA. (mm)	L (m)	S (%)	TRENCH BACKFILL VOLUME (CU M)
S123B	123	125	SS T1, RCP CL IV	300	4.1	1.00	1.4
S124	126	124	SS, WMR	300	14.2	1.00	6.0
S124A	126A	126	SS, WMR	300	4.1	1.00	1.4
S124B	126B	126	SS, WMR	300	4.1	1.00	1.4
S125	125	124	SS T1, RCP CL IV	300	1.5	1.00	0.6
S126	127	124	SS, WMR	750	58.6	0.30	55.2
S127	128	127	SS T1, RCP CL IV	300	1.9	1.00	0.6
S128	129	127	SS, WMR	300	18.9	0.50	8.8
S129	130	129	SS, WMR	300	8.9	1.00	3.2
S130	132	127	SS T1, RCP CL IV	450	30.9	0.30	28.6
S131	131	132	SS T1, RCP CL IV	300	2.1	1.00	0.7
S132	133	132	SS, WMR	300	14.3	1.00	5.6
S132A EX PIPE	132A	132A	SS T1, RCP CL IV	300	2.0	1.00	0.8
S132B	132A	132	SS T2, RCP CL III	300	11.2	0.45	11.0
S133	135	132A	SS T2, RCP CL III	300	21.1	0.45	11.7
S134	136	135	SS, WMR	300	14.3	1.00	5.6
S135	134	135	SS T1, RCP CL IV	300	1.9	1.00	0.7
S136	137	135	SS, WMR	300	22.3	0.45	12.0

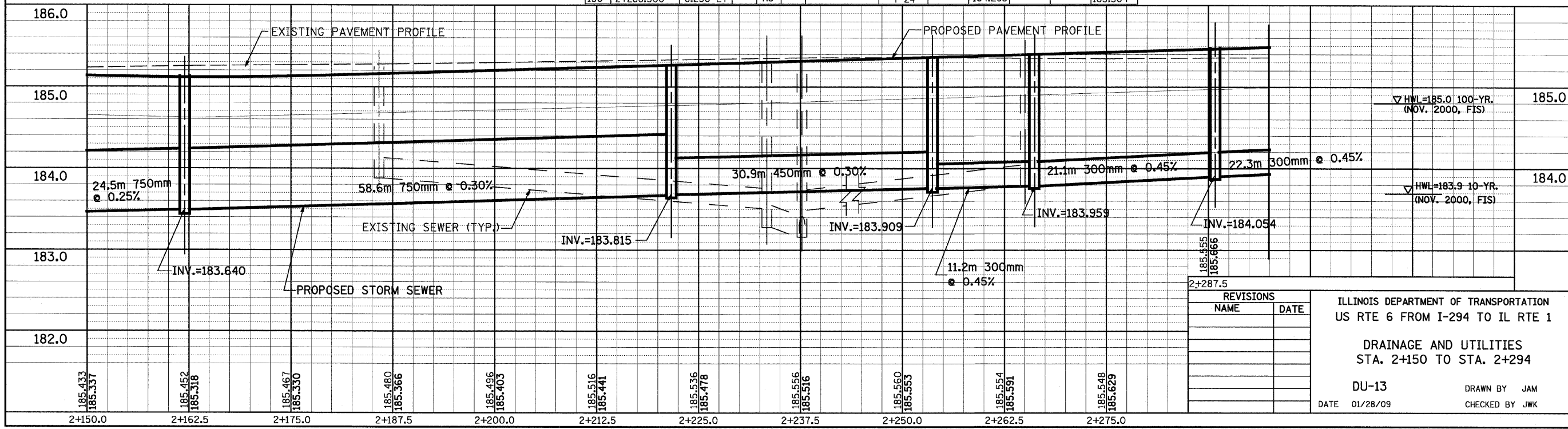

**REVISIONS**

NAME	DATE

ILLINOIS DEPARTMENT OF TRANSPORTATION  
US RTE 6 FROM I-294 TO IL RTE 1

**DRAINAGE AND UTILITIES**  
STA. 2+150 TO STA. 2+294

DU-13  
DATE 01/28/09  
DRAWN BY JAM  
CHECKED BY JWK