

F.A.P. RTE.	SECTION	COUNTY	TOTAL SHEETS	SHEET NO.
351	3277R	COOK	541	273
STA.		TO STA.		
FED. ROAD DIST. NO.		ILLINOIS FED. AID PROJECT		
CONTRACT NO. 60774				

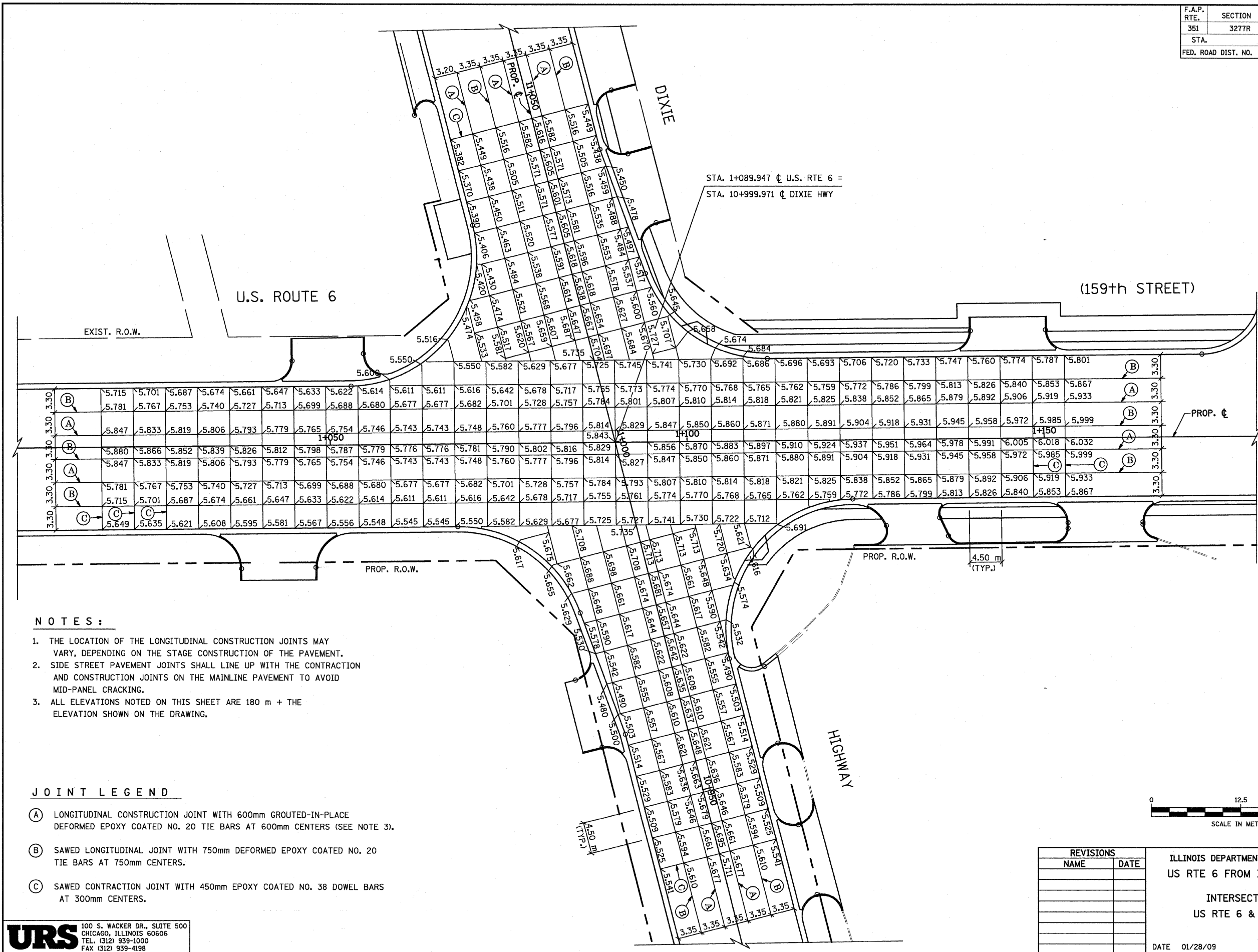

**NOTES:**

1. THE LOCATION OF THE LONGITUDINAL CONSTRUCTION JOINTS MAY VARY, DEPENDING ON THE STAGE CONSTRUCTION OF THE PAVEMENT.
2. SIDE STREET PAVEMENT JOINTS SHALL LINE UP WITH THE CONTRACTION AND CONSTRUCTION JOINTS ON THE MAINLINE PAVEMENT TO AVOID MID-PANEL CRACKING.
3. ALL ELEVATIONS NOTED ON THIS SHEET ARE 180 m + THE ELEVATION SHOWN ON THE DRAWING.

**JOINT LEGEND**

- (A) LONGITUDINAL CONSTRUCTION JOINT WITH 600mm GROUTED-IN-PLACE DEFORMED EPOXY COATED NO. 20 TIE BARS AT 600mm CENTERS (SEE NOTE 3).
- (B) SAWED LONGITUDINAL JOINT WITH 750mm DEFORMED EPOXY COATED NO. 20 TIE BARS AT 750mm CENTERS.
- (C) SAWED CONTRACTION JOINT WITH 450mm EPOXY COATED NO. 38 DOWEL BARS AT 300mm CENTERS.

**URS**  
 100 S. WACKER DR., SUITE 500  
 CHICAGO, ILLINOIS 60606  
 TEL. (312) 939-1000  
 FAX (312) 939-4198

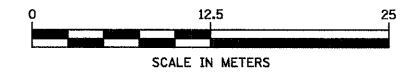

REVISIONS	
NAME	DATE

ILLINOIS DEPARTMENT OF TRANSPORTATION  
 US RTE 6 FROM I-294 TO IL RTE 1  
 INTERSECTION DETAILS  
 US RTE 6 & DIXIE HIGHWAY  
 DATE 01/28/09  
 DRAWN BY VAP  
 CHECKED BY NAP