

QUANTITY  
 4 (100) LINE = 64.1 ft. (19.7 m)  
 21.1 sq. ft. (1.97 sq. m)

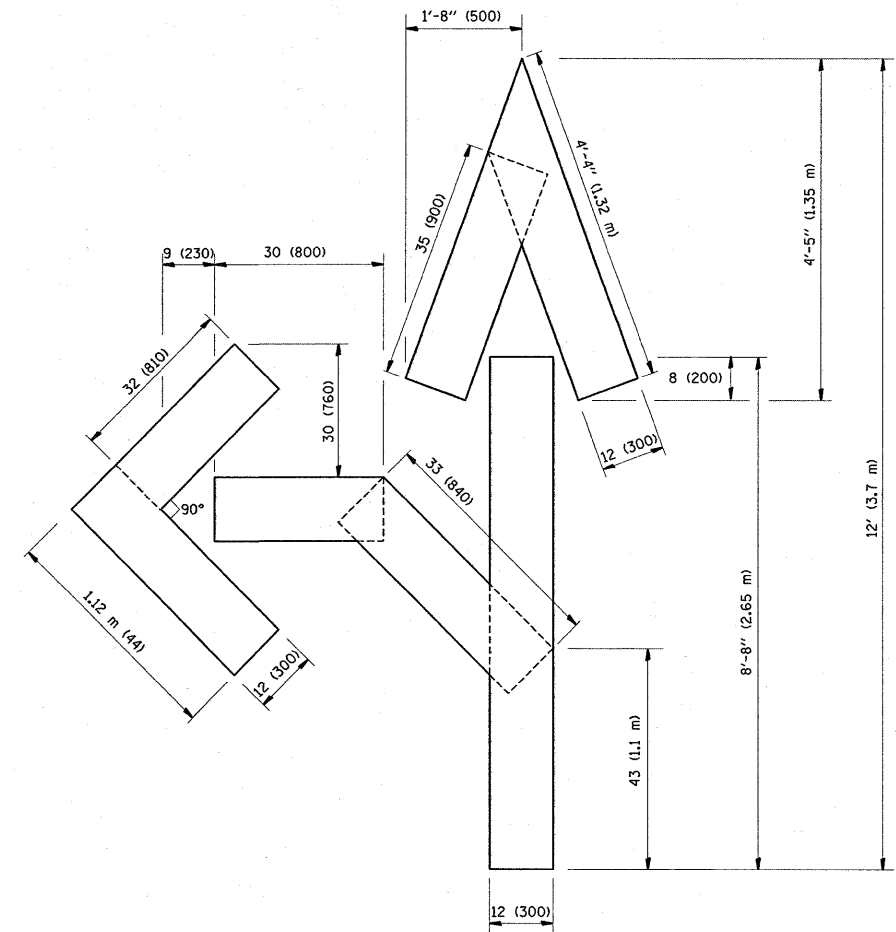

QUANTITY  
 4 (100) LINE = 82.5 ft. (25.3 m)  
 27.5 sq. ft. (2.53 sq. m)

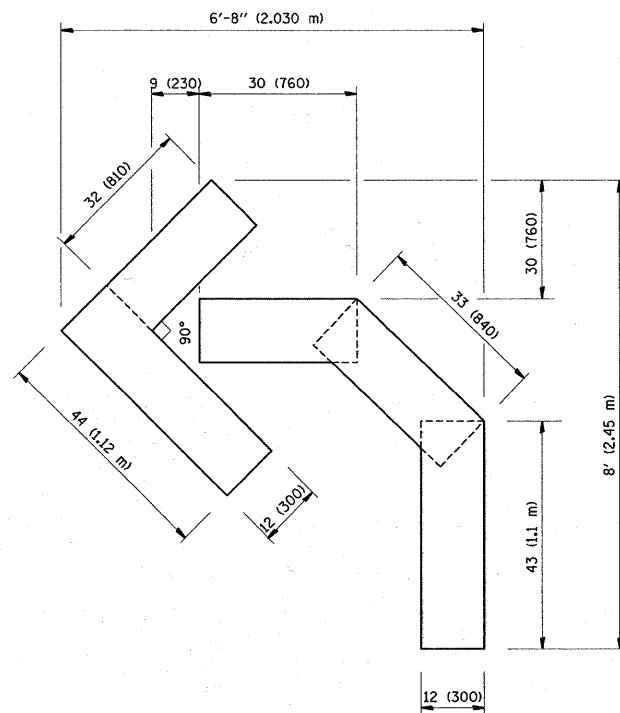

QUANTITY  
 4 (100) LINE = 45.5 ft. (13.9 m)  
 15.2 sq. ft. (1.39 sq. m)

All dimensions are in Inches (millimeters)  
 unless otherwise shown.

FILE NAME =	USER NAME = gorengautab	DESIGNED -	REVISED -T. RAMMACHER 06-05-96
es:\pwork\pwidot\GORENGAUTAB\d0119364\d1stStd.dgn		DRAWN -	REVISED -T. RAMMACHER 11-04-97
	PLOT SCALE = 50.0000' / IN.	CHECKED -	REVISED -T. RAMMACHER 03-02-98
	PLOT DATE = 2/13/2009	DATE - 09-18-94	REVISED -E. GOMEZ 08-28-00

**STATE OF ILLINOIS  
 DEPARTMENT OF TRANSPORTATION**

**PAVEMENT MARKING LETTERS AND SYMBOLS  
 FOR TRAFFIC STAGING**

SCALE: NONE SHEET NO. 1 OF 1 SHEETS STA. 6+60 TO STA. 66+46

F.A.P. RTE.	SECTION	COUNTY	TOTAL SHEETS	SHEET NO.
334	111 RS - 7	MC HENRY	20	18
TC-16		CONTRACT NO. 60041		
FED. ROAD DIST. NO. 1 ILLINOIS FED. AID PROJECT				