

The existing structure was built in 1960 and widened in 1977. It is a three span continuous reinforced concrete slab structure. The substructure consists of open stub abutments and solid shaft piers. The rehabilitation work will be done utilizing stage construction.

The proposed improvements consist of removal of the existing HMA wearing surface, hydroscarifying the deck, deck slab repairs, replacing the existing expansion joints, removing the longitudinal joint, replacing the existing expansion bearings at the abutments, reconstructing the parapets, construction of a latex concrete overlay, and repair of the substructure.

The existing aluminum railing is not to be salvaged.

GENERAL NOTES

Reinforcement bars shall conform to the requirements of ASTM A 706 Gr 60. See Special Provisions.

Reinforcement bars designated (E) shall be epoxy coated.

Plan dimensions and details relative to existing plans are subject to routine variations. The Contractor shall field verify existing dimensions and details affecting new construction and make necessary approved adjustments prior to construction or ordering of materials. Such variations shall not be cause for additional compensation for a change in scope of the work, however, the Contractor will be paid for the quantity actually furnished based upon the unit price bid for the work.

These plans have been prepared from notes received from the Illinois Department of Transportation field maintenance Engineers.

Protective Coat shall not be applied over Latex Concrete Overlay.

INDEX OF SHEETS

1. General Plan and Elevation
2. Typical Cross Sections with Staging
3. Expansion Joint Removal at Deck
4. Expansion Joint Rehabilitation at Deck
5. Expansion Joint Rehabilitation at Parapet and Wingwall
6. Longitudinal Joint Details
7. Parapet Rehabilitation
8. Preformed Joint Strip Seal
9. Bar Splicer Assembly Details
10. Bearing Replacement Details
11. Deck Repair Plan
12. Abutment Repairs
13. Pier Repairs - I
14. Pier Repairs - II

TOTAL BILL OF MATERIAL

| ITEM | UNIT | SUPER | SUB | TOTAL |
|--|---------|--------|-----|--------|
| Bridge Rail Removal | Foot | 211 | | 211 |
| Hot-Mix Asphalt Surface Removal (Deck) | Sq. Yd. | 676 | | 676 |
| Concrete Removal | Cu. Yd. | 102.7 | | 102.7 |
| Bridge Deck Hydro-Scarification, 3/4" | Sq. Yd. | 634 | | 634 |
| Deck Slab Repair (Partial) | Sq. Yd. | 4 | | 4 |
| Deck Slab Repair (Full Depth, Type II) | Sq. Yd. | 20 | | 20 |
| Bridge Deck Latex Concrete Overlay, 2 1/4" | Sq. Yd. | 634 | | 634 |
| Temporary Shoring and Cribbing | L. Sum | 1 | | 1 |
| Elastomeric Bearing Assembly, Type I | Each | 48 | | 48 |
| Preformed Joint Strip Seal | Foot | 200 | | 200 |
| Concrete Superstructure | Cu. Yd. | 117.1 | | 117.1 |
| Protective Coat | Sq. Yd. | 336 | | 336 |
| Bridge Deck Grooving | Sq. Yd. | 612 | | 612 |
| Reinforcement Bars, Epoxy Coated | Pound | 16,070 | | 16,070 |
| Bar Splicers | Each | 48 | | 48 |
| Structural Repair of Concrete (Depth equal to or less than 5") | Sq. Ft. | | 22 | 22 |
| Structural Repair of Concrete (Depth greater than 5") | Sq. Ft. | | 3 | 3 |
| Cleaning and Painting Structural Steel, Location 1 | L. Sum | 1 | | 1 |

| | | | | | |
|-----------------------|------------|------------------|--------------|-----------|-------------|
| ROUTE NO. | SECTION | COUNTY | TOTAL SHEETS | SHEET NO. | SHEET NO. 1 |
| FAP 348 | 3128-Z-B-1 | Cook | 35 | 16 | 14 SHEETS |
| FED. ROAD DIST. NO. 7 | ILLINOIS | FED. AID PROJECT | | | |

Contract #60D70

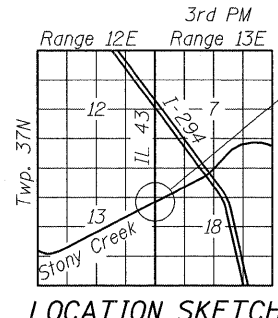
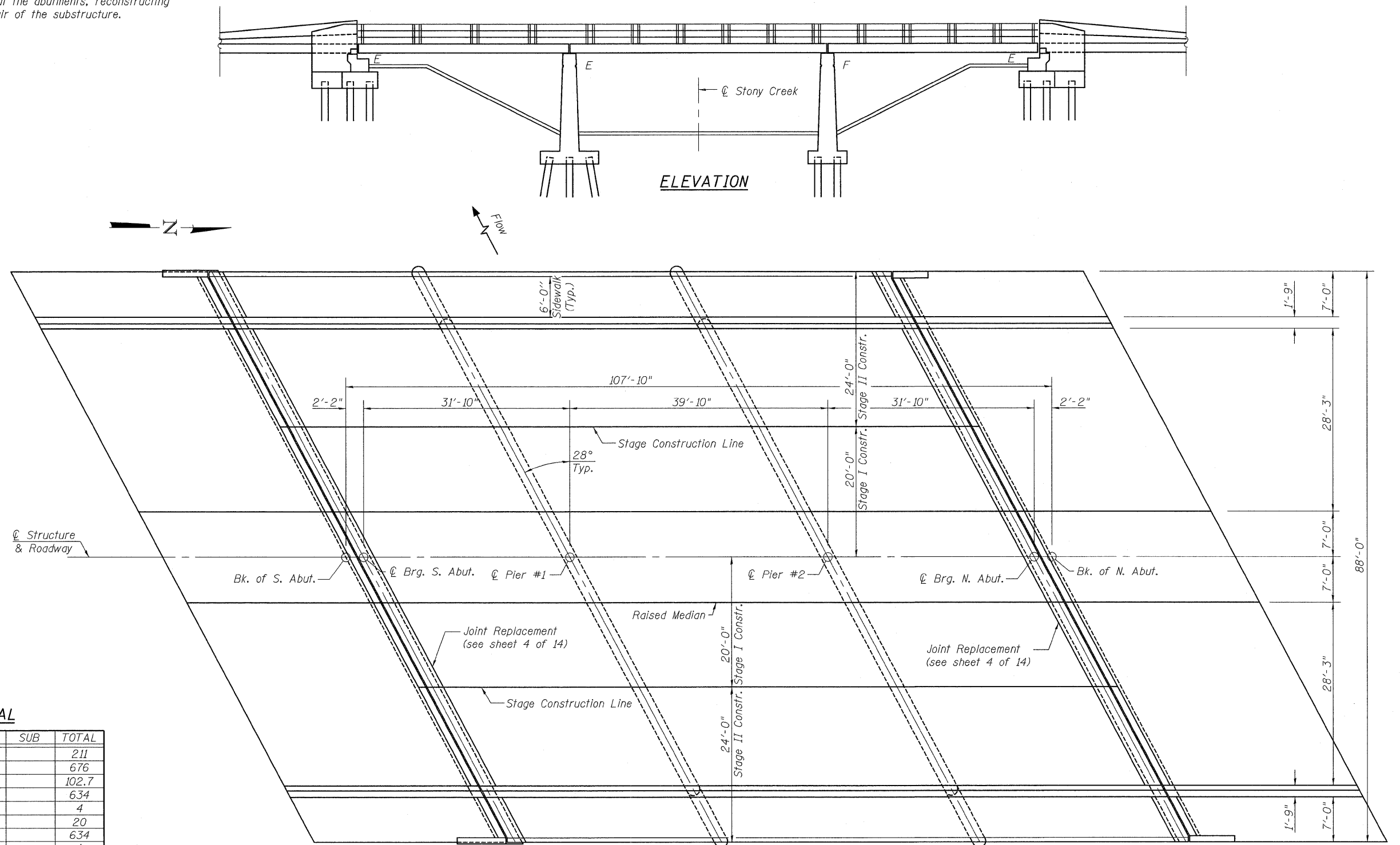

DESIGN STRESSES

FIELD UNITS
 f'c = 3,500 psi
 fy = 60,000 psi (Reinforcement)

LOADING HS 20-44

DESIGN SPECIFICATIONS
 2002 AASHTO Standard Specifications
 for Highway Bridges

PLAN

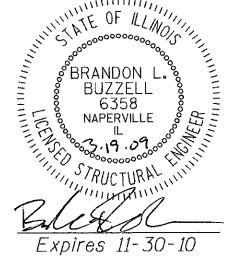

200 West Front Street
 Wheaton, IL 60187

ILLINOIS DEPARTMENT OF TRANSPORTATION

GENERAL PLAN AND ELEVATION
 IL 43 OVER STONY CREEK
 FAP RTE 348 SECTION 3128-Z-B-1
 COOK COUNTY
 STATION 179+01.40
 STRUCTURE NO. 016-0322

DATE: 1-30-2009

DRAWN BY WJV
 CHECKED BY BLB