

STATE OF ILLINOIS
DEPARTMENT OF TRANSPORTATION

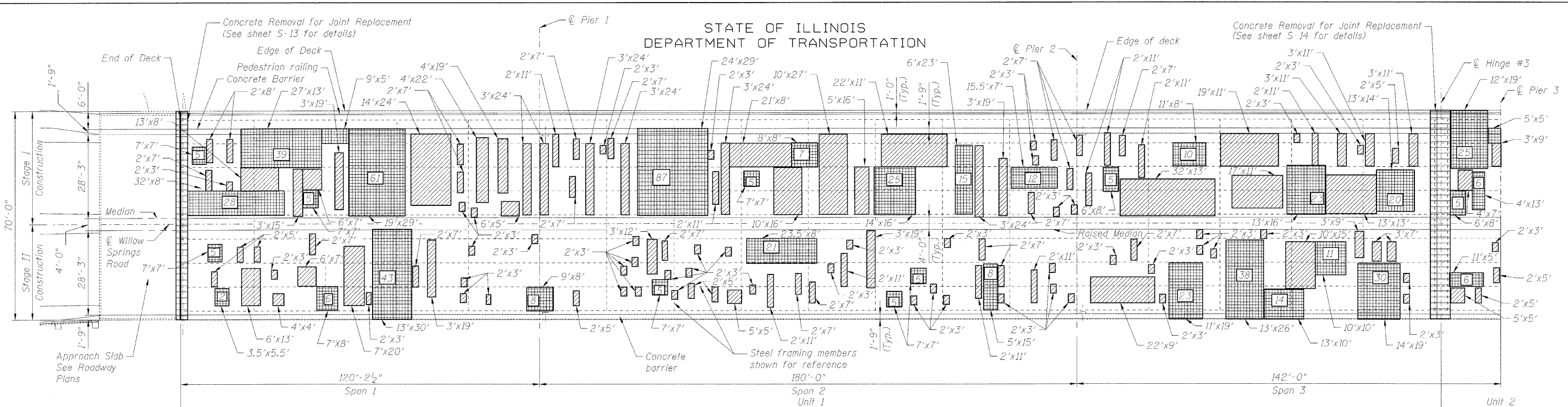

DECK PLAN

Deck Slab Repair (Partial Depth)
Estimated Quantity 1133 Sq. Yd.
FOR INFORMATION ONLY

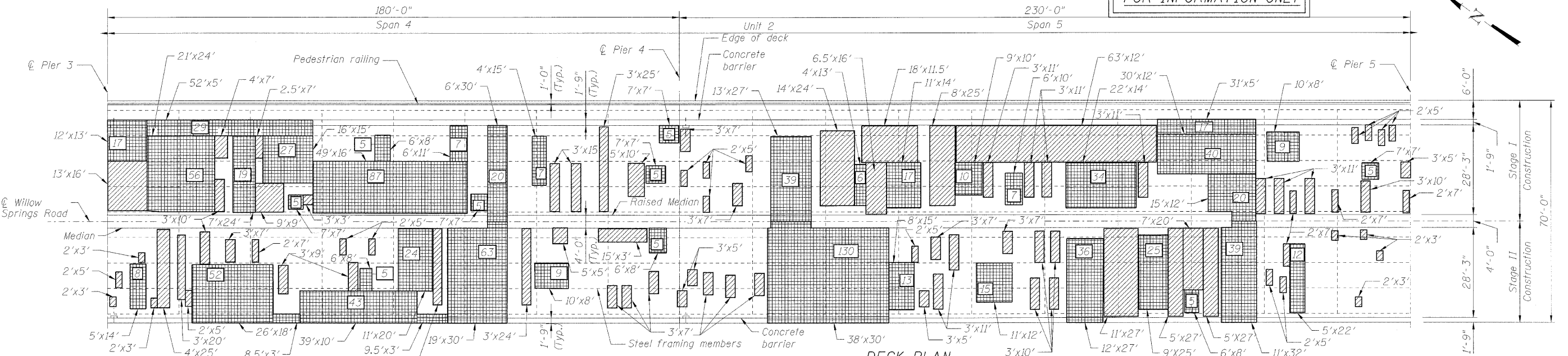

DECK PLAN

BILL OF MATERIAL

| ITEM | UNIT | QUANTITY |
|--|---------|----------|
| Hot-Mix Asphalt Surface Removal (Deck) | Sq. Yd. | 5,350 |
| Concrete Removal | Cu. Yd. | 24.8 |
| Bridge Deck Grooving | Sq. Yd. | 4,971 |
| Protective Coat | Sq. Yd. | 5,362 |
| Bridge Deck Latex Concrete Overlay, 2 1/2 inches | Sq. Yd. | 5,290 |
| Bridge Deck Hydro-Scarification 1" | Sq. Yd. | 5,350 |
| Deck Slab Repair (Full Depth, Type II) | Sq. Yd. | 1,760 |

LAST DELAMINATION SURVEY:
November 27, 2007
(Typical for all superstructure repairs)

SUPERSTRUCTURE REPAIRS I
S.N. 016-0540

- LEGEND:**
- Deck Slab Repair (Full Depth), Type II
X denotes estimated quantity in Sq. Yd.
 - Concrete removal for expansion joint replacement
 - Deck Slab Repair (Partial Depth)
For information only, Quantity included with Bridge Deck Hydro-Scarification 1"

- NOTES:**
- Repairs shall include but not be limited to the areas shown. The actual areas to be determined by the Engineer at the time of construction.
 - If the length along the bridge centerline of Deck Slab Repairs (Full Depth, Type II) when measured in the field and approved by the Engineer exceeds what is indicated in plan and is equal or greater than 10 feet, the entire section of the adjacent parapet shall be removed and replaced according to details shown on Sheet S-15A.
 - The Engineer shall record the actual deck repair areas in order to document as-built conditions for the future reference.

- For expansion joint rehabilitation, see sheet S-13 thru S-15.
- For parapet removal and repairs see sheet S-9 thru S-12.
- Concrete Removal includes only deck removal at joints.
- Contractor shall use extreme care in the concrete removal operation. Any spalling, beam, shear stud or rebar damage caused by this operation shall be repaired by the Contractor to the satisfaction of the Engineer at no additional cost to the Department.
- Quantities in the Bill of Material for Deck Slab Repairs Full Depth, Type II are 10% greater than areas shown on deck plan to accommodate for degradation since last delamination survey.
- Protective coat shall be applied to N.B. & S.B. Lanes and to newly constructed and repaired areas of concrete on parapets and median.
- Existing reinforcement in the deck shall be cleaned and incorporated into the repairs. Cost included with Deck Slab Repair (Full Depth, Type II).
- Existing scuppers to be temporarily supported and cast with proposed deck if affected by Deck Slab Repair. Cost included with Deck Slab Repair (Full Depth, Type II).
- Bridge Deck Latex Concrete Overlay for each stage shall be placed only after all Deck Slab Repairs for the stage have been completed.

DESIGNED B. Sauter
CHECKED E. Mroczek
DRAWN R. Danley
CHECKED B. Sauter



| | | | | | |
|---------------------|-------------|---------------------------|--------------------|--------------|-----------|
| SHEET NO. S-7 | F.A.U. RTE. | SECTION | COUNTY | TOTAL SHEETS | SHEET NO. |
| | 2697 | 142 B-1-I | COOK | 48 | 21 |
| S-27 SHEETS | | | CONTRACT NO. 60D89 | | |
| FED. ROAD DIST. NO. | | ILLINOIS FED. AID PROJECT | | | |

1 Entire Sheet Revised 4/08/09 E.K.M

4/8/2009 rdanley m:\pro\3329\3329_30\design\structural\concrete_repairs\3329_30_07-Deck_Repairs1 - REV 1a.rvt