

STAGE I TRAFFIC CONTROL
(SIGNING & BARRICADING TO BE INSTALLED
IN ACCORDANCE WITH STANDARD 701316)

TRAFFIC CONTROL AND STAGING LEGEND

- WORK ZONE
- DIRECTION OF TRAFFIC
- TYPE III BARRICADES WITH FLASHING LIGHTS
- TEMPORARY TRAFFIC SIGNAL HEAD
- TEMPORARY TRAFFIC SIGN

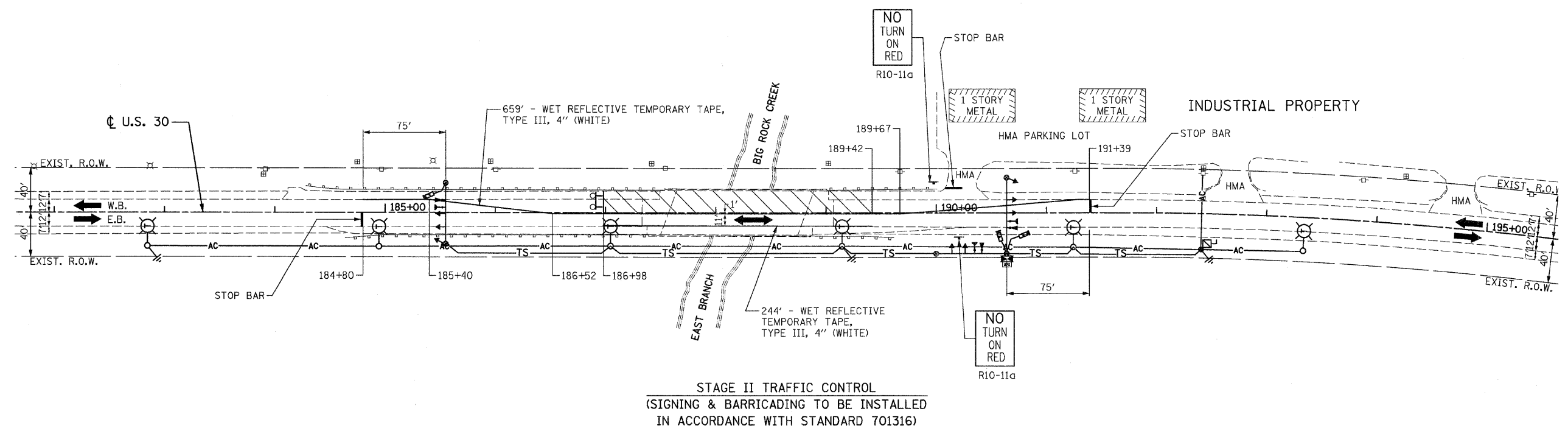

STAGE II TRAFFIC CONTROL
(SIGNING & BARRICADING TO BE INSTALLED
IN ACCORDANCE WITH STANDARD 701316)

FILE NAME = D160E63-sh1-staging2.dgn
PLOT DATE = 1/26/2009

CHRISTIAN-ROGE & ASSOCIATES, INC.
ENGINEERS-PLANNERS-SURVEYORS
211 WEST WACKER DRIVE
CHICAGO, ILLINOIS 60606
PHONE: (312)372-2023 FAX: (312)372-5274

DESIGNED - S.J.P.	REVISED -
DRAWN - A.C.S.	REVISED -
CHECKED - E.J.M.	REVISED -
DATE - JANUARY 28, 2009	REVISED -

STATE OF ILLINOIS
DEPARTMENT OF TRANSPORTATION

SUGGESTED TRAFFIC CONTROL AND STAGING PLAN
U.S. 30 OVER EAST BRANCH BIG ROCK CREEK

SCALE: 1" = 50' SHEET NO. 3 OF 3 SHEETS STA. 186+98 TO STA. 189+42

F.A.P. RTE.	SECTION	COUNTY	TOTAL SHEETS	SHEET NO.
573	117 R-2B-R	KANE	40	9
CONTRACT NO. 60E63				
FED. ROAD DIST. NO. 1 ILLINOIS FED. AID PROJECT				