



TEMPORARY LIGHTING LEGEND

EXISTING	PROPOSED	
—A—		400W, 120V, MCIII HPS. WITH PHOTO CELL 15' MA, 50 MH ON WOOD POLE,
		AERIAL LINE (COMED/TELEPHONE)
	TL-1	WOODEN POLE (60' WOODEN CLASS 4) WITH TEMPORARY LIGHTING UNIT
		WOOD POLE (25' CLASS 4) FOR TEMPORARY LIGHTING
	—AC—	AERIAL ELECTRIC CABLE WITH MESSENGER WIRE
		5/8" x 10' GROUND ROD
	ESD	ELECTRIC SERVICE DISCONNECT, LIGHTING AND TRAFFIC SIGNAL
		COMED POWER POLE
		TELEPHONE SPLICE BOX

TEMPORARY TRAFFIC SIGNAL LEGEND

PROPOSED	
	TEMPORARY TRAFFIC SIGNAL HEAD
TSC	TEMPORARY TRAFFIC SIGNAL CONTROLLER CABINET
—TS—	TEMPORARY TRAFFIC SIGNAL SPAN WIRE, TETHER WIRE, AND CABLE
	VIDEO DETECTOR SENSOR
TS-1	WOOD POLE (CLASS 5 OR BETTER, 45 FOOT (13.7m) MINIMUM) FOR TEMPORARY TRAFFIC SIGNAL (TO BE INSTALLED 8' BEHIND GUARDRAIL, OTHERWISE 20' FROM EDGE OF TRAVELED WAY WITH NO GUARD RAIL)
	DIRECTION OF TRAFFIC FLOW
	EMERGENCY VEHICLE LIGHT DETECTOR
	CONFIRMATION BEACON
	UNINTERRUPTIBLE POWER SUPPLY

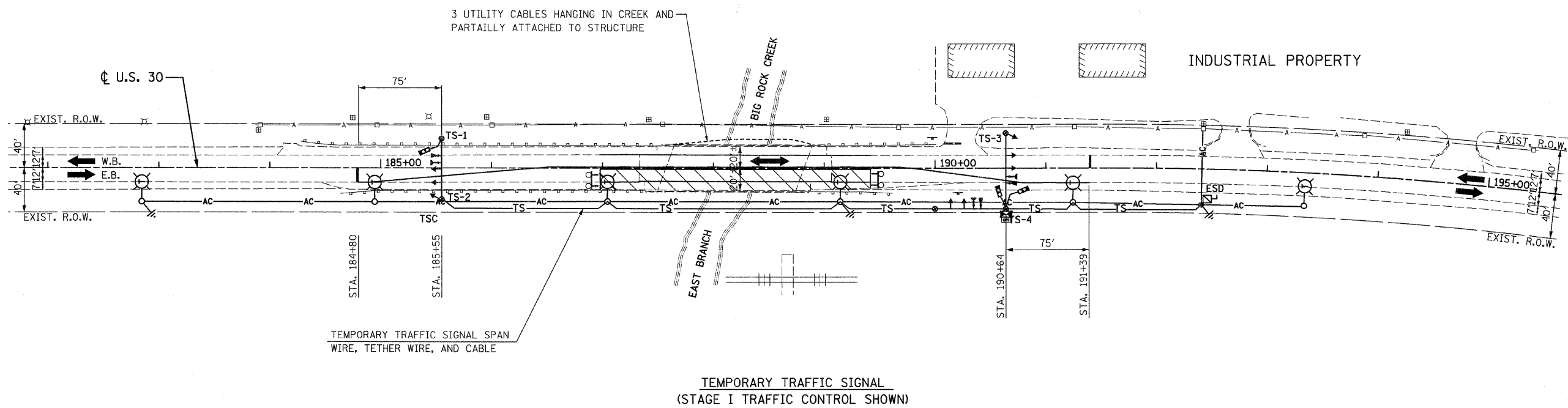

FILE NAME = D160E63-sht-ts3.dgn
PLOT DATE = 1/26/2009

CHRISTIAN-ROGE & ASSOCIATES, INC.
ENGINEERS-PLANNERS-SURVEYORS
211 WEST WACKER DRIVE
CHICAGO, ILLINOIS 60606
PHONE: (312)372-2023 FAX: (312)372-5274

DESIGNED - M.A.	REVISED -
DRAWN - M.A.	REVISED -
CHECKED - E.J.M.	REVISED -
DATE - JANUARY 28, 2009	REVISED -

**STATE OF ILLINOIS
DEPARTMENT OF TRANSPORTATION**

**TEMPORARY TRAFFIC SIGNAL PLAN
U.S. 30 OVER EAST BRANCH BIG ROCK CREEK**

SCALE: 1" = 50' SHEET NO. 3 OF 4 SHEETS STA. 186+98 TO STA. 189+42

F.A.P. RTE.	SECTION	COUNTY	TOTAL SHEETS	SHEET NO.
573	117 R-2B-R	KANE	40	12
CONTRACT NO. 60E63				
FED. ROAD DIST. NO. 1 ILLINOIS FED. AID PROJECT				