

ABUTMENT EXPANSION JOINT PLAN
(WEST ABUTMENT SHOWN - EAST ABUTMENT SIMILAR)

BILL OF MATERIAL

BAR	NO.	SIZE	LENGTH	SHAPE
a(E)	16	#7	28'-2"	—
a1(E)	4	#6	27'-2"	—
a2(E)	16	#7	24'-2"	—
a3(E)	4	#6	23'-2"	—
a4(E)	8	#6	28'-10"	—
a5(E)	8	#6	24'-7"	—
a6(E)	48	#6	7'-0"	—
a7(E)	48	#6	4'-0"	—
b(E)	22	#5	6'-0"	—
c1(E)	14	#5	5'-6"	—
c2(E)	28	#5	3'-0"	—
d(E)	14	#4	4'-9"	L
d1(E)	14	#6	4'-0"	L
d2(E)	14	#4	5'-3"	L
d3(E)	14	#6	4'-6"	L
u(E)	96	#5	2'-9"	U
u1(E)	4	#4	2'-0 1/2"	U
x(E)	83	#6	7'-5"	□
x1(E)	83	#6	7'-7"	□
REINFORCEMENT BARS (EPOXY COATED)			POUND	6180
CONCRETE REMOVAL			CU. YD.	32.8
CONCRETE SUPERSTRUCTURE			CU. YD.	32.8
PREFORMED JOINT STRIP SEAL			FOOT	109
STRUCTURAL REPAIR OF CONCRETE ≤ 5"			SO. FT.	18
CLEANING DRAINAGE SYSTEM			L. SUM	1
PROTECTIVE COAT			SO. YD.	5431
NEOPRENE EXPANSION JOINT, 4"			FOOT	109
BAR SPLICERS			EACH	36

NOTE:
FOR BAR SPLICER ASSMBLIES SEE SHEET NO. 6 OF 9

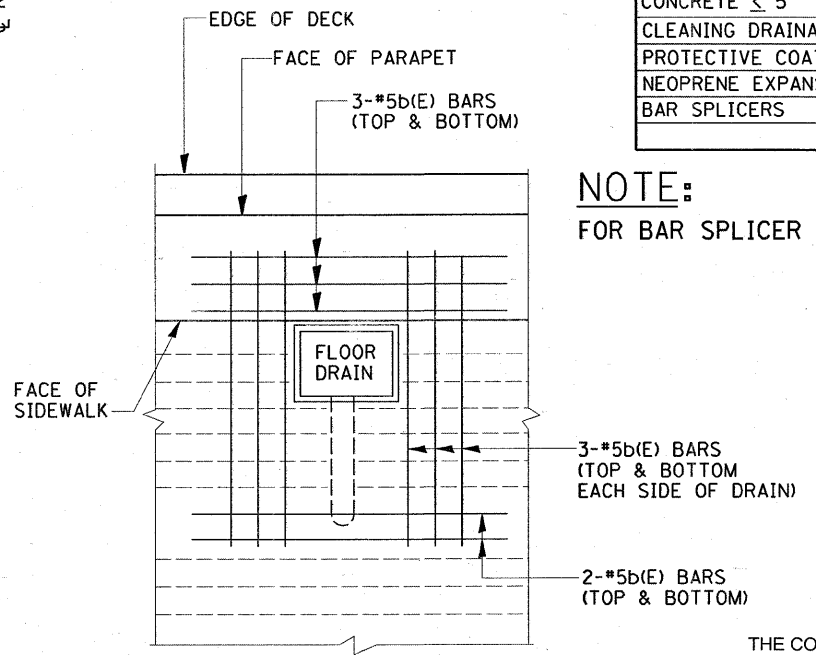

FLOOR DRAIN DETAIL
(AT WEST ABUTMENT ONLY)

NOTE:
CUT MAIN DECK REINFORCEMENT INTERFERING WITH FLOOR DRAINS TO CLEAR FLOOR DRAIN BY 2"

THE CONCRETE REMOVAL LINE AT THE NORTH-WEST AND SOUTH-EAST CORNERS MAY INTERSECT WITH THE EXISTING DECK DRAINS. THE CONTRACTOR SHALL EXERCISE CARE NOT TO DAMAGE THE DRAINS DURING CONCRETE REMOVAL. TEMPORARY SUPPORT OF THE DRAINS MAY BE REQUIRED DURING CONCRETE REMOVAL AND REPLACEMENT. ANY DAMAGE TO THE DRAINS CAUSED DURING THE CONCRETE REMOVAL OPERATION MUST BE REPAIRED AT THE CONTRACTOR'S EXPENSE.