

ROUTE	SECTION	COUNTY	TOTAL SHEETS	SHEET NUMBER
VARIOUS	2008-053 BP	VARIOUS	54	16

CONTRACT NO. 60F04

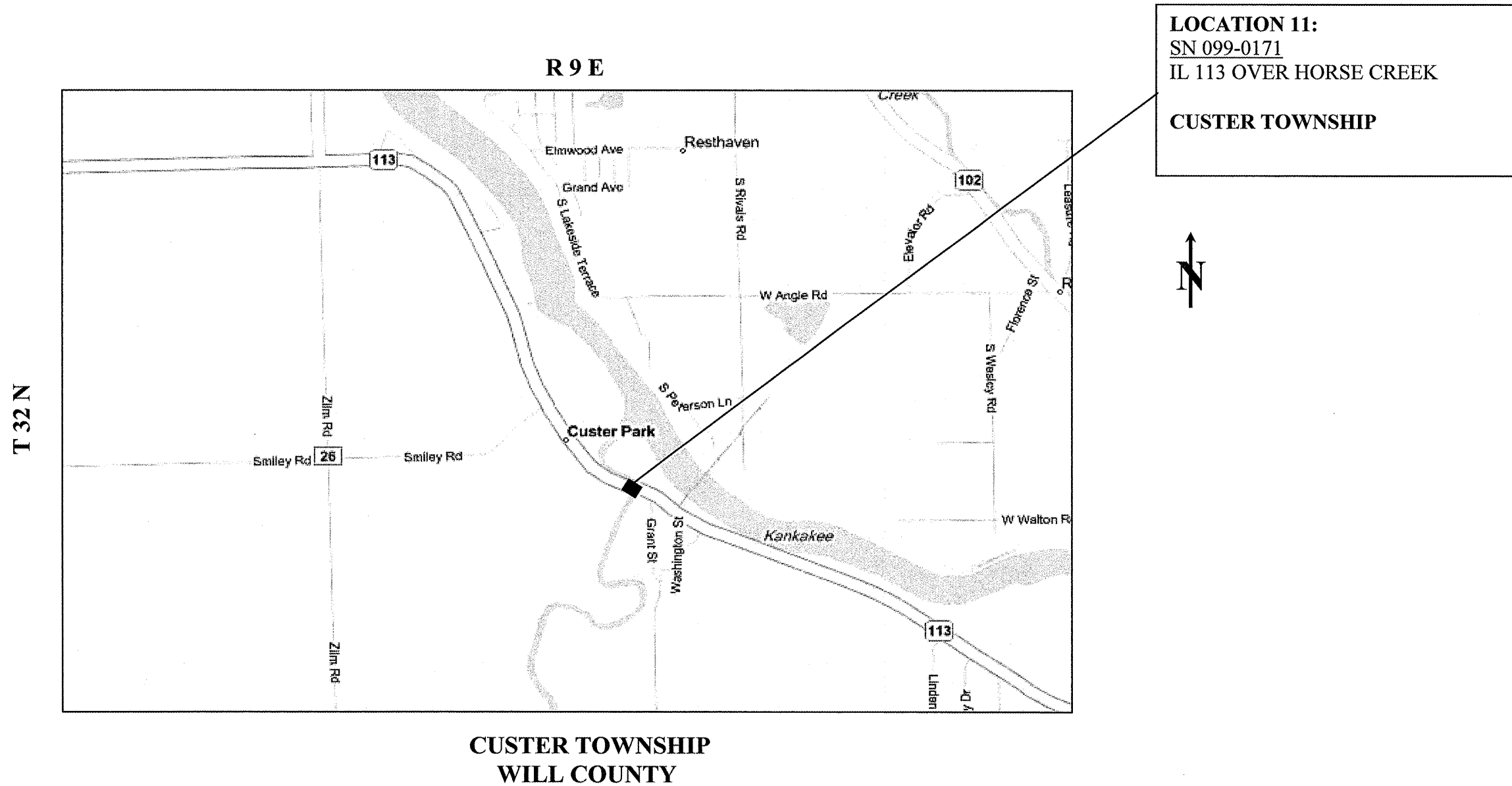

TRAFFIC DATA: IL 113	
2007 ADT	= 3,700
POSTED SPEED LIMIT	= 55 MPH

ILLINOIS DEPARTMENT OF TRANSPORTATION

LOCATION MAPS

LOCATION 11: IL 113 OVER HORSE CREEK