

TYPICAL ENTRANCE/EXIT RAMP COMBINATION PAVEMENT MARKINGS

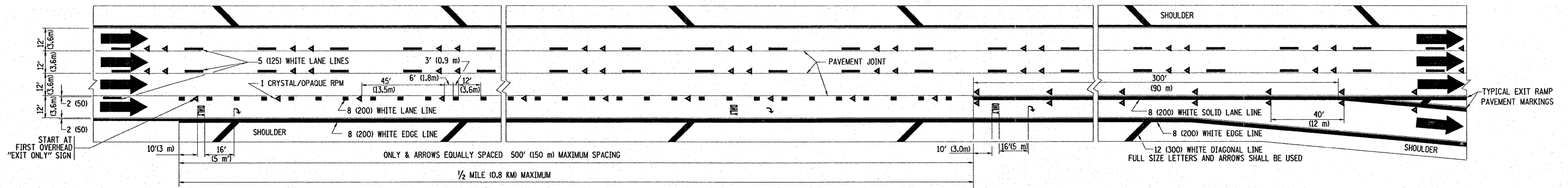

TYPICAL EXIT ONLY LANE PAVEMENT MARKINGS

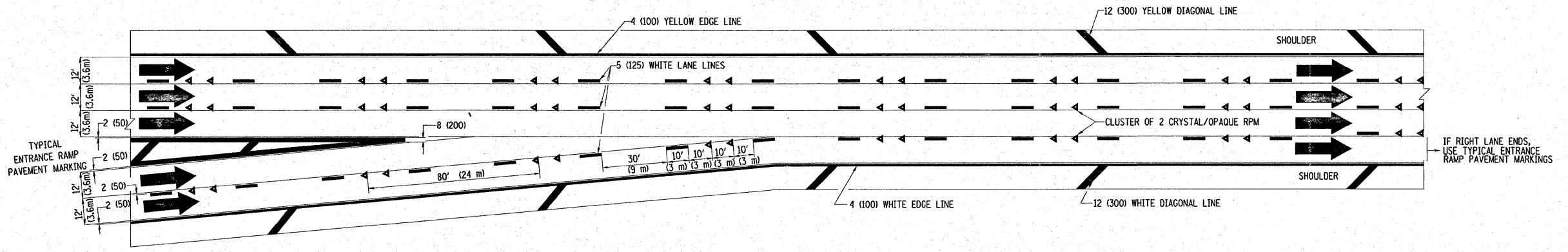

TYPICAL TWO LANE ENTRANCE RAMP PAVEMENT MARKINGS

FILE NAME =	USER NAME = steedpa	DESIGNED - D.W.S.	REVISED - A.H. 03-96	STATE OF ILLINOIS DEPARTMENT OF TRANSPORTATION	MULTI-LANE FREEWAY PAVEMENT MARKING DETAILS			F.A. RTE. = 290	SECTION = 2008-056 I	COUNTY = COOK	TOTAL SHEETS = 32	SHEET NO. = 29
c:\pw_work\pwidot\stedpa\dms92445\Dist\std.dgn	PLOT SCALE = 50.0000 "/ IN.	DRAWN -	REVISED - D.W.S. 07-96		SCALE: NONE	SHEET NO. 2 OF 2 SHEETS	STA. TO STA.	FED. ROAD DIST. NO. 1 ILLINOIS FED. AID PROJECT				
	PLOT DATE = 12/16/2008	CHECKED -	REVISED - J.A.F. 02-06					TC-12 CONTRACT NO. 60F11				
		DATE - 01-90	REVISED - S.P.B. 01-07									