

BILL OF MATERIAL

Bar	No.	Size	Length	Shape
a(E)	224	#7	5'-4"	
b(E)	24	#5	29'-10"	—
b1(E)	24	#5	26'-8"	—
c(E)	112	#5	6'-4"	
Reinforcement Bars, Epoxy Coated			Pound	4,600
Concrete Removal			Cu. Yd.	22.3
Concrete Superstructure			Cu. Yd.	21.0

Bars indicated thus 4x2-#5 etc., indicates 4 lines of bars with 2 lengths per line

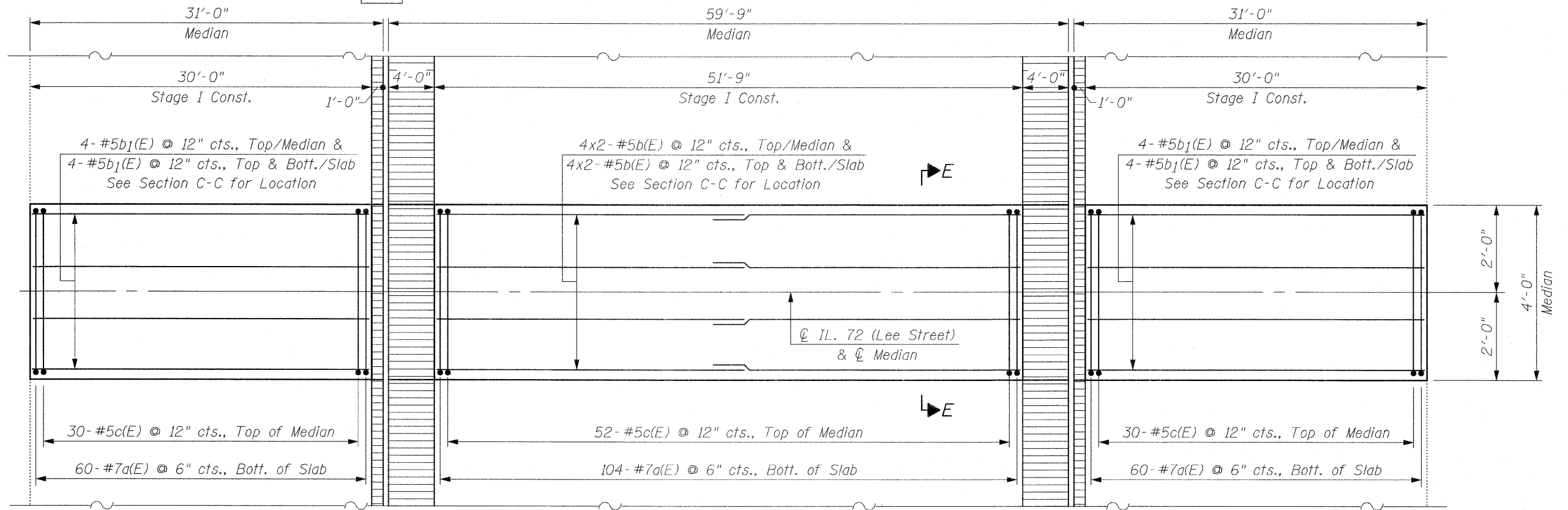

FILE NAME = median_repair.dgn
PLOT DATE = 3/23/2009

CHRISTIAN-ROGE & ASSOCIATES, INC.
ENGINEERS-PLANNERS-SURVEYORS
211 WEST WACKER DRIVE
CHICAGO, ILLINOIS 60606
PHONE: (312)372-2023 FAX: (312)372-5274

DESIGNED - B.N.S./J.C.N.	REVISED -
DRAWN - F.M.	REVISED -
CHECKED - B.N.S./J.C.N.	REVISED -
DATE - MARCH, 2009	REVISED -

STATE OF ILLINOIS
DEPARTMENT OF TRANSPORTATION

MEDIAN RECONSTRUCTION
IL. 72 (LEE STREET) OVER WILLOW CREEK S.N. 016-0506

SCALE: SHEET NO. 56 OF 510 SHEETS STA. TO STA.

F.A.U. RTE.	SECTION	COUNTY	TOTAL SHEETS	SHEET NO.
1350	2008-063 RS	COOK	42	27
FED. ROAD DIST. NO. ILLINOIS FED. AID PROJECT			CONTRACT NO. 60F40	