

PROP. RESURFACING NOTES:

HMA SURFACE REMOVAL, 2 1/2"
 POLYMERIZED HMA SURFACE COURSE, MIX "F", N90, 1 3/4"
 POLYMERIZED LEVELING BINDER (MM), IL-4.75, N50, 3/4"

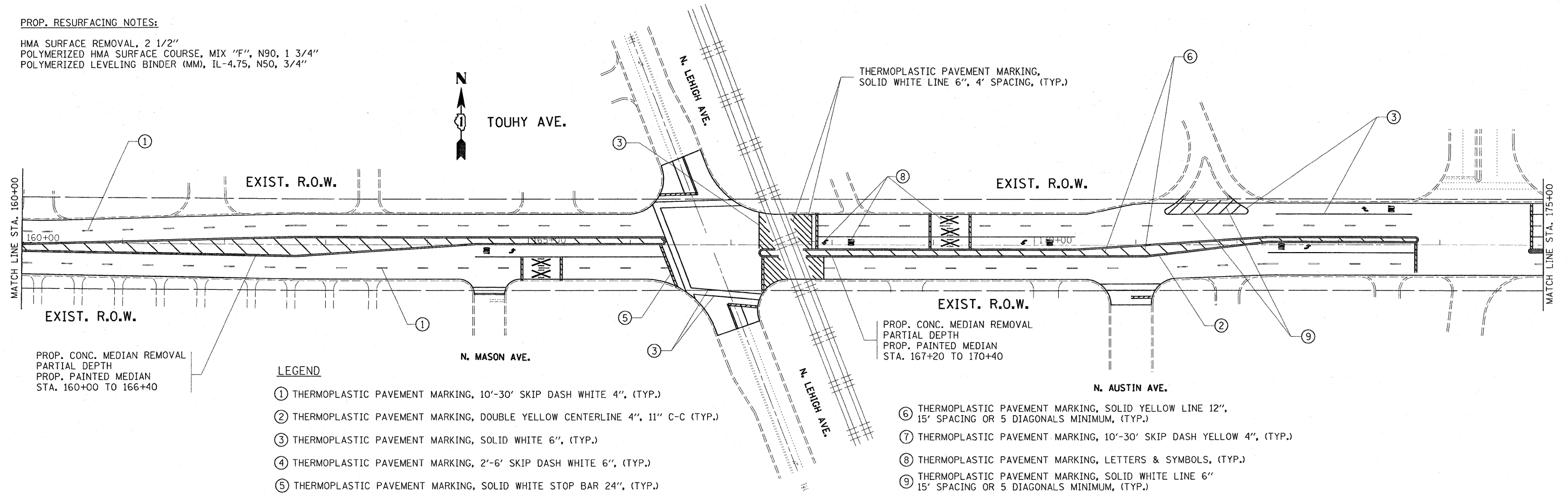

LEGEND

- ① THERMOPLASTIC PAVEMENT MARKING, 10'-30' SKIP DASH WHITE 4", (TYP.)
- ② THERMOPLASTIC PAVEMENT MARKING, DOUBLE YELLOW CENTERLINE 4", 11" C-C (TYP.)
- ③ THERMOPLASTIC PAVEMENT MARKING, SOLID WHITE 6", (TYP.)
- ④ THERMOPLASTIC PAVEMENT MARKING, 2'-6' SKIP DASH WHITE 6", (TYP.)
- ⑤ THERMOPLASTIC PAVEMENT MARKING, SOLID WHITE STOP BAR 24", (TYP.)

- ⑥ THERMOPLASTIC PAVEMENT MARKING, SOLID YELLOW LINE 12", 15' SPACING OR 5 DIAGONALS MINIMUM, (TYP.)
- ⑦ THERMOPLASTIC PAVEMENT MARKING, 10'-30' SKIP DASH YELLOW 4", (TYP.)
- ⑧ THERMOPLASTIC PAVEMENT MARKING, LETTERS & SYMBOLS, (TYP.)
- ⑨ THERMOPLASTIC PAVEMENT MARKING, SOLID WHITE LINE 6" 15' SPACING OR 5 DIAGONALS MINIMUM, (TYP.)

PROP. RESURFACING NOTES:

HMA SURFACE REMOVAL, 2 1/2"
 POLYMERIZED HMA SURFACE COURSE, MIX "F", N90, 1 3/4"
 POLYMERIZED LEVELING BINDER (MM), IL-4.75, N50, 3/4"

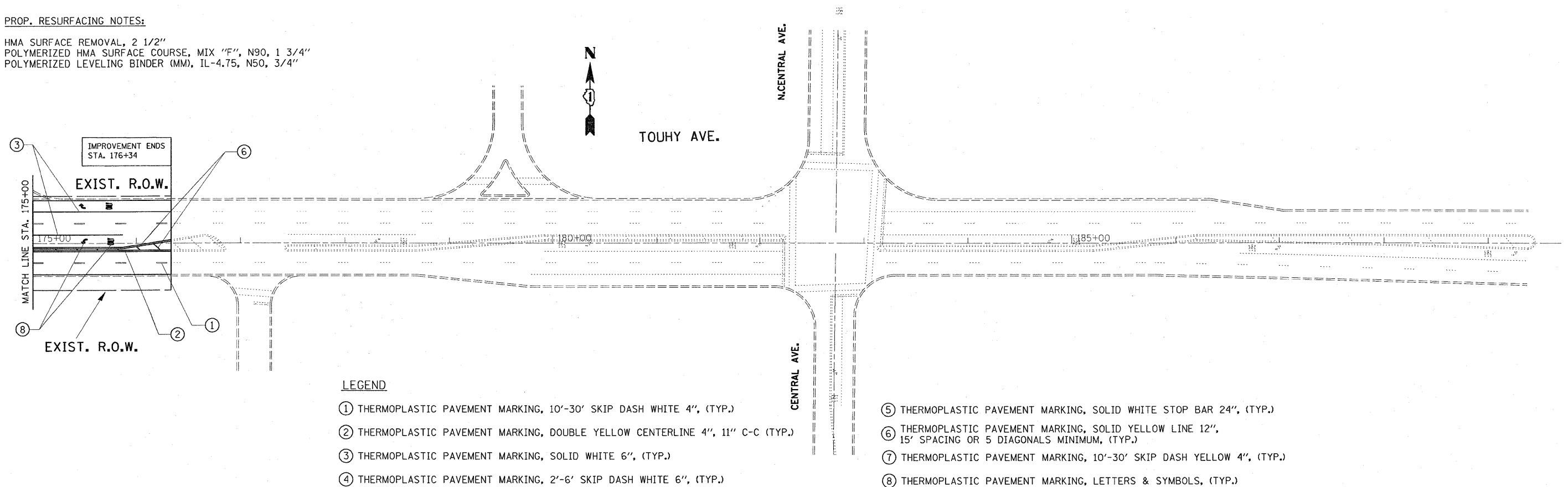

LEGEND

- ① THERMOPLASTIC PAVEMENT MARKING, 10'-30' SKIP DASH WHITE 4", (TYP.)
- ② THERMOPLASTIC PAVEMENT MARKING, DOUBLE YELLOW CENTERLINE 4", 11" C-C (TYP.)
- ③ THERMOPLASTIC PAVEMENT MARKING, SOLID WHITE 6", (TYP.)
- ④ THERMOPLASTIC PAVEMENT MARKING, 2'-6' SKIP DASH WHITE 6", (TYP.)

- ⑤ THERMOPLASTIC PAVEMENT MARKING, SOLID WHITE STOP BAR 24", (TYP.)
- ⑥ THERMOPLASTIC PAVEMENT MARKING, SOLID YELLOW LINE 12", 15' SPACING OR 5 DIAGONALS MINIMUM, (TYP.)
- ⑦ THERMOPLASTIC PAVEMENT MARKING, 10'-30' SKIP DASH YELLOW 4", (TYP.)
- ⑧ THERMOPLASTIC PAVEMENT MARKING, LETTERS & SYMBOLS, (TYP.)

FILE NAME = c:\pw_work\PWIDOT\KELLERS\dms9422\1010	USER NAME = kellers	DESIGNED -	REVISED -	STATE OF ILLINOIS DEPARTMENT OF TRANSPORTATION	TOUHY AVE. (N.W. HWY TO CENTRAL AVE.) EXISTING AND PROPOSED ROADWAY AND PAVEMENT MARKING PLAN			F.A.P. RTE. 341.375	SECTION 2326.IRS-1	COUNTY COOK	TOTAL SHEETS 30	SHEET NO. 13
	909-shr-plan.dgn	DRAWN -	REVISED -		SCALE: 1" = 50'	SHEET NO. OF	SHEETS STA.	TO STA.	FED. ROAD DIST. NO. ILLINOIS FED. AID PROJECT	CONTRACT NO. 60F48		
	PLOT SCALE = 50.0000' / IN.	CHECKED -	REVISED -									
	PLOT DATE = 1/30/2009	DATE -	REVISED -									