

3/4/2009

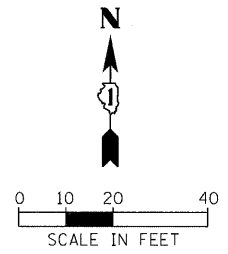

NOTES

- 1. EXISTING CORNER LUMINAIRE AND MAST ARM TO BE REMOVED FROM COMED WOOD POLE AND IN ACCORDANCE WITH GENERAL NOTES #21.

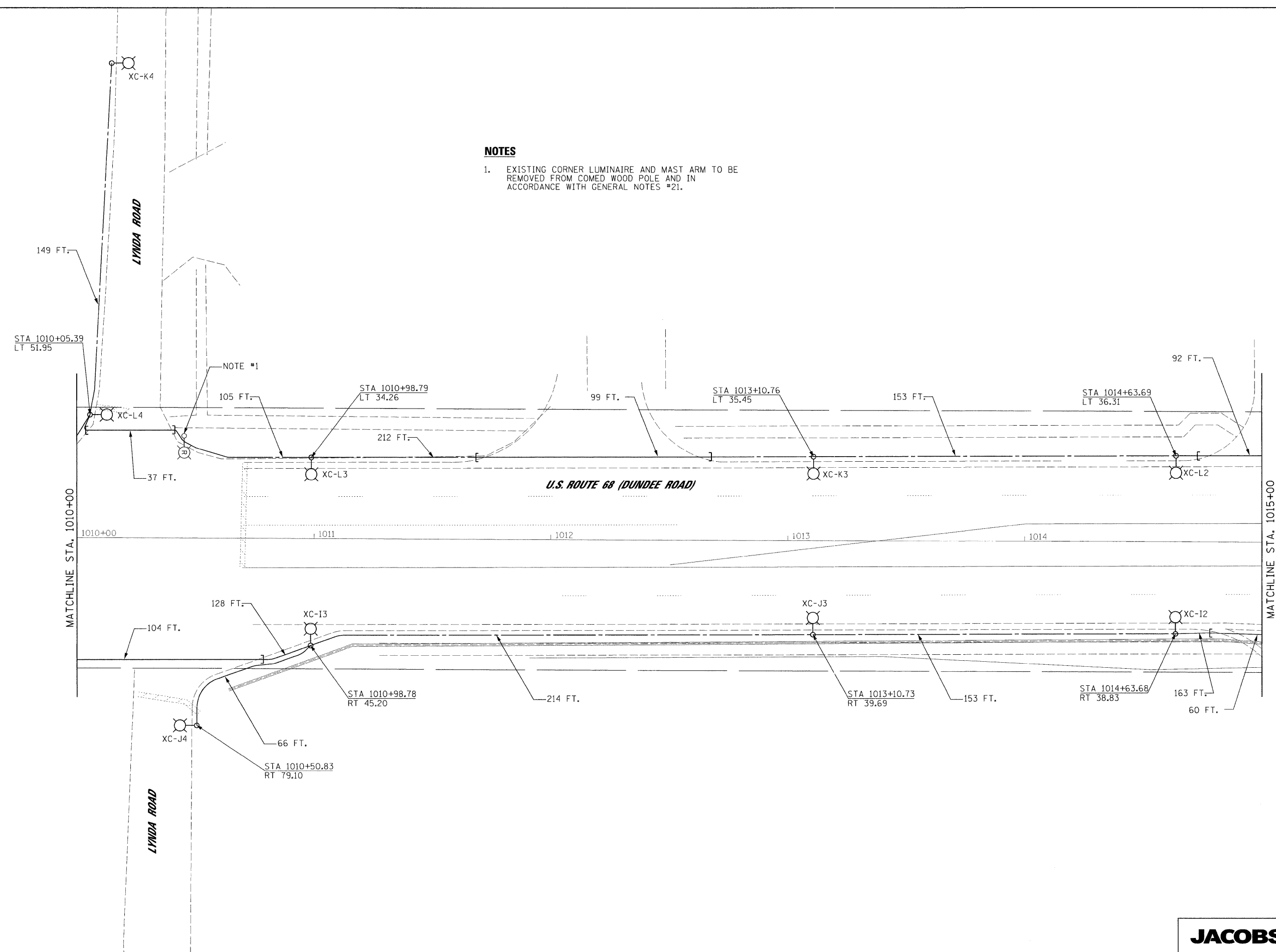

p:\2009\ak\3700\Acad\Sheets\Lighting Plan_16_Dundee 2.dgn

FILE NAME =
Lighting Plan_16_Dundee 2.dgn

USER NAME = #USER#
PLOT SCALE = #SCALE#
PLOT DATE = 3/4/2009

DESIGNED - HS
DRAWN - MJO
CHECKED - CDS
DATE - 1/22/2009

REVISED -
REVISED -
REVISED -
REVISED -

**STATE OF ILLINOIS
DEPARTMENT OF TRANSPORTATION**

PROPOSED LIGHTING PLAN
SCALE: 1"=20' SHEET NO. OF SHEETS STA. 1010+00 TO STA. 1015+00

JACOBS		ONE NORTH FRANKLIN CHICAGO IL, 60606 312-251-3000	
F.A.P. RTE. 334	SECTION 2008-08-31	COUNTY COOK	TOTAL SHEETS 81
		SHEET NO. 60	
		CONTRACT NO. 60F87	
FED. ROAD DIST. NO. ILLINOIS FED. AID PROJECT			