

STATE OF ILLINOIS
DEPARTMENT OF TRANSPORTATION

GENERAL NOTES

All structural steel shall conform to AASHTO Classification M-270 Gr. 50, unless otherwise noted.

Fasteners shall be high strength bolts. Flange splice holes shall be $\frac{15}{16}$ " ϕ for $\frac{7}{8}$ " ϕ bolts. Web splice holes shall be $\frac{13}{16}$ " ϕ for $\frac{3}{4}$ " ϕ bolts.

The Contractor shall provide support and/or shoring systems for the slab and beam in the area of existing beam removal. See Special Provisions "Temporary Slab Support System."

After the new beam is in its final position and/or beam straightening operations have been completed, the Engineer in the field shall check to see that the top flange is tight against the slab. If not, the Contractor shall inject epoxy between the existing concrete deck and the top flange of the beam. See Special Provision "Epoxy Injection".

The Contractor shall grind all cracked welds parallel to the direction of the existing weld and not perpendicular to the weld.

Plan dimensions and details relative to existing plans are subject to routine variations. The Contractor shall field verify existing dimensions and details affecting new construction and make necessary approved adjustments prior to construction or ordering of materials. Such variations shall not be cause for additional compensation for a change in scope of the work, however, the Contractor will be paid for the quantity actually furnished based upon the unit price bid for the work.

Cost of removal and re-installation of all members necessary to complete the work as detailed on the plans and as specified in the Special Provisions shall be included with Structural Steel Repair.

The Inorganic Zinc Rich Primer / Acrylic / Acrylic Paint System shall be used for shop and field painting of new structural steel except where otherwise noted. The color of the final finish coat shall be Interstate Green, Munsell No. 7.5G 4/B. See Special Provision "Cleaning and Painting New Metal Structures".

The existing structural steel coating contains lead. The Contractor shall take appropriate precautions to deal with the presence of lead on this project.

Existing structural steel that will be in contact with new structural steel shall be cleaned and painted prior to erection as required by the Special Provision "Cleaning and Painting Contact Surface Areas of Existing Steel Structures".

Diaphragm connection holes shall be $\frac{15}{16}$ " ϕ for $\frac{3}{4}$ " ϕ bolts. Two hardened washers shall be required at diaphragm connections.

The Contractor is responsible for the method of supporting the portion of existing girder to be removed prior to, during cutting and removal operations, and shall ensure that cuts made are smooth and straight.

Load carrying components designated "NTR" shall conform to the Supplemental Requirements for Notch Toughness, Zone 2.

All cut edges to be round smooth and be free of any nicks, gauges or irregularities.

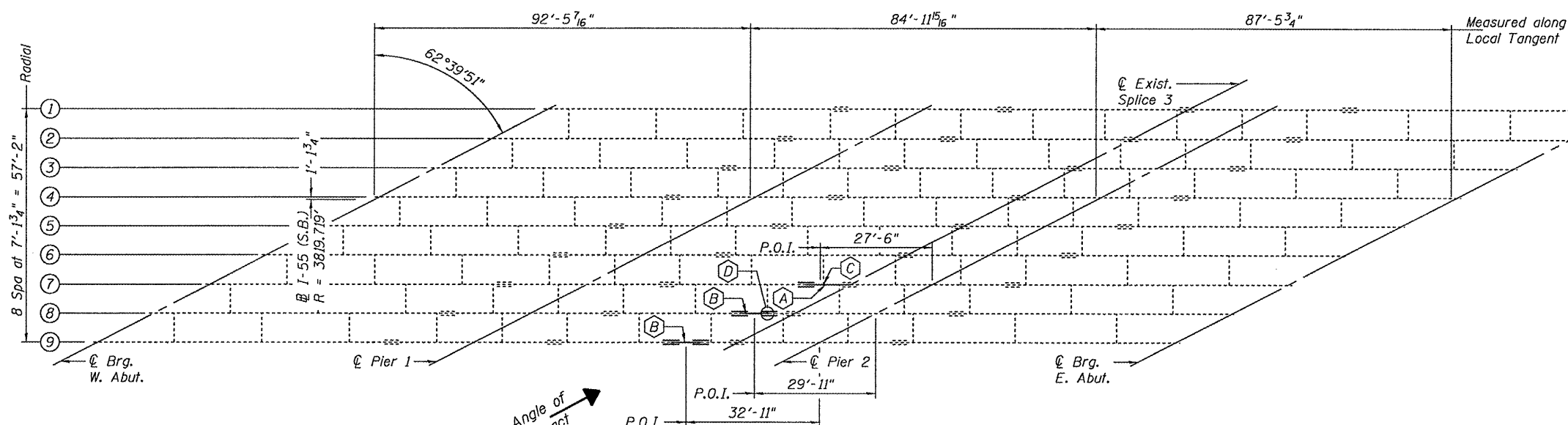
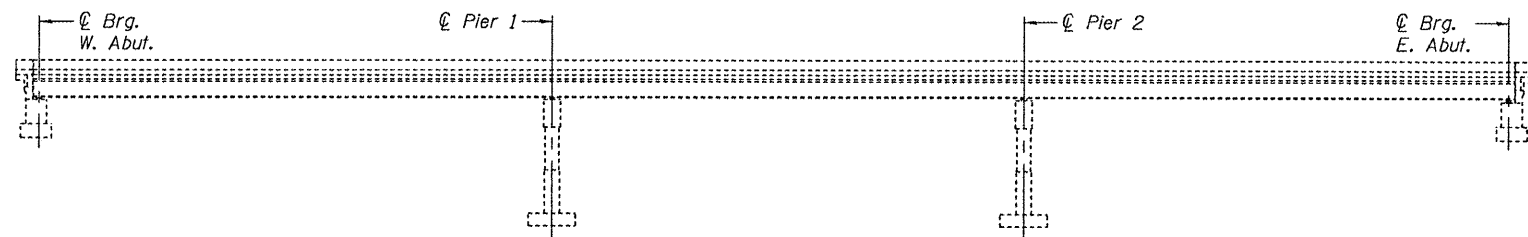

- (A) Remove and Replace section of beam
- (B) Remove and Replace section of beam
- (C) Add shim $\frac{1}{8}$ " at bottom clip L.
- (D) Remove and Replace Top and Bottom clip L's. Shim $\frac{1}{8}$ " at bottom clip L.

TOTAL BILL OF MATERIAL

ITEM	UNIT	QUANTITY
Structural Steel Repair	Pound	5,770
Temporary Slab Support System	L.S.	1

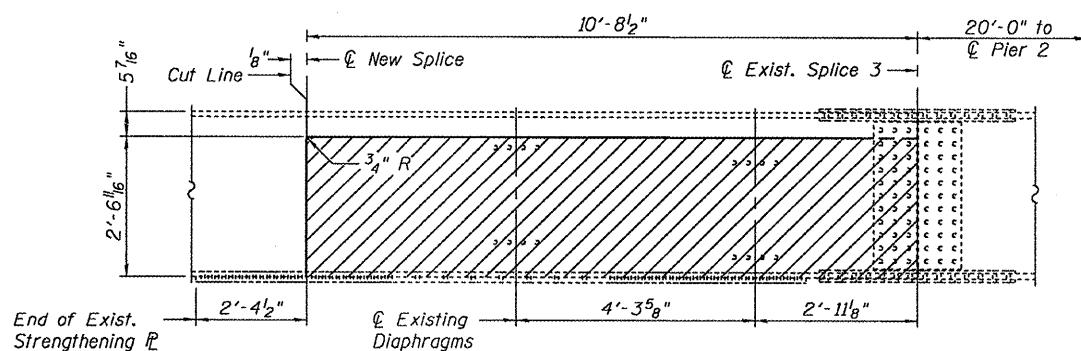

All cut edges are to be ground smooth and be free of any nicks, gauges or irregularities.

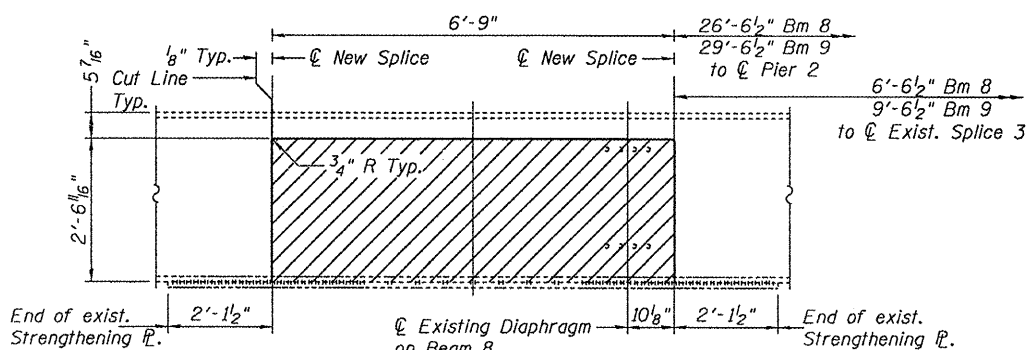

PLAN AND ELEVATION

DESIGNED Victor H. Ve C. J.
CHECKED Adrian T. Hallaway
DRAWN [Signature]
CHECKED V H V A T H

March 9, 2009
EXAMINED [Signature]
PASSED [Signature]
ENGINEER OF BRIDGES AND STRUCTURES

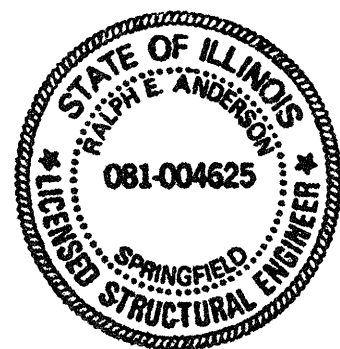

Expires: November 30, 2010

SHEET NO.	F.A. RTE.	SECTION	COUNTY	TOTAL SHEETS	SHEET NO.
1	55	0101-601 HB-I	Cook	13	5
3 SHEETS		SN 016-0001	CONTRACT NO. 60G06		
		FED. ROAD DIST. NO.	ILLINOIS	FED. AID PROJECT	