

TRAFFIC SIGNAL LEGEND

		PROPOSED	EXISTING		PROPOSED	EXISTING
CONTROLLER		[Symbol]	[Symbol]	VEHICLE DETECTOR, NON COMPENSATED MAGNETIC TYPE	[Symbol]	[Symbol]
RAILROAD CONTROL CABINET		[Symbol]	[Symbol]	RAILROAD CONTROL CABINET	[Symbol]	[Symbol]
SERVICE INSTALLATION, (P) POLE OR (G) GROUND MOUNTED		[Symbol]	[Symbol]	ILLUMINATED SIGN, FIBER OPTIC "NO LEFT TURN"	[Symbol]	[Symbol]
SIGNAL HEAD		[Symbol]	[Symbol]	ILLUMINATED SIGN, FIBER OPTIC "NO RIGHT TURN"	[Symbol]	[Symbol]
SIGNAL HEAD WITH BACKPLATE		[Symbol]	[Symbol]	TELEPHONE CONNECTION	[Symbol]	[Symbol]
SIGNAL HEAD, PEDESTRIAN		[Symbol]	[Symbol]	PEDESTRIAN PUSHBUTTON DETECTOR	[Symbol]	[Symbol]
SIGNAL POST		[Symbol]	[Symbol]	DETECTOR LOOP, TYPE I	[Symbol]	[Symbol]
MAST ARM ASSEMBLY AND POLE, STEEL		[Symbol]	[Symbol]	PREFORMED DETECTOR LOOP	[Symbol]	[Symbol]
MAST ARM ASSEMBLY AND POLE, ALUMINIUM		[Symbol]	[Symbol]	VIDEO DETECTOR	[Symbol]	[Symbol]
COMMON TRENCH		[Symbol]	[Symbol]	CLOSED CIRCUIT TV	[Symbol]	[Symbol]
UNIT DUCT		[Symbol]	[Symbol]	EMERGENCY VEHICLE SYSTEM DETECTOR	[Symbol]	[Symbol]
HANDHOLE		[Symbol]	[Symbol]	CONFIRMATION BEACON	[Symbol]	[Symbol]
HEAVY DUTY HANDHOLE		[Symbol]	[Symbol]	UNINTERRUPTABLE POWER SUPPLY	[Symbol]	[Symbol]
DOUBLE HANDHOLE		[Symbol]	[Symbol]	PEDESTRIAN SIGNAL HEAD WITH COUNTDOWN TIMER	[Symbol]	[Symbol]
G.S.CONDUIT IN TRENCH OR PUSHED		[Symbol]	[Symbol]			
CAST IRON JUNCTION BOX		[Symbol]	[Symbol]			
SIGNAL HEAD OPTICALLY PROGRAMMED		[Symbol]	[Symbol]			
CONDUIT SPLICE		[Symbol]	[Symbol]			
WOOD POLE		[Symbol]	[Symbol]			
RACEWAY FOR MAGNETIC DETECTOR, TYPE I OR TYPE II		[Symbol]	[Symbol]			

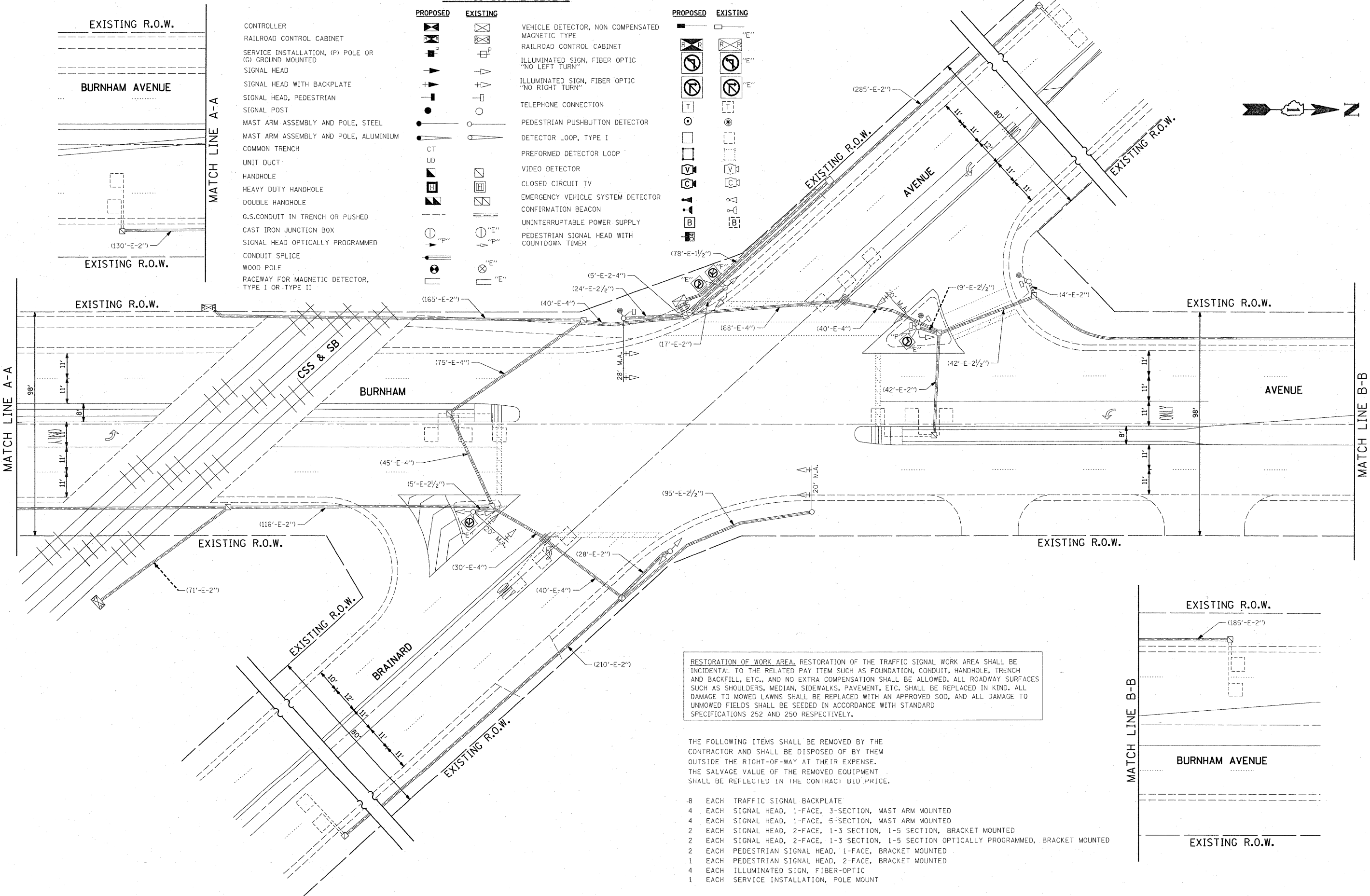

RESTORATION OF WORK AREA. RESTORATION OF THE TRAFFIC SIGNAL WORK AREA SHALL BE INCIDENTAL TO THE RELATED PAY ITEM SUCH AS FOUNDATION, CONDUIT, HANDHOLE, TRENCH AND BACKFILL, ETC., AND NO EXTRA COMPENSATION SHALL BE ALLOWED. ALL ROADWAY SURFACES SUCH AS SHOULDERS, MEDIAN, SIDEWALKS, PAVEMENT, ETC. SHALL BE REPLACED IN KIND. ALL DAMAGE TO MOWED LAWNS SHALL BE REPLACED WITH AN APPROVED SOD, AND ALL DAMAGE TO UNMOWED FIELDS SHALL BE SEEDED IN ACCORDANCE WITH STANDARD SPECIFICATIONS 252 AND 250 RESPECTIVELY.

THE FOLLOWING ITEMS SHALL BE REMOVED BY THE CONTRACTOR AND SHALL BE DISPOSED OF BY THEM OUTSIDE THE RIGHT-OF-WAY AT THEIR EXPENSE. THE SALVAGE VALUE OF THE REMOVED EQUIPMENT SHALL BE REFLECTED IN THE CONTRACT BID PRICE.

- 8 EACH TRAFFIC SIGNAL BACKPLATE
- 4 EACH SIGNAL HEAD, 1-FACE, 3-SECTION, MAST ARM MOUNTED
- 4 EACH SIGNAL HEAD, 1-FACE, 5-SECTION, MAST ARM MOUNTED
- 2 EACH SIGNAL HEAD, 2-FACE, 1-3 SECTION, 1-5 SECTION, BRACKET MOUNTED
- 2 EACH SIGNAL HEAD, 2-FACE, 1-3 SECTION, 1-5 SECTION OPTICALLY PROGRAMMED, BRACKET MOUNTED
- 2 EACH PEDESTRIAN SIGNAL HEAD, 1-FACE, BRACKET MOUNTED
- 1 EACH PEDESTRIAN SIGNAL HEAD, 2-FACE, BRACKET MOUNTED
- 4 EACH ILLUMINATED SIGN, FIBER-OPTIC
- 1 EACH SERVICE INSTALLATION, POLE MOUNT