

RESTORATION OF WORK AREA. RESTORATION OF THE TRAFFIC SIGNAL WORK AREA SHALL BE INCIDENTAL TO THE RELATED PAY ITEM SUCH AS FOUNDATION, CONDUIT, HANDHOLE, TRENCH AND BACKFILL, ETC., AND NO EXTRA COMPENSATION SHALL BE ALLOWED. ALL ROADWAY SURFACES SUCH AS SHOULDERS, MEDIAN, SIDEWALKS, PAVEMENT, ETC. SHALL BE REPLACED IN KIND. ALL DAMAGE TO MOWED LAWNS SHALL BE REPLACED WITH AN APPROVED SOD, AND ALL DAMAGE TO UNMOWED FIELDS SHALL BE SEEDING IN ACCORDANCE WITH STANDARD SPECIFICATIONS 252 AND 250 RESPECTIVELY.

**TRAFFIC SIGNAL LEGEND**

- |  |  |          |  |  |  |          |  |
|--|--|----------|--|--|--|----------|--|
| CONTROLLER   |  | EXISTING |  | RACEWAY FOR MAGNETIC DETECTOR, TYPE I OR TYPE II |  | EXISTING |  |
| RAILROAD CONTROL CABINET                             |  | EXISTING |  | VEHICLE DETECTOR, NON COMPENSATED MAGNETIC TYPE  |  | EXISTING |  |
| SERVICE INSTALLATION, (P) POLE OR (G) GROUND MOUNTED |  | EXISTING |  | RAILROAD CONTROL CABINET                         |  | EXISTING |  |
| SIGNAL HEAD  |  | EXISTING |  | ILLUMINATED SIGN, FIBER OPTIC "NO LEFT TURN"     |  | EXISTING |  |
| SIGNAL HEAD WITH BACKPLATE                           |  | EXISTING |  | ILLUMINATED SIGN, FIBER OPTIC "NO RIGHT TURN"    |  | EXISTING |  |
| SIGNAL HEAD, PEDESTRIAN                              |  | EXISTING |  | TELEPHONE CONNECTION                             |  | EXISTING |  |
| SIGNAL POST  |  | EXISTING |  | PEDESTRIAN PUSHBUTTON DETECTOR                   |  | EXISTING |  |
| MAST ARM ASSEMBLY AND POLE, STEEL                    |  | EXISTING |  | DETECTOR LOOP, TYPE I                            |  | EXISTING |  |
| MAST ARM ASSEMBLY AND POLE, ALUMINIUM                |  | EXISTING |  | PREFORMED DETECTOR LOOP                          |  | EXISTING |  |
| COMMON TRENCH  |  | EXISTING |  | VIDEO DETECTOR                                   |  | EXISTING |  |
| UNIT DUCT  |  | EXISTING |  | CLOSED CIRCUIT TV                                |  | EXISTING |  |
| HANDHOLE   |  | EXISTING |  | EMERGENCY VEHICLE SYSTEM DETECTOR                |  | EXISTING |  |
| HEAVY DUTY HANDHOLE                                  |  | EXISTING |  | CONFIRMATION BEACON                              |  | EXISTING |  |
| DOUBLE HANDHOLE                                      |  | EXISTING |  | UNINTERRUPTIBLE POWER SUPPLY                     |  | EXISTING |  |
| G.S.CONDUIT IN TRENCH OR PUSHED                      |  | EXISTING |  | PEDESTRIAN SIGNAL HEAD WITH COUNTDOWN TIMER      |  | EXISTING |  |
| CAST IRON JUNCTION BOX                               |  | EXISTING |  |  |  |          |  |
| SIGNAL HEAD OPTICALLY PROGRAMMED                     |  | EXISTING |  |  |  |          |  |
| CONDUIT SPLICE                                       |  | EXISTING |  |  |  |          |  |
| WOOD POLE  |  | EXISTING |  |  |  |          |  |

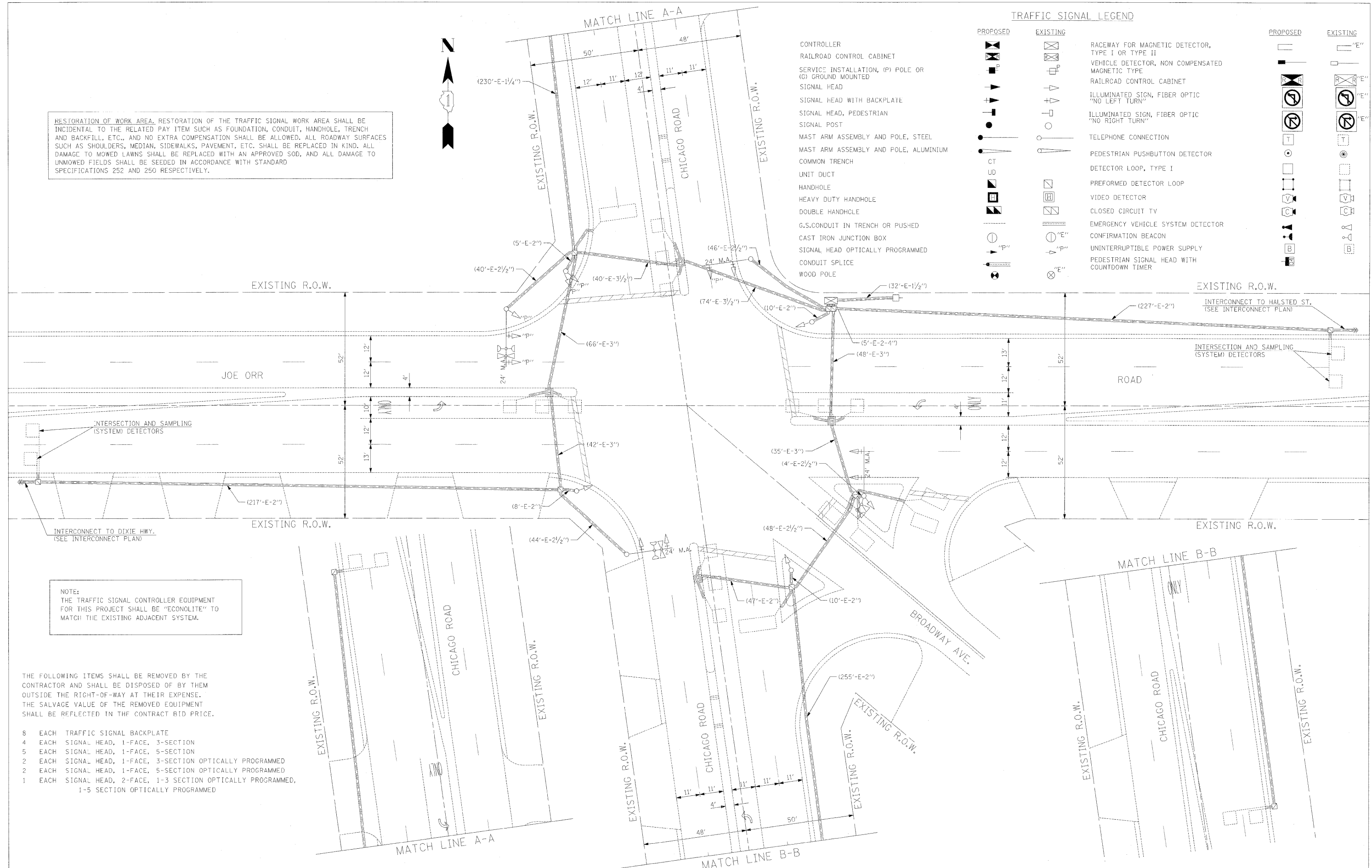

NOTE:  
THE TRAFFIC SIGNAL CONTROLLER EQUIPMENT FOR THIS PROJECT SHALL BE "ECONOLITE" TO MATCH THE EXISTING ADJACENT SYSTEM.

THE FOLLOWING ITEMS SHALL BE REMOVED BY THE CONTRACTOR AND SHALL BE DISPOSED OF BY THEM OUTSIDE THE RIGHT-OF-WAY AT THEIR EXPENSE. THE SALVAGE VALUE OF THE REMOVED EQUIPMENT SHALL BE REFLECTED IN THE CONTRACT BID PRICE.

- 8 EACH TRAFFIC SIGNAL BACKPLATE
- 4 EACH SIGNAL HEAD, 1-FACE, 3-SECTION
- 5 EACH SIGNAL HEAD, 1-FACE, 5-SECTION
- 2 EACH SIGNAL HEAD, 1-FACE, 3-SECTION OPTICALLY PROGRAMMED
- 2 EACH SIGNAL HEAD, 1-FACE, 5-SECTION OPTICALLY PROGRAMMED
- 1 EACH SIGNAL HEAD, 2-FACE, 1-3 SECTION OPTICALLY PROGRAMMED, 1-5 SECTION OPTICALLY PROGRAMMED