

PAY LIMITS OF CONCRETE BARRIER TRANSITION = 525'

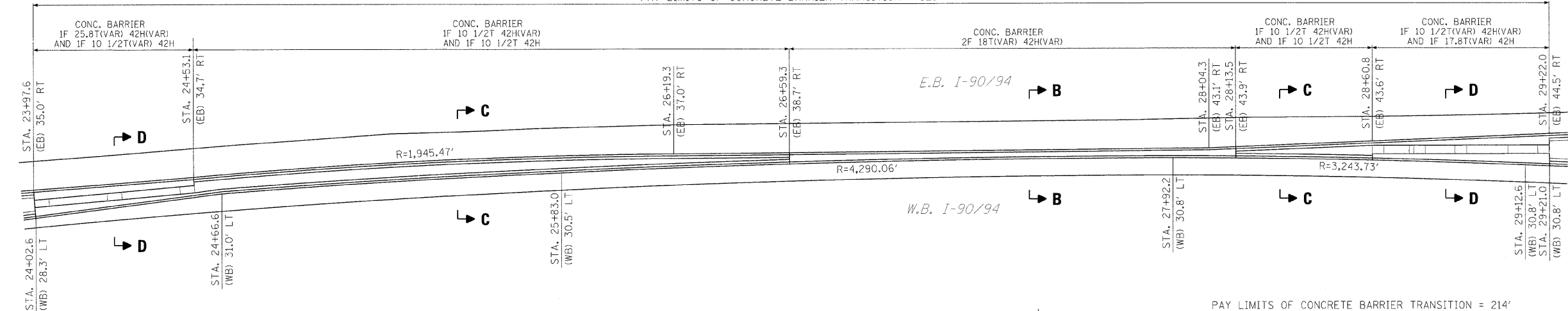

PAY LIMITS OF CONCRETE BARRIER TRANSITION = 193'

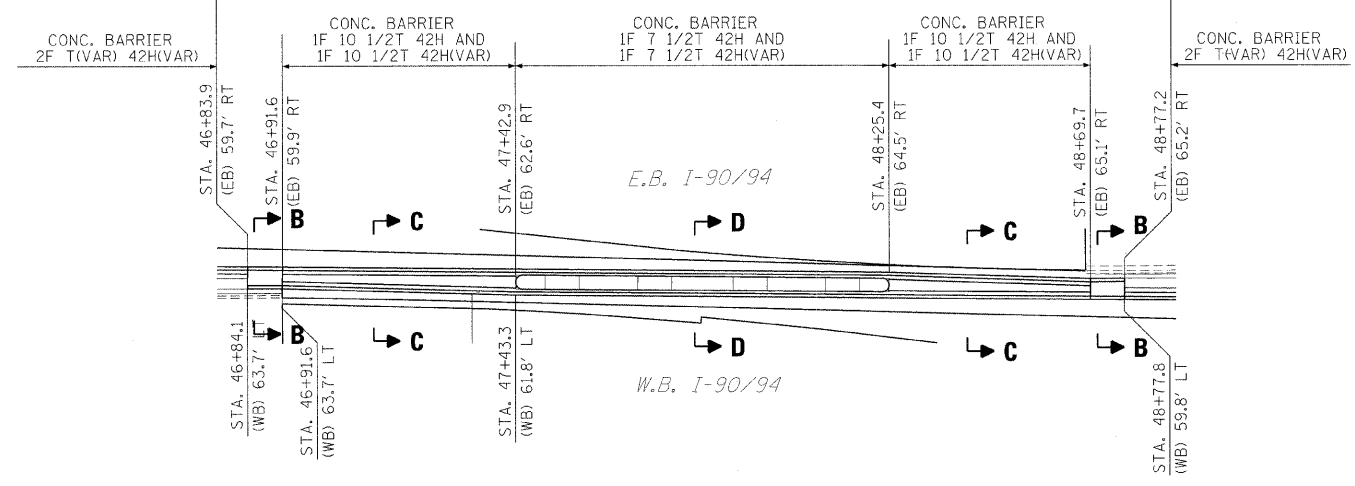

PAY LIMITS OF CONCRETE BARRIER TRANSITION = 214'

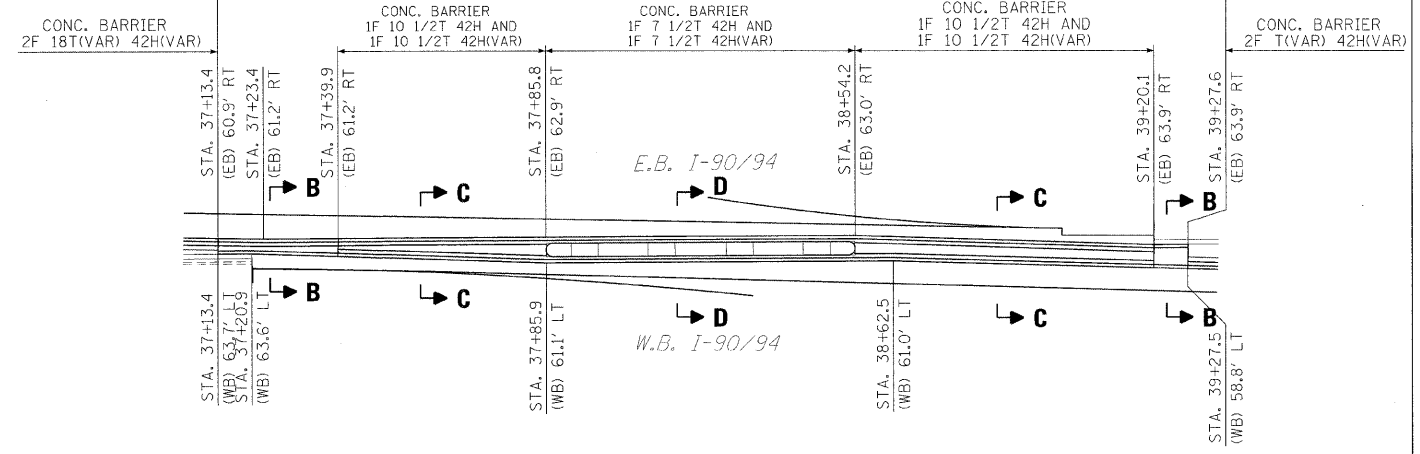

PAY LIMITS OF CONCRETE BARRIER TRANSITION = 153'

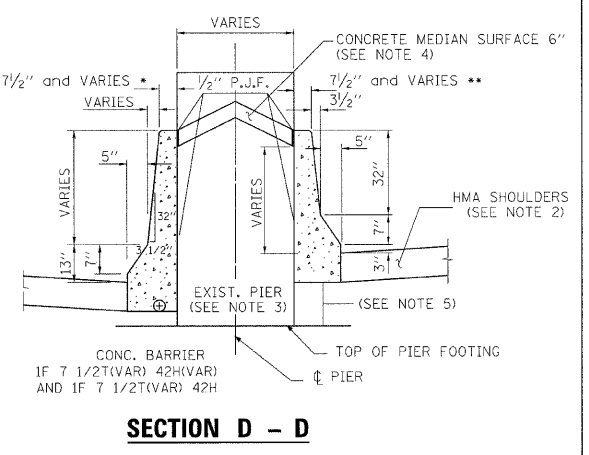
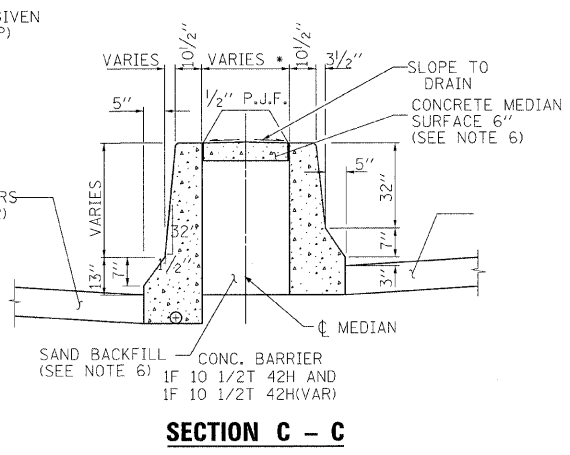
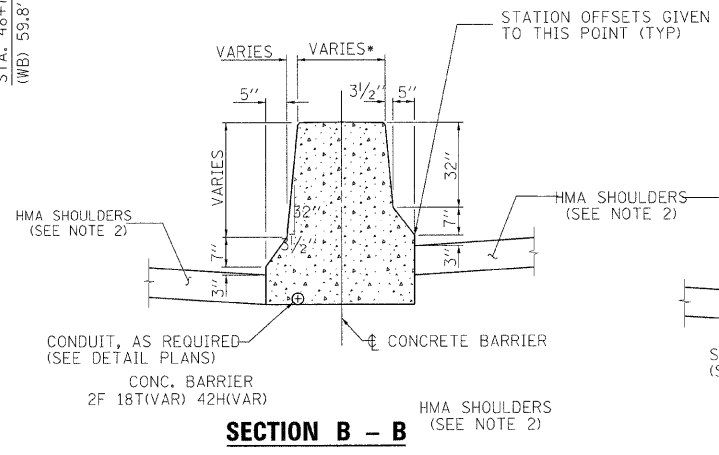
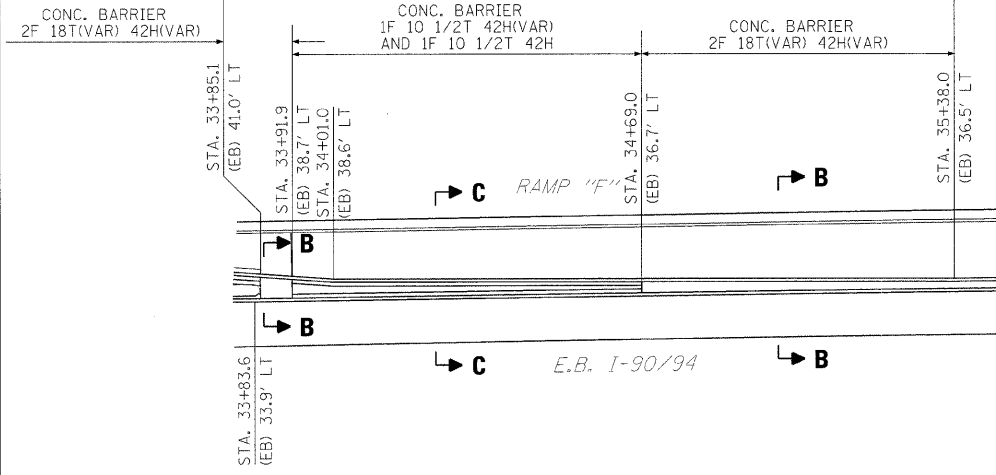

- NOTES:
- FOR ADDITIONAL CONCRETE BARRIER DETAILS SEE CONCRETE BARRIER TYPICAL SECTIONS SHEET AND STANDARDS 637001 AND 637006.
 - FOR ADDITIONAL SHOULDER DETAILS SEE PIPE UNDERDRAIN & SHOULDER DETAILS SHEET AND STANDARDS 601001, 482006, 483001 & 482001.
 - IF THE PIER IS NEW CONSTRUCTION, THE CONCRETE BARRIER MAY BE POURED MONOLITHICALLY.
 - PIER FILLER MATERIAL SHALL BE CONCRETE IF A MINIMUM 6" THICKNESS CAN BE MAINTAINED. IF THE 6" THICKNESS CANNOT BE MAINTAINED, USE ASPHALT FILLER MATERIAL AS DIRECTED BY THE ENGINEER.
 - EXTEND THE BOTTOM OF THE CONCRETE BARRIER TO THE PIER FOOTING WHEN THE DEPTH IS LESS THAN 6".

- SAND BACKFILL AND CONCRETE MEDIAN SURFACE 6" WILL BE REQUIRED. FILLING WITH CONCRETE WILL NOT BE ALLOWED. THIS WORK SHALL BE PAID FOR SEPARATELY.
- TAPERS INTO AND AWAY FROM SIGN FOUNDATIONS SHALL BE THE SAME AS SHOWN ABOVE.
- INSTALL DUCT BETWEEN THE SIGN FOUNDATION AND THE NEAREST LIGHT POLE FOUNDATION WHERE SHOWN ON THE PLANS THIS WORK SHALL BE PAID FOR SEPARATELY.
- PREFORMED JOINT FILLER OF THE SIZE SPECIFIED SHALL BE INCIDENTAL TO THE CONCRETE BARRIER OF THE TYPE INVOLVED.
- THE REMOVAL OF THE EXISTING CONCRETE END BLOCKS IF APPLICABLE SHALL BE INCLUDED IN THE COST OF THE CONCRETE BARRIER OF THE TYPE INVOLVED.

REVISIONS		ILLINOIS DEPARTMENT OF TRANSPORTATION
NAME	DATE	
		CONCRETE BARRIER DETAILS I-90/94 KENNEDY EXPRESSWAY SCALE : NTS DRAWN BY : BEC DATE : 02/06/09 CHECKED BY : GB