

F.A.I. RTE.	SECTION	COUNTY	TOTAL SHEETS	SHEET NO.
90/94	02026-2P, ETC. 1415 & 1517R-7	COOK	246	56
STA. 50+00		TO STA. 65+00		
FED. ROAD DIST. NO.		ILLINOIS FED. AID PROJECT		
CONTRACT NO. 62408				

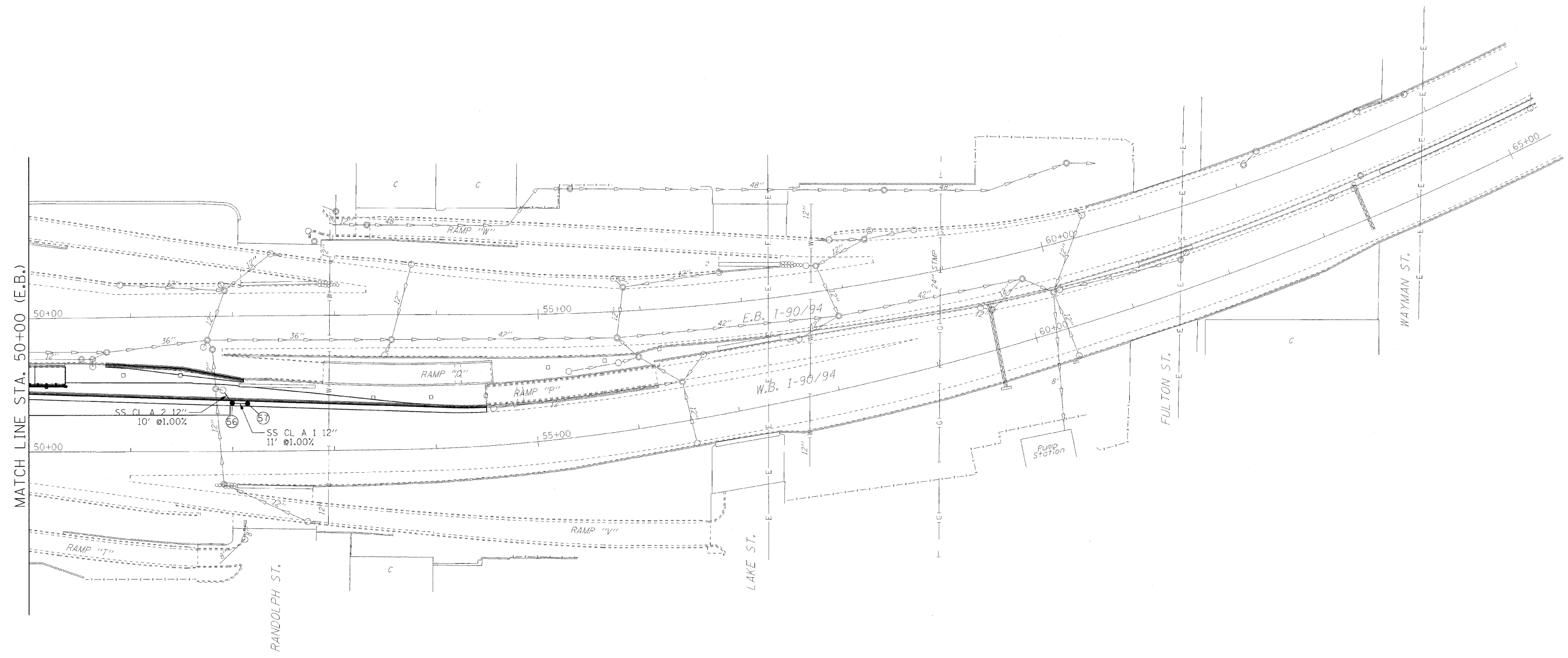

PLAN	DATE
BY	
NO. OF SHEETS	
NO. OF THIS SHEET	
DATE	
BY	
NO.	

PROFILE	DATE
BY	
NO. OF SHEETS	
NO. OF THIS SHEET	
DATE	
BY	
NO.	



- 56 CB-TA 4' DIA
T24 F&G
52+00.00, 49.90' LT
(WB I-90/94)
RIM 578.30±
N IN 575.10
SW OUT 575.00
- 57 CB-TA 4' DIA
T24 F&G
52+15.00, 49.30' LT
(WB I-90/94)
RIM 578.20±
INV 575.21

ILLINOIS DEPARTMENT OF TRANSPORTATION
PROPOSED DRAINAGE & UTILITIES
 I-90/94 KENNEDY EXPRESSWAY
 STA. 50+00 TO STA. 65+00
 SCALE : 1" = 50'
 DATE : 02/06/09
 DRAWN BY : BEC
 CHECKED BY : GB

