

F.A.I. RTE.	SECTION	COUNTY	TOTAL SHEETS	SHEET NO.
90/94	02026-25, ETC, 1419 & 1517R-7	COOK	246	51
STA. 35+00		TO STA. 50+00		
FED. ROAD DIST. NO.		ILLINOIS FED. AID PROJECT		
CONTRACT NO. 62408				

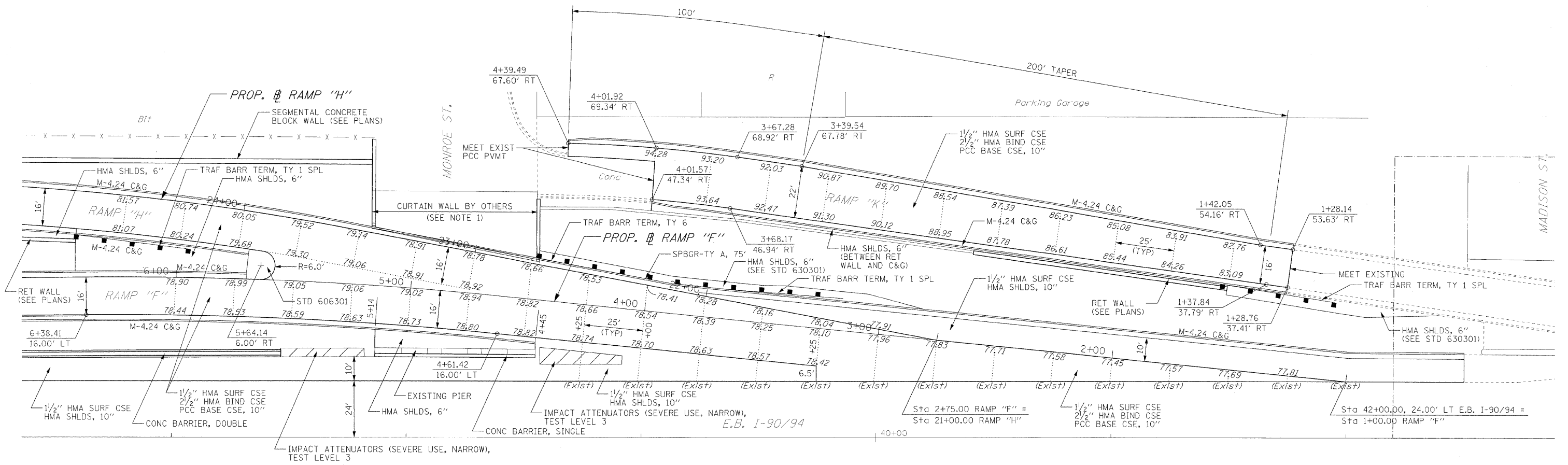

- NOTE:
- MONROE ST CURTAIN WALL HAS BEEN RECONSTRUCTED WITH MONROE ST BRIDGE REPAIRS. FEILD VERIFY EXISTING CURTAIN WALL LOCATION AND LAYOUT FOR PROPOSED IMPROVEMENTS.
 - ALL STATIONS AND OFFSETS FOR RAMP 'K' ARE GIVEN OFF OF THE BASELINE OF RAMP 'F'.
 - ALL EXISTING ELEVATIONS SHALL BE FIELD VERIFIED FROM PREVIOUS RESURFACING CONTRACT.

ILLINOIS DEPARTMENT OF TRANSPORTATION

INTERSECTION DETAIL

RAMP "F" & RAMP "H"

STA. TO STA.

SCALE : 1" = 20'
DATE : 02/06/09

DRAWN BY : BEC
CHECKED BY : GB

DATE	BY

DATE	BY

