

BENCH MARK
BM 900 - N.E. ANCHOR BOLT OF
HIGH MAST LIGHT
STA. 37+37.00 ~ 97+00' LT. ELEV. 587.84

EXISTING STRUCTURE NO. 016-W809
I-90/94 RAMP K - MONROE ST. EXIT RAMP
EASTBOUND, BUILT IN 1957 CONSISTS OF
CAST-IN-PLACE CONCRETE RETAINING
WALL SUPPORTED ON CONCRETE
PILING

PROPOSED IMPROVEMENTS
EXISTING STRUCTURE TO BE EXTENDED
108'-9" WITH A CAST-IN-PLACE T-TYPE CONCRETE
RETAINING WALL SUPPORTED ON 14"
DIAMETER METAL SHELL PILES.

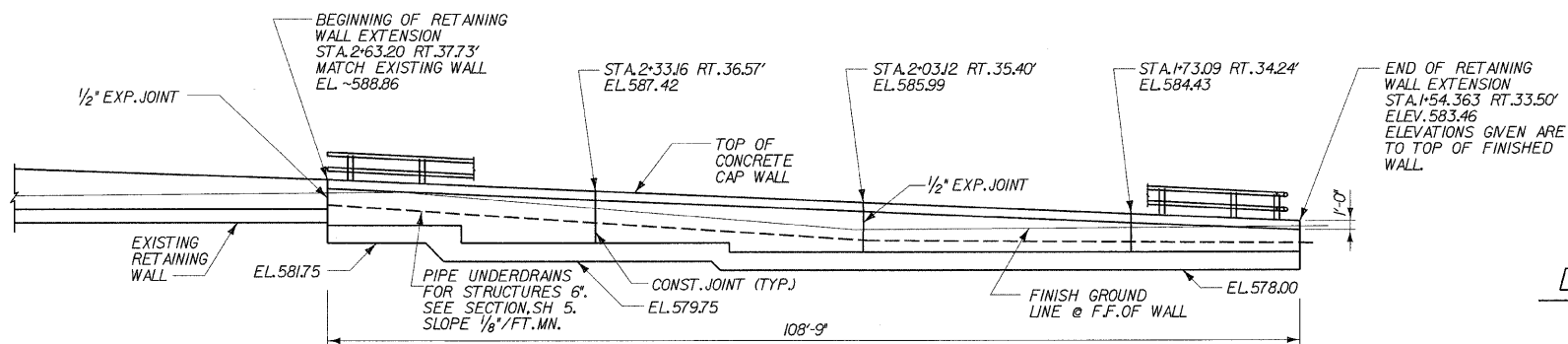

NOTE: STATIONS & OFFSETS FROM BASELINE OF RAMP F F.F. = FRONT FACE

ELEVATION

NOTE: STATIONS & OFFSETS FROM BASELINE OF RAMP F

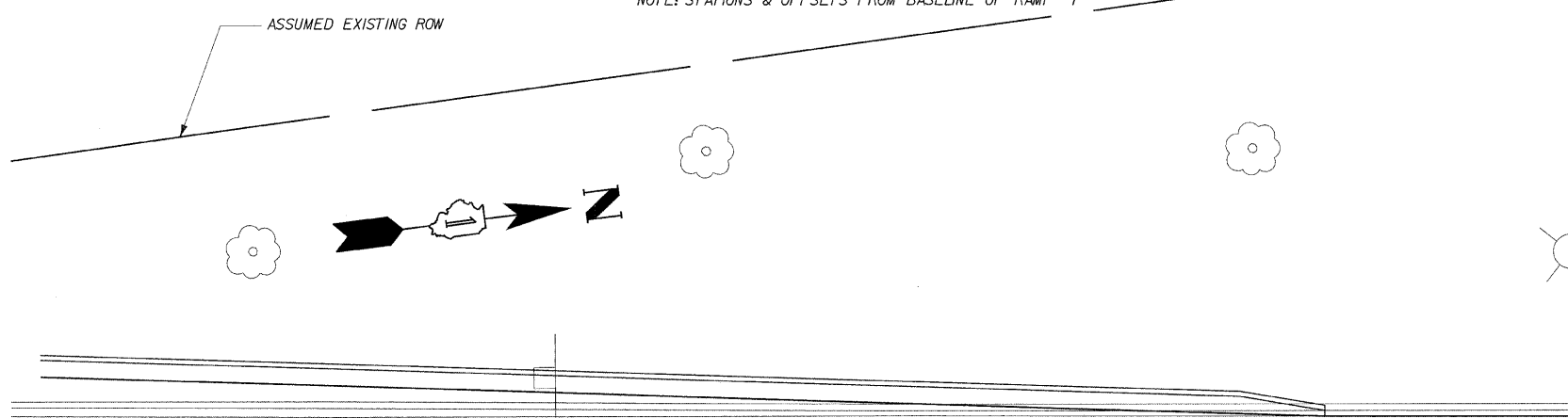

PLAN

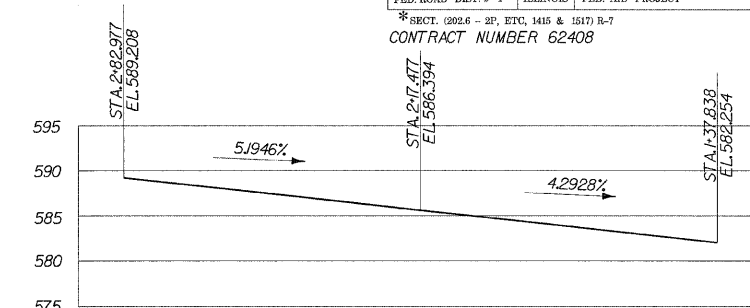

PROFILE OF RAMP K

DESIGN SPECIFICATIONS

2002 AASHTO SPECIFICATIONS
FOR HIGHWAY BRIDGES

DESIGN STRESSES

LOADINGS:
EQUIVALENT FLUID SOIL PRESSURE = 40 PCF
TRAFFIC SURCHARGE PRESSURE 240 PCF
F_c = 3,500 PSI (CONCRETE)
F_y = 60,000 PSI (REINFORCEMENT)

GENERAL NOTES

1. REINFORCEMENT BARS SHALL CONFORM TO THE REQUIREMENTS OF ASTM A 706 GR60. SEE SPECIAL PROVISIONS.
2. REINFORCEMENT BARS DESIGNATED (E) SHALL BE EPOXY COATED.
3. PLAN DIMENSIONS AND DETAILS RELATIVE TO EXISTING STRUCTURES HAVE BEEN TAKEN FROM FIELD MEASUREMENTS AND ARE SUBJECT TO NOMINAL CONSTRUCTION VARIATIONS. IT SHALL BE THE CONTRACTOR'S RESPONSIBILITY TO VERIFY SUCH DIMENSIONS AND DETAILS IN THE FIELD AND MAKE NECESSARY APPROVED ADJUSTMENTS PRIOR TO CONSTRUCTION OR ORDERING OF MATERIALS. SUCH VARIATIONS SHALL NOT BE CAUSE FOR ADDITIONAL COMPENSATION OR A CHANGE IN THE SCOPE OF THE WORK, HOWEVER, THE CONTRACTOR WILL BE PAID FOR THE QUANTITY ACTUALLY FURNISHED AT THE UNIT PRICE FOR THE WORK.
4. THE CONTRACTOR SHALL DRIVE TWO METAL SHELL PILES 14" DIAMETER TEST PILES IN A PERMANENT LOCATION NEAR BORINGS K-1 AND K-2 AS INDICATED ON THE PLANS AND AS DIRECTED BY THE ENGINEER BEFORE ORDERING THE REMAINDER OF PILES.
5. ALL CONSTRUCTION JOINTS SHALL BE BONDED.

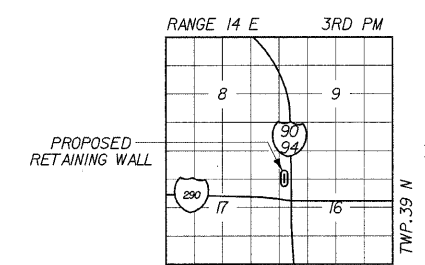

LOCATION SKETCH

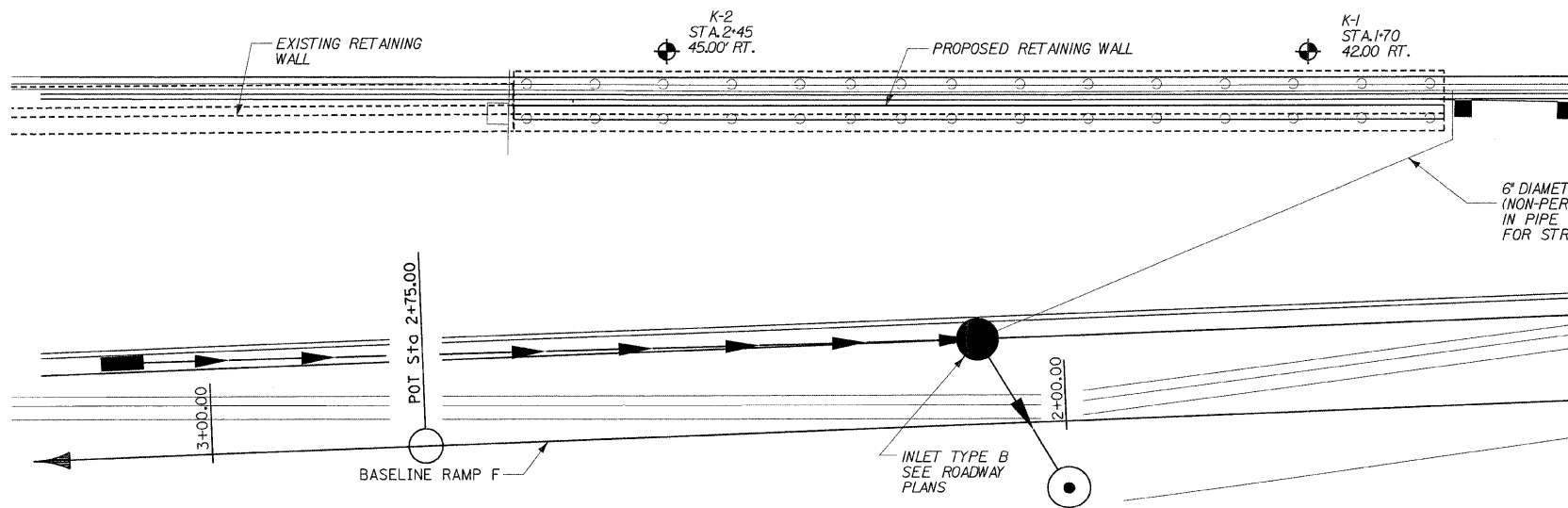

APPROVED
FOR STRUCTURAL ADEQUACY ONLY

Ralph E. Anderson
ENGINEER OF BRIDGES AND STRUCTURES

TOTAL BILL OF MATERIAL		
ITEM	UNIT	QUANTITY
CONCRETE STRUCTURES	CU YD	82.4
REINFORCEMENT BARS	POUND	4,940
REINFORCEMENT BARS, EPOXY COATED	POUND	1,130
STRUCTURE EXCAVATION	CU YD	295
FURNISHING METAL SHELL PILES 14" x 0.250'	FOOT	2,055
DRIVING PILES	FOOT	2,055
TEST PILE METAL SHELLS	EACH	1
GEOCOMPOSITE WALL DRAIN	SQ YD	65
PIPE UNDERDRAINS FOR STRUCTURES 6"	FOOT	109
INSTALL DECORATIVE STEEL GUARDRAIL	FOOT	108
INSTALL DECORATIVE STEEL FASCIA	FOOT	87
EMBEDDED PLATE, GUARDRAIL UPRIGHT, EXPANSION JOINT	EACH	2
EMBEDDED PLATE, GUARDRAIL UPRIGHT	EACH	15
REPAIR OF FASCIA PANELS, EXIT RAMP K	LS	1

DLZ ILLINOIS, LLC.
ARLINGTON HEIGHTS, ILLINOIS

Signed: *Ralph E. Anderson*
Date: 02-25-2009
Expiration Date: 11/30/10

DLZ 85 W. Algonquin Rd. Ste. 220
Arlington Heights IL 60005

REVISIONS	
NAME	DATE

**RETAINING WALL RAMP K
GENERAL PLAN AND ELEVATION**
 I-90/94 KENNEDY EXPRESSWAY
 (HUBBARDS CAVE TO I-290)
 SECT. (202.6 - 2P, ETC, 1415 & 1517) R-7
 STATION 1+54.36, 33.5' RT TO 2+63.20, 37.7' RT
 (RAMP F BASELINE)
 COOK COUNTY
 STRUCTURE NUMBER 016-W809

25-Feb-2009 11:12 s:\Dept\Structures\301099 190 194 RAMPK\UGNFILES\01-Layout\RampK2-16.dgn

DESIGNED	ECF
CHECKED	JMM
DRAWN	ECF & DPW
CHECKED	JMM