

ELEVATION
(SHOWING FRONT FACE REINFORCEMENT)

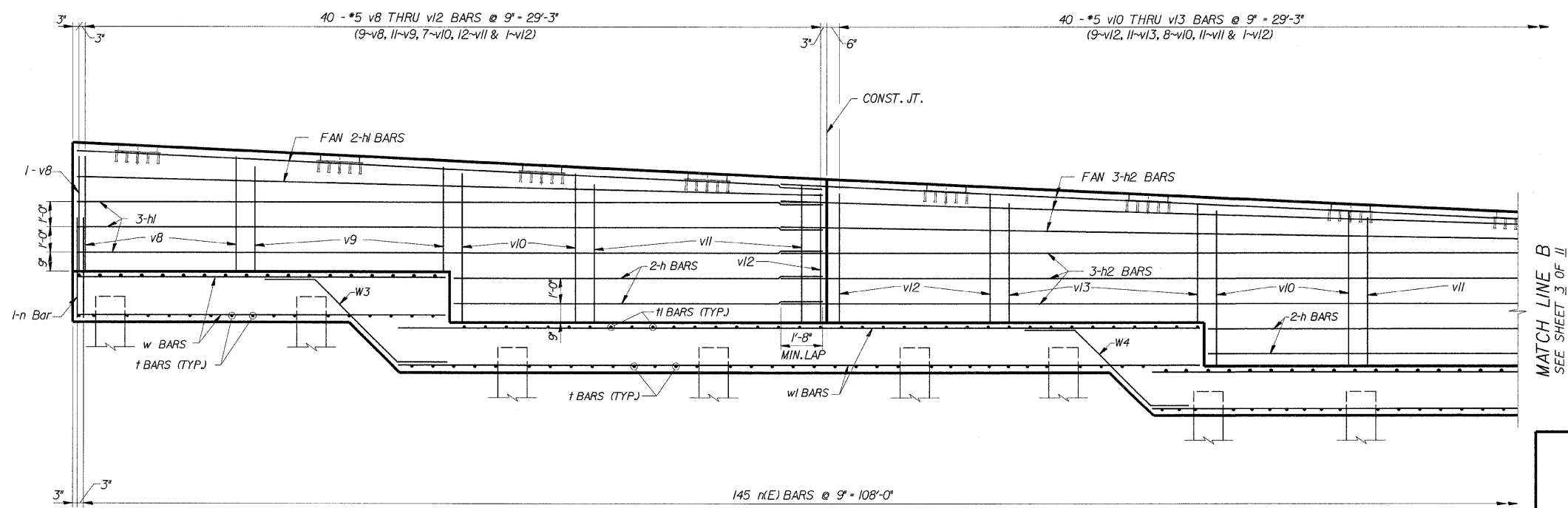

ELEVATION
(SHOWING BACK FACE REINFORCEMENT)

MINIMUM BAR LAPS
*4 BARS - 1'-8"

s:\Dept\Structures\301099 190 94-retwall\11_190_194\RAMPK\DCNFILBS\02-06-REPlan.dgn 04-Feb-2009 09:37

DESIGNED	CMF
CHECKED	LTX
DRAWN	DPW
CHECKED	JMM

REVISIONS	
NAME	DATE

DLZ 85 W. Algonquin Rd. Ste. 220
Arlington Heights IL 60005
DLZ Illinois, Inc.

RETAINING WALL RAMP K
ELEVATION (REINF)
I-90/94 KENNEDY EXPRESSWAY
(HUBBARDS CAVE TO I-290)
SECT.(202.6 - 2P, ETC, 1415 & 1517) R-7
STATION 1+54.36, 33.5' RT TO 2+63.20, 37.7' RT
(RAMP F BASELINE)
COOK COUNTY
STRUCTURE NUMBER 016-W809