

STATE OF ILLINOIS
DEPARTMENT OF TRANSPORTATION

ROUTE NO. F.A.P. 90/94	SECTION *	COUNTY COOK	TOTAL SHEETS 246	SHEET NO. 211	SHEET NO. 06 08 SHEETS
FED. ROAD DIST. NO. 1		ILLINOIS	FED. AID PROJECT		

*SECT. (202.6-2P, ETC, 1415 & 1517)R-7
Contract # 62408

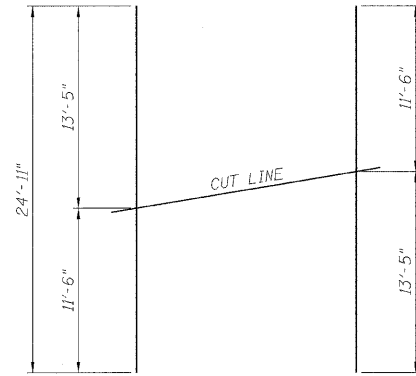

BAR v1(E)

24 BARS-1 SET
(USE REMAINDER OF BARS
IN OPPOSITE FACE)

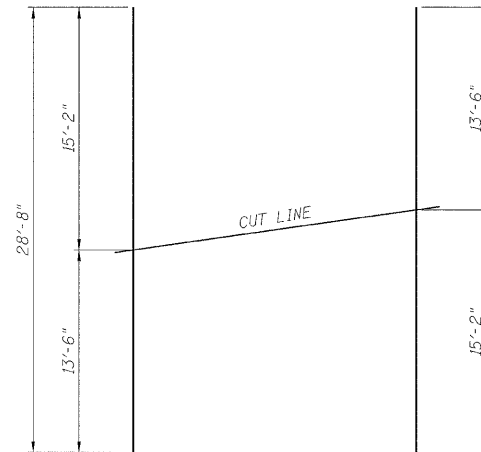

BAR v2(E)

22 BARS-1 SET
(USE REMAINDER OF BARS
IN OPPOSITE FACE)

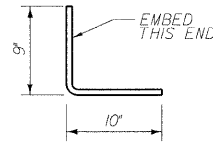

BAR d(E)

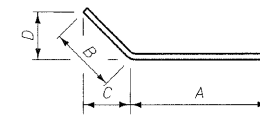

BARS d1(E), d8(E) OR d14(E)

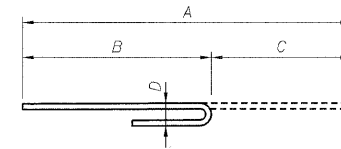

BARS d2(E) THRU d3(E)

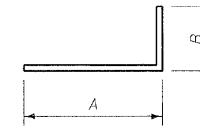

BARS d5(E) OR d6(E)

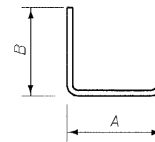

BARS d7(E) OR d13(E)

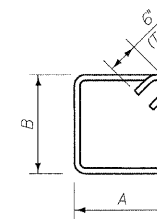

**BARS d9(E) THRU d12(E)
OR d15(E) THRU d17(E)**

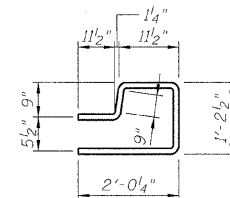

BAR d18(E)

BAR BENDING DIAGRAMS

Bar	A		B		C		D	
	Ft.	In.	Ft.	In.	Ft.	In.	Ft.	In.
d1(E)	2	10	1	6	1	0 3/4	1	0 3/4
d2(E)	3	2	2	3	0	11	0	8
d3(E)	1	8	1	1	0	7	0	5
d4(E)	INTENTIONALLY BLANK							
d5(E)	2	0	1	0				
d6(E)	3	9	1	0				
d7(E)	3	6	3	0				
d8(E)	4	10	3	0	2	1 1/2	2	1 1/2
d9(E)	2	6	3	6				
d10(E)	2	6	2	9				
d11(E)	2	6	2	0				
d12(E)	2	6	1	3				
d13(E)	2	1	4	3				
d14(E)	4	3	2	9	2	0	2	0
d15(E)	2	3	2	1 1/2				
d16(E)	2	3	1	10				
d17(E)	2	3	1	1				

BILL OF MATERIAL

Bar	No.	Size	Length	Shape
d1(E)	25	5	1'-7"	
d1(E)	14	7	4'-4"	
d2(E)	11	8	3'-2"	
d3(E)	11	5	1'-8"	
d4(E)	INTENTIONALLY BLANK			
d5(E)	120	5	3'-0"	
d6(E)	60	5	4'-9"	
d7(E)	6	9	9'-6"	
d8(E)	6	5	7'-10"	
d9(E)	5	5	13'-0"	
d10(E)	1	5	11'-6"	
d11(E)	1	5	10'-0"	
d12(E)	1	5	8'-6"	
d13(E)	5	9	10'-7"	
d14(E)	5	5	7'-0"	
d15(E)	6	5	9'-9"	
d16(E)	1	5	9'-2"	
d17(E)	1	5	7'-8"	
d18(E)	48	5	5'-11"	
h(E)	11	6	3'-11"	
h1(E)	30	6	26'-11"	
h2(E)	28	6	21'-5"	
h3(E)	4	6	22'-6"	
h4(E)	11	5	2'-2"	
h5(E)	12	5	24'-8"	
h6(E)	24	7	2'-0"	
v(E)	INTENTIONALLY BLANK			
v1(E)	24	5	24'-11"	
v2(E)	22	5	28'-8"	
v3(E)	2	5	13'-2"	
v4(E)	2	5	10'-1"	
v5(E)	6	5	9'-4"	
v6(E)	6	5	9'-11"	
v7(E)	6	5	10'-6"	
v8(E)	6	5	11'-4"	
v9(E)	6	5	11'-10"	
v10(E)	2	5	13'-1"	
v11(E)	2	5	15'-3"	
CONCRETE STRUCTURES		CU. YD.	37.8	
REINFORCEMENT BARS, EPOXY COATED		POUND	6,350	

RAMPS 'N' & 'O' BARBILL & DETAILS
I-90/94 KENNEDY EXPRESSWAY
(HUBBARDS CAVE TO I-290)
SECTION (202.6-2P, ETC, 1415 & 1517)R-7
COOK COUNTY
STRUCTURE NO. 016-W988

DESIGNED	ASP
CHECKED	LNB
DRAWN	BEM
CHECKED	ASP