

F.A.P. RTE.	SECTION	COUNTY	TOTAL SHEETS	SHEET NO.
337	20R-6	LAKE	149	1
FED. ROAD DIST. NO.		ILLINOIS	FED. AID PROJECT	
CONTRACT NO. 62519		★ 149+1=150		

FOR INDEX OF SHEETS, SEE SHEET NO. 2

STATE OF ILLINOIS
DEPARTMENT OF TRANSPORTATION
DIVISION OF HIGHWAYS

PROPOSED HIGHWAY PLANS

F.A.P. ROUTE 337 (ILLINOIS ROUTE 22)
AT U.S. ROUTE 45 / ILLINOIS ROUTE 21 (MILWAUKEE AVE.)
INTERSECTION RECONSTRUCTION, CULVERT REPLACEMENT
AND TRAFFIC SIGNAL MODERNIZATION

SECTION 20R-6
LAKE COUNTY
C-91-271-02

HIGHWAY CLASSIFICATION
STRATEGIC REGIONAL ARTERIAL

DESIGN DESIGNATION
2500 (20) ARTERIAL 13.83 (PCC-20)

TRAFFIC DATA
US RTE 45 / IL RTE 21 TO OLDE HALF DAY RD
2000 ADT=22,000 2020 ADT=33,000
POSTED SPEED LIMIT=50 Km/H (35 MPH)
DESIGN SPEED LIMIT=70 Km/H (45 MPH)

PROJECT DESCRIPTION
THE PROPOSED IMPROVEMENT CONSISTS OF THE
WIDENING AND RECONSTRUCTION OF THE ILLINOIS ROUTE 22
AND U.S. ROUTE 45/ILLINOIS ROUTE 21 INTERSECTION, NEW
STORM SEWER SYSTEM, REPLACEMENT OF THE INDIAN CREEK
TRIBUTARY DOUBLE BOX CULVERT (SN 049-0233),
AND TRAFFIC SIGNAL MODERNIZATION.

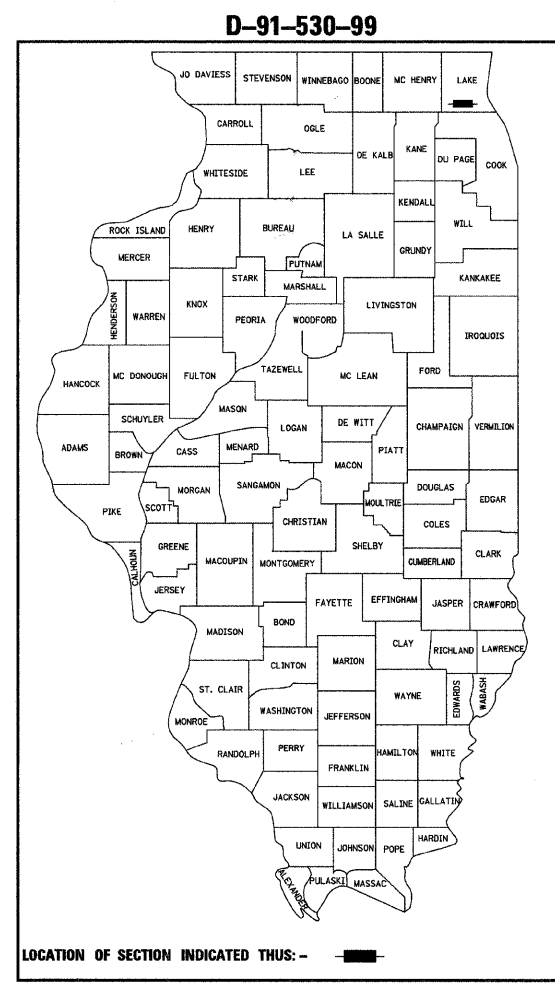

PROJECT LOCATED IN
VILLAGE OF LINCOLNSHIRE

INDIAN CREEK TRIBUTARY
DOUBLE BOX CULVERT
REPLACEMENT
SN 049-0233, STA. 104 + 950

IL RTE 22
END PROJECT
STA. 105 + 132.181

STATION EQUATION
STA. 105+132.181 BK = STA. 105+131.926 AH
W.B.L. & E.B.L.

US RTE 45 / IL RTE 21
END IMPROVEMENT
STA. 10 + 180.459

IL RTE 22
BEGIN PROJECT
STA. 104 + 517.919

US RTE 45 / IL RTE 21
BEGIN IMPROVEMENT
STA. 9 + 845.844

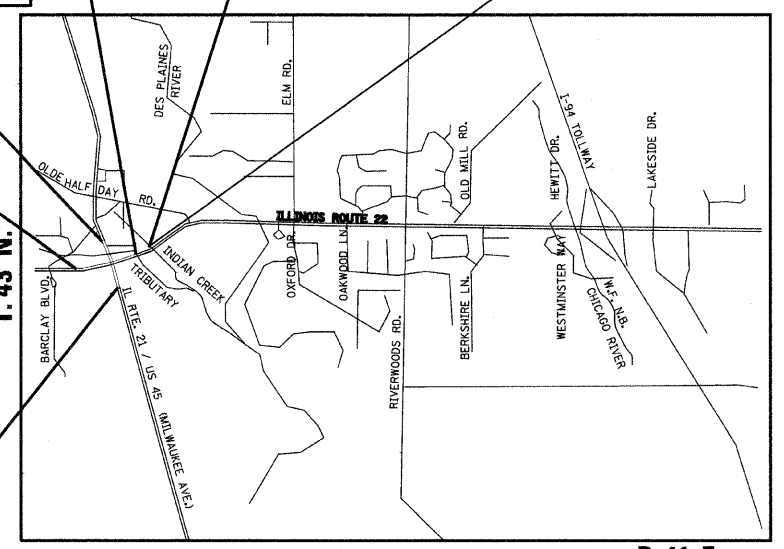

VERNON TOWNSHIP R. 11 E.

LOCATION MAP
SCALE 1:15,000

GROSS LENGTH ILLINOIS RTE. 22 = 614 m = 0.614 Km
NET LENGTH ILLINOIS RTE. 22 = 614 m = 0.614 Km

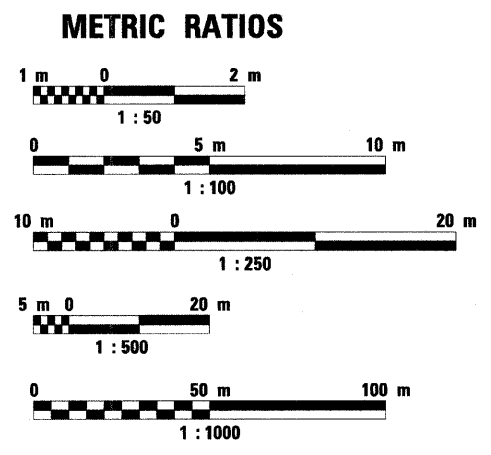

FULL SIZE PLANS HAVE BEEN PREPARED USING STANDARD
ENGINEERING SCALES, REDUCED SIZED PLANS WILL NOT
CONFORM TO STANDARD SCALES, IN MAKING MEASUREMENTS
ON REDUCED PLANS, THE ABOVE SCALES MAY BE USED.

J.U.L.I.E.
JOINT UTILITY LOCATION INFORMATION FOR EXCAVATION
1-800-892-0123 OR 811

CONTRACT NO. 62519

PATRICK ENGINEERING, INC.
DENIS T. HOGAN, P.E.
062-050059
Denis T. Hogan
DATE: 1/28/09
SIGNATURE AND SEAL APPLY TO DRWG.
NOS.
EXP 11/30/09

PATRICK ENGINEERING, INC.
PAUL M. LOPEZ, S.E.
081-005231
Paul M. Lopez
DATE: 1/28/09
SIGNATURE AND SEAL APPLY TO DRWG.
NOS. Shts 51 thru 56
EXP 11/30/10

STATE OF ILLINOIS
DEPARTMENT OF TRANSPORTATION
DIVISION OF HIGHWAYS
SUBMITTED FEBRUARY 5, 20 09
Dean M. O'Keefe
DEPUTY DIRECTOR OF HIGHWAYS, REGION ENGINEER
March 27, 20 09
Charles J. Ingersoll
ENGINEER OF DESIGN AND ENVIRONMENT
March 27, 20 09
Christine M. Reed
DIRECTOR OF HIGHWAYS, CHIEF ENGINEER

PATRICK ENGINEERING, INC.
MIR S. ALIKHAN, P.E.
062-054268
Mir S. Alikhan
DATE: 1/28/09
SIGNATURE AND SEAL APPLY TO DRWG.
NOS. Shts TSHRUTS 18
EXP 11/30/09

DISTRICT 1-DESIGN /CONSULTANT UNIT /ISSAM RAYAN (847) 705-4556
PATRICK ENGINEERING INC. LISLE, ILLINOIS