

F.A.P. RTE.	SECTION	COUNTY	TOTAL SHEETS	SHEET NO.
337	20R-6	LAKE	149	19
STA.		TO STA.		
FED. ROAD DIST. NO.		ILLINOIS FED. AID PROJECT		
CONTRACT NO. 62519				

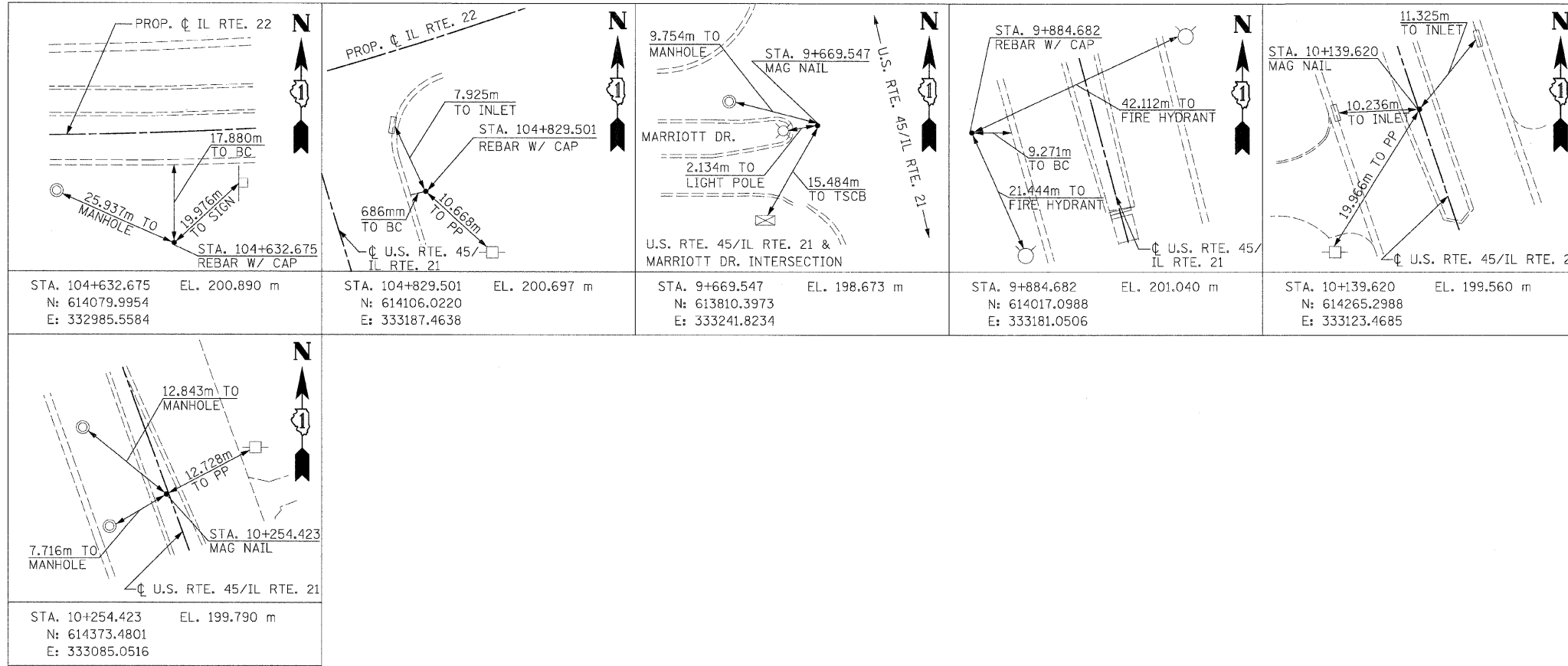

+koepper(Rdwy...isle) 2/5/2009 5:06:51PM P:\Lisle\DOT\971\A0\Drawings\RDWY\M\1\Sints\AIF\S_Ties_01.dgn PDF(Grey_Large).plt



REVISIONS		ILLINOIS DEPARTMENT OF TRANSPORTATION FAP ROUTE 337 (IL ROUTE 22) ALIGNMENT, TIES, & BENCHMARKS
NAME	DATE	

SCALE: NONE DRAWN BY: TCK
DATE: 1/28/2009 CHECKED BY: DTH