

F.A.P. RTE.	SECTION	COUNTY	TOTAL SHEETS	SHEET NO.
337	20R-6	LAKE	149	31
STA.	TO STA.			
FED. ROAD DIST. NO.	ILLINOIS FED. AID PROJECT			
CONTRACT NO. 62519				

P:\Lislie\IDOT\9171\AO\Drawings\RD\WY\MIL\Shts\MOT\S_MOT_02_00.cgm
 PDF(Grey_Large).pht
 5:07:59 PM
 2/5/2009
 hkoepfen(Rdwy_Lislie)

LEGEND

- TEMPORARY PAVEMENT
- WORK ZONE
- DIRECTION OF TRAFFIC
- TYPE II BARRICADES OR DRUMS WITH STEADY BURN LIGHTS @ 15m CENTERS ALONG ROADWAY (TANGENT), 7.5m CENTERS ALONG TAPERS AND 3.5m CENTERS ALONG RADII
- TYPE III BARRICADES WITH FLASHING LIGHTS
- ARROW BOARD

NOTE: ALL TAPERS ARE 45:1 UNLESS OTHERWISE NOTED

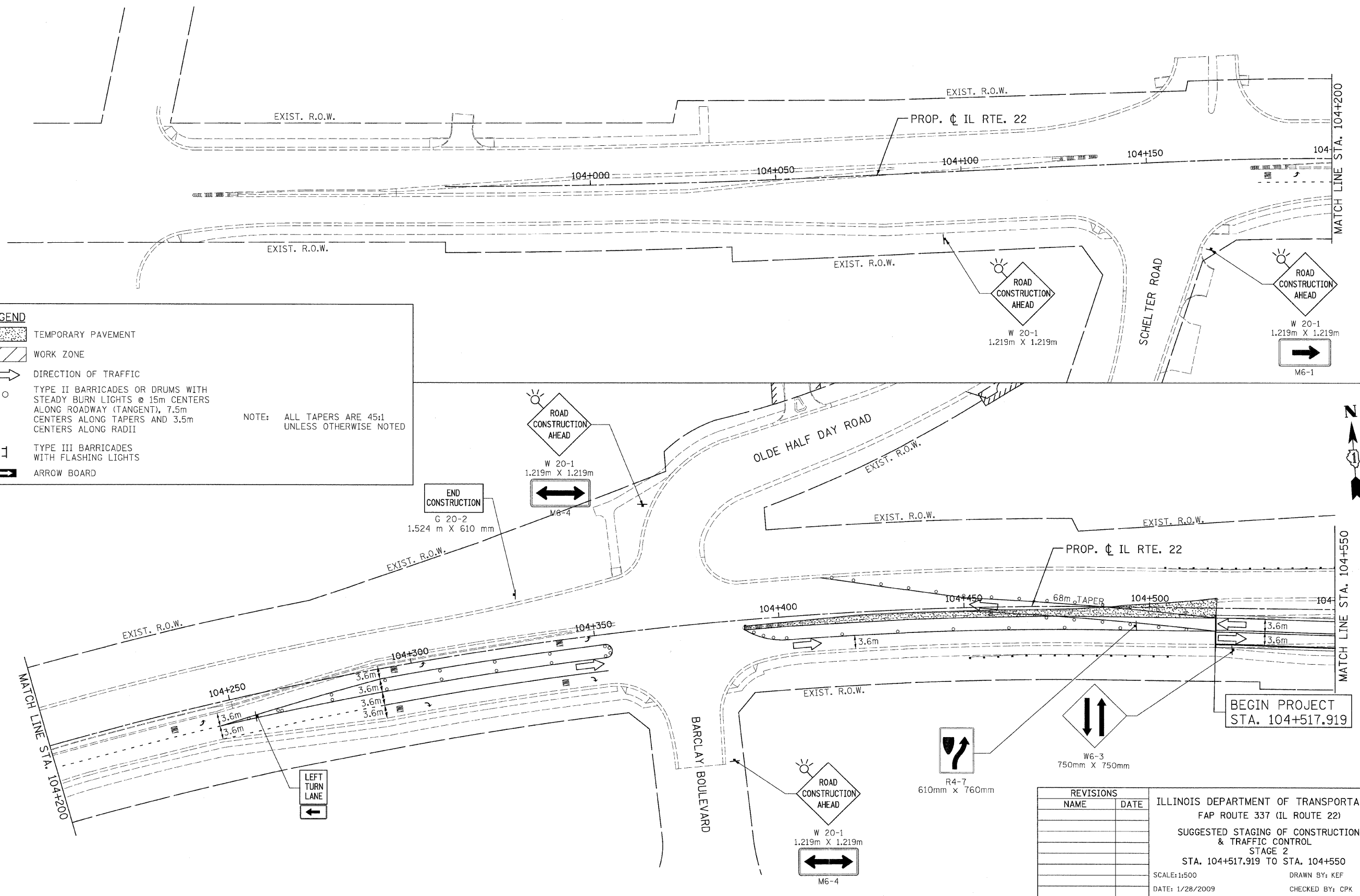

REVISIONS	
NAME	DATE

ILLINOIS DEPARTMENT OF TRANSPORTATION
 FAP ROUTE 337 (IL ROUTE 22)
 SUGGESTED STAGING OF CONSTRUCTION & TRAFFIC CONTROL
 STAGE 2
 STA. 104+517.919 TO STA. 104+550
 SCALE: 1:500
 DATE: 1/28/2009
 DRAWN BY: KEF
 CHECKED BY: CPK