

| | | | | |
|---------------------|---------------------------|--------|--------------|-----------|
| F.A.P. RTE. | SECTION | COUNTY | TOTAL SHEETS | SHEET NO. |
| 337 | 20R-6 | LAKE | 149 | 36 |
| STA. | TO STA. | | | |
| FED. ROAD DIST. NO. | ILLINOIS FED. AID PROJECT | | | |
| CONTRACT NO. 62519 | | | | |

P:\Lislie\DOT\9717\A0\Drawings\RDWY\MF\Shfts\MOT\S_MOT_03_00.dgn
 PDF(Grey_Large).plt
 5:08:41PM
 2/5/2009
 tkoeppe(Rdwy_Lislie)

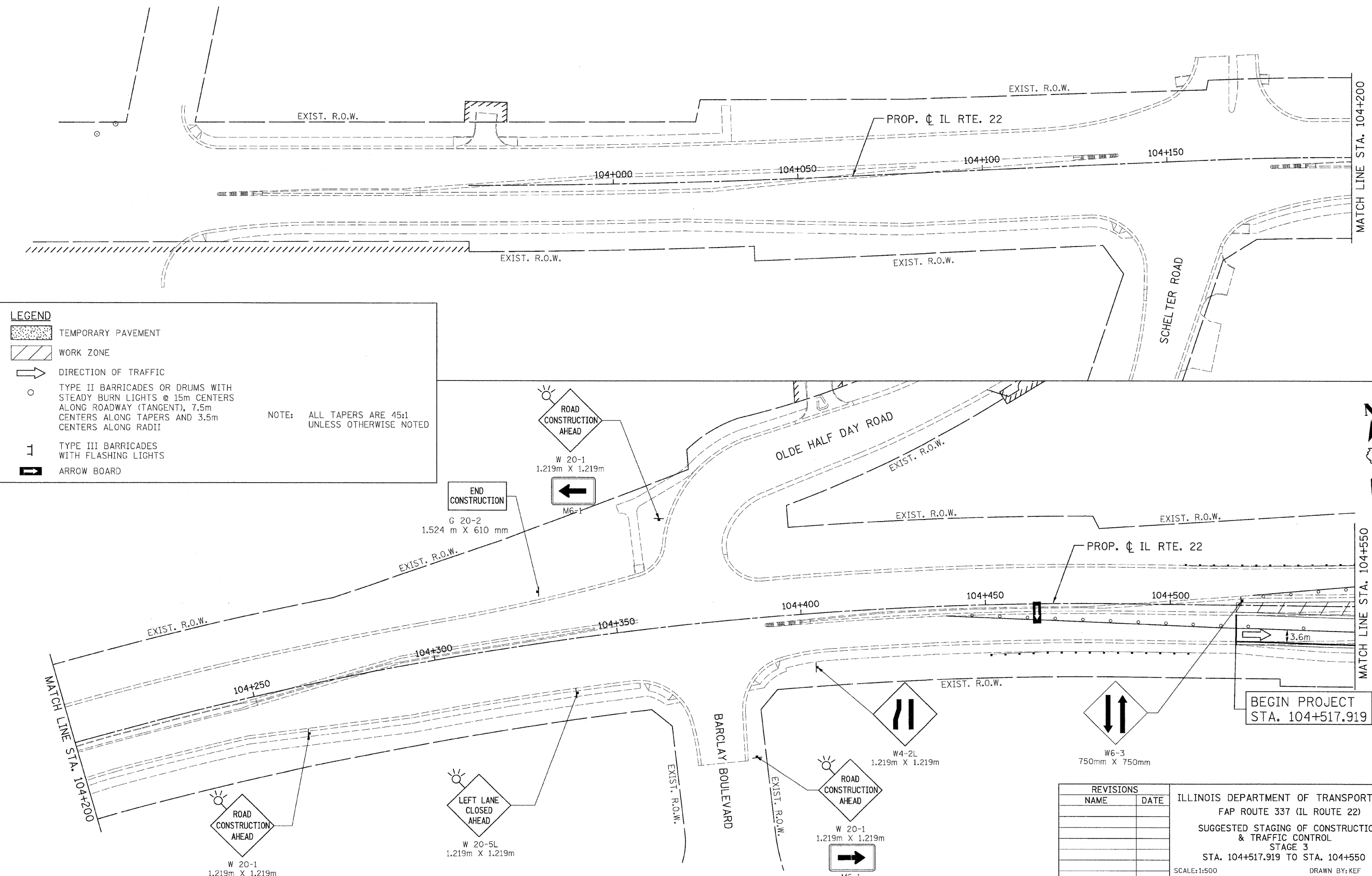

LEGEND

- TEMPORARY PAVEMENT
- WORK ZONE
- DIRECTION OF TRAFFIC
- TYPE II BARRICADES OR DRUMS WITH STEADY BURN LIGHTS @ 15m CENTERS ALONG ROADWAY (TANGENT), 7.5m CENTERS ALONG TAPERS AND 3.5m CENTERS ALONG RADII
- TYPE III BARRICADES WITH FLASHING LIGHTS
- ARROW BOARD

NOTE: ALL TAPERS ARE 45:1 UNLESS OTHERWISE NOTED



ROAD CONSTRUCTION AHEAD
W 20-1
1.219m X 1.219m

LEFT LANE CLOSED AHEAD
W 20-5L
1.219m X 1.219m

ROAD CONSTRUCTION AHEAD
W 20-1
1.219m X 1.219m
M6-1

END CONSTRUCTION
G 20-2
1.524 m X 610 mm

ROAD CONSTRUCTION AHEAD
W 20-1
1.219m X 1.219m
M6-1

ROAD CONSTRUCTION AHEAD
W4-2L
1.219m X 1.219m

ROAD CONSTRUCTION AHEAD
W6-3
750mm X 750mm

BEGIN PROJECT
STA. 104+517.919

| REVISIONS | |
|-----------|------|
| NAME | DATE |
| | |
| | |
| | |
| | |
| | |
| | |
| | |
| | |
| | |
| | |

ILLINOIS DEPARTMENT OF TRANSPORTATION
 FAP ROUTE 337 (IL ROUTE 22)
 SUGGESTED STAGING OF CONSTRUCTION
 & TRAFFIC CONTROL
 STAGE 3
 STA. 104+517.919 TO STA. 104+550
 SCALE: 1:500
 DATE: 1/28/2009
 DRAWN BY: KEF
 CHECKED BY: CPK